

**BENCHMARKS:**

BM #1: "□" Cut on top of curb, east side of Ridgehurst, adjacent to common front lot corner of Lots 6 & 7, Block E, Stonebridge 2nd Addition.  
ELEV. = 1348.51 NGVD29

BM #2: "□" Cut on top of curb, south side of Sundance, near end of pavement in front of Lot 6, Block 3, Savannah at Castle Rock Ranch 7th Addition.  
ELEV. = 1347.33 NGVD29

BM #3: "□" Cut on top of hubguard at NE corner of RCBC 350' west of the east property line of Stonebridge 2nd Addition.  
ELEV. = 1333.58 NGVD29

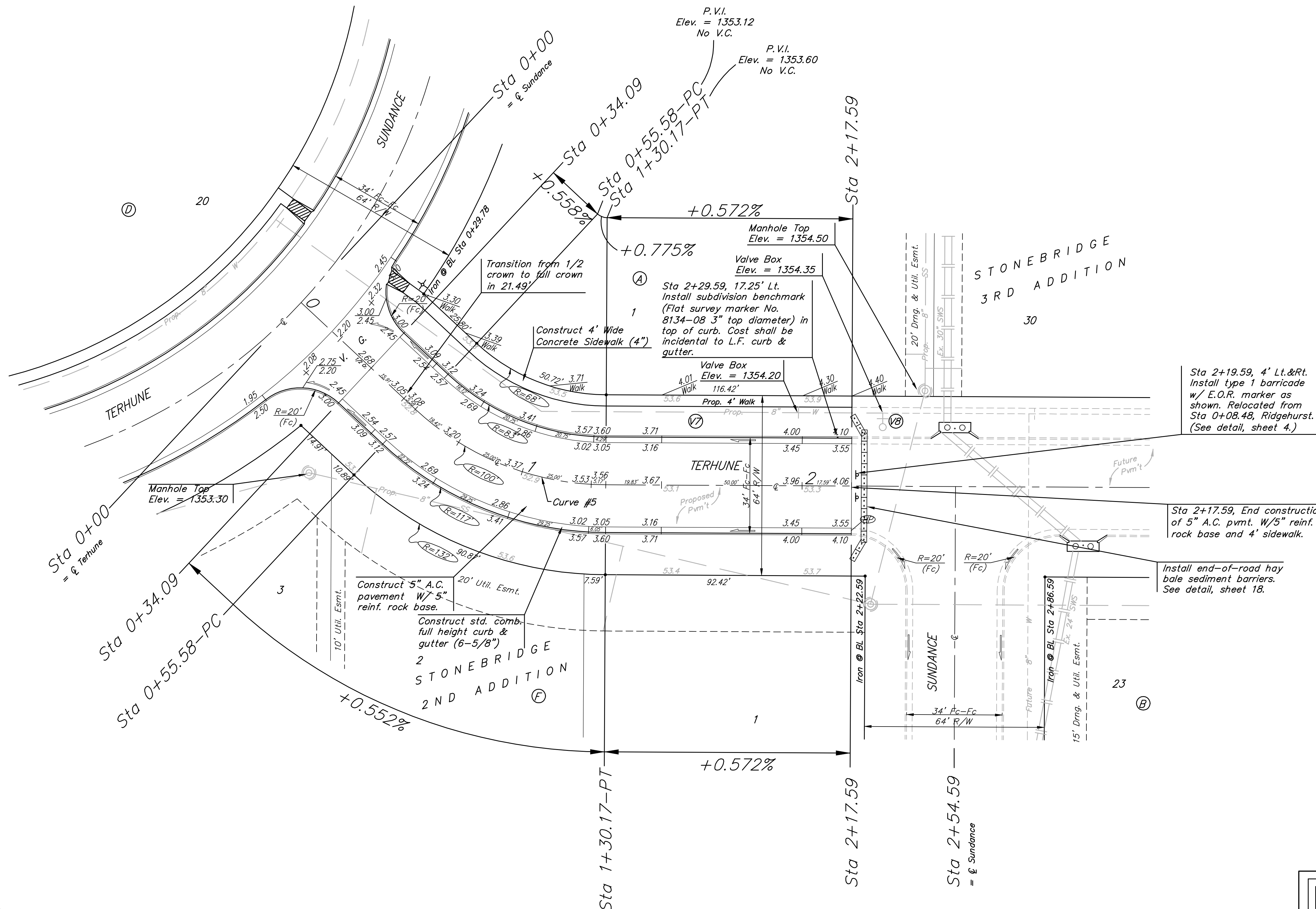
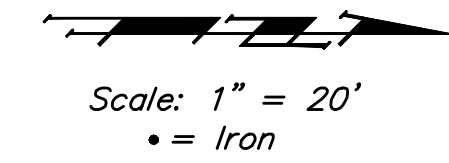

Curve #5  
Curve Data Based on Centerline

Rad. = 100' Delta = 42° 44' 14" Tangent = 39.13'  
Arc = 74.59' L.C. = 72.87' Def/Ft. = 17.18885 Min.

Station	Arc	FACE CHORD LENGTHS		Def.	T. Def.
		8 Lt.	8 Rt.		
0+55.58	-	-	-	0'00"00"	0'00"00"
0+75.00	19.42'	14.54'	24.24'	5'33'48"	5'33'48"
1+00.00	25.00'	18.70'	31.17'	7'09'43"	12'43'32"
1+25.00	25.00'	18.70'	31.17'	7'09'43"	19'53'15"
1+30.17	5.17'	3.88'	6.46'	1'28'52"	21'22'07"

P.V.I.  
Elev. = 1353.60  
No V.C.

	<b>TERHUNE</b> STA 0+00 TO STA 2+91.59	
	Baughman Company, P.A. 515 Ellis St. Wilkins, KS 67211 P 316-263-2771 F 316-263-0149 ENGINEERING   SURVEYING   PLANNING   LANDSCAPE ARCHITECTURE	
PROJECT NUMBER 47284592	DESIGN TJW	DRAWN TMS
REVISIONS:	APPROVED NBW	DATE 07/11
SCALE Noted		SHEET <b>11 OF 28</b>
06-14 Str1.dwg		06-08-E635