

BENCHMARK:
 BM #7 - Chiseled "+" on sidewalk in the Northeast
 Corner Reserve G of the Fossil Rim Estates
 Sta. 54+65, 170' Rt.
 Elev. = 1367.20

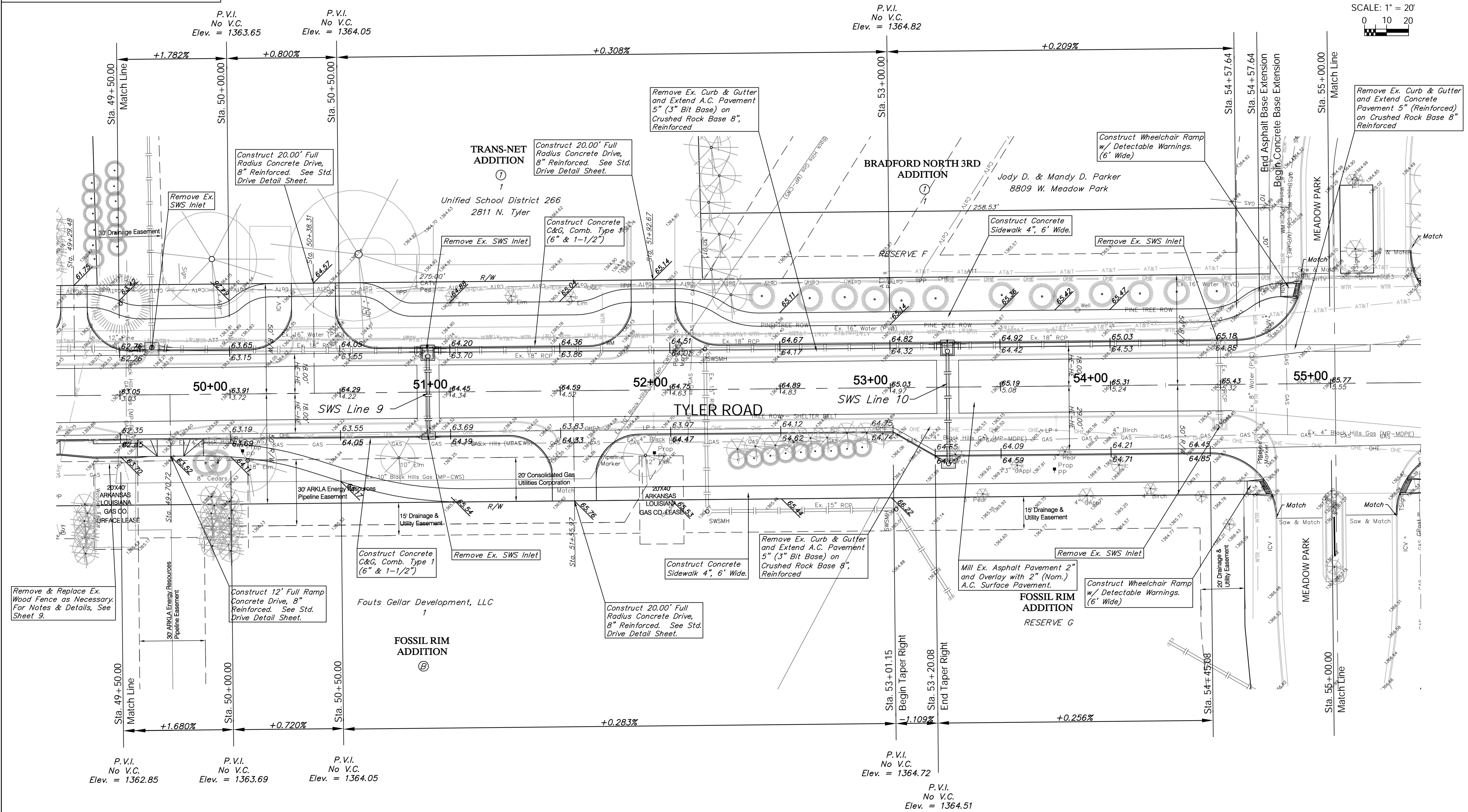
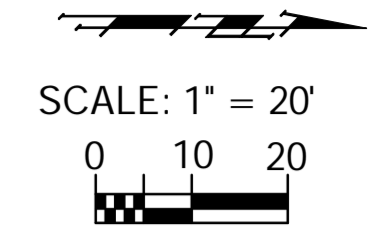

Remove & Replace Ex. Wood Fence as Necessary. For Notes & Details, See Sheet 9.

Construct 12' Full Ramp Concrete Drive, 8" Reinforced. See Std. Drive Detail Sheet.

Construct Concrete C&G, Comb. Type 1 (6" & 1-1/2")

Construct 20.00' Full Radius Concrete Drive, 8" Reinforced. See Std. Drive Detail Sheet.

Remove Ex. Curb & Gutter and Extend A.C. Pavement 5" (3" Bit Base) on Crushed Rock Base 8", Reinforced

Mill Ex. Asphalt Pavement 2" and Overlay with 2" (Nom.) A.C. Surface Pavement.

Construct Wheelchair Ramp w/ Detectable Warnings. (6' Wide)

Remove Ex. Curb & Gutter and Extend Concrete Pavement 5" (Reinforced) on Crushed Rock Base 8" Reinforced

P.V.I. No V.C. Elev. = 1362.85
 P.V.I. No V.C. Elev. = 1363.69
 P.V.I. No V.C. Elev. = 1364.05

P.V.I. No V.C. Elev. = 1364.72

P.V.I. No V.C. Elev. = 1364.51

Drawing File: E:\Projects\Tyler - 21st to 29th\Civil 3d\Tyler Base.dwg (Par08)

Project No. 1012E575 CAPITAL IMPROVEMENT PROJECT
 TYLER ROAD PAVING
 Sta. 49 + 50.00 to Sta. 55 + 00.00
 TYLER ROAD - 21ST STREET NORTH to 29TH STREET NORTH

Design: TPV
 Drawn: STAFF
 Approved: TPV
 Scale: NOTED

Baughman Company, P.A.
 315 Ellis St., Wichita, KS 67211 P 316.262.1271 F 316.262.0149
 ENGINEERING | SURVEYING | PLANNING | LANDSCAPE ARCHITECTURE

July 2011
 SHEET 18 OF 100