

BENCHMARK:
 BM #7 - Chiseled "+" on sidewalk in the Northeast
 Corner Reserve G of the Fossil Rim Estates
 Sta. 54+65, 170' Rt.
 Elev. = 1367.20

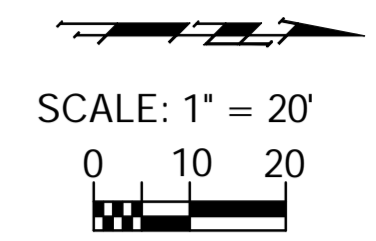

Remove Ex. Curb & Gutter
 and Extend Concrete
 Pavement 5" (Reinforced)
 on Crushed Rock Base 8"
 Reinforced

Construct Concrete
 Pavement (VG) 8" (Reinf.)
 on Crushed Rock Base 7",
 Reinforced, W/Concrete Curb,
 Mono Edge (6" & 1-1/2")

P.V.I.
 No V.C.
 Elev. = 1366.04

P.V.I.
 No V.C.
 Elev. = 1366.04

P.V.I.
 No V.C.
 Elev. = 1365.94

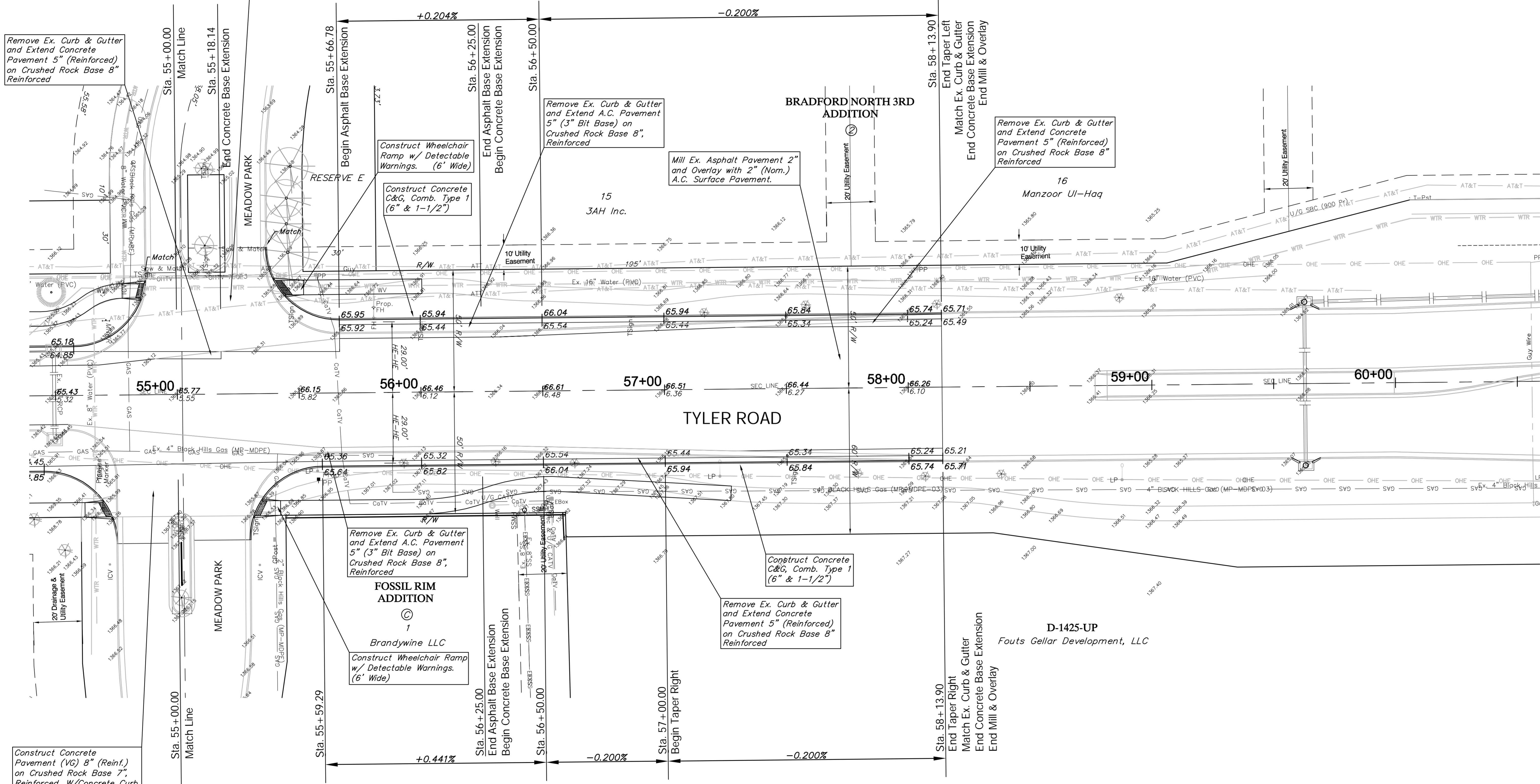

Construct Concrete
 Pavement (VG) 8" (Reinf.)
 on Crushed Rock Base 7",
 Reinforced, W/Concrete Curb,
 Mono Edge (6" & 1-1/2")

Remove Ex. Curb & Gutter
 and Extend A.C. Pavement
 5" (3" Bit Base) on
 Crushed Rock Base 8",
 Reinforced

Construct Wheelchair Ramp
 w/ Detectable Warnings.
 (6' Wide)

P.V.I.
 No V.C.
 Elev. = 1366.04

P.V.I.
 No V.C.
 Elev. = 1365.94

Drawing File: E:\Projects\Tyler - 21st to 29th\Civil 3d\Tyler Base.dwg (Pav09)
 Project No. 1012E575 CAPITAL IMPROVEMENT PROJECT
 Design: TPV
 Drawn: STAFF
 Approved: TPV
 Scale: NOTED
 TYLER ROAD PAVING
 Sta. 55+00.00 to Sta. 58+13.90
 TYLER ROAD - 21ST STREET NORTH to 29TH STREET NORTH

Baughman Company, P.A.
 315 Ellis St., Wichita, KS 67211 P 316-262-7271 F 316-262-0149
 ENGINEERING | SURVEYING | PLANNING | LANDSCAPE ARCHITECTURE

July 2011
 SHEET
 19
 OF
 100