

BENCHMARK:
 BM #3 - Chiseled "□" on the Top of Curb in the Southwest Parking Lot at the Middle Drive to the Reflection Ridge Retirement Home.
 Sta. 22+66, 75' Rt.
 Elev. = 1355.93

SCALE:
 HORIZONTAL: 1" = 20'
 VERTICAL: 1" = 5'

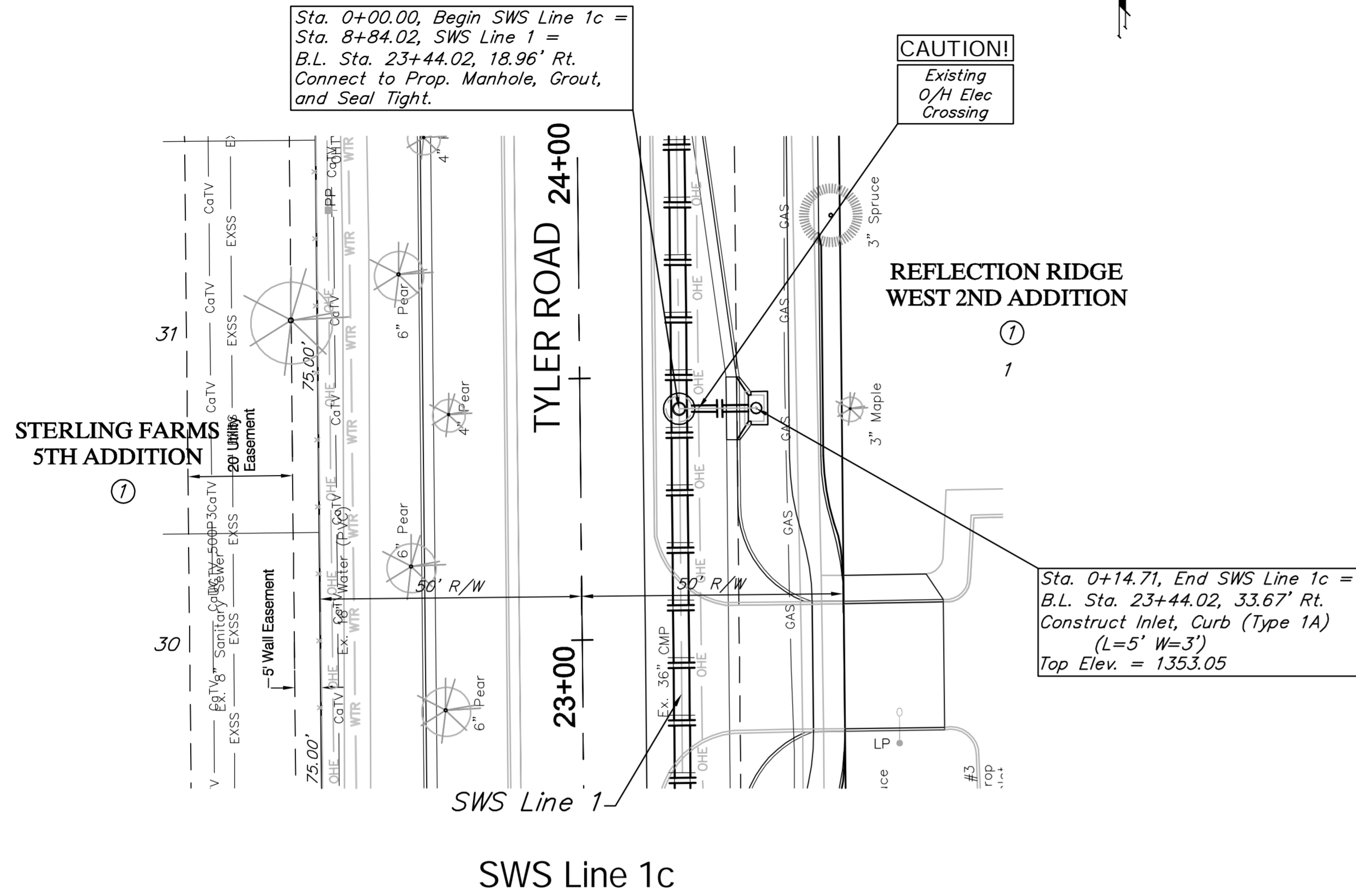

BENCHMARK:
 BM #4 - Chiseled "□" on the Top of the Curb on the East End of Median at Sterling
 Sta. 28+74, 53' Lt.
 Elev. = 1353.76

SCALE:
 HORIZONTAL: 1" = 20'
 VERTICAL: 1" = 5'

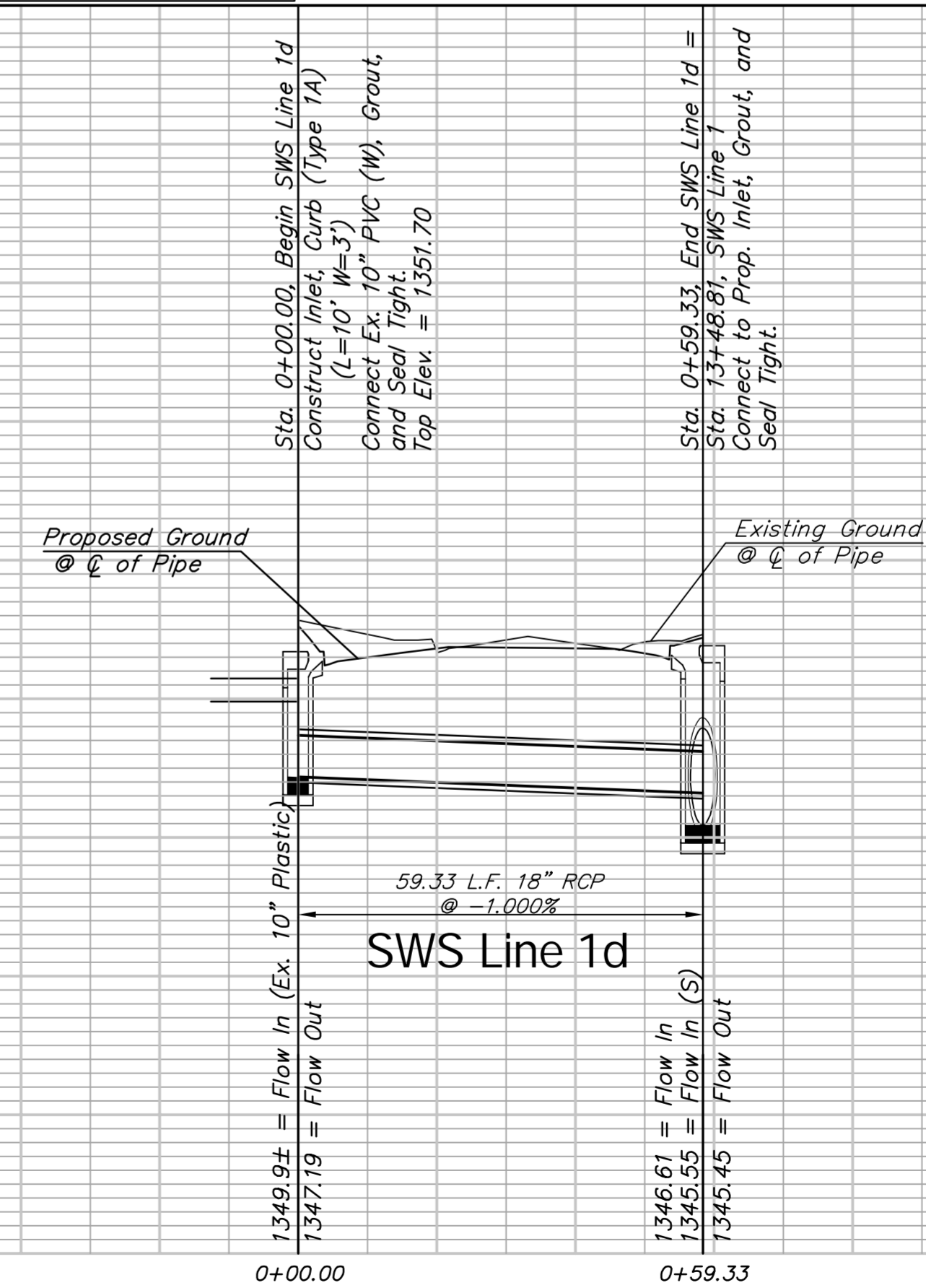
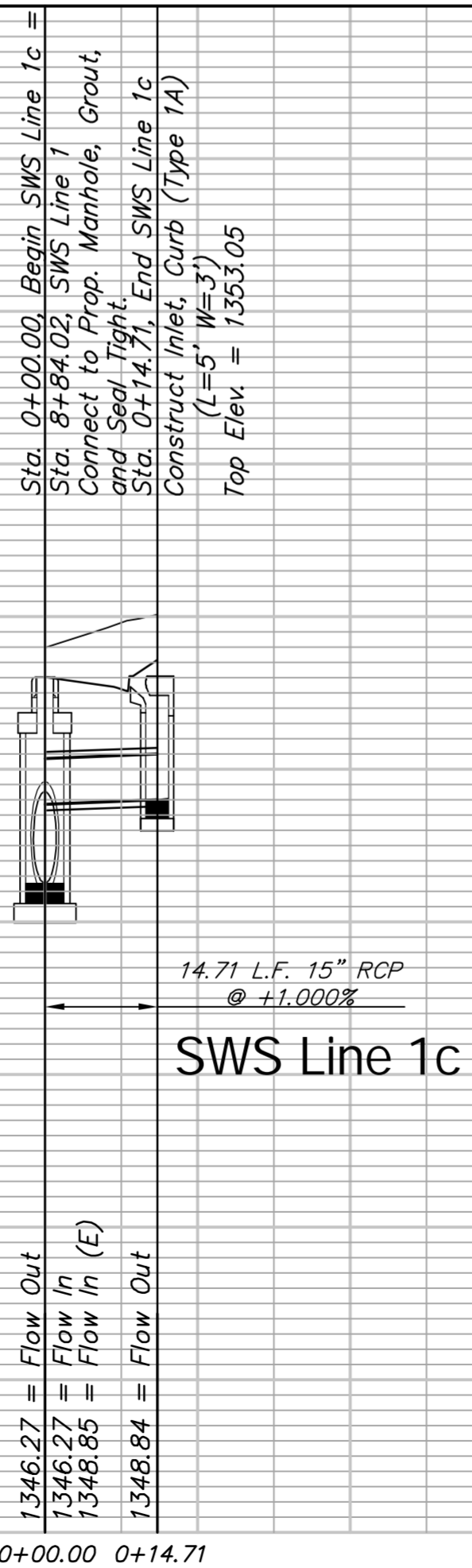
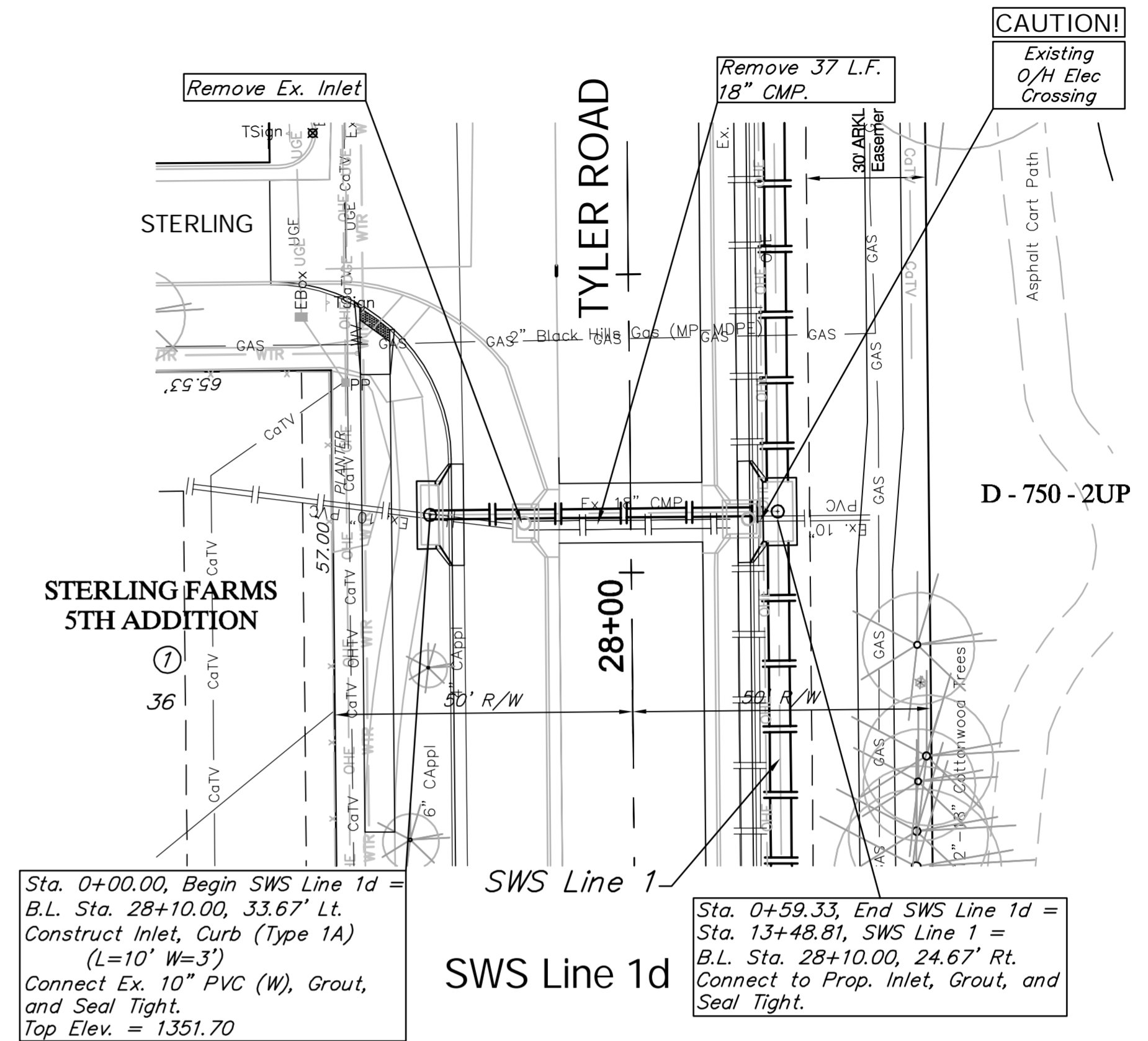

Drawing File: E:\Projects\Tyler-21st to 29th\Civil 3d\Tyler Base.dwg (SWS 05)
 Project No. 1012ES75 CAPITAL IMPROVEMENT PROJECT
 Design: TPV
 Drawn: SS/TPV
 Approved: TPV
 Scale: NOTED

TYLER ROAD SWS PLAN & PROFILE
 SWS Line 1c & SWS Line 1d
 TYLER ROAD - 21st STREET NORTH to 29th STREET NORTH

Baughman Company, P.A.
 315 Ellis St., Wichita, KS 67211 P 316.262.1271 F 316.262.0149
 ENGINEERING | SURVEYING | PLANNING | LANDSCAPE ARCHITECTURE

July 2011
 SHEET 28
 OF 100