

BENCHMARK:  
 BM #4 - Chiseled "□" on the Top of the Curb on the East End of Median at Sterling  
 Sta. 28+74, 53' Lt.  
 Elev. = 1353.76

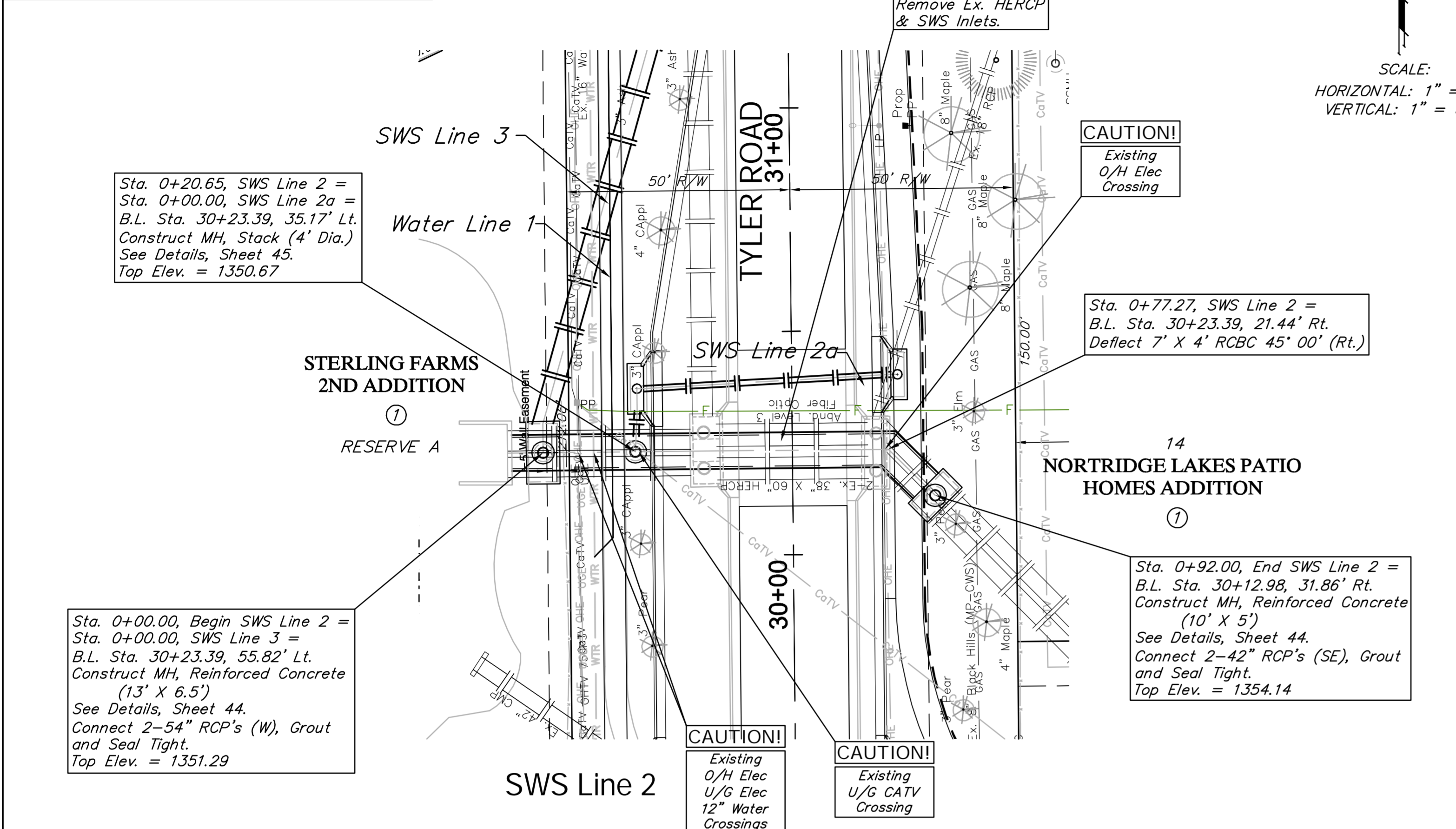

BENCHMARK:  
 BM #4 - Chiseled "□" on the Top of the Curb on the East End of Median at Sterling  
 Sta. 28+74, 53' Lt.  
 Elev. = 1353.76

