

BENCHMARK:
 BM #7 - Chiseled "+" on sidewalk in the Northeast
 Corner Reserve G of the Fossil Rim Estates
 Sta. 54+65, 170' Rt.
 Elev. = 1367.20

SCALE:
 HORIZONTAL: 1" = 20'
 VERTICAL: 1" = 5'

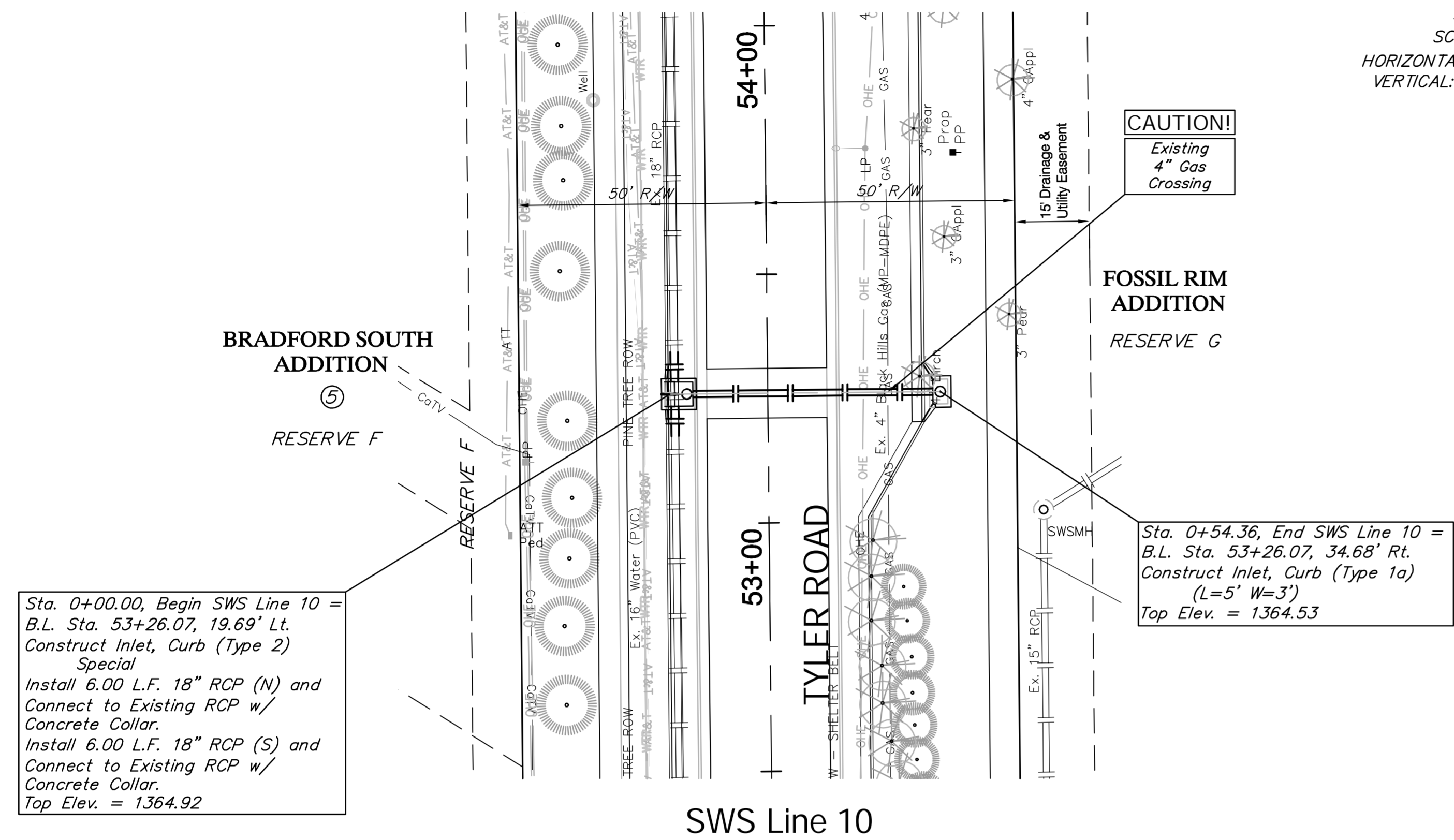

BENCHMARK:
 BM #6 - Chiseled "□" on the Top of the Curb on
 the East End of Median at Meadow Knoll
 Sta. 46+24, 50' Lt.
 Elev. = 1357.00

SCALE:
 HORIZONTAL: 1" = 20'
 VERTICAL: 1" = 5'

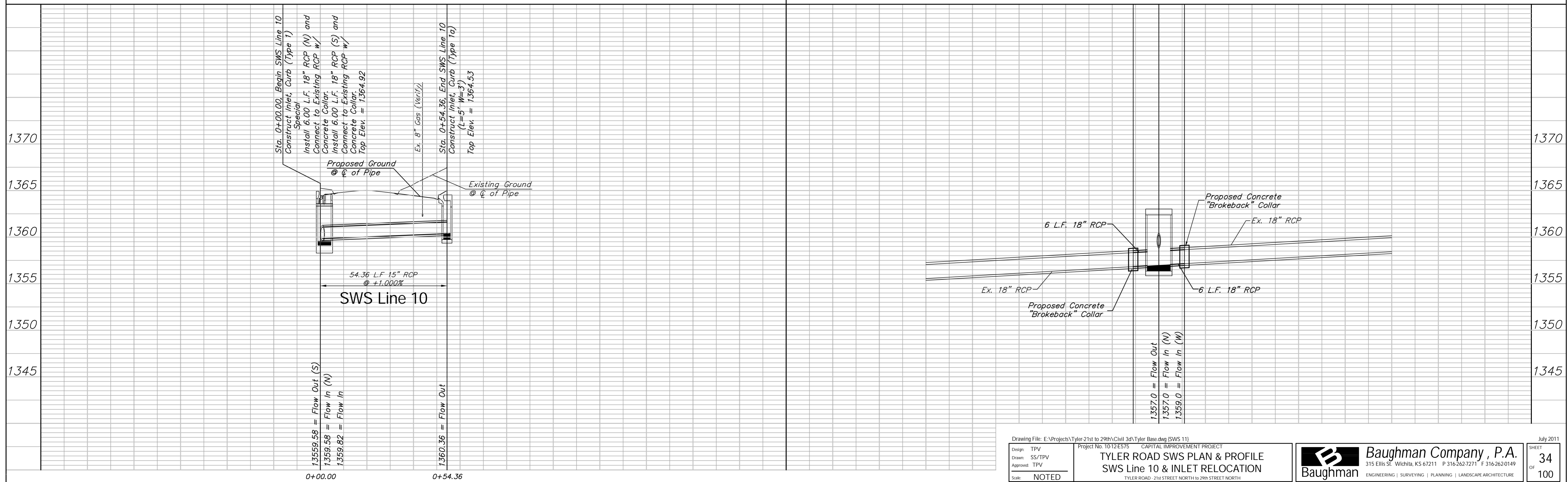
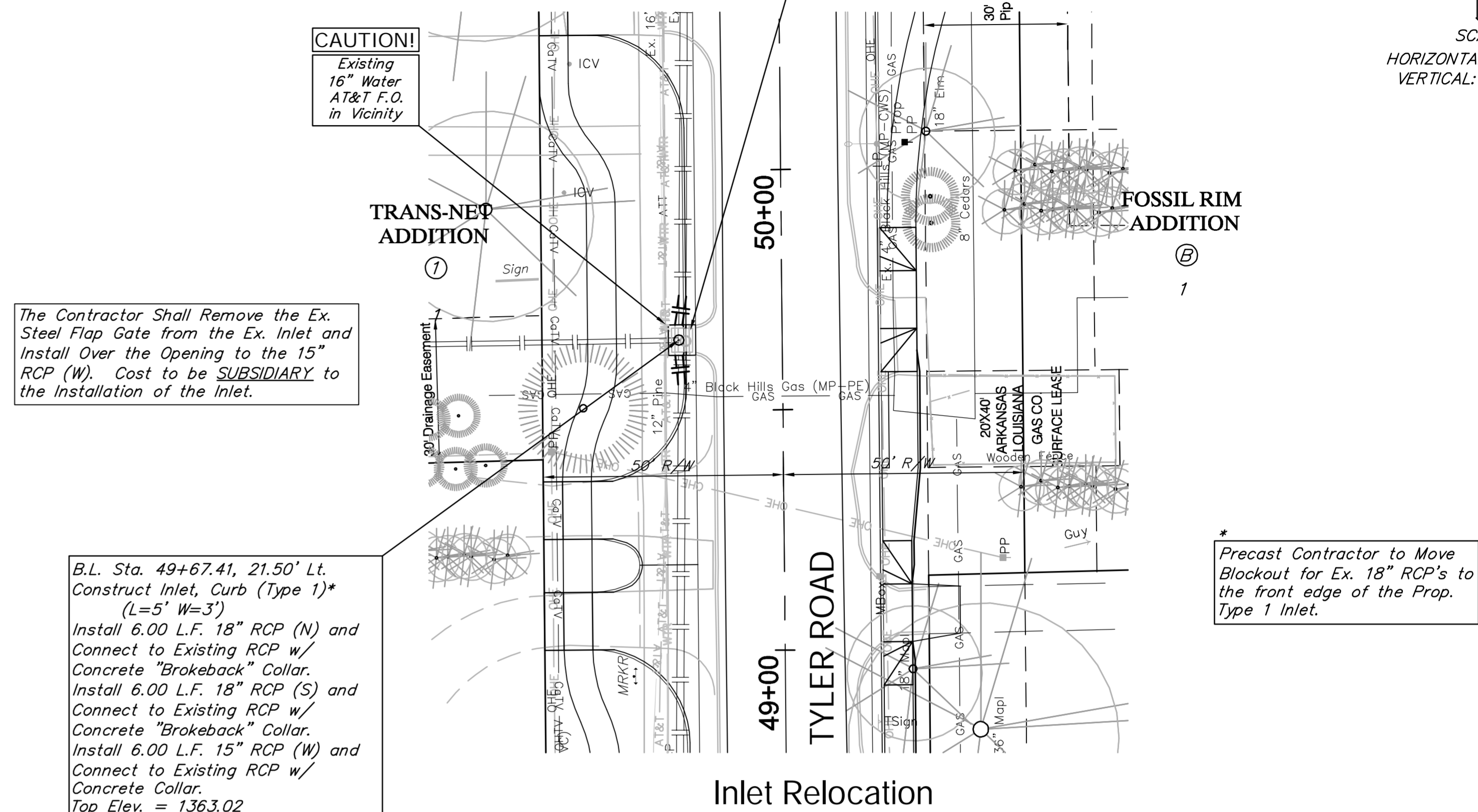

Drawing File: E:\Projects\Tyler-21st to 29th\Civil 3d\Tyler Base.dwg (SWS 11)

Design: TPV
 Drawn: SS/TPV
 Approved: TPV
 Scale: NOTED

Project No. 1012E575 CAPITAL IMPROVEMENT PROJECT
 TYLER ROAD SWS PLAN & PROFILE
 SWS Line 10 & INLET RELOCATION
 TYLER ROAD - 21st STREET NORTH to 29th STREET NORTH

Baughman Company, P.A.
 315 Ellis St., Wichita, KS 67211 P 316-262-7271 F 316-262-0149
 ENGINEERING | SURVEYING | PLANNING | LANDSCAPE ARCHITECTURE

July 2011
 SHEET 34
 OF 100