

GENERAL NOTES

- ALL CONSTRUCTION AND MATERIALS TO COMPLY WITH CITY OF WICHITA SPECIFICATIONS AND STANDARDS.
- ALL ELEVATIONS SHOWN ARE NGVD 29 DATUM.
- THE CONTRACTOR SHALL LIMIT THE EXTENT OF TRENCH TO REMAIN OPEN OVERNIGHT AND WEEKENDS TO LESS THAN 50 FEET.
- AT LEAST 72 HOURS PRIOR TO BEGINNING EXCAVATION (EXCLUDING WEEKENDS AND HOLIDAYS), THE CONTRACTOR SHALL CONTACT THE KANSAS ONE-CALL SYSTEM, A UTILITY LOCATION SERVICE, AT (316) 687-2470 TO REQUEST THE LOCAL UTILITY COMPANIES MARK ANY EXISTING LINES WITHIN THE PROJECT AREA.
- UNDERGROUND UTILITY SERVICE LINES AND OVERHEAD UTILITY POLE LINES ARE TO BE ADJUSTED AS NECESSARY BY OTHERS PRIOR TO CONSTRUCTION UNLESS THE PLANS SPECIFICALLY CALL FOR THEIR ADJUSTMENT BY THE CONTRACTOR OR UNLESS THE PLANS SPECIFICALLY IDENTIFY A UTILITY TO BE ADJUSTED BY ITS OWNER DURING CONSTRUCTION. EXISTING UTILITIES AND THEIR LOCATIONS, AS SHOWN ON THE PLANS, REPRESENT THE BEST INFORMATION OBTAINABLE FOR THE DESIGN. THE CONTRACTOR WILL BE REQUIRED TO WORK AROUND EXISTING UTILITIES WITHIN THE RIGHT-OF-WAY WHICH DO NOT CONFLICT WITH PROPOSED CONSTRUCTION.
- THE CONTRACTOR SHALL BE RESPONSIBLE FOR PRESERVING PROPERTY IRONS. THE CONTRACTOR WILL BE REQUIRED TO RE-ESTABLISH ANY PROPERTY IRONS WHICH ARE DAMAGED OR DESTROYED BY HIS CONSTRUCTION OPERATIONS. SUCH IRONS SHALL BE RE-ESTABLISHED BY A LICENSED LAND SURVEYOR IN ACCORDANCE WITH STATE LAWS. ALL COSTS FOR THIS WORK SHALL BE SUBSIDIARY TO THE LUMP SUM PRICE BID FOR "SITE RESTORATION".
- CONTRACTOR SHALL PROVIDE POSITIVE DRAINAGE AWAY FROM ALL MANHOLE COVERS.
- MANHOLES SHALL BE TYPE "P" MANHOLES. MANHOLES SHALL BE CONSTRUCTED IN ACCORDANCE WITH THE STANDARD SPECIFICATIONS AND THE STANDARD DETAIL DRAWINGS.
- RUBBLE FROM THE REMOVAL OF MISCELLANEOUS STRUCTURES INCLUDING ANY TREES REMOVED AND TREE TRIMMINGS AND EXCESS EXCAVATED MATERIAL SHALL BE DISPOSED OF ON SITES PROVIDED BY THE CONTRACTOR. THESE SITES SHALL ALSO BE APPROVED OF BY THE ENGINEER AS TO SUITABILITY, APPEARANCE, AND SITE LOCATION. LOCATIONS THAT, IN THE OPINION OF THE ENGINEER, LEAVE AN UNSIGHTLY APPEARANCE WILL NOT BE APPROVED. ALL DISPOSAL SITES MUST BE APPROVED BY THE KANSAS DEPARTMENT OF HEALTH AND ENVIRONMENT. MATERIAL EITHER STOCKPILED OR DISPOSED OF IN A FLOOD PLAIN WILL REQUIRE A KANSAS STATE BOARD OF AGRICULTURE PERMIT. ANY MATERIAL DUMPED IN WATERS OF THE UNITED STATES OR WETLANDS IS SUBJECT TO U.S. CORPS OF ENGINEERS PERMITTING REGULATIONS. ANY MATERIAL BURIED OR STOCKPILED BEYOND APPROVED CONSTRUCTION LIMITS MAY REQUIRE ARCHAEOLOGICAL INVESTIGATIONS UNLESS BURIED IN A PREVIOUSLY APPROVED DISPOSAL LOCATION.
- ALL APPROVED EXCESS EXCAVATION WHICH IS TO BE WASTED SHALL BE STOCKPILED IN ACCORDANCE WITH GENERAL NOTE NO. 9 ABOVE.
- THE CONTRACTOR SHALL AVOID REMOVAL OR TRIMMING OF ANY TREES OR SHRUBS WHERE POSSIBLE. WHERE THE CONTRACTOR BELIEVES THE REMOVAL OR TRIMMING IS UNAVOIDABLE, HE SHALL COORDINATE SUCH WORK WITH THE ENGINEER. COSTS FOR TREE/SHRUB REMOVAL AND TRIMMING REGARDLESS OF SIZE SHALL BE CONSIDERED SUBSIDIARY TO THE LUMP SUM PRICE BID FOR "SITE CLEARING".
- THE CONTRACTOR SHALL PREVENT ANY CONSTRUCTION DEBRIS FROM ENTERING THE EXISTING SANITARY SEWER DURING CONSTRUCTION.
- THE CONTRACTOR SHALL GIVE ALL PROPERTY OWNERS AND/OR TENANTS OF DEVELOPED PROPERTY ABUTTING THE CONSTRUCTION OF THIS PROJECT A MINIMUM OF TEN (10) DAYS ADVANCE NOTICE PRIOR TO START OF CONSTRUCTION.
- THE CONTRACTOR IS REQUIRED TO MAINTAIN CONTINUOUS FLOW OF SEWAGE IN EXISTING MAINS AT ALL TIMES.
- THE CONTRACTOR SHALL NOT BURY MANHOLES THAT HAVE RIM ELEVATIONS WHICH ARE LOWER THAN EXISTING GROUND AT THE MANHOLE. THE GROUND AROUND SUCH MANHOLES AND ALONG THE SEWER ALIGNMENT SHALL BE BACKFILLED TO THE APPROXIMATE ELEVATION OF THE PROPOSED GROUND ELEVATION SHOWN ON THE PLAN/PROFILE SHEETS. THE CONTRACTOR SHALL PROVIDE DRAINAGE AWAY FROM THESE MANHOLES AND SEWER LINES BY CONSTRUCTION OF TEMPORARY DITCHES OR SLOPING THE GROUND AS REQUIRED. ALL COSTS FOR THIS WORK SHALL BE CONSIDERED SUBSIDIARY TO THE INSTALLED BID PRICE FOR MANHOLES OR PIPE.
- INTERURBAN TRAFFIC GENERATED OUTSIDE THE PROJECT AREA AND LOCAL BUSINESS OR RESIDENTIAL TRAFFIC GENERATED WITHIN THE PROJECT AREA ARE TO BE CARRIED THROUGH CONSTRUCTION AS FURTHER PROMULGATED BY PROJECT SPECIAL PROVISIONS. THE CONTRACTOR SHALL UTILIZE BARRICADES, SIGNS, GUARDS, AND FLAGMEN IN ACCORDANCE WITH THE MANUAL ON UNIFORM TRAFFIC CONTROL DEVICES.
- WHERE INDICATED IN THE PLANS, THE SANITARY SEWER EXCAVATION SHALL BE SAND FILLED AND FLUSHED (JETTED AND VIBRATED) WITH WATER PER THE REQUIREMENTS LISTED IN THE STANDARD SPECIFICATIONS FOR THE CITY OF WICHITA, UNLESS FLOWABLE FILL OR OTHER IMPROVED BACKFILL MATERIAL IS OTHERWISE SPECIFIED. ALL COSTS FOR SAND FILLING AND FLUSHING SHALL BE INCLUDED IN THE UNIT PRICE BID FOR "JETTED SAND BACKFILL".
- EACH BIDDER SHALL VISIT THE SITE OF THE PROJECT BEFORE SUBMITTING THE PROPOSAL FOR THIS WORK SO THAT HE WILL BE FULLY INFORMED OF THE EXISTING FIELD CONDITIONS AND THE OBSTACLES WHICH MIGHT BE ENCOUNTERED. UPON AWARD OF THE CONTRACT THE CONTRACTOR WILL NOT BE GRANTED ANY ADDITIONAL COMPENSATION WITH REGARDS TO TIME AND MONEY FOR CONDITIONS THAT MAY HAVE BEEN EVALUATED DURING ANY INSPECTION OF THE SITE.
- WHEN REMOVING/ABANDONING WATER AND SANITARY SEWER LINES AS SHOWN IN THE PLANS, THE CONTRACTOR SHALL CAP OR PLUG THE ENDS OF THE PIPES REMAINING IN PLACE PRIOR TO REMOVAL. ALL COSTS FOR THE REMOVAL/ABANDON OF EXISTING WATER AND SANITARY SEWER LINES AS PART OF CONSTRUCTION SHALL BE CONSIDERED SUBSIDIARY TO THE LUMP SUM PRICE BID FOR "SITE CLEARING" FOR THE RESPECTIVE WATERLINE AND SANITARY SEWER PROJECTS.
- IT SHOULD BE NOTED THAT OTHER BURIED LINES AND CABLE MAY EXIST WHICH ARE NOT SHOWN ON THESE PLANS. THE CONTRACTOR SHALL EXERCISE EXTREME CAUTION DURING TRENCHING OPERATIONS TO AVOID DAMAGING THESE LINES AND CABLES. ANY UTILITIES DAMAGED SHALL BE REPLACED OR REPAIRED IMMEDIATELY AS DIRECTED BY THE ENGINEER AT THE CONTRACTOR'S EXPENSE. THE CONTRACTOR SHALL PROTECT FROM DAMAGE AND SUPPORT EXISTING UTILITIES THROUGH CONSTRUCTION AS APPROVED BY THE UTILITY OWNER AND THE ENGINEER AT THE CONTRACTOR'S EXPENSE.
- WHERE THE IMPROVEMENTS CROSS EXISTING PUBLIC OR PRIVATE UTILITIES WHICH ARE NOT TO BE ADJUSTED BY OTHERS, THE CONTRACTOR SHALL PROVIDE THE MATERIAL AND MEANS TO PROTECT AND SUPPORT SAID UTILITIES DURING CONSTRUCTION TO THE SATISFACTION OF THE ENGINEER.
- EROSION CONTROL (BMP'S) EROSION CONTROL MEASURES FOR THE PROJECT WILL BE PERFORMED BY THE PAVING CONTRACTORS. THE CONTRACTOR SHALL COORDINATE ALL ACTIVITIES WITH THE PAVING CONTRACTOR AND ENSURE THAT EROSION PROTECTION MEASURES ARE IN PLACE PRIOR TO EXCAVATION FOR INSTALLATION OF THE SANITARY SEWER. SEE PAVING/SWD PLANS FOR ADDITIONAL INFORMATION.

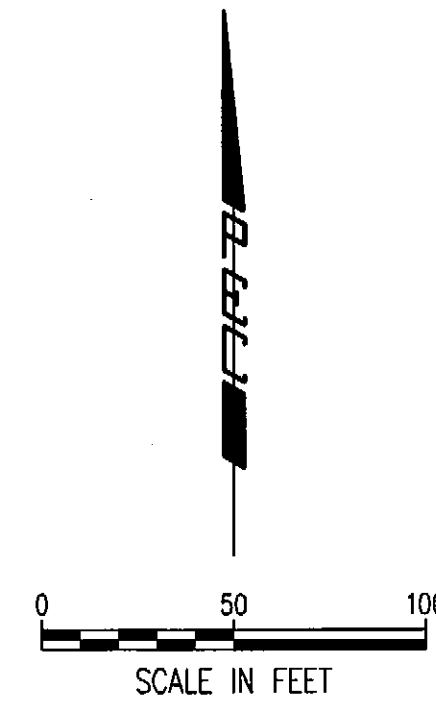

LEGEND

- EXISTING SANITARY SEWER
- PROPOSED SANITARY SEWER
- EXISTING SANITARY SEWER w/ MANHOLE
- PROPOSED SANITARY SEWER w/ MANHOLE

BENCHMARK LIST

- DATUM BM 11—CHISELED "d" ON NE CORNER OF CONCRETE TELEPHONE PEDESTAL AT SE CORNER OF BUILDING, LOCATED NORTH OF 1ST ST. AND ON THE WEST SIDE OF RAILROAD. ELEV. = 1298.97 (NGVD29)
- BM 100 —CHISELED "d" AT THE SE CORNER OF 1ST STREET AND ST. FRANCIS AVENUE, ON THE E. BACK OF SIDEWALK AND 6' S. OF TRAFFIC SIGNAL POLE. ELEV. = 1300.06
- BM 103 —CHISELED "d" ON WEST BACK SIDEWALK, WEST SIDE ST. FRANCIS AVE. AT THE SE CORNER ADDRESS 221 N. ST. FRANCIS, WEST OF FIRE HYDRANT. ELEV. = 1299.06 (NGVD29)
- BM 104 —CHISELED "d" ON SE CORNER TRAFFIC SIGNAL BASE AT THE SW CORNER OF INTERSECTION OF ST. FRANCIS AVE AND 2ND ST. ELEV. = 1298.44 (NGVD29)
- BM 104A—CHISELED "d" AT SE CORNER OF TRANSFORMER PAD NORTH SIDE OF 2ND STREET, WEST SIDE OF ALLEY BETWEEN SANTA FE AND ST. FRANCIS. ELEV. = 1299.53 (NGVD29)

CONTROL POINTS

- Pt. No. 1001
N-1686974.684373, E-1650753.348959
SET MAG NAIL IN INTERSECT CONC. JT. SANTA FE AND 2ND
1. TO NORTHEAST CORNER COLEMAN BUILDING.
2. TO SOUTH CURB 2ND STREET, WEST OF RAILROAD BRIDGE
20.2' WSW
7.0' N
- Pt. No. 1002
N-1687022.816243, E-1650421.566203
SET CHISELED "d" AT NE CORNER 2ND AND ST. FRANCIS
1. TO BACK OF CURB EAST
2. TO BACK OF CURB NORTH
7.0' S
8.0' W
- Pt. No. 1003
N-1687015.20098, E-1650222.856303
SET CHISELED "d" 3.3' NORTH OF NORTH CURB 2ND ST.
1. ALLEY BETWEEN ST. FRANCIS AND EMPORIA ST.
18.3' E
- Pt. No. 1004
N-1686618.156644, E-1650434.546946
SET MAG NAIL IN CONC. JT. @ SIDE WALK EAST OF ST. FRANCIS
1. TO SECOND STREET LIGHT NORTH OF 1ST STREET
5.0' E
- Pt. No. 1005
N-1686358.30125, E-1650437.975879
SET MAG NAIL IN CONC. JT. AT NE CORNER ST. FRANCIS AND 1ST STREET.
1. TO NORTH CURB OF 1ST STREET.
2. TO EAST CURB OF ST. FRANCIS.
6.0' S
5.5' W
- Pt. No. 1006
N: 1,686,297.0520, E: 1,650,700.3996
SET MAG NAIL IN CONC. JT. AT SW CORNER CURB INLET.
1. TO S. CURB OF FIRST STREET.
2. TO CENTERLINE OF SANTA FE STREET.
3.0' N
75.0' E
- Pt. No. 1007
N: 1,686,284.4845, E: 1,650,232.9504
SET 60D NAIL AT THE BACK OF SIDEWALK ON THE S. SIDE OF FIRST STREET.
1. TO CENTERLINE OF ALLEY BETWEEN ST. FRANCIS AND EMPORIA. 18.8' W

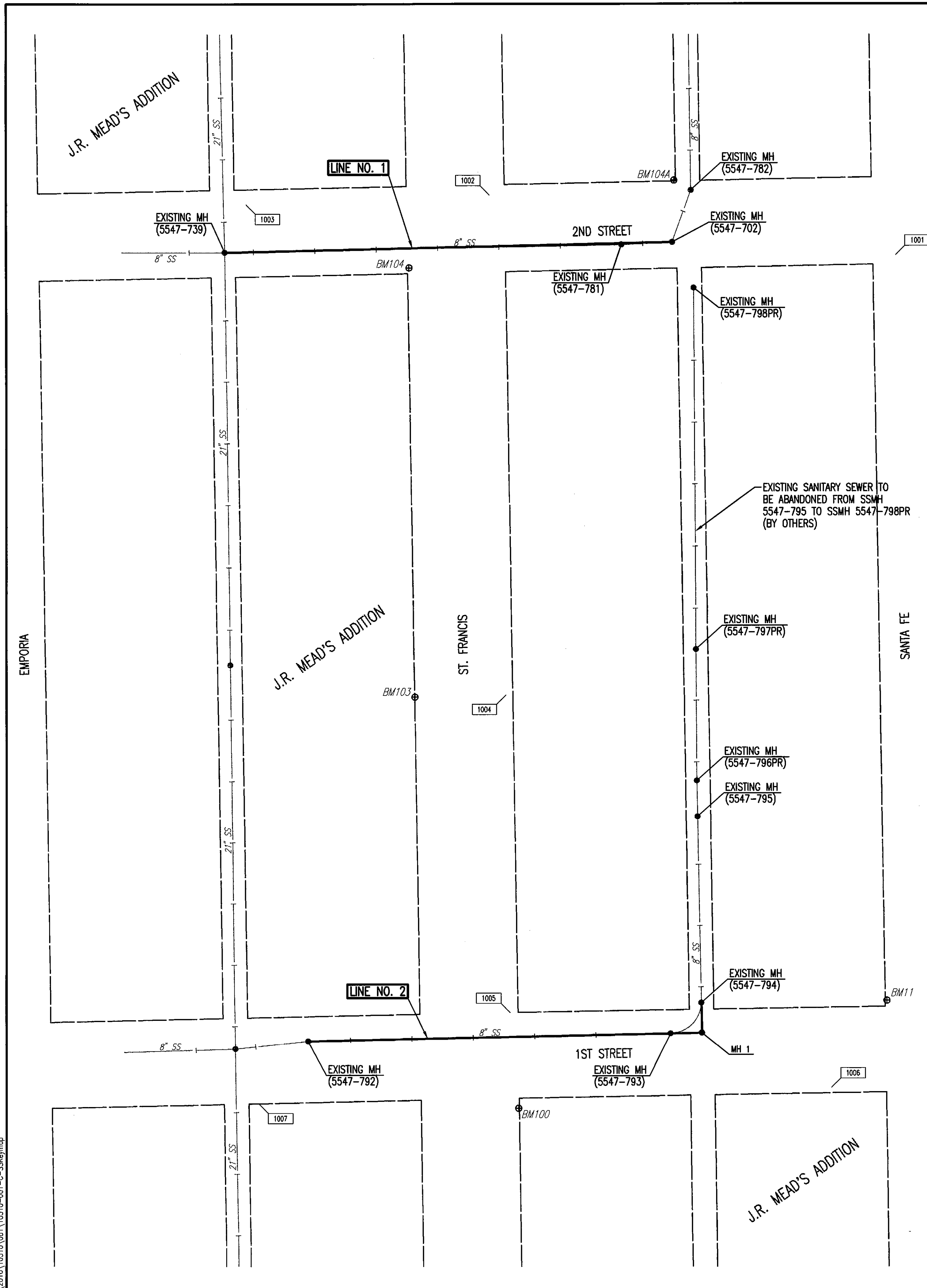

Saved 07-11-2011 3:54:52 PM by JLM
 P:\2010\10310\001\10310-001-0-SS2.dwg
 P:\2010\10310\001\10310-001-0-SS2.dwg

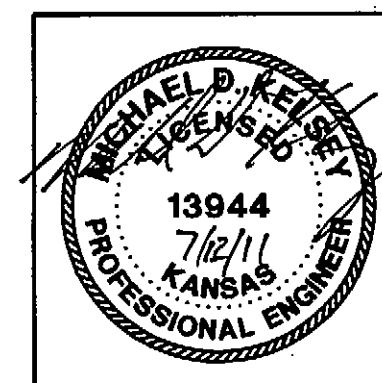

No.	Revision	By	Date

1ST & 2ND ST.—BETWEEN THE ALLEYS WEST & EAST OF ST. FRANCIS AVE.
SANITARY SEWER MODIFICATIONS

KEY MAP AND GENERAL NOTES

JAMES L. ARMOUR, P.E. — CITY ENGINEER
CITY OF WICHITA PROJECT NO. 468-84776

PEC PROFESSIONAL ENGINEERING CONSULTANTS, P.A.
303 SOUTH TOPEKA WICHITA, KS 67202
316-262-2691 www.pec1.com

Designed by	SAD	Job No.	35-10310-001	Sheet	SS2 of 6
Drawn by	JLM	Date	October 2010		