

PLAN	CHECKED	DATE
	CHECKED	

PROFILE	CHECKED	DATE
	CHECKED	

@ 1st St., Sta. 28+68.40, 14.92' Lt. = Sta. 10+00.0
 Exist. SS MH 5547-792
 Remove existing 8" SS Pipe (E) and Install New 8" PVC Pipe. Seal new 8" Pipe to MH with an approved waterstop gasket and non-shrink grout. Construct a minimum of 3' Reinforced Concrete Encasement from MH wall. This work shall be considered subsidiary to the price bid for pipe in place.

CAUTION!!!
 Traffic Signal Conduit
 8" Waterline (City of Wichita)

CAUTION!!!
 Traffic Signal Conduit

CAUTION!!!
 6" Gas Line (KGS)
 Buried Electric (Westar Energy)

@ 1st St., Sta. 31+89.96, 15.81' Lt. = Sta. 13+21.6
 Const. MH 1
 Type "P" MH

CAUTION!!!
 Buried Electric (Westar Energy)

@ 1st St., Sta. 31+89.85, 40.32' Lt. = Sta. 13+46.1
 Exist. SS MH 5547-794
 Remove existing MH in it's entirety and Connect new 8" pipe to existing 8" VCP with an approved non-shear coupling, per manufacturers recommendations. Fill any over excavated area's, below the pipe zone, with AB-3 compacted to 95% ASTM D698. Backfill with Jetted Sand.

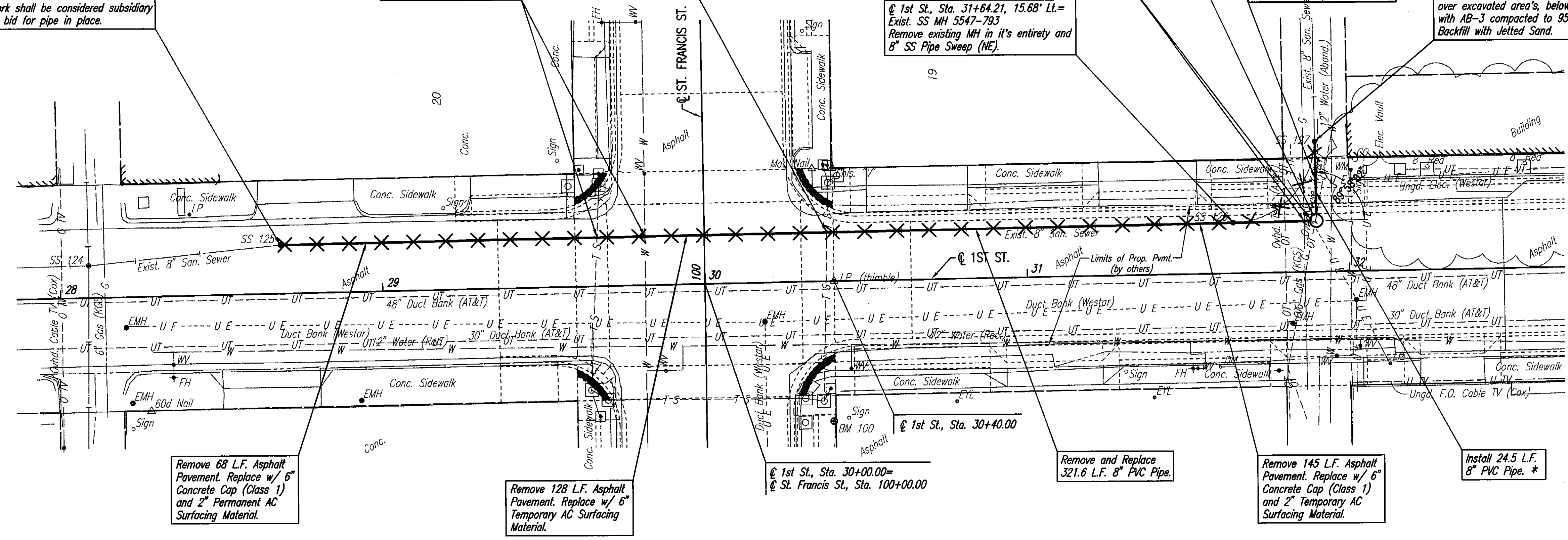

NOTE: CONTRACTOR SHALL VERIFY LOCATIONS AND DEPTHS FOR ALL UTILITIES.
 SEE SHEET NO. R56 FOR CONSTRUCTION SEQUENCING.
 SEE COORDINATE GEOMETRY PLAN FOR STREET CENTERLINE CONTROL.

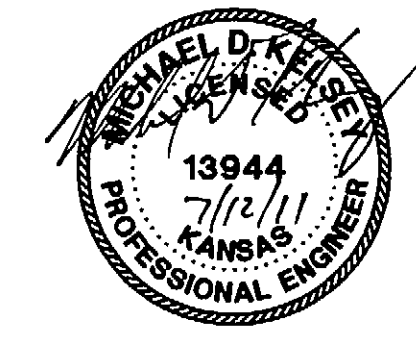

* CONTRACTOR SHALL VERIFY LOCATION OF AN EXISTING SEWER SERVICE LINE, FOR 624 E. 1ST STREET, THAT IS TAPPED INTO THE EXISTING SWEEP THAT IS SCHEDULED TO BE REMOVED. THE SEWER SERVICE LINE SHALL BE CONNECTED TO THE NEW 8" PIPE PER CITY OF WICHITA SPECIFICATIONS.

X - Denotes Sanitary Sewer to be removed.

SANITARY SEWER LINE NO. 2

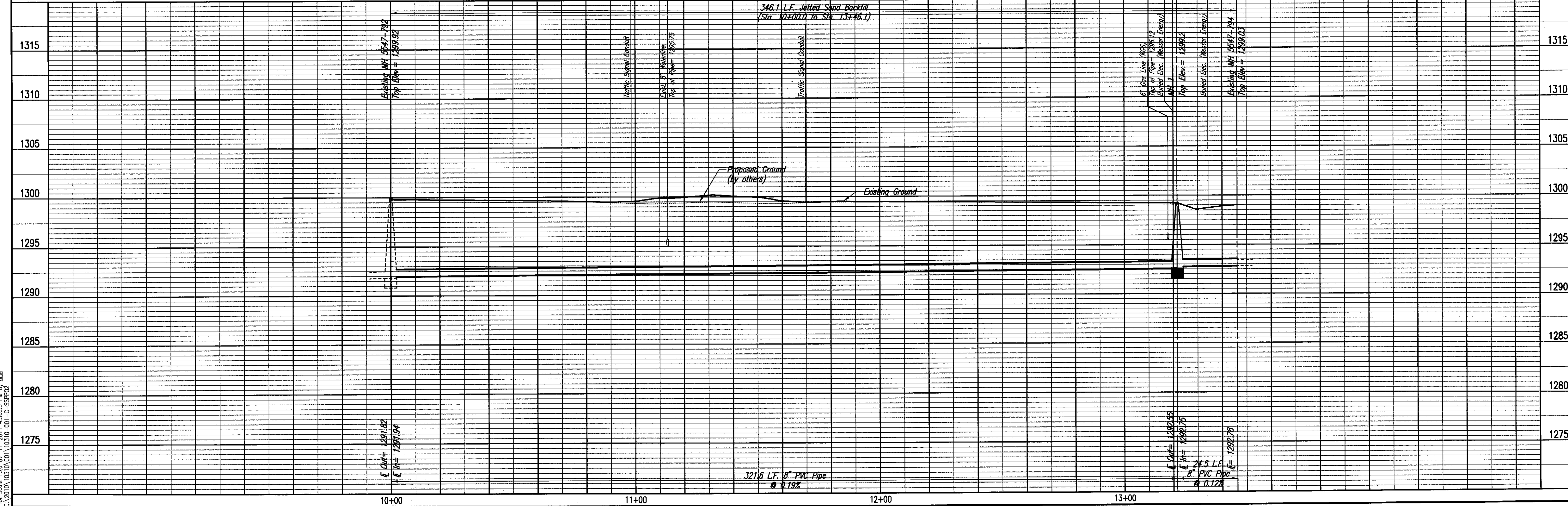

Revised 07-11-2011, 4:00:37 PM by JLM
 Plot Scale: 1/20 (0.7" = 11'-0") 4:36:53 PM by JLM
 0:\2010\10310\001\10310-01-C-SSPROZ

1ST ST. - BETWEEN THE ALLEYS WEST & EAST OF ST. FRANCIS AVE.
 SANITARY SEWER MODIFICATIONS
 SANITARY SEWER LINE NO. 2

DESIGNED BY: JLM
 CHECKED BY: JLM
 DATE: October 2010

PROFESSIONAL ENGINEERING CONSULTANTS, P.A.
 305 SOUTH TOPICKA, WICHITA, KS 67202
 316-262-2881 www.pec.com

Job No. 35-10310-001
 Date October 2010

Sheet SS4 of 6