

BENCHMARKS:
 BM #1: 135th St. W. & Pawnee
 City of Wichita Benchmark Disc,
 northeast corner of intersection on SW
 corner of concrete base of high line
 pole.
 Elev. = 1359.65 NGVD29

BM #2: City of Wichita Benchmark Disc,
 0.4 Mi. South of Kellogg on 135th St.
 W., west side of concrete base for high
 line pole, west of K.G.&E. Substation,
 135'± south of railroad tracks on east
 side of 135th St. W.
 Elev. = 1367.77 NGVD29

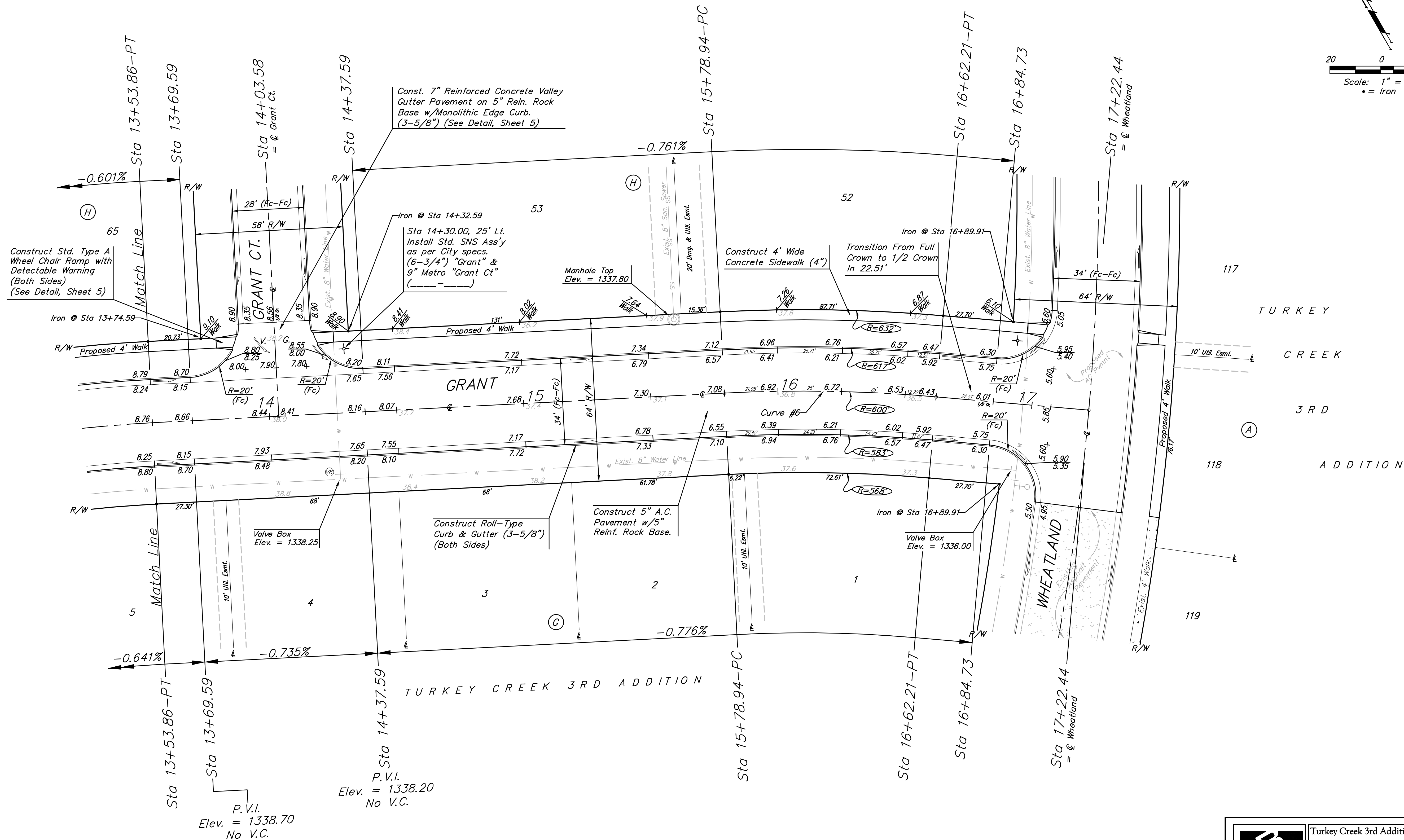
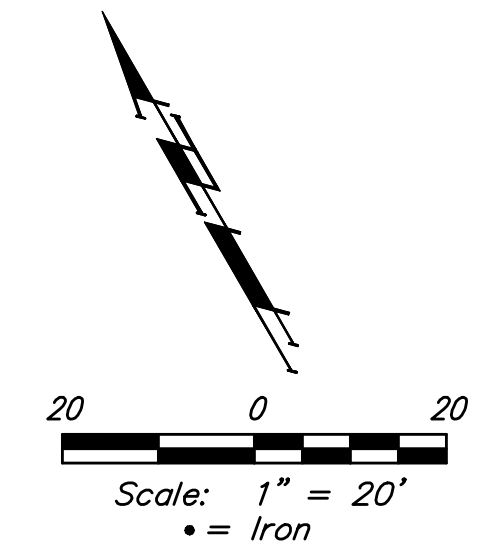

Curve #6
 Curve Data Based on Centerline
 Rad. = 600' Delta = 75°05' Tangent = 41.70'
 Arc = 83.27' L.C. = 83.20' Def./Pt. = 2.86468 Min.

Station	Arc	Face Chord Lengths		Def.	Total Def.
		8' Left	8' Right		
15+78.95	-	-	-	0'00"00"	0'00"00"
16+00.00	21.05'	21.93'	20.17'	1'00"18"	1'00"18"
16+25.00	25.00'	26.04'	23.96'	1'11"37"	2'11"55"
16+50.00	25.00'	26.04'	23.96'	1'11"37"	3'23"32"
16+62.22	12.22'	12.73'	11.71'	0'35"01"	3'58"33"

Roll type curb & gutter to be constructed on the pavement on this sheet.
 Top of curb elevation are given for full height curb.

	Turkey Creek 3rd Addition - Phase II	
	GRANT STA 13+53.86 TO STA 17+22.44	
<small>Baughman Company, P.A. 315 Ellis St. Wichita, KS 67211 F 316362771 F 316362049 ENGINEERING SURVEYING PLANNING LANDSCAPE ARCHITECTURE</small>		
PROJECT NUMBER 47284487	DESIGN JAK	DRAWN TMS/JAK
REVISIONS:	APPROVED DATE 7/26/11	SCALE Noted SHEET 11 OF 42