

STATE	PROJECT NO.	YEAR	SHEET NO.	TOTAL SHEETS
KANSAS	472-84923	2011	II	42

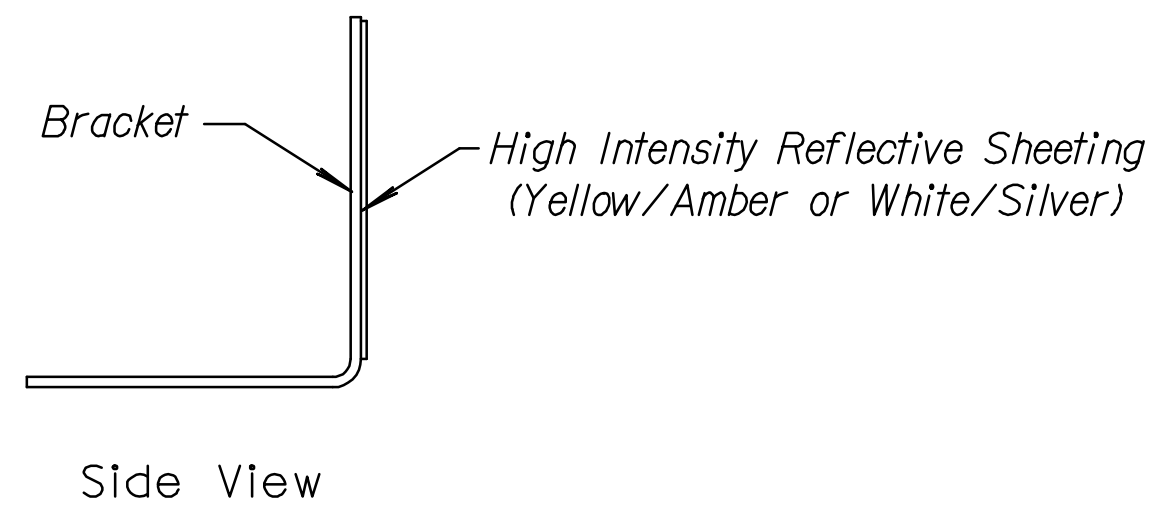

Flexible Guardrail Marker
One-Way Traffic

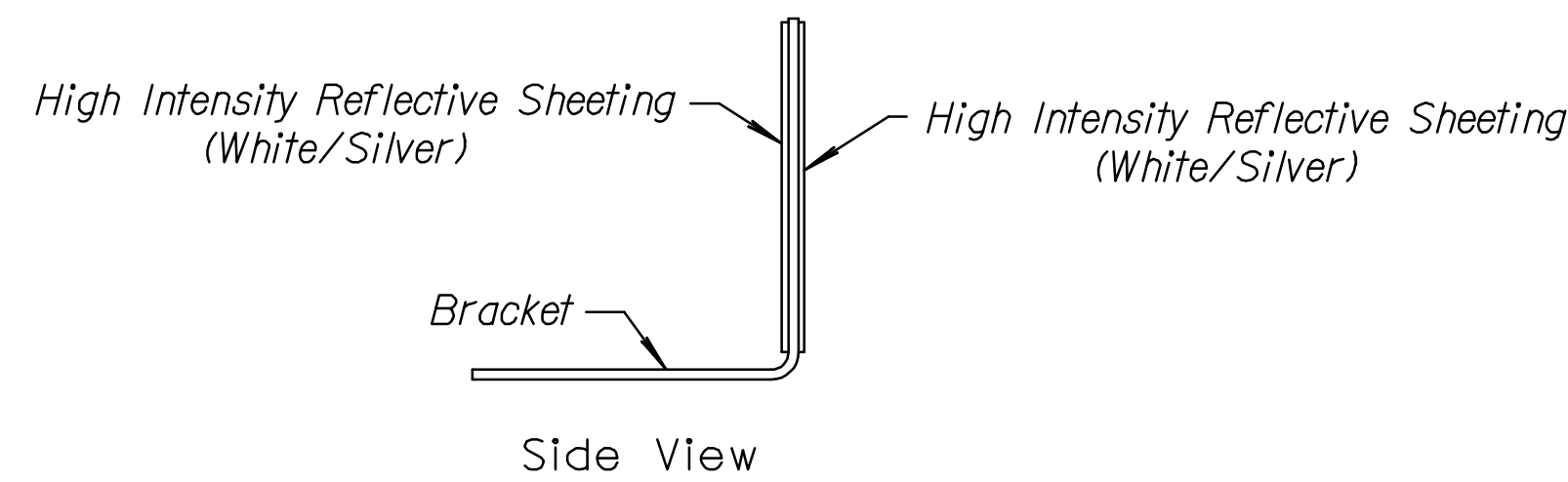

Flexible Guardrail Marker
Two-Way Traffic

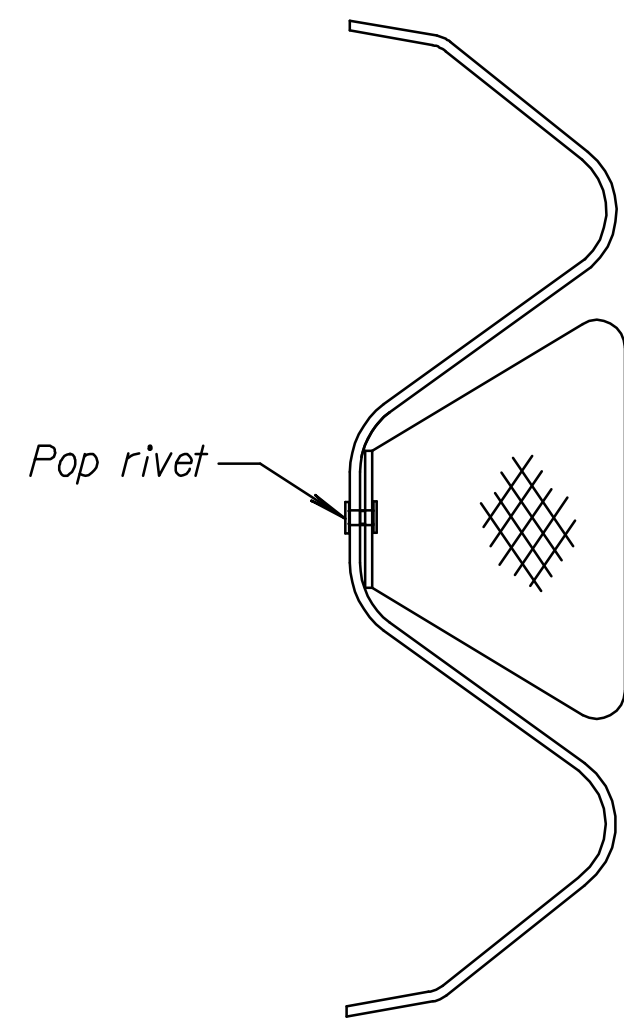

Typical Mounting on W-Beam
Pop rivet attachment to Guardrail when necessary.

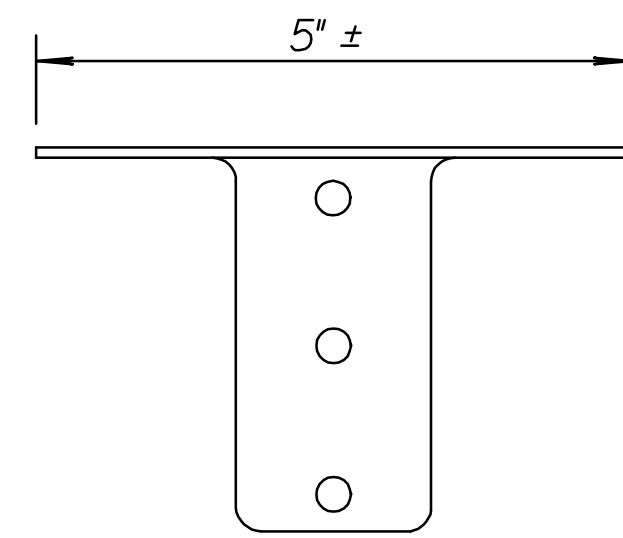

Top View
Barrier/Bridges

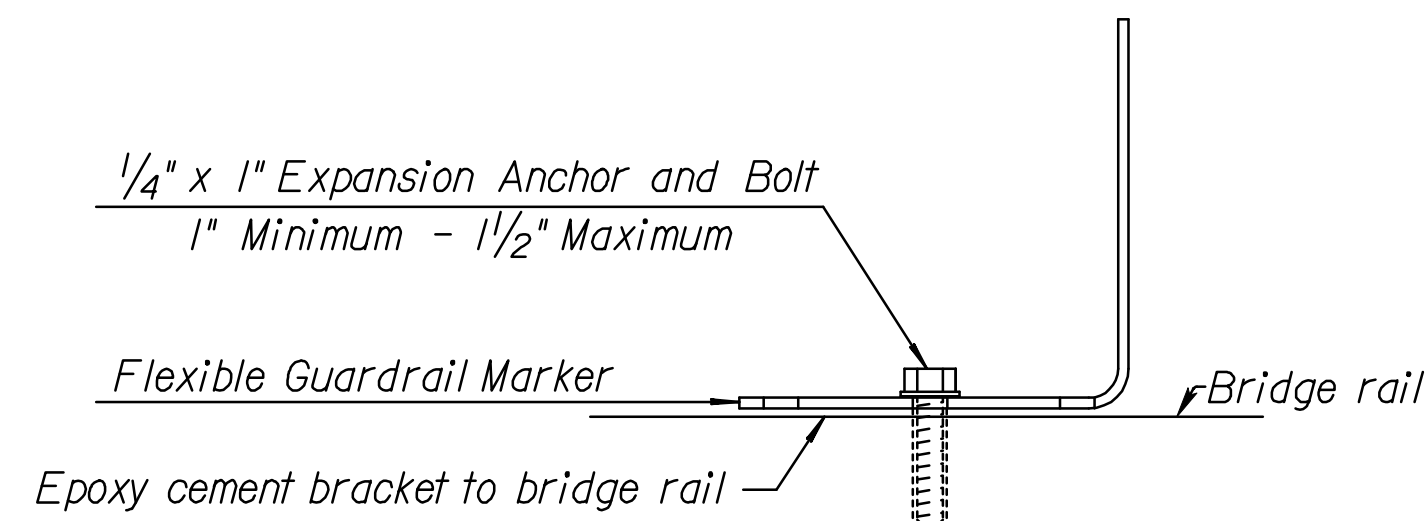

Method of Attaching Flexible
Guardrail Marker to Bridge Rail

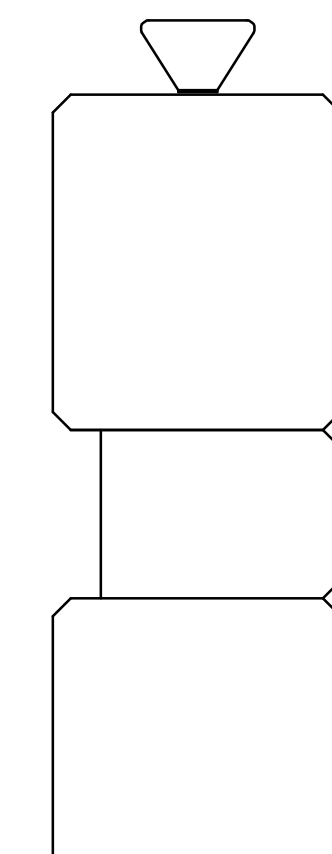

Typical Mounting on
Corrugated Rail

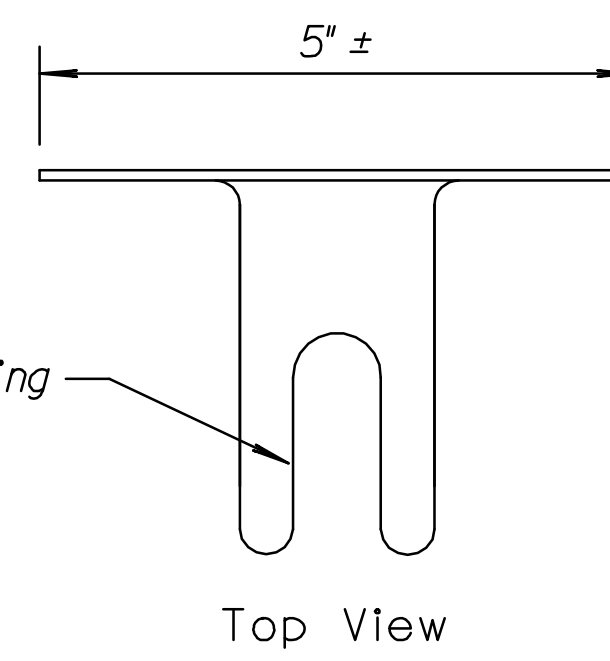

Slot fits under existing
guardrail post bolt

Top View

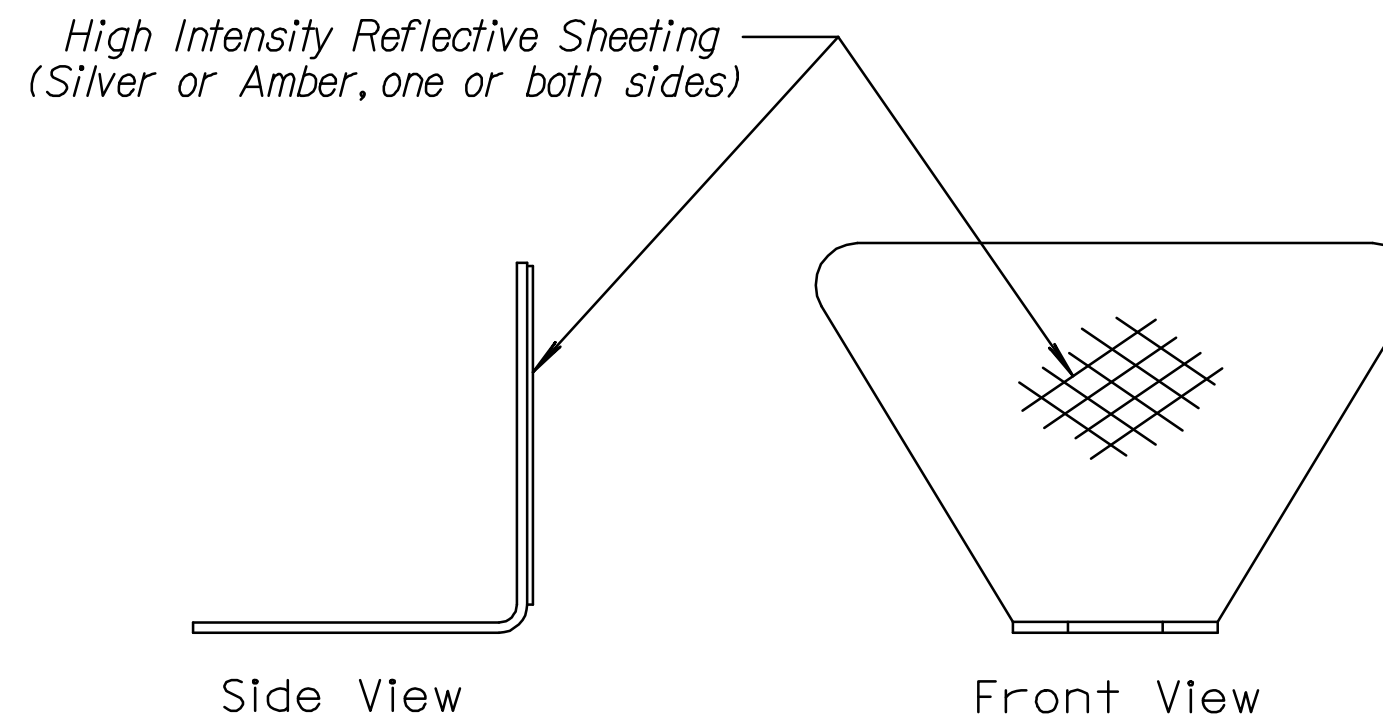

Side View

Front View

Flexible Guardrail Marker
(High Impact Polycarbonate approx.
.085" thick, 5 1/4" x 3")

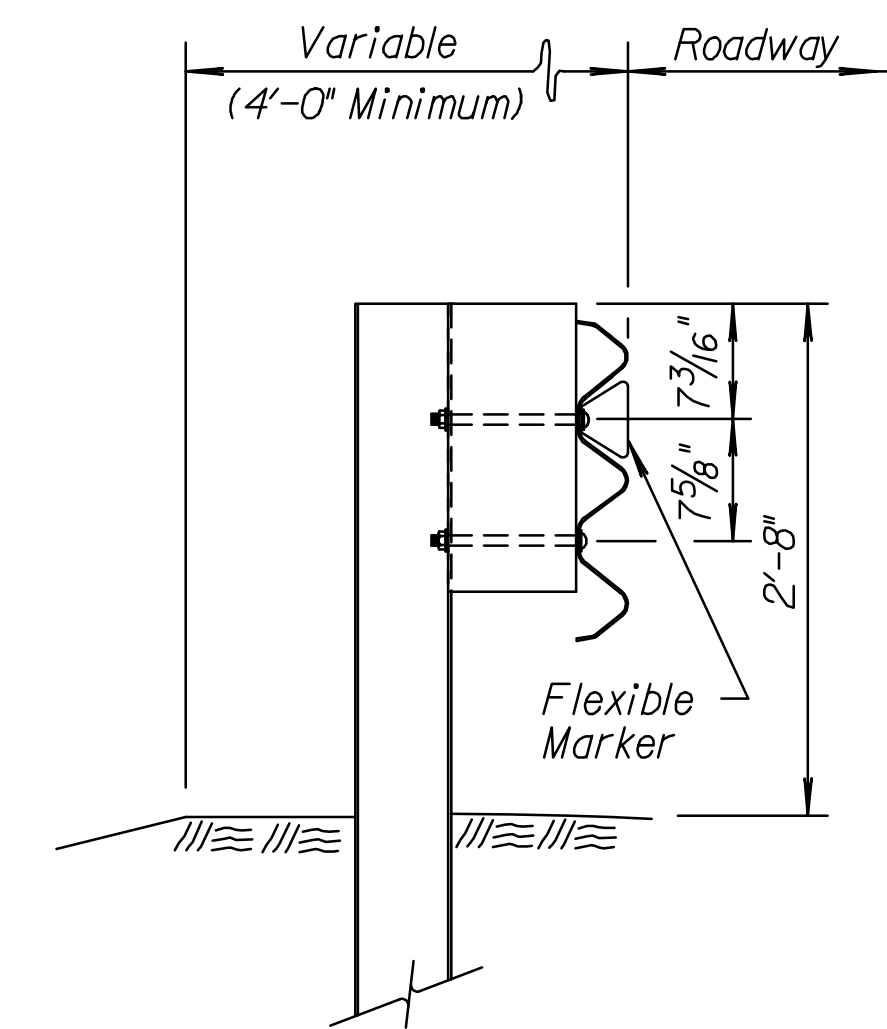

Flexible Marker Mounting
on Three Beam Guardrail

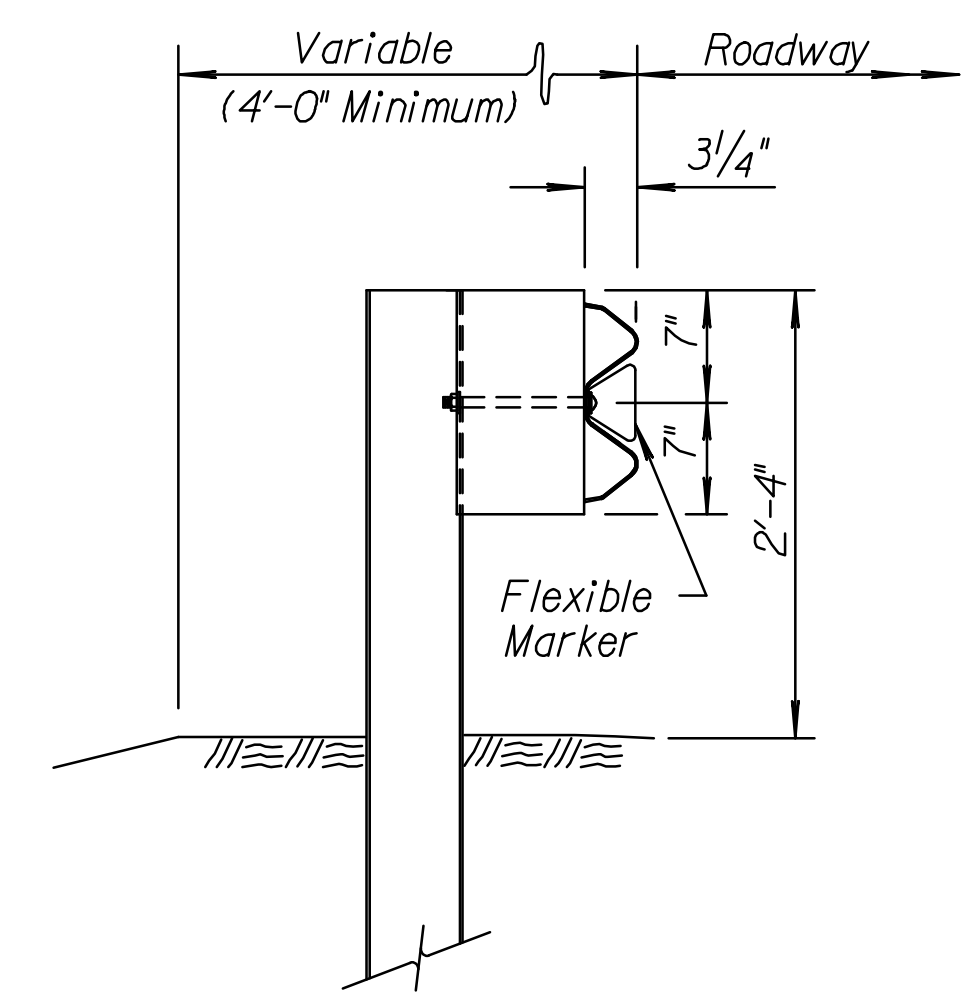

Flexible Marker Mounting
on W-Beam Guardrail

General Notes

Markers shall be installed on the traffic side of all guardrail installations. Spacing between markers shall not exceed 25 feet. No marker shall be located between the head and post 5 when the guardrail is terminated with a crashworthy end terminal. Flexible Markers should be installed on a post behind guardrail bolt head.

Markers shall be installed on the top of bridge rails at a spacing not to exceed 50' except for long bridges (greater than 200' long) where the spacing may be increased to 100'.

Flexible markers shall have High Intensity Reflective Sheeting on both sides on two-way roadways. All markers used on two-way roadways shall be white/silver.

When used on one-way or divided roadways flexible markers shall be installed on the approach traffic side of the bracket only. Marker color shall be yellow/amber when used on the left side and white/silver when used on the right side of the roadway.

The High Impact Polycarbonate Flexible Guardrail Marker with High Intensity Reflective Sheeting shall comply with the KDOT Standard Specifications. AKT Marker or approved equivalent marker shall be installed.

All hardware used for the connections shall comply with the KDOT Standard Specifications. All fasteners shall be either zinc or cadmium plated.

All work and materials required for the installation of the markers on guardrail and bridge rails shall be Subsidiary to the bid item "Steel Plate Guardrail".

On projects with staged construction, such as a divided highway with one side closed and two-way traffic during construction, flexible markers shall be installed for the final (permanent) traffic configuration.

NO.	DATE	REVISIONS	BY	APP'D
7	12-21-09	AKT marker or approved equal	S.W.K.	J.O.B.
6	3-10-09	Add. Flexible rem. Button Dellneator	S.W.K.	J.O.B.
5	7-20-04	Changed Guard fence to Guardrail	S.W.K.	J.O.B.
4	5-5-00	Added note for temporary traffic	R.J.S.	J.O.B.

KANSAS DEPARTMENT OF TRANSPORTATION			
MARKER DETAILS FOR GUARDRAIL AND BRIDGE RAILS			
RD610			
DESIGNED	6-30-09	APP'D. James O. Brewer	
DESIGN CK.	DETAIL CK.	QUANTITIES	TRACE CK. S.W.K.