

PAVING PLANS
BERKELEY SQUARE FIRST ADDITION
HOME BANK & TRUST ADDITION

EROSION CONTROL

SHEET TITLE
472-84975
PROJECT NUMBER

DFL / KKL / GJA
DESIGNED / DRAWN / CHECKED

ISSUED
August 2011

REVISED

SHEET NO.

10 of 21

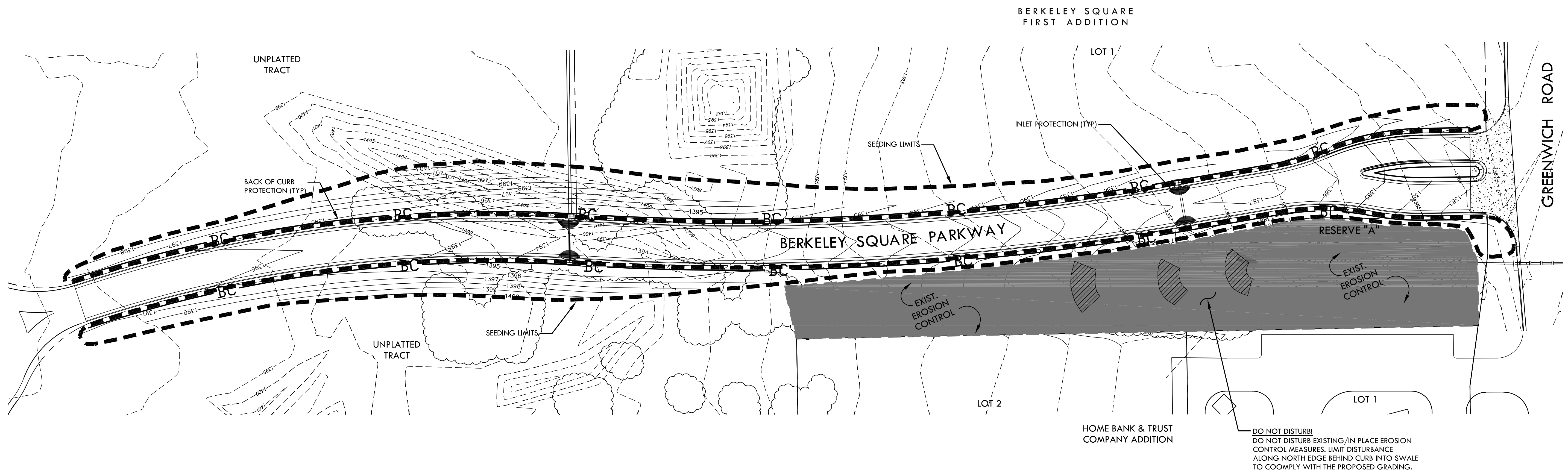

SEEDING NOTES

TEMPORARY SEEDING
THE CONTRACTOR SHALL SEED AND FERTILIZE ALL DISTURBED AREAS (REGARDLESS OF TIME OF YEAR EXCEPT IN THE PREFERRED PERMANENT SEEDING WINDOW WHICH THE PERMANENT SEEDING SHALL BE COMPLETED) AS FOLLOWS:
PERENNIAL RYE @ 150 LBS./ACRE
10-20-10 @ 150 LBS./ACRE

PERMANENT SEEDING
AREAS NOTED AS FESCUE SHALL BE KANSAS PREMIUM BLEND FESCUE SEED AT A RATE OF 8 LB/1,000 SF. APPLY FERTILIZER PER SEED DISTRIBUTOR RECOMMENDATIONS. THE PREFERRED SEEDING TIME IS SEPTEMBER 1ST - OCTOBER 15TH, BUT MAY BE COMPLETED AT ANY TIME WITH THE APPROVAL OF THE ENGINEER UPON AGREED CONDITIONS.

- BOTH TEMPORARY AND PERMANENT SEEDING SHALL BE PREPARED FOR PLANTING WITH COMMON AGRICULTURAL TECHNIQUES. ALL AREAS SHALL BE FINE GRADED USING SMALL EQUIPMENT. REMOVE EXISTING GRASS, VEGETATION, AND TURF. DO NOT MIX INTO SURFACE SOIL. LOOSEN SOIL TO A DEPTH OF AT LEAST 6". GRADE AREAS TO A SMOOTH UNIFORM SURFACE PLANE. ROLL, RAKE, AND REMOVE RIDGES AND FILL DEPRESSIONS, THE SURFACE SHALL BE FREE FROM STICKS, SMALL STONES, AND OTHER EXTRANEIOUS MATERIALS. APPROVE WITH OWNER'S REPRESENTATIVE BEFORE PLANTING.
- ALL SEED SHALL BE DISTRIBUTED WITH AN ACCEPTABLE DRILL INTENDED FOR SUCH OPERATIONS, OR OTHER EQUIPMENT OR METHODS APPROVED BY THE OWNER'S REPRESENTATIVE. SEEDING DEPTH SHALL BE 1/4".
- BROADCASTING WILL BE ALLOWED IN INACCESSIBLE AREAS TO THE DRILL ONLY AFTER GROUND IS DISTURBED TO CREATE A SUITABLE SEEDBED. SEEDING DEPTH SHALL BE 1/4".
- ALL SEEDED AREAS SHALL BE IMMEDIATELY MULCHED W/ CLEAN PRAIRIE HAY OR STRAW AT 2 TONS/ACRE. ANCHOR MULCH BY CRIMPING INTO TOPSOIL WITH SUITABLE MECHANICAL EQUIPMENT.
- SEEDING SHALL NOT BE COMPLETED DURING PERIODS OF RAIN, SEVERE DROUGHT, HIGH WINDS, EXCESSIVE MOISTURE, FROZEN GROUND, OR OTHER CONDITIONS THAT PRECLUDE SATISFACTORY RESULTS.
- ANY WASHOUT THAT OCCURS SHALL BE RE-GRADED AND RE-SEEDED AT THE CONTRACTOR'S EXPENSE UNTIL A GOOD SOD IS ESTABLISHED.

EROSION CONTROL NOTES

- EROSION CONTROL IS TO MEET ALL FEDERAL, STATE, COUNTY & LOCAL CODE STANDARDS.
- CONTRACTOR SHALL PROVIDE AND PRESERVE EROSION PROTECTION THROUGHOUT PROJECT CONSTRUCTION. THE PLAN PROVIDED HERE IS FOR FINAL PROTECTION, VARIOUS PHASES OF THIS PLAN SHALL BE IMPLEMENTED OR MODIFIED TO CONTROL EROSION. MODIFICATIONS OF THE PLAN SHALL BE APPROVED BY THE OWNERS REPRESENTATIVE.
- CONTRACTOR IS RESPONSIBLE FOR MAINTAINING AND IMPLEMENTING ALL EROSION CONTROL.
- CONTRACTOR SHALL INSTALL AND MAINTAIN A STABILIZED CONSTRUCTION ENTRANCE AT A LOCATION DETERMINED BY THE ENGINEER.
- EROSION CONTROL MAT SHALL BE NORTH AMERICAN GREEN SC-150 OR APPROVED EQUAL. INSTALL PER MANUFACTURER'S RECOMMENDATIONS.

CONSTRUCTION SEQUENCING

- CLEARING/GRUBBING - STABILIZED ENTRANCE IMPLEMENTED/ SILT BARRIER INSTALLED
- SANITARY SEWER CONSTRUCTION
- GRADING
- WATERLINE CONSTRUCTION
- STORM SEWER CONSTRUCTION/ INLET PROTECTION IMPLEMENTED
- PAVING CONSTRUCTION/ BACK OF CURB PROTECTION IMPLEMENTED
- BUILDING DEVELOPMENT UPON COMPLETION OF GRADING AND CONSTRUCTION OF UTILITIES
- FINAL STABILIZATION/ BACK OF CURB PROTECTION REMOVED
- SILT BARRIER REMOVED
- STABILIZED ENTRANCE REMOVED

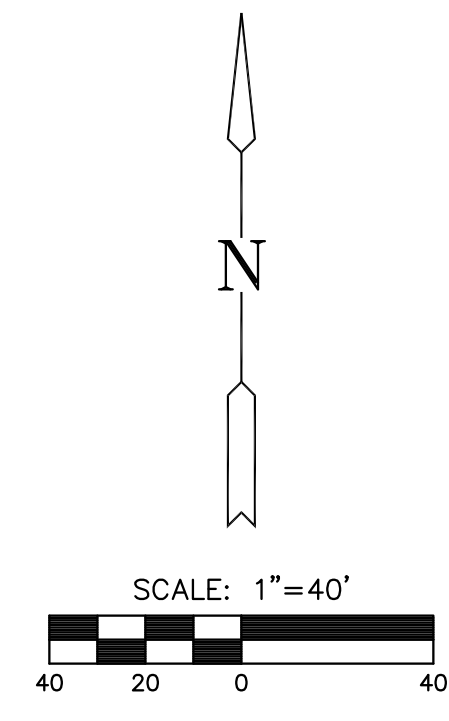

NOTE: ACTUAL IN FIELD QUANTITIES MAY VARY DEPENDING UPON ACTUAL CONTRACTOR DISTURBANCE. (COST SUBSIDIARY TO PROJECT)

LEGEND

- SEEDING LIMITS (1.0 AC.)
- BACK OF CURB PROTECTION- CURLEX (2320 L.F.)
- INLET PROTECTION (4)