

# STORM SEWER LINE PLANS

TO SERVE



## MARKET STORE #5873-01

13TH STREET NORTH & OLIVER AVENUE

WICHITA, SEDGWICK COUNTY, KANSAS

PROJECT NO. 0045 PPD (607861)

2011

APPROVED AS NOTED  
BY CITY ENGINEER OF WICHITA:  
Stormwater Engineering *[Signature]* 9-21-11

OWNERS' ADDRESS

WAL-MART STORES, INC.  
702 S.W. 8th STREET  
BENTONVILLE, AR 72716  
PH. (479) 273-4000

SHEET INDEX

C-9.0	TITLE SHEET
C-9.1	STORM SEWER LOCATION PLAN
C-9.2	ERU PLAN
C-9.3	PROPOSED DRAINAGE PLAN
C-9.4	PROPOSED WATERSHED & STORM SEWER SUMMARY
C-9.5	STORM SEWER LINE 'A' PLAN & PROFILE
C-9.6	DETENTION POND PLAN
C-9.7	MANUFACTURE'S DETAILS & MODIFIED SINGLE/DOUBLE DROP INLET W/SWO DEVICE
C-9.8	SUMP PUMP DETAILS
C-9.9	STORM SEWER DETAILS
C-9.10	STORM SEWER DETAILS
C-9.11	DESIGN OF INLET DETAILS

CITY RESOURCE LIST

<b>CITY MANAGER</b> CITY MANAGER'S OFFICE CITY OF WICHITA 455 N. MAIN - CITY HALL WICHITA, KS 67202 CONTACT: ROBERT LAYTON PH: (316) 268-4351 FAX: (316) 858-7712	<b>CITY ENGINEER</b> PUBLIC WORKS CITY OF WICHITA 455 N. MAIN - CITY HALL WICHITA, KS 67202 CONTACT: JIM ARMOUR PH: (316) 268-4266 FAX: (316) 268-4114	<b>PLANNING / ZONING</b> METROPOLITAN AREA PLANNING DEPARTMENT CITY OF WICHITA 455 N. MAIN - CITY HALL WICHITA, KANSAS 67202 CONTACT: BILL LONGNECKER PH: (316) 268-4494 FAX: (316) 268-4390
<b>GAS</b> BLACK HILLS ENERGY 1611 SOUTH HOOVER WICHITA, KS 67209 CONTACT: CALVIN BRIGGS PH: (316) 941-1608 FAX: (316) 942-7096	<b>TELEPHONE</b> AT&T 154 NORTH BROADWAY ROOM 210 WICHITA, KS 67202 CONTACT: MARK OLSEN PH: (316) 268-2105 FAX: (316) 268-3110	<b>ELECTRIC</b> WESTAR ENERGY P.O. BOX 208 WICHITA, KS 67201 CONTACT: SHANE PRICE PH: (316) 261-6824 FAX: (316) 261-6979
<b>SANITARY SEWER</b> PUBLIC WORKS CITY OF WICHITA 455 N. MAIN - CITY HALL WICHITA, KANSAS 67202 CONTACT: BILL PERKINS PH: (316) 268-4555 FAX: (316) 268-4114	<b>WATER</b> PUBLIC WORKS CITY OF WICHITA 455 N. MAIN - CITY HALL WICHITA, KANSAS 67202 CONTACT: BILL PERKINS PH: (316) 268-4555 FAX: (316) 268-4114	<b>STORM SEWER</b> STORM WATER UTILITY CITY OF WICHITA 455 N. MAIN - CITY HALL WICHITA, KS. 67202 CONTACT: SCOTT LINDEBAK PH: (316) 268-4909 FAX: (316) 268-4114

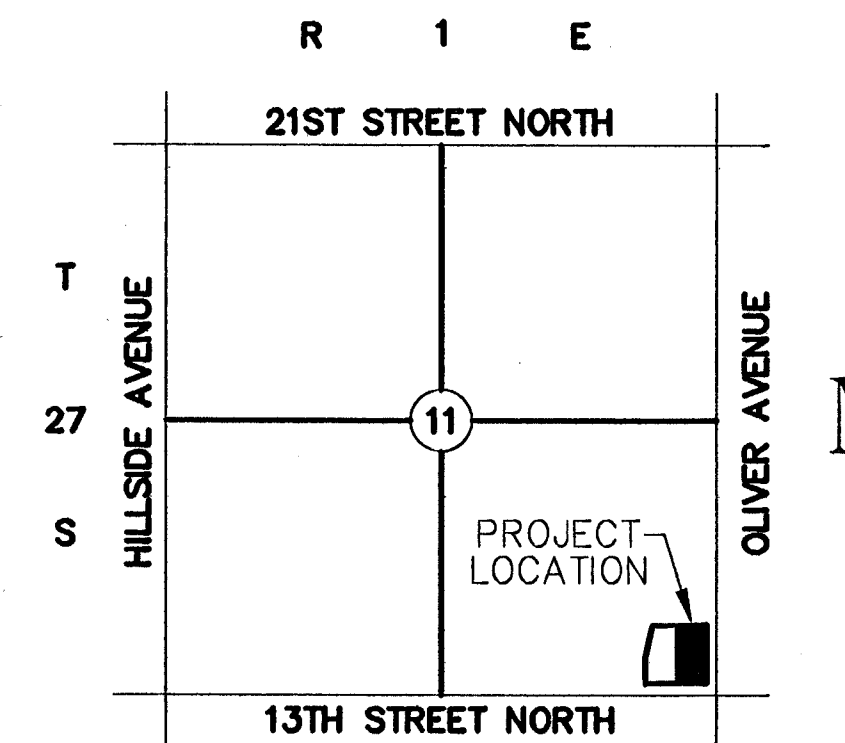

LOCATION MAP  
NOT TO SCALE

EROSION CONTROL PLANS ARE PROVIDED IN THE SITE DEVELOPMENT PLANS MARKET STORE #5873-01 AND ARE AVAILABLE UPON REQUEST FROM THE ENGINEER

**ALERT TO CONTRACTOR:**

1. THE SITEWORK FOR THE WALMART PORTION OF THIS PROJECT SHALL MEET OR EXCEED THE "SITE SPECIFIC SPECIFICATIONS."
2. ALL NECESSARY INSPECTIONS AND/OR CERTIFICATIONS REQUIRED BY CODES AND/OR UTILITY SERVICE COMPANIES SHALL BE PERFORMED PRIOR TO CONTRACT COMPLETION AND THE FINAL CONNECTION OF SERVICES.

BENCH MARKS

SITE BENCHMARK-1  
"V" Chiselled on Conc.  
NE Prop. Corner  
Elevation=1398.36  
DATUM = NAVD 1988

REFER STORM SEWER LOCATION PLAN SHEET C-9.1 FOR BENCHMARK LOCATION

- (1) An effort has been made to locate and show approximate location of underground utility lines. Buried utilities are not necessarily shown. It is the Contractors responsibility to locate and preserve all utility services.
- (2) Proposed utility services have been coordinated with the local utility companies. Contractor is responsible for contacting all utility companies prior to construction.
- (3) All quantity estimates shown in this set of plans are the Engineer's estimate and are provided for general information only! The contractor is solely responsible for calculating his/her own quantities!
- (4) Contractor shall acquire Licensing to work in City of Wichita, shall maintain Insurance Verification per Walmart and City's requirements and shall submit necessary bonds to satisfy City of Wichita's requirements.

**NOTE TO CONTRACTOR**  
CALL KANSAS ONE  
1-800-522-6543

This number is to be used for information on the location of all underground utilities. Contact this number prior to any excavation.

I, Terence L. Haynes, Kansas Professional Engineer, #14583, do hereby state that these Storm Sewer Line plans, prepared by me or under my direct, responsible supervision, are in strict conformance with the applicable Codes of the City of Wichita and the sound principles and practice of the Civil Engineering profession

*[Signature]*

TERENCE L. HAYNES, P.E. #14583

**SMC Consulting Engineers, P.C.**

Oklahoma City, Oklahoma

TITLE SHEET	
STORM SEWER LINE PLANS	
WALMART MARKET #5873-01	
13TH STREET NORTH & OLIVER AVENUE WICHITA, KANSAS	
SMC Consulting Engineers, P.C. <b>SMC</b> 815 West Main - Oklahoma City, OK 73106 PH: 405-232-7715 Fax: 405-232-7859 KANSAS CERTIFICATE OF AUTHORIZATION NO. E-335 EXP. Dec. 31, 2011	
No. / Revision	By / Date
1 / SMC review comments	MDS / 03/04/11
2 / Addendum #1 - City review comments	MDS / 08/26/11
DATE: 04/20/11	SCALE: NTS
DRAWN BY: MDS	PROJECT NO.: 4938.30
ENGINEER: TERENCE L. HAYNES, P.E. #14583	SHEET NO. C-9.0

