

STATE	PROJECT NO.	YEAR	SHEET NO.	TOTAL SHEETS
KANSAS	87 N-0243-01	2005	19	169

Federal Aid No. STP N024(301)

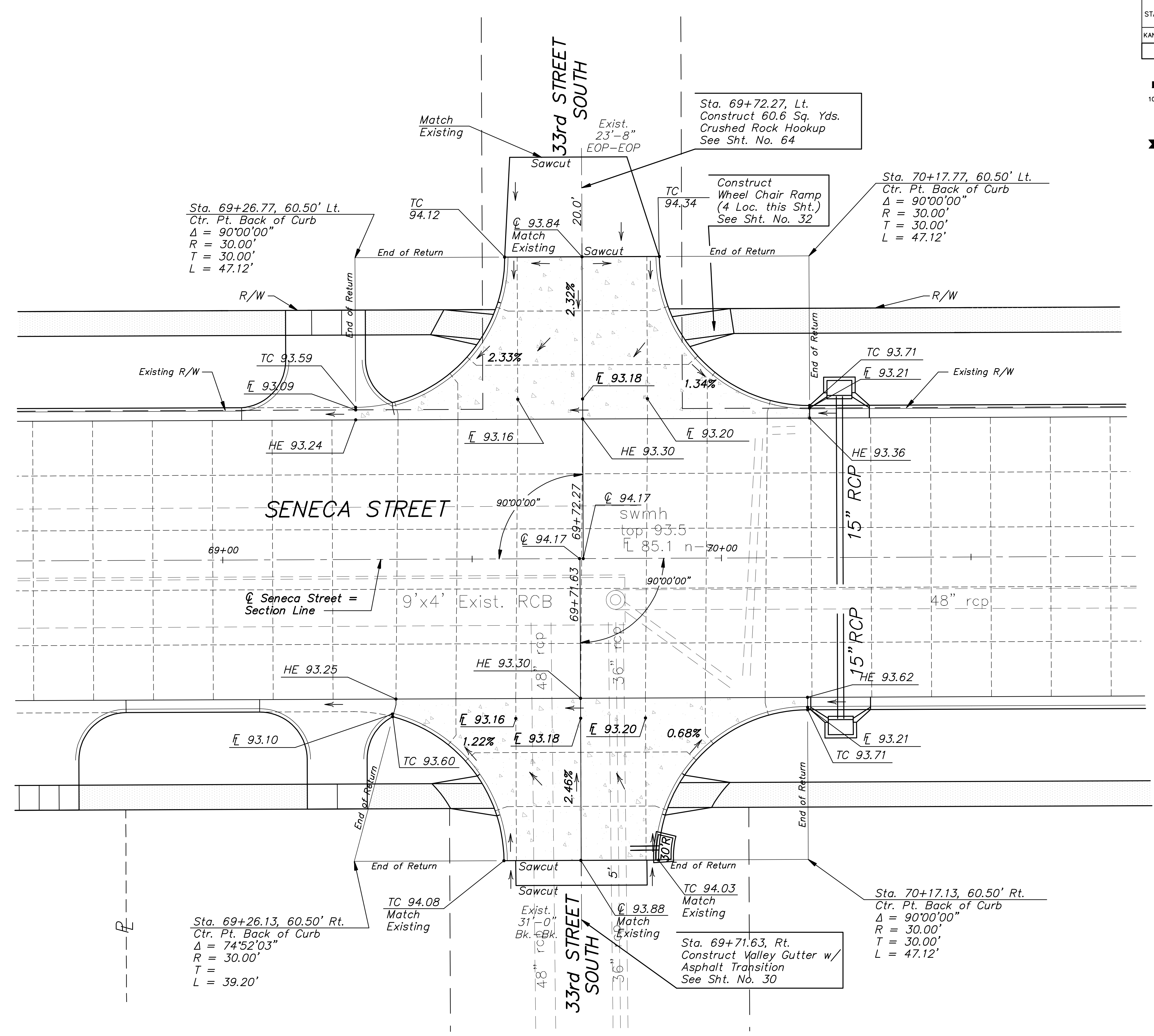
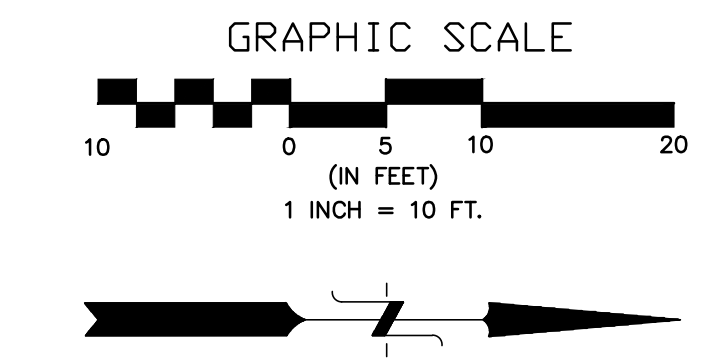

Sta. 69+26.77, 60.50' Lt.  
Ctr. Pt. Back of Curb  
 $\Delta = 90^{\circ}00'00''$   
 $R = 30.00'$   
 $T = 30.00'$   
 $L = 47.12'$

Sta. 69+72.27, Lt.  
Construct 60.6 Sq. Yds.  
Crushed Rock Hookup  
See Sht. No. 64

Construct  
Wheel Chair Ramp  
(4 Loc. this Sht.)  
See Sht. No. 32

Sta. 70+17.77, 60.50' Lt.  
Ctr. Pt. Back of Curb  
 $\Delta = 90^{\circ}00'00''$   
 $R = 30.00'$   
 $T = 30.00'$   
 $L = 47.12'$

Sta. 69+26.13, 60.50' Rt.  
Ctr. Pt. Back of Curb  
 $\Delta = 74^{\circ}52'03''$   
 $R = 30.00'$   
 $T =$   
 $L = 39.20'$

Sta. 69+71.63, Rt.  
Construct Valley Gutter w/  
Asphalt Transition  
See Sht. No. 30

Sta. 70+17.13, 60.50' Rt.  
Ctr. Pt. Back of Curb  
 $\Delta = 90^{\circ}00'00''$   
 $R = 30.00'$   
 $T = 30.00'$   
 $L = 47.12'$

No.	Date	By	Approved	Revision

SENECA STREET  
1-235 TO 31ST STREET  
CITY OF WICHITA, KANSAS  
INTERSECTION DETAIL - 33RD STREET SOUTH

POE & ASSOCIATES, INC.  
CONSULTING ENGINEERS  
5940 E. Central, Suite 200 □ Wichita, KS  
67208-4242  
Phone: 316/685-4114 □ FAX: 316/685-4444

FINAL

Engineer: P. FERGUSON  
Designer: J. UNRUH  
KDOT Job No.: 87 N-0243-01    Poe Job No.: 1794  
Date: JANUARY 2010

Sheet  
19 of 169