

PAVING & INCIDENTAL DRAINAGE PLANS
FOX RIDGE ADDITION
PHASE 14

NOTE: ALL RIPRAP SHALL BE INSTALLED TO STANDARD SPECIFICATIONS WITH TOE WALLS ON ALL UNPROTECTED EDGES. THE TOE WALL SHOWN ON THE PLANS SHALL BE IN ADDITION TO STANDARD SPECIFICATIONS.

STA. 10+25.4, LINE 1
INSTALL 36" RESTRAINED
END SECTION (SEE SHEET 22)

NORMAL POOL=1349.5
100-YR WSEL=1352.9

INSTALL 22 S.Y. OF
LIGHT STONE RIP-RAAP
W/GROUTED STONE
TOEWALL (9'x2'x4')

STA. 10+50.0, LINE 1
CONST. CONC. COLLAR
(5'x5'x1')

STA. 12+30.2, LINE 1=
ST. STA. 4+24.16, 17.4' LT.
INSTALL TYPE 1A CURB INLET
(10'x3')
INLET TOP=1354.06

LINE 1
36" RCP

LINE 1
18" RCP

STA. 12+66.2, LINE 1=
ST. STA. 4+18.40, 17.9' RT.
INSTALL TYPE 1A CURB INLET
(10'x3')
INLET TOP=1354.07

STA. 14+49.3, LINE 1
CONST. 4' DIA. SPECIAL SHALLOW MH
w/DEETER FRAME & GRATE
NO. 1927 OR APPROVED EQUAL
MANHOLE TOP=1354.9

STA. 13+53.0, LINE 1
CONST. 4' DIA. SPECIAL SHALLOW MH
w/DEETER FRAME & GRATE
NO. 1927 OR APPROVED EQUAL
MANHOLE TOP=1354.4

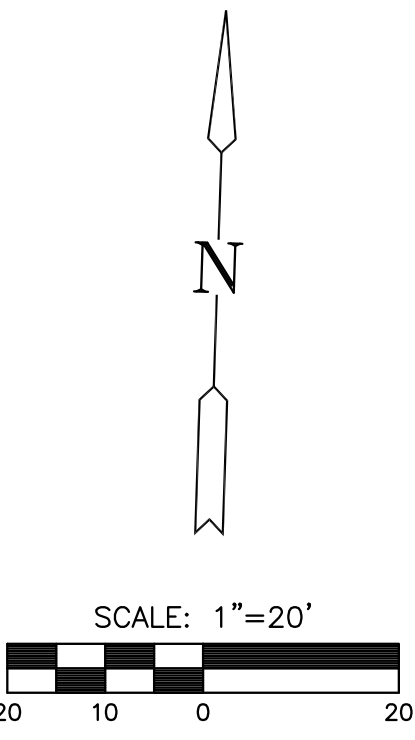

LEGEND

* EXISTING SPRINKLER HEAD
(SEE GENERAL NOTE 10)

PLAN LINE 1

PROFILE LINE 1

SCALE: HORIZ. 1"=20'
SCALE: VERT. 1"=5'

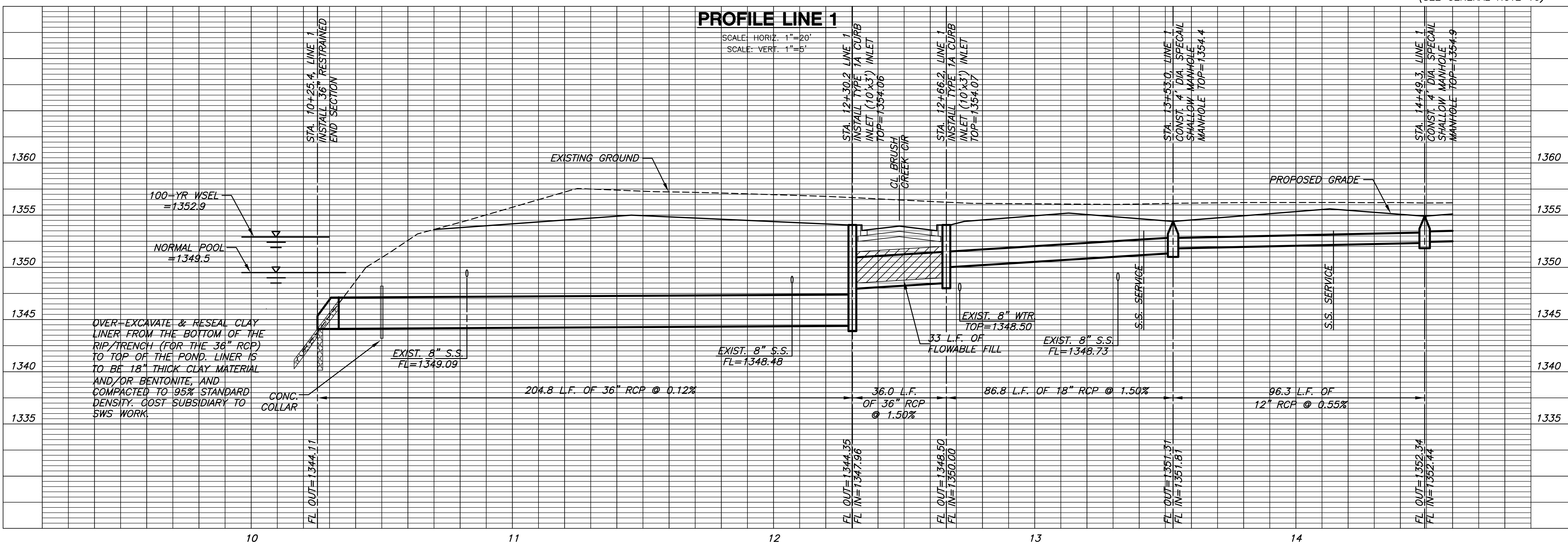

LINE 1
SHEET TITLE
472-83791
PROJECT NUMBER

DFL / KKL / GJA
DESIGNED / DRAWN / CHECKED

ISSUED
October 2011
REVISED

SHEET NO.
25 of 56

PLOTTED: Wednesday, October 12, 2011 @ 08:17AM

G:\CIVIL\981118\DWG\SWS\PH-14\981118_14.DWG