

BM#2 - C.O.W. Disc located on the northwest corner of Pawnee & Broadway (52' north of CL Pawnee, 40' west of CL Broadway)  
Elev. = 1286.28 (NAVD 88)

BM#3 - "x" Cut on top of curb located on the west curb to the sub-station entrance south of Pawnee across from Market St.  
Elev. = 1283.89 (NAVD 88)

FHWA REGION NO.	STATE	PROJECT NO.	FISCAL YEAR	SHEET NO.	TOTAL SHEETS
7	KANSAS	87 N-0495-01	2011	10	64

HSIP-N049 (501)

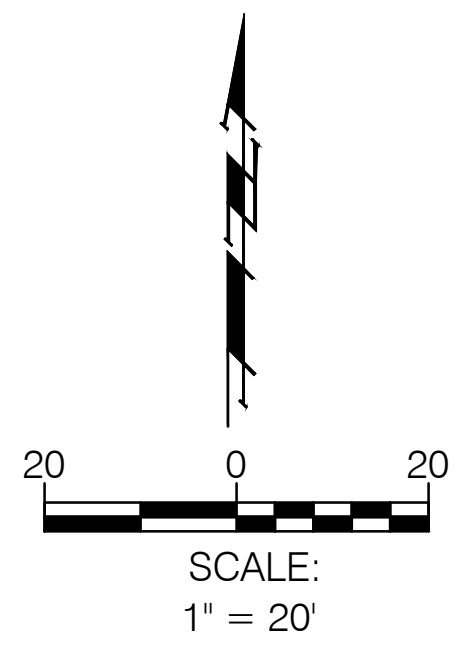

STA 7+50.00  
BEGIN KDOT PROJ.  
87N-0495-01

Construct Conc. Pmnt. 9"  
(NRDJ) on Crushed Rock  
Base 6" Reinforced

Begin Conc. Sidewalk  
at Nearest Joint.  
Match Existing Walk

Sta. 7+50.00  
BEGIN PROJECT  
Begin Constr.  
Begin Taper Lt.

Sta. 7+63.73  
END 6" Conc. Nose  
BEGIN Brick Median

Construct Conc.  
C&G Comb. Type 1  
(6" & 1-1/2")

Sta. 8+25.00  
END Taper Lt.

Construct Full Width  
Concrete Sidewalk (4")

Construct 30' Conc.  
Drive 8" Reinf.  
(See Drive Detail Sheet)

Proposed 6" Asphalt  
Parking Lot Pavement

Ex. Sign to be  
Relocated by  
"Others"

Prop Fire Hydrant  
See Water Plans  
Sheet 3

AT&T MH Adjusted (NP)  
Elev=1286.35 Top

Ex. WVB Adjusted  
Elev=1286.67 Top

AT&T MH Adjusted  
Elev=1286.53 Top

Ex. WVB Adjusted  
Elev=1286.97 Top

Ex. WVB Adjusted  
Elev=1286.75 Top

Ex. Sign to be  
Relocated by  
"Others"

Sta. 10+84.98  
Radius

Sta. 10+93.95  
Match Point

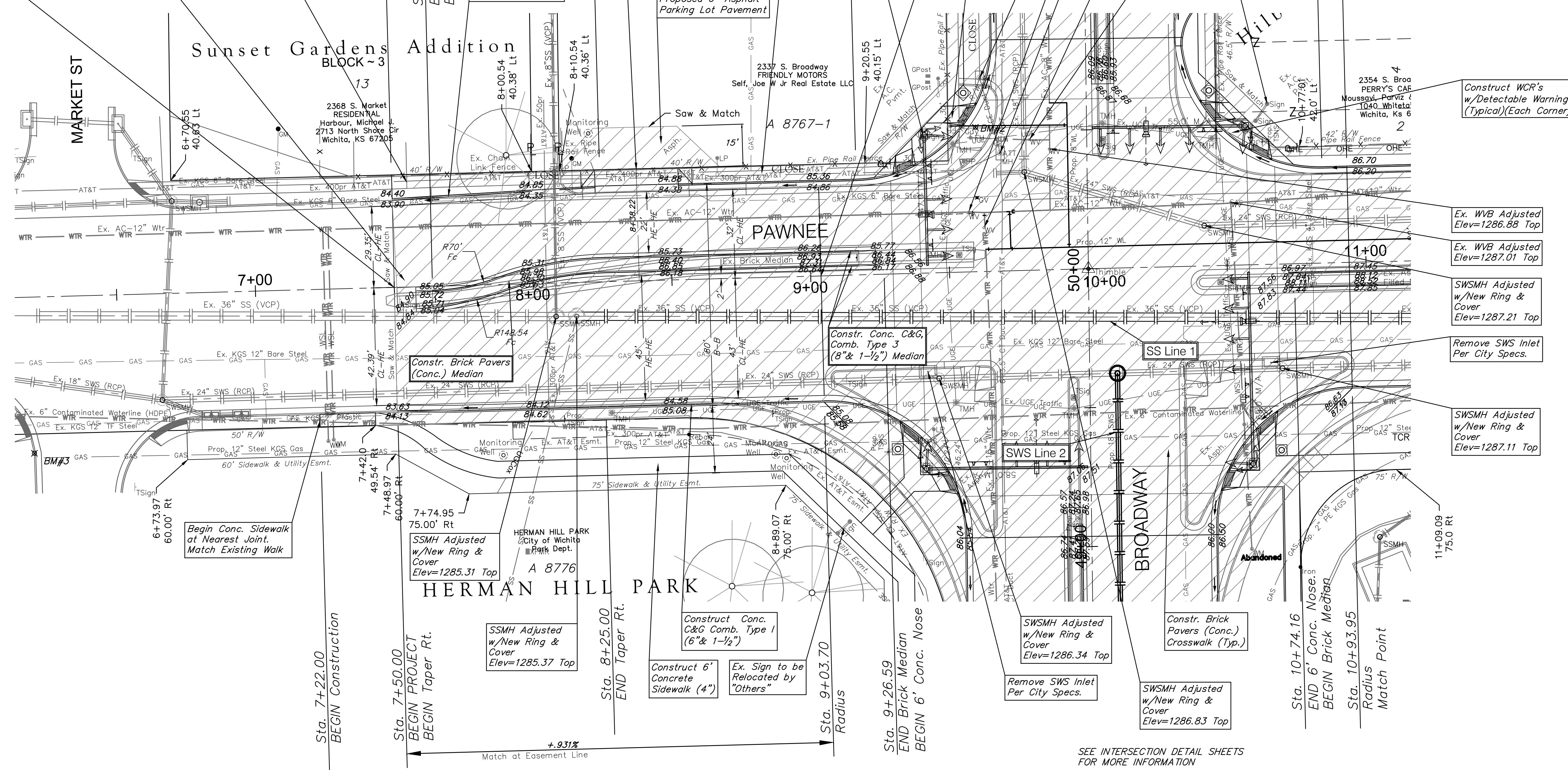

Construct WCR's  
w/Detectable Warnings  
(Typical)(Each Corner)

Ex. WVB Adjusted  
Elev=1286.88 Top

Ex. WVB Adjusted  
Elev=1287.01 Top

SWSMH Adjusted  
w/New Ring &  
Cover  
Elev=1287.21 Top

Remove SWS Inlet  
Per City Specs.

SWSMH Adjusted  
w/New Ring &  
Cover  
Elev=1287.11 Top

Begin Conc. Sidewalk  
at Nearest Joint.  
Match Existing Walk

SSMH Adjusted  
w/New Ring &  
Cover  
Elev=1285.31 Top

SSMH Adjusted  
w/New Ring &  
Cover  
Elev=1285.37 Top

Construct Conc.  
C&G Comb. Type 1  
(6" & 1-1/2")

Construct 6"  
Concrete  
Sidewalk (4")

Ex. Sign to be  
Relocated by  
"Others"

SWSMH Adjusted  
w/New Ring &  
Cover  
Elev=1286.34 Top

Remove SWS Inlet  
Per City Specs.

SWSMH Adjusted  
w/New Ring &  
Cover  
Elev=1286.83 Top

SEE INTERSECTION DETAIL SHEETS  
FOR MORE INFORMATION

<p><b>Note:</b> Trees/Shrubs to be removed are marked thus:</p>	<p><b>Note:</b> Mill &amp; Overlay are indicated by:</p>	<p><b>Note:</b> Pavement, Sidewalks, and Etc. To Be Removed Are Indicated By:</p>
---	--	---

Drawing File: E:\Projects\Pawnee & Broadway\Civil 3d\Base  
Project No. 09-12-E435  
Design: T. Aziere  
Drawn: JDM  
Approved: T. Aziere  
Scale: 1"=20'

CAPITAL IMPROVEMENT PROJECT  
**PAWNEE PAVING**  
Sta. 7+50.00 to Sta. 10+93.95  
PAWNEE / BROADWAY INTERSECTION

**Baughman Company, P.A.**  
315 Ellis St. Wichita, KS 67211 P 316-262-7271 F 316-262-0149  
ENGINEERING | SURVEYING | PLANNING | LANDSCAPE ARCHITECTURE