

FHWA REGION NO.	STATE	PROJECT NO.	FISCAL YEAR	SHEET NO.	TOTAL SHEETS
7	KANSAS	87 N-0495-01	2011	20	64

HSIP-N049 (501)

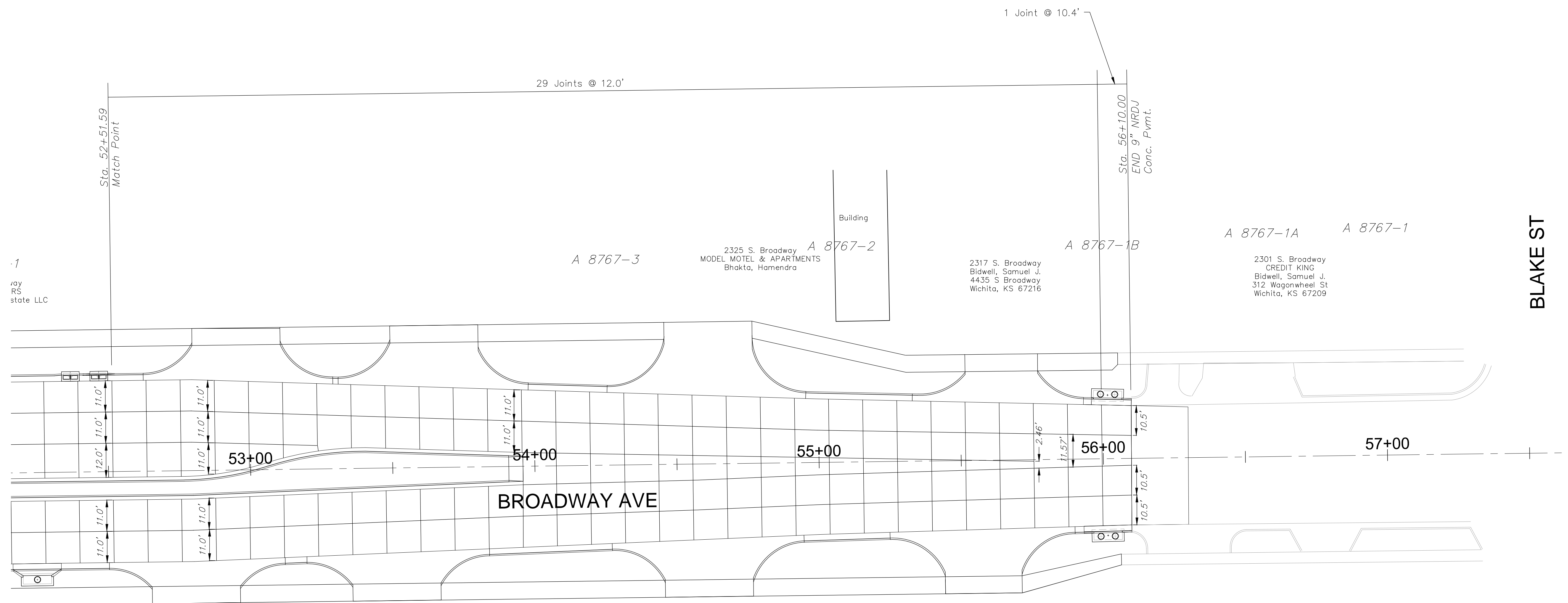
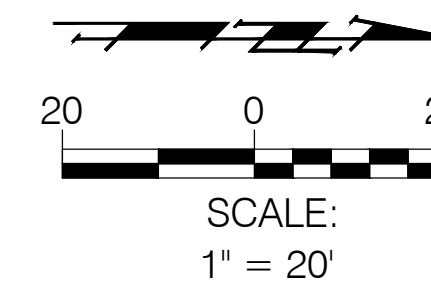

-1  
ray  
RS  
state LLC

Sta. 52+51.59  
Match Point

29 Joints @ 12.0'

1 Joint @ 10.4'

Sta. 56+10.00  
END 9" NRDU  
Conc. Pkmt.

BLAKE ST

A 8767-3

2325 S. Broadway  
MODEL MOTEL & APARTMENTS  
Bhakta, Hamendra

A 8767-2

Building

A 8767-1B

2317 S. Broadway  
Bidwell, Samuel J.  
4435 S Broadway  
Wichita, KS 67216

A 8767-1A

A 8767-1

2301 S. Broadway  
CREDIT KING  
Bidwell, Samuel J.  
312 Wagonwheel St  
Wichita, KS 67209

53+00

BROADWAY AVE

54+00

55+00

56+00

57+00

2348 S. Broadway  
PERRY'S CAR CO  
Moorhouse, Wry A.

Building

Building

2328 S. Broadway  
SUNSET MOTEL & APARTMENTS  
Bhakta, Yogesh D. & Sunita Y.

Building

2306 S. Broadway  
LE DETAIL SHOP  
Ho, Roger & Tuyet Le  
202 W 11th N  
Wichita, KS 67203

2302 S. Broadway  
WASHINGTON AUTO SALES  
Moorhouse, Robt. D.  
215 N Ashley Park  
Wichita, KS

2262 S. Broadway  
RESIDENTIAL  
Pearce Family LOV Trust  
910 W 1st St  
Wichita, KS 67203

Hilbish & Hettinger's Addition

Hilbish & Hettinger's Addition

Southern Addition

Drawing File: E:\Projects\ Pawnee & Broadway\Civil 3d\Base  
Project No. 09-12-E435 CAPITAL IMPROVEMENT PROJECT  
Design: T. Azlere  
Drawn: JDM  
Approved: T. Azlere  
Scale: 1"=20'  
BROADWAY JOINT PLAN  
PAWNEE / BROADWAY INTERSECTION

**Baughman** **Baughman Company, P.A.**  
315 Ellis St. Wichita, KS 67211 P 316-262-7271 F 316-262-0149  
ENGINEERING | SURVEYING | PLANNING | LANDSCAPE ARCHITECTURE

July, 2011  
SHEET 20 OF 64