

# PAVEMENT AND DRAINAGE IMPROVEMENTS

## FLOODWAY CROSSING-PHASE I

### 13TH STREET & RIDGE ROAD INTERSECTION

#### INDEX OF SHEETS

1	Title Sheet
2	General Notes
3	Alignment Detail Sheet
4-5	Typical Sections
6-19	Plans & Profiles
20-24	Coordinate Geometry Plans
25	Curve Stake-Out Tables
26-28	Storm Sewer Profiles
29-32	Intersection & Joint Detail
33-35	Pavement Details
36	Wheelchair Ramp Details
37	Sidewalk & Steps
38-44	Inlet & Manhole Details
45	Schedule of Inlets & Manholes
46-47	Summary & Recapitulation of Quantities
48-52	Erosion Control - BMP's
53-56	SWPPP
57	Landscape Details & Quantities
58-61	Landscape Plans
62-71	Signal Plans
72-79	Signing & Marking Plans
80-100	Traffic Control Plans
101	Drainage Area Map
102	Cross Section Layout
103-113	Cross Sections

#### LOCATION MAP

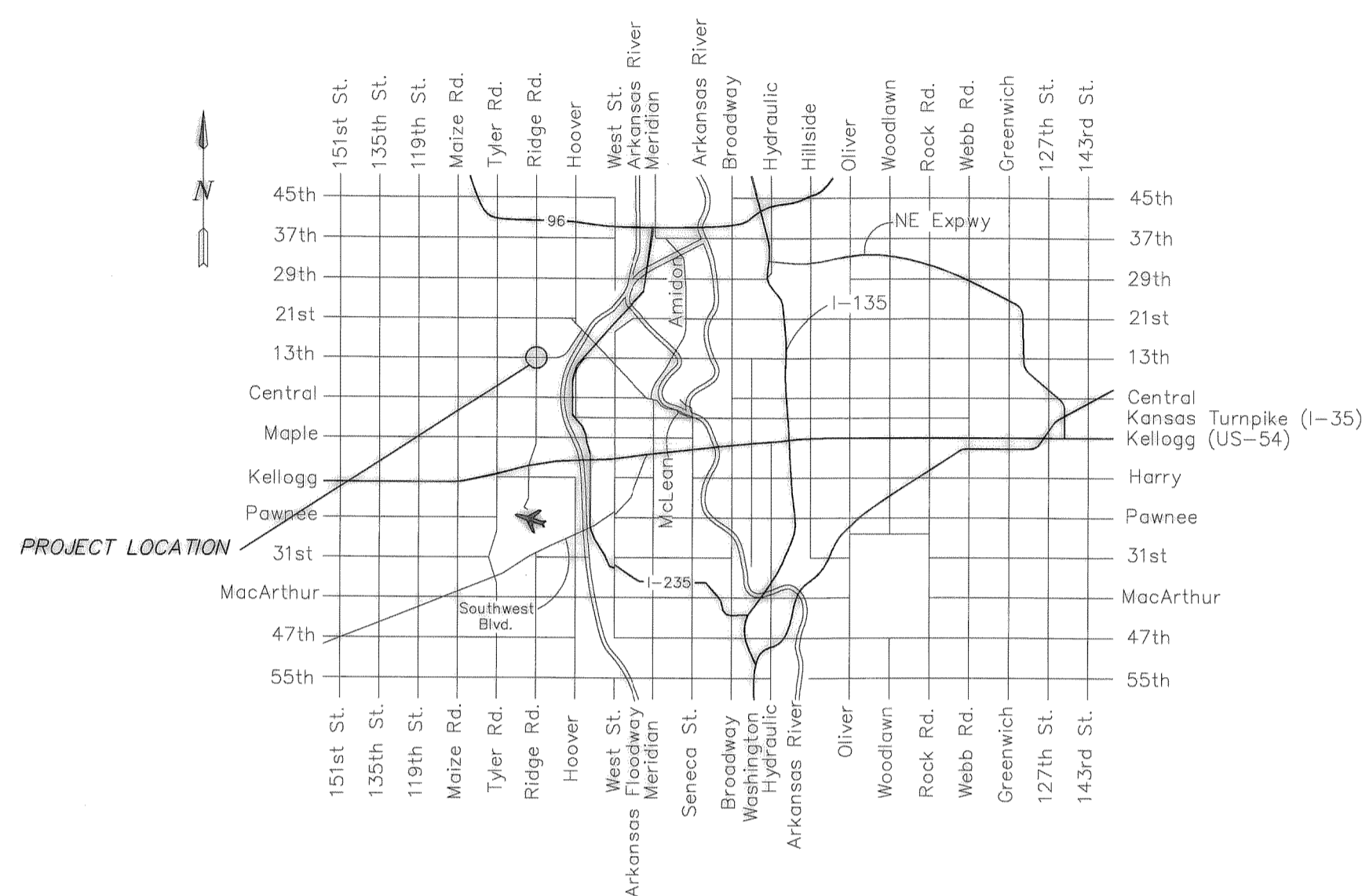

OCA NO. 770005

CITY OF WICHITA PROJ. NO. 472-84817 PHASE I

## CITY OF WICHITA, KANSAS

JAMES L. ARMOUR, P.E., L.S. - CITY ENGINEER

# NOVEMBER 2011

#### DESIGN DESIGNATION

AADT (2011)	=	5763
AADT (2040)	=	9825
DHV	=	16%
D	=	63/37
T	=	3.5%
V	=	40 MPH
C of A	=	PARTIAL
Clear Zone	=	16'

THIS DESIGN SPECIFICALLY PREPARED FOR USE AT THE LOCATION SHOWN. USE IN ANY OTHER MANNER EXCEEDS THE INTENDED PURPOSE OF THESE DRAWINGS AND ANY ACCOMPANYING SPECIFICATIONS.

STA. 194+20.00 BEGIN  
Project No. 472-84817 PHASE I

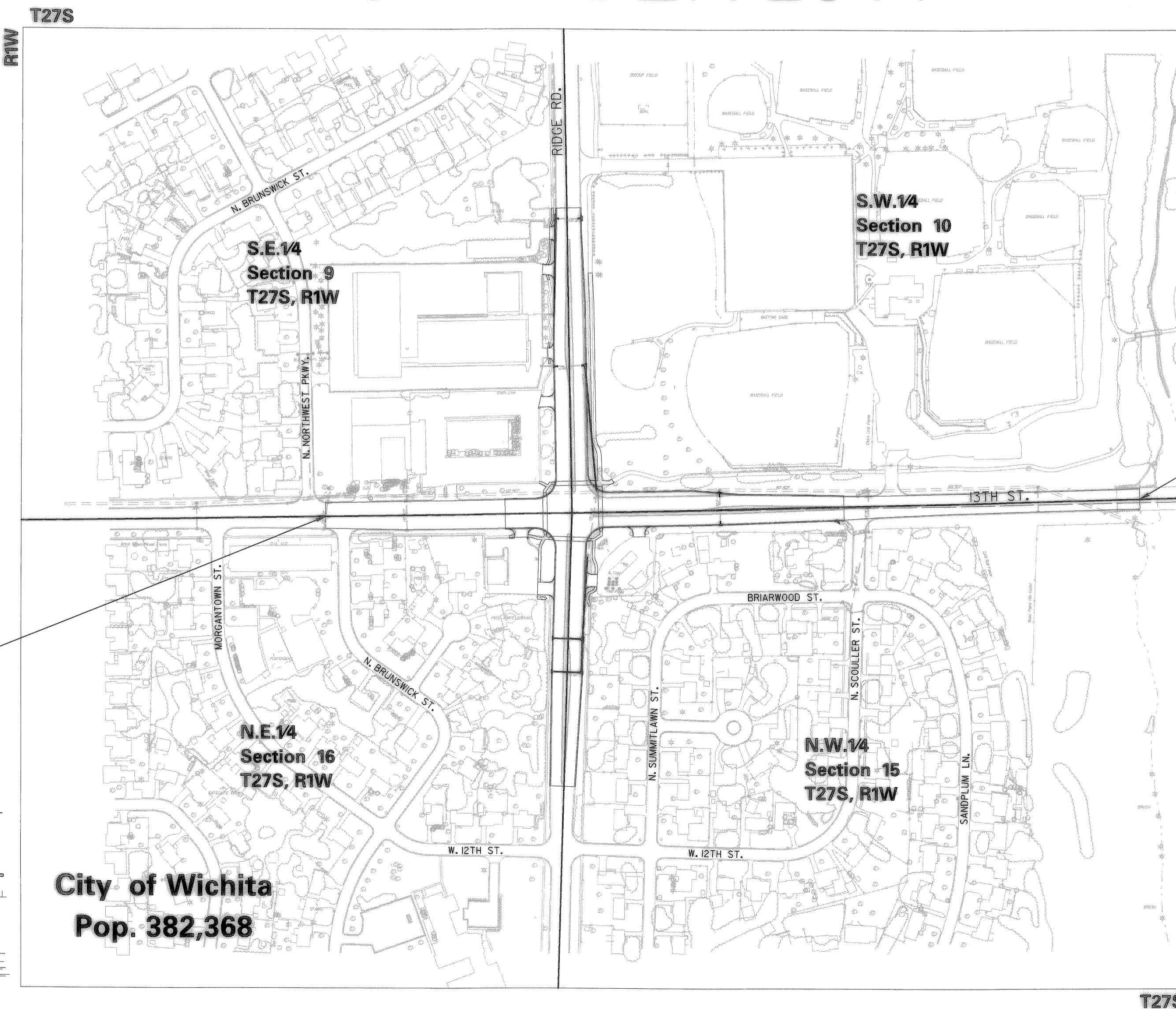

STA. 213+39.50 END  
Project No. 472-84817 PHASE I -  
Sta. 1124+39.35 on  
Project No. 472-84817 PHASE III &  
Project No. 235-87 KA-2040-01

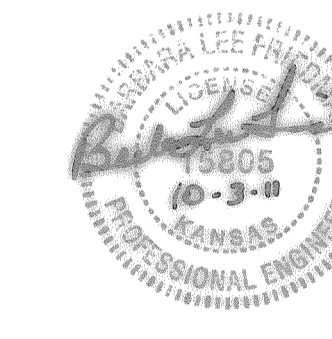

SEALED FOR SHTS. 80-100

PREPARED & SUBMITTED BY

**HNTB**

OVERLAND PARK, KANSAS

*James L. Armour* 10-3-11  
ENGINEER DATE

SCALE = 1"=200'

APPROVED - DATE 09-29-2011  
*James L. Armour*  
JAMES L. ARMOUR, P.E. CITY ENGINEER  
CITY OF WICHITA, SEDWICK COUNTY, KANSAS  
CITY NO. 472-84817 PHASE I

City of Wichita  
Pop. 382,368

NET LENGTH OF PROJECT 1919.50 FT. 0.36 MILES