

APPROVED	DESIGNED	DETAILED
DESIGN CK.	DESIGN CK.	DETAIL CK.
QUANTITIES	QUANTITIES	TRACE CK.
QUANCK.	QUANCK.	TRACE CK.

Plotted on Wednesday, November 26, 2008 10:33 AM
 By: amast-dgh Plot Scale: 50'
 Design: File name: J:\43244\CD\Plan\Gyp-Arm-plan_04.dgn
 Model: *****IP_MODEL*****
 Pen Table: fullsize.pen

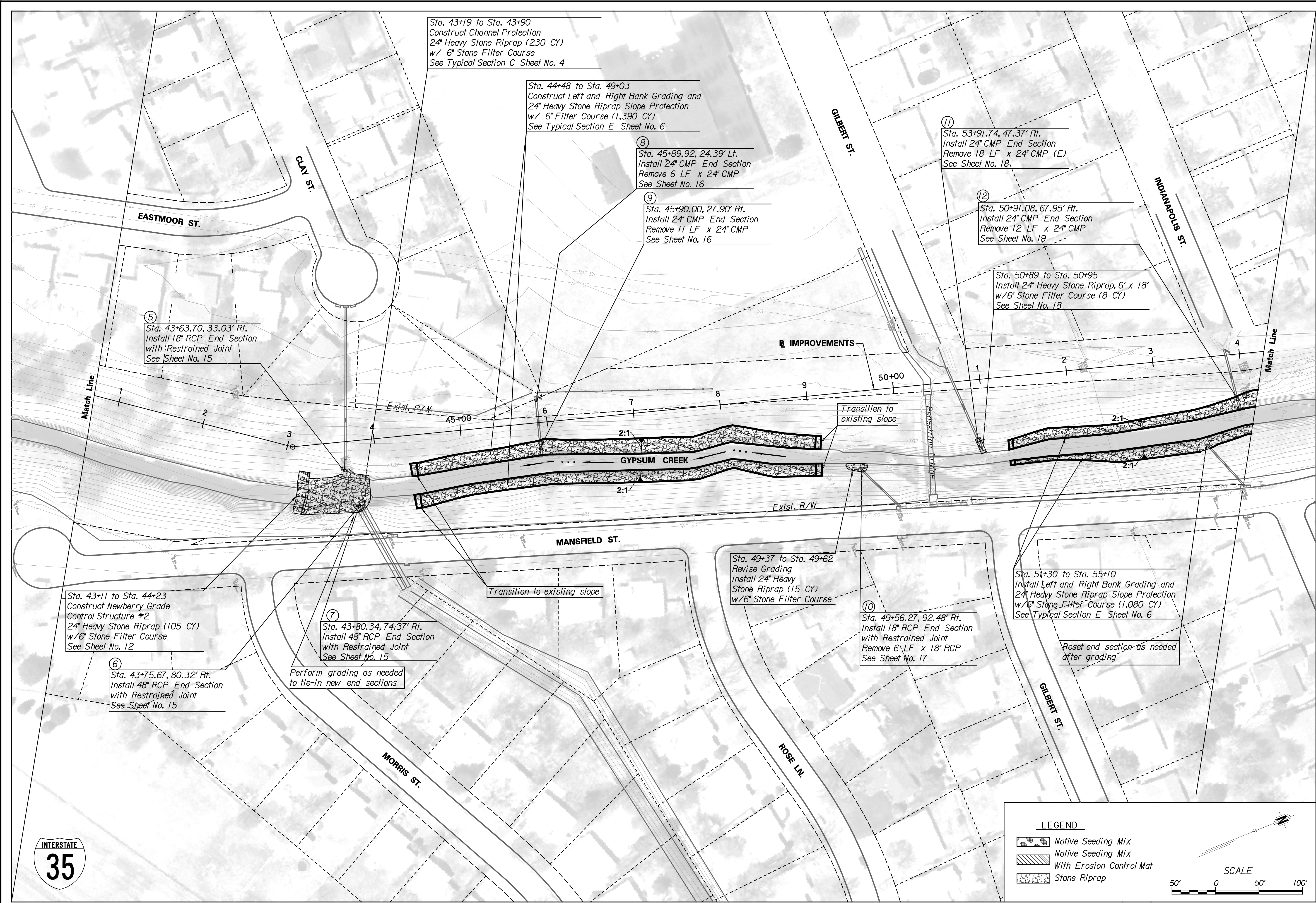

Sta. 43+19 to Sta. 43+90
 Construct Channel Protection
 24" Heavy Stone Riprap (230 CY)
 w/ 6" Stone Filter Course
 See Typical Section C Sheet No. 4

Sta. 44+48 to Sta. 49+03
 Construct Left and Right Bank Grading and
 24" Heavy Stone Riprap Slope Protection
 w/ 6" Filter Course (1,390 CY)
 See Typical Section E Sheet No. 6

⑧ Sta. 45+89.92, 24.39' Lt.
 Install 24" CMP End Section
 Remove 6 LF x 24" CMP
 See Sheet No. 16

⑨ Sta. 45+90.00, 27.90' Rt.
 Install 24" CMP End Section
 Remove 11 LF x 24" CMP
 See Sheet No. 16

⑪ Sta. 53+91.74, 47.37' Rt.
 Install 24" CMP End Section
 Remove 18 LF x 24" CMP (E)
 See Sheet No. 18

⑫ Sta. 50+91.08, 67.95' Rt.
 Install 24" CMP End Section
 Remove 12 LF x 24" CMP
 See Sheet No. 19

Sta. 50+89 to Sta. 50+95
 Install 24" Heavy Stone Riprap, 6' x 18"
 w/ 6" Stone Filter Course (8 CY)
 See Sheet No. 18

⑤ Sta. 43+63.70, 33.03' Rt.
 Install 18" RCP End Section
 with Restrained Joint
 See Sheet No. 15

Sta. 43+11 to Sta. 44+23
 Construct Newberry Grade
 Control Structure #2
 24" Heavy Stone Riprap (105 CY)
 w/ 6" Stone Filter Course
 See Sheet No. 12

⑥ Sta. 43+75.67, 80.32' Rt.
 Install 48" RCP End Section
 with Restrained Joint
 See Sheet No. 15

⑦ Sta. 43+80.34, 74.37' Rt.
 Install 48" RCP End Section
 with Restrained Joint
 See Sheet No. 15

Perform grading as needed
 to tie-in new end sections

Sta. 49+37 to Sta. 49+62
 Revise Grading
 Install 24" Heavy
 Stone Riprap (15 CY)
 w/ 6" Stone Filter Course

⑩ Sta. 49+56.27, 92.48' Rt.
 Install 18" RCP End Section
 with Restrained Joint
 Remove 6 LF x 18" RCP
 See Sheet No. 17

Sta. 51+30 to Sta. 55+10
 Install Left and Right Bank Grading and
 24" Heavy Stone Riprap Slope Protection
 w/ 6" Stone Filter Course (1,080 CY)
 See Typical Section E Sheet No. 6

Reset end section as needed
 after grading

LEGEND

- Native Seeding Mix
- Native Seeding Mix with Erosion Control Mat
- Stone Riprap

SCALE
 50' 0 50' 100'