

WATERLINE PLANS (PRIVATE)

TO SERVE



MARKET STORE #5991-00

31st ST. SOUTH & SENECA ST.
WICHITA, SEDGWICK COUNTY, KANSAS
CITY OF WICHITA PRIVATE PROJECT NO.

1592 PPW (607853)

2011

INDEX OF SHEET

C-11.0.0	TITLE SHEET
C-11.0.1	WATERLINE LOCATION PLAN
C-11.0.2	WATERLINE PLAN & PROFILE
C-11.1	WATERLINE DETAILS
C-11.2	STANDARD WATER ASSEMBLY DETAILS
C-11.3	VARIOUS WATER DETAILS

OWNERS' ADDRESS

WALMART STORES, INC.
702 S.W. 8th STREET
BENTONVILLE, AR 72716
PH. (479) 273-4000

CITY RESOURCE LIST

CITY MANAGER CITY MANAGER'S OFFICE CITY OF WICHITA 455 N. MAIN - CITY HALL WICHITA, KS 67202 CONTACT: ROBERT LAYTON PH: (316) 268-4351 FAX: (316) 858-7712	CITY ENGINEER PUBLIC WORKS CITY OF WICHITA 455 N. MAIN - CITY HALL WICHITA, KS 67202 CONTACT: JIM ARMOUR PH: (316) 268-4266 FAX: (316) 268-4114	PLANNING / ZONING METROPOLITAN AREA PLANNING DEPARTMENT CITY OF WICHITA 455 N. MAIN - CITY HALL WICHITA, KANSAS 67202 CONTACT: BILL LONGNECKER PH: (316) 268-4494 FAX: (316) 268-4390
--	---	--

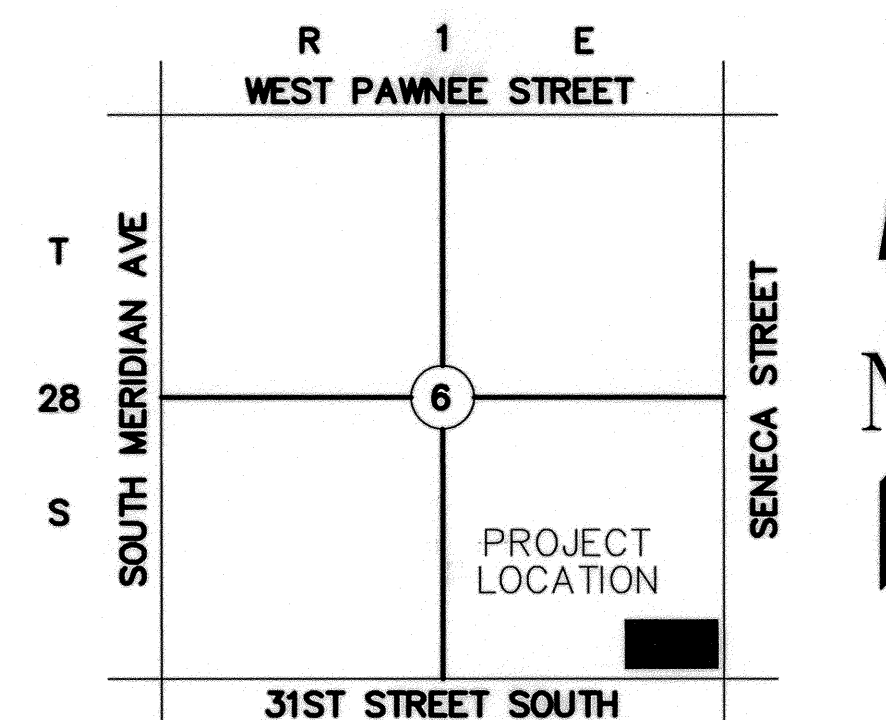

LOCATION MAP
NOT TO SCALE

ALERT TO CONTRACTOR:

1. THE SITEWORK FOR THE WALMART PORTION OF THIS PROJECT SHALL MEET OR EXCEED THE "SITE SPECIFIC SPECIFICATIONS."
2. ALL NECESSARY INSPECTIONS AND/OR CERTIFICATIONS REQUIRED BY CODES AND/OR UTILITY SERVICE COMPANIES SHALL BE PERFORMED PRIOR TO CONTRACT COMPLETION AND THE FINAL CONNECTION OF SERVICES.

NOTE TO CONTRACTOR
CALL KANSAS ONE
1-800-522-6543

This number is to be used for information on the location of all underground utilities. Contact this number prior to any excavation.

- (1) An effort has been made to locate and show approximate location of underground utility lines. Buried utilities are not necessarily shown. It is the Contractors responsibility to locate and preserve all utility services.
- (2) Proposed utility services have been coordinated with the local utility companies. Contractor is responsible for contacting all utility companies prior to construction.
- (3) All quantity estimates shown in this set of plans are the Engineer's estimate and are provided for general information only! The contractor is solely responsible for calculating his/her own quantities!
- (4) Contractor shall acquire Licensing to work in City of Wichita, shall maintain Insurance Verification per Walmart and City's requirements and shall submit necessary bonds to satisfy City of Wichita's requirements.

APPROVED AS NOTED
BY CITY ENGINEER OF WICHITA,
BY WICHITA WATER & SEWER DEPARTMENT,
& BY WICHITA FIRE DEPARTMENT

Public Works: *[Signature]* 5/24/11
Water & Sewer: *[Signature]* 5/24/11
Fire: *[Signature]* 5-24-2011

NOTE TO CONTRACTORS

Public Property:
Inspection and testing for the waterline is to be provided by a Licensed Consulting Engineering Firm under contract with the Owner/Developer. Said inspection to be in accordance with the City of Wichita standard construction engineering practices and certified by a Professional Engineer Licensed in the state of Kansas. No work shall be performed in dedicated easements or public right-of-way by the Contractor without such inspection nor shall any work be commenced without written authorization by the City Engineer. All Construction and Materials shall comply with the City or Wichita Specifications and Standards (on file and available in the City Engineer's Office).

Private Property:
Installation and testing for the fire protection line is to be performed by a City of Wichita licensed fire protection contractor in accordance with the fire codes as adopted by the City of Wichita. All material and construction practices for the fire protection line shall comply with the fire codes as adopted by the City of Wichita (available from the City of Wichita Fire Department). The Contractor shall not commence work without notification and approval of the Wichita Fire Department. Inspection of the fire protection line is to be provided by a licensed Engineering Firm under contract with the Owner/Developer and the Fire Department. The contractor shall not start work until the project inspector is assigned to the project and present on the site. Any work done without inspection will be required to be uncovered for inspection.

I, Terence L. Haynes, Kansas Professional Engineer, #14583, do hereby state that these Public Water Line plans & Private Water Line plans, prepared by me or under my direct, responsible supervision, are in strict conformance with the applicable Codes of the City of Wichita and the sound principles and practice of the Civil Engineering profession

[Signature]
TERENCE L. HAYNES, P.E. #14583

CHANGE DIRECTIVE #1 ~ 05/19/11

BENCH MARKS:

BM #1 " " CHISELED ON TOP OF CURB ELEV=1284.05 DATUM = NAVD 1988	BM #2 " " CHISELED ON TOP OF CURB ELEV=1283.13 DATUM = NAVD 1988
---	---

AS BUILTS

Contractor: Ewertz Excavation 10/7/2011	Project Inspector: Larry Gann kemiller engineering 516 S. Main Wichita, KS 67202 (316)264-0242
--	---

TITLE SHEET
WATERLINE PLANS (PRIVATE)

WALMART MARKET #5991-00

31st STREET & S. SENECA STREET
WICHITA, KANSAS

SMC Consulting Engineers, P.C.
815 West Main - Oklahoma City, OK 73106
PH: 405-232-7715 Fax: 405-232-7859
KANSAS CERTIFICATE OF AUTHORIZATION NO. E-335 EXP. Dec. 31, 2011

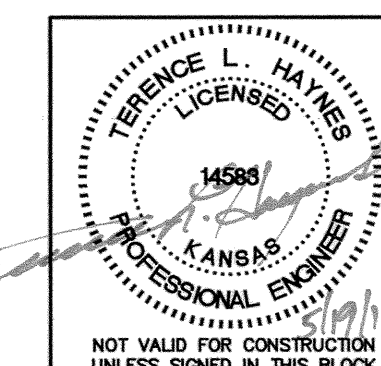

No. 7	Revision Change Directive #1	By TAB	Date 05/19/11
DATE: 04/28/11	SCALE: NTS	SHEET NO. C-11.0.0	
DRAWN BY: TAB	PROJECT NO.: 4966.00	ENGINEER: TERENCE L. HAYNES, P.E. #14583	

SMC Consulting Engineers, P.C.
Oklahoma City, Oklahoma