

**BENCHMARKS:**

**BM #1:**  
RR Spike in CATV Pole, 85' east and 77' south of SE corner of Woods North 3rd Addition.  
Elev. = 1383.00 NAVD88

**BM #2:**  
"□" cut at centerline of inlet adjacent to Lot 29, Block A, Woods North 2nd Addition.  
Elev. = 1387.12 NAVD88

**BM #3:**  
Cross cut on north end of west headwall 137.5' south & 12' west of the intersection of 29th St N & 127th St E.  
ELEV. = 1382.45 NAVD88

P.V.I.  
Elev. = 1390.70  
50' V.C.

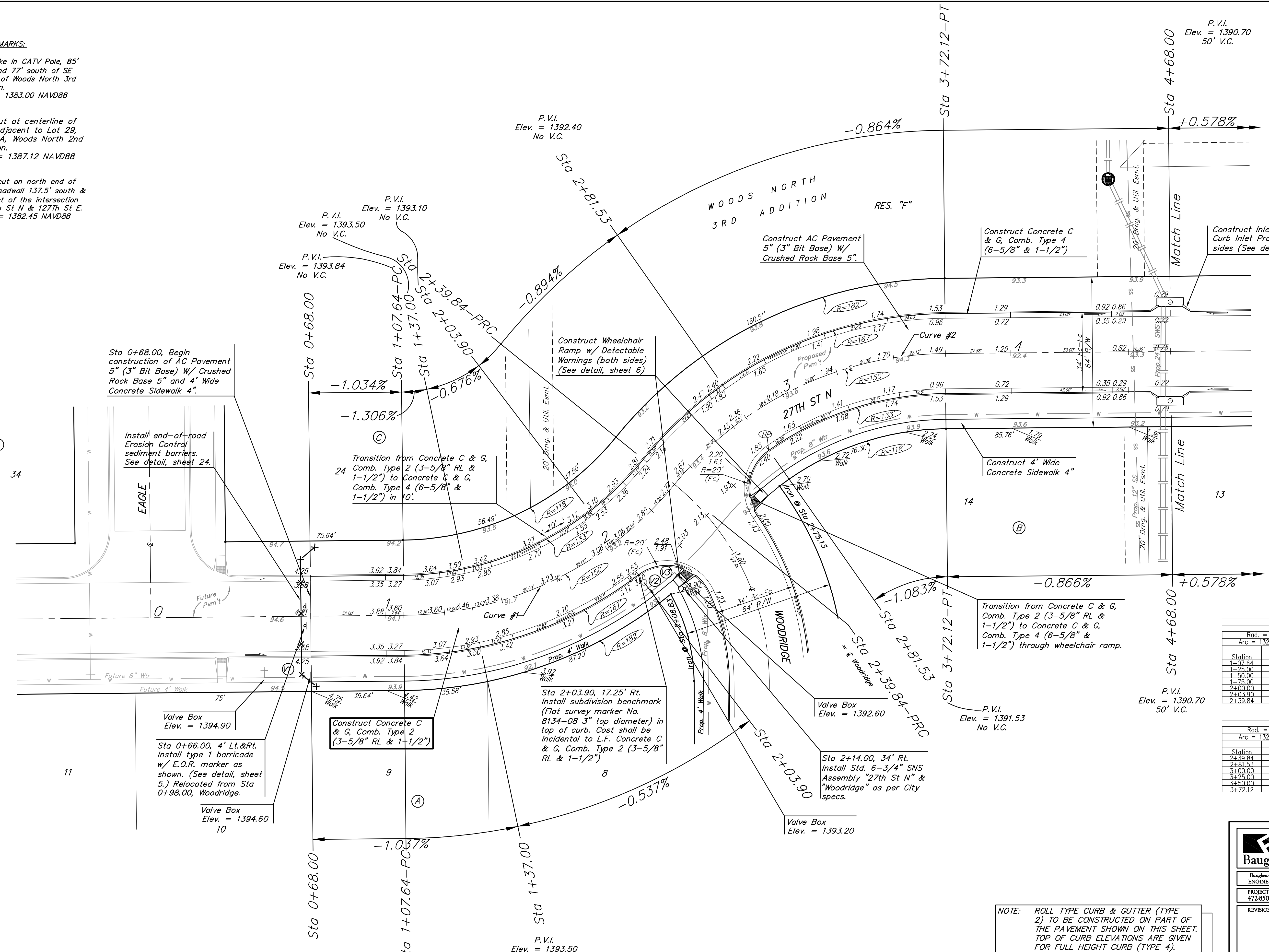
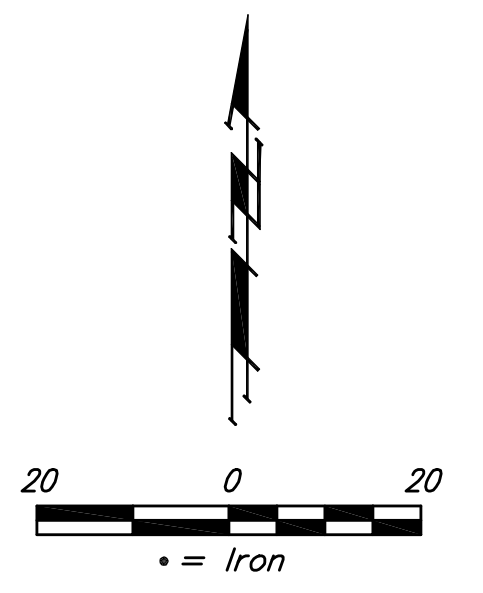

Sta 0+68.00, Begin construction of AC Pavement 5" (3" Bit Base) W/ Crushed Rock Base 5" and 4' Wide Concrete Sidewalk 4".

Install end-of-road Erosion Control sediment barriers. See detail, sheet 24.

Transition from Concrete C & G, Comb. Type 2 (3-5/8" RL & 1-1/2") to Concrete C & G, Comb. Type 4 (6-5/8" & 1-1/2") in 10'.

Construct Wheelchair Ramp w/ Detectable Warnings (both sides) (See detail, sheet 6)

Construct AC Pavement 5" (3" Bit Base) W/ Crushed Rock Base 5".

Construct Concrete C & G, Comb. Type 4 (6-5/8" & 1-1/2")

Construct Inlet Hookups & Curb Inlet Protection, both sides (See detail, sheet 23)

Sta 0+66.00, 4' Lt.&Rt. Install type 1 barricade w/ E.O.R. marker as shown. (See detail, sheet 5.) Relocated from Sta 0+98.00, Woodridge.

Construct Concrete C & G, Comb. Type 2 (3-5/8" RL & 1-1/2")

Sta 2+03.90, 17.25' Rt. Install subdivision benchmark (Flat survey marker No. 8134-08 3" top diameter) in top of curb. Cast shall be incidental to L.F. Concrete C & G, Comb. Type 2 (3-5/8" RL & 1-1/2")

Sta 2+14.00, 34' Rt. Install Std. 6-3/4" SNS Assembly "27th St N" & "Woodridge" as per City specs.

Transition from Concrete C & G, Comb. Type 2 (3-5/8" RL & 1-1/2") to Concrete C & G, Comb. Type 4 (6-5/8" & 1-1/2") through wheelchair ramp.

Curve #1  
Curve Data Based on Centerline  
Rad. = 150' Delta = 50.2940' Tangent = 70.74'  
Arc = 132.20' L.C. = 127.96' Def./ft. = 11.45865 Min.

Station	Arc	Face Chord Lengths		Defl.	Total Defl.
		8' Left	8' Right		
1+07.64	-	-	-	0.0000'	0.0000'
1+25.00	17.36'	14.46'	20.24'	3.1855'	3.1855'
1+50.00	25.00'	20.81'	29.13'	4.4628'	8.0523'
1+75.00	25.00'	20.81'	29.13'	4.4628'	12.5151'
2+00.00	25.00'	20.81'	29.13'	4.4628'	17.3819'
2+03.90	3.90'	3.25'	4.55'	0.4442'	18.2301'
2+39.84	35.94'	29.88'	41.83'	6.5149'	25.1450'

Curve #2  
Curve Data Based on Centerline  
Rad. = 150' Delta = 50.3147' Tangent = 70.79'  
Arc = 132.28' L.C. = 128.04' Def./ft. = 11.45972 Min.

Station	Arc	Face Chord Lengths		Defl.	Total Defl.
		8' Left	8' Right		
2+39.84	41.69'	48.48'	34.63'	7.5745'	7.5745'
2+81.53	18.47'	21.54'	15.38'	3.3140'	11.2925'
3+00.00	25.00'	20.81'	29.13'	4.4628'	16.1553'
3+25.00	25.00'	20.81'	29.13'	4.4628'	21.0221'
3+72.12	22.12'	25.78'	18.42'	4.1329'	25.1553'

NOTE: ROLL TYPE CURB & GUTTER (TYPE 2) TO BE CONSTRUCTED ON PART OF THE PAVEMENT SHOWN ON THIS SHEET. TOP OF CURB ELEVATIONS ARE GIVEN FOR FULL HEIGHT CURB (TYPE 4).

**Baughman** WOODS NORTH 3RD ADD. PH. I  
**27TH ST N**  
STA 0+68.00 TO STA 4+68.00

Baughman Company, P.A. 515 Ellis St. Wichita, KS 67211 P 316-262-7271 F 316-262-0416  
ENGINEERING | SURVEYING | PLANNING | LANDSCAPE ARCHITECTURE

PROJECT NUMBER 47285046	DESIGN AEG TMS
REVISIONS:	APPROVED DATE 07/12
SCALE Noted	
SHEET <b>8 OF 35</b>	

08-13\_Sr1.dwg 09-12-E428