

STA. 9+93.49 LINE 6
BL STA. 10+21.00, 26.00' LT.
CONNECT TO EXISTING 12" WATER MAIN.
#1 - 12"x 8" TAPPING SLEEVE
#1 - 8" TAPPING VALVE
#1 - 6" VALVE BOX TOP ELEV. MATCH
*FURNISHED AND INSTALLED BY DEPT. OF
WATER AND SEWER.
5.77 L.F. 8" DI CL PIPE

STA 9+99.26, LINE 6
BL STA 10+26.77, 26.00' LT.
1 - FH ASSEMBLY
BURY LINE ELEV = 1287.71
VALVE BOX ELEV = 1287.64
L = 5.0'

STA 18+84.26, LINE 6
BL STA 19+11.77, 26.00' LT.
1 - FH ASSEMBLY
BURY LINE ELEV = 1291.03
VALVE BOX ELEV = 1290.61
L = 5.0'
1 - 8"x6" MJ REDUCER

STA 20+57.87 LINE 6
BL STA 20+85.38, 26.00' LT
1 - 6" 45° BEND
29.69 L.F. 6" PIPE

STA 20+87.56 LINE 6
BL STA 21+06.37, 5.01' LT
1 - 6" 45° BEND
30.01 L.F. 6" PIPE

STA 21+17.57 LINE 6
BL STA 21+06.37, 25.00' RT
1 - 6" 45° BEND
29.69 L.F. 6" PIPE

REMOVE EX. FIRE HYDRANT AND
RETURN TO 1825 S. MCLEAN.
CUT AND KILL 3 - 1 CORPS
4.5' S OF FIRE HYDRANT
BL STA 10+00.00 LORRAINE CT =
BL STA 43+49.23 MT. VERNON
21.91 S. OF N. CURB LINE &
24.72 E. OF THE W. CURB LINE.

NEW WATER METER SUMMARY					
No.	BL Station	Lt./Rt.	Service (Long or Short)	Meter Size	Address
1	10+82.65	Rt.	Long	0.63	1960 S. LORRAINE ST.
2	11+71.96	Rt.	Long	0.63	1956 S. LORRAINE ST.
3	12+11.46	Lt.	Short	0.63	1945 S. LORRAINE ST.
4	12+20.65	Rt.	Long	0.63	1950 S. LORRAINE ST.
5	12+86.73	Lt.	Short	0.63	1935 S. LORRAINE ST.
6	13+65.40	Rt.	Long	0.63	1936 S. LORRAINE ST.
7	13+87.12	Rt.	Long	0.63	1920 S. LORRAINE ST.
8	13+92.68	Lt.	Short	0.63	1925 S. LORRAINE ST.
9	14+30.82	Lt.	Short	0.63	1915 S. LORRAINE ST.
10	14+61.21	Rt.	Long	0.63	1912 S. LORRAINE ST.
11	15+41.52	Lt.	Short	0.63	1901 S. LORRAINE ST.
12	15+70.46	Rt.	Long	0.63	1902 S. LORRAINE ST.
13	16+32.18	Rt.	Long	0.63	1858 S. LORRAINE ST.

NEW WATER METER SUMMARY					
No.	BL Station	Lt./Rt.	Service (Long or Short)	Meter Size	Address
14	16+32.84	Lt.	Short	0.63	1857 S. LORRAINE ST.
15	16+88.79	Rt.	Long	0.63	1854 S. LORRAINE ST.
16	17+52.86	Rt.	Long	0.63	1850 S. LORRAINE ST.
17	17+70.99	Lt.	Short	0.63	1851 S. LORRAINE ST.
18	18+06.99	Rt.	Long	0.63	1846 S. LORRAINE ST.
19	18+08.14	Lt.	Short	0.63	1847 S. LORRAINE ST.
20	18+81.25	Rt.	Long	0.63	1836-1840 S. LORRAINE ST.
21	19+01.84	Lt.	Short	0.63	1841 S. LORRAINE ST.
22	19+41.93	Rt.	Long	0.63	1824 S. LORRAINE ST.
23	19+65.36	Lt.	Short	0.63	1839 S. LORRAINE ST.
24	20+43.58	Rt.	Long	0.63	1822 S. LORRAINE ST.
25	20+86.35	Lt.	Short	0.63	1819-1821 S. LORRAINE ST.
26	20+94.68	Rt.	Short	0.63	1818-1820 S. LORRAINE ST.

STA 21+82.27 LINE 6
BL STA 20+51.83, 42.46' LT.
1 - 2" BLOWOFF ASSEMBLY
VALVE BOX ELEV = 1292.48

STA 21+77.27 LINE 6
BL STA 20+55.37, 46.00' RT
1 - 6" 45° BEND
5.00 L.F. 6" DI CL PIPE

STA 21+47.26 LINE 6
BL STA 20+85.38, 46.00' RT
1 - 6" 45° BEND
30.01 L.F. 6" PIPE

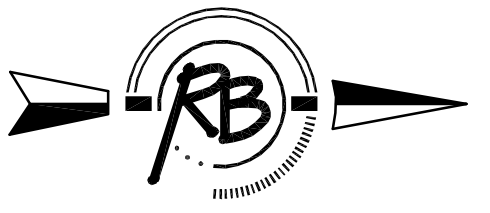

SCALE 1" = 40'
1" = 5' (VERT.)

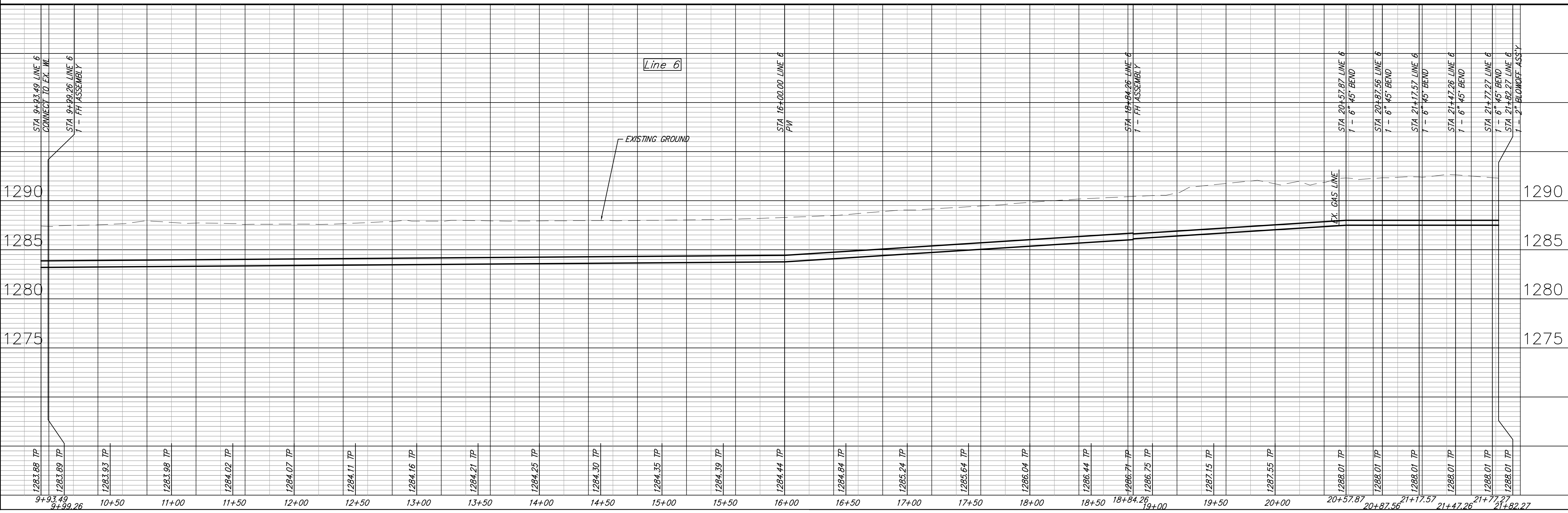

Kuggles & Dohm, P.A.
Engineering, Surveying, Land Planning
602 North Main
Wichita, Kansas 67203
www.kdpe.com
Email: kdpe@kdpe.com



PROJECT NUMBER: 448-90214
DESIGN: PC
DRAWING FILE: ENC. BASE (LINE 6)
REVISION: REVISED
DRAWN: MLP
DATE: Aug. 3, 2012
REVIEW: REVIEW

SCHRADER WATER DISTRIBUTION
LORRAINE (LINE 6)
WICHITA, KANSAS

10 OF 24
SHEET 2970W