

SCHAEFER JOHNSON COX FREY ARCHITECTURE
 507 W. 10th St.
 Wichita, Kansas
 67202-2317
 Ph. 316.864.0177
 Fax 316.864.0178
 www.sjcf.com

Professional Engineer
 Joseph D. Frey
 License No. 20918
 State of Kansas
 Professional Engineer

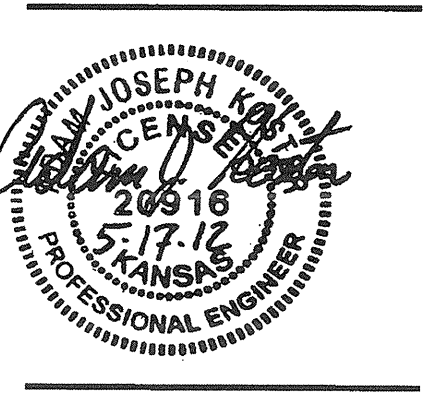

MKEC ENGINEERING CONSULTANTS
 411 N. WEBB ROAD
 WICHITA, KS 67202
 316-864-9600

GREATHER WICHITA YMCA
 FARHA SPORTS CENTER ADDITION
 3405 S. MERIDIAN
 WICHITA, KANSAS 67217

©2006
 Schaefer Johnson Cox Frey & Associates, P.A.
 All Rights Reserved

These drawings and their contents, including but not limited to, all concepts, designs, & data are the exclusive property of Schaefer Johnson Cox Frey (SJCF), and may not be used or reproduced in any way without the express consent of SJCF.

Revisions
 1
 2
 3
 4
 5

Project Number
 SJCF 2913.10
 Date
 14 MAR 2012
 PAVING & RAIN LEADER PLAN

CS.1.3

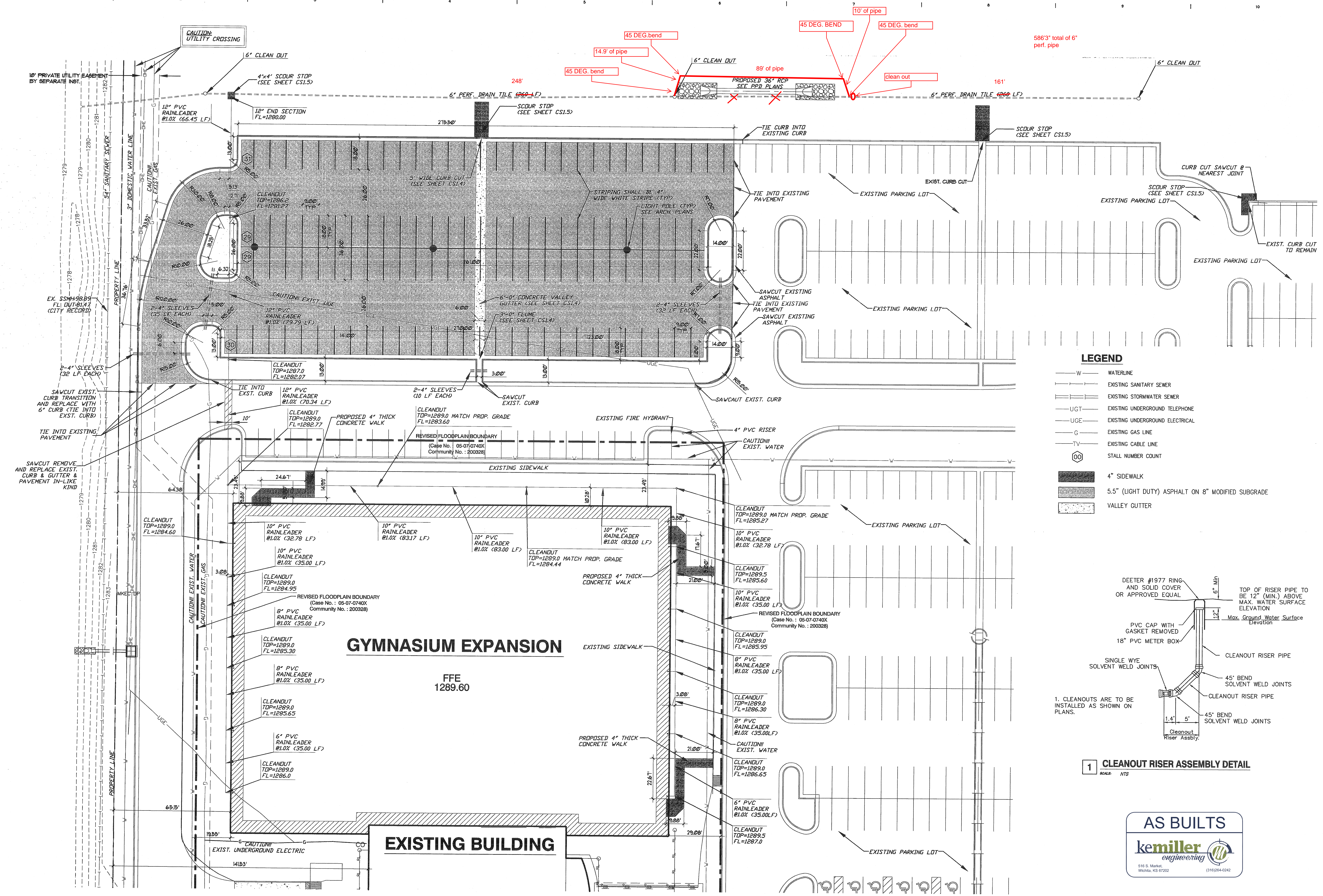

- LEGEND**
- W — WATERLINE
 - S — EXISTING SANITARY SEWER
 - ST — EXISTING STORMWATER SEWER
 - UGT — EXISTING UNDERGROUND TELEPHONE
 - UGE — EXISTING UNDERGROUND ELECTRICAL
 - G — EXISTING GAS LINE
 - TV — EXISTING CABLE LINE
 - 00 — STALL NUMBER COUNT
 - ▨ 4" SIDEWALK
 - ▨ 5.5" (LIGHT DUTY) ASPHALT ON 8" MODIFIED SUBGRADE
 - ▨ VALLEY GUTTER

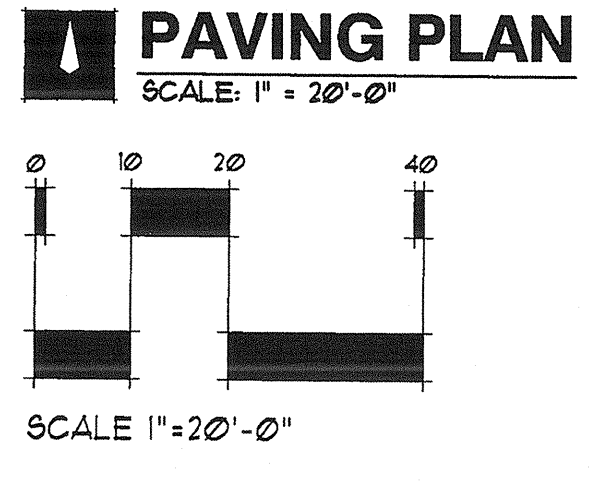
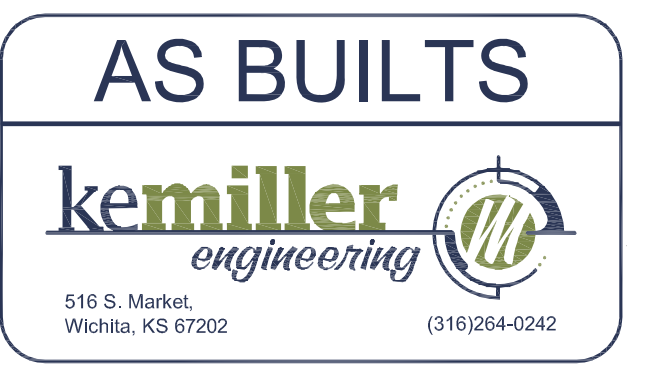
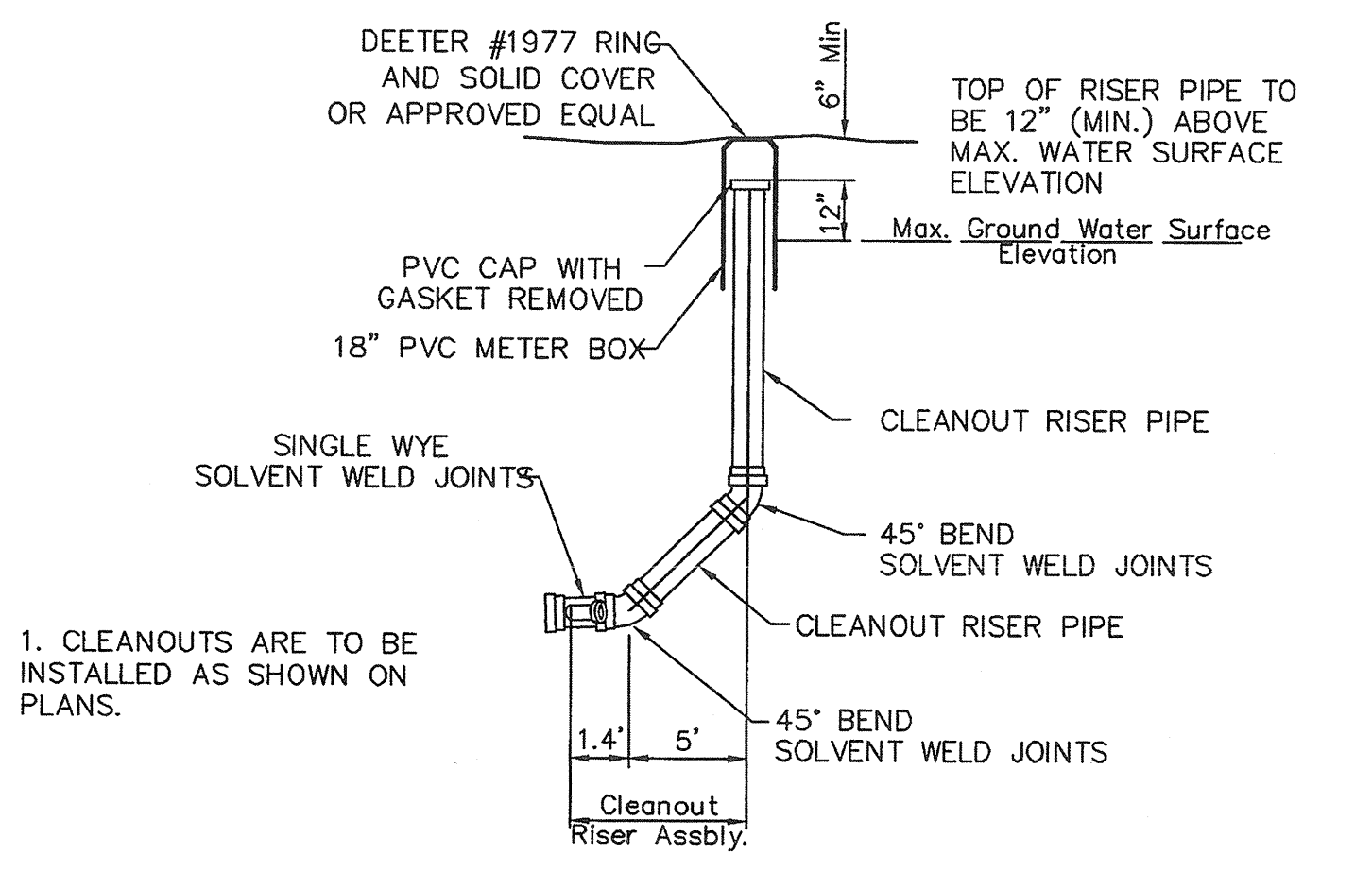

- NOTE:**
- CONTRACTOR SHALL DETERMINE THE USE OF REVERSE OR STANDARD CURBS BASED ON THE GRADING PLAN.
 - SAW CUT CONCRETE CURB AT ALL CHANGES IN DIRECTION, AT ENDS OF RETURN ON ALL RADII, AND AT NO GREATER THAN 10'-0" IN ALL OTHER LOCATIONS.
 - ALL DIMENSIONS ARE TAKEN FROM THE FACE OF CURB UNLESS OTHERWISE NOTED.
 - PIPE SLEEVE: PVC CLASS 200 SDR 21 TYPICAL PIPE SLEEVE FOR IRRIGATION PIPE. PIPE SLEEVE SIZE SHALL ALLOW FOR IRRIGATION PIPING AND THEIR RELATED COUPLINGS TO EASILY SLIDE THROUGH SLEEVING MATERIAL.
 - UNLESS OTHERWISE NOTED PIPE MATERIALS SHALL BE AS FOLLOWS:
 6" OR SMALLER - SCHEDULE 40 PVC
 12" OR SMALLER - ASTM D3034 SDR-35
 15" OR LARGER - CLASS III RCP
 - RUBBLE FROM THE REMOVAL OF MISCELLANEOUS STRUCTURES AND EXCESS EXCAVATION WHICH IS TO BE WASTED SHALL BE DISPOSED OF ON SITES TO BE PROVIDED BY THE CONTRACTOR. THESE SITES SHALL BE APPROVED BY THE ENGINEER AS TO SUITABILITY, APPEARANCE AND SITE LOCATION. LOCATIONS THAT, IN THE OPINION OF THE ENGINEER, WILL LEAVE AN UNSIGHTLY APPEARANCE WILL NOT BE APPROVED. ALL DISPOSAL SITES MUST BE APPROVED BY THE KANSAS DEPARTMENT OF HEALTH AND ENVIRONMENT. MATERIAL EITHER STOCKPILED OR DISPOSED OF IN A FLOOD PLAIN WOULD REQUIRE A KANSAS STATE BOARD OF AGRICULTURE PERMIT. ANY MATERIAL DUMPED IN WATERS OF THE UNITED STATES OR WETLANDS IS SUBJECT TO U.S. CORPS OF ENGINEERS PERMITTING REGULATIONS. ANY MATERIAL BURIED OR STOCKPILED BEYOND APPROVED CONSTRUCTION LIMITS WOULD REQUIRE ADDITIONAL ARCHAEOLOGICAL INVESTIGATIONS UNLESS BURIED IN A PREVIOUSLY APPROVED BORROW LOCATION.
 - A SAW CUT OF AT LEAST ONE-HALF THE DEPTH OF THE EXISTING SURFACE COURSES OR ONE-FOURTH THE DEPTH OF THE EXISTING TOTAL PAVEMENT THICKNESS SHALL BE PROVIDED AT LOCATIONS WHERE PROPOSED CONSTRUCTION ABUTS AN EXISTING SURFACE OR PAVEMENT FOR WHICH PARTIAL REMOVAL OF THAT SURFACE OR PAVEMENT IS REQUIRED. SAW JOINT TO FACILITATE REMOVAL WITHIN THREE (3) FEET OF EXISTING JOINTS WILL NOT BE PERMITTED AND FOR SUCH INSTANCES THE LIMITS OF REMOVAL SHALL EXTEND TO THE EXISTING JOINT. SUCH SAW CUTS WILL NOT BE PAID FOR DIRECTLY AND THIS COST SHALL BE CONSIDERED AS SUBSIDIARY TO THE REMOVAL OF SURFACE OR PAVEMENT.
 - CONTRACTOR SHALL BE RESPONSIBLE FOR REMOVAL OF EXISTING PAVEMENT, SIDEWALK, SLABS & FOOTINGS FROM AREA OF PROPOSED IMPROVEMENTS, AND LEGALLY DISPOSE OFF SITE (SEE NOTE 6).
 - ALL DIMENSIONS TO FACE OF CURB UNLESS OTHERWISE NOTED.
 - CONTRACTOR SHALL FOLLOW RECOMMENDATIONS OF GEOTECHNICAL REPORT (BY TERRACON) FOR BUILDING FOUNDATIONS, SUB-GRADES AND SUB-GRADE PREPARATIONS, PAVEMENT THICKNESSES, AND PAVEMENT STRENGTH SPECIFICATIONS.
 - PLACE EXPANSION, LONGITUDINAL, KEYWAY, AND CONSTRUCTION JOINTS IN CONCRETE PAVEMENT PER ACI STANDARDS. SEAL ALL JOINTS PER ACI STANDARDS.