

STATE	PROJECT NO.	YEAR	SHEET NO.	TOTAL SHEETS
KANSAS	87 N-0519-01	2012	44	212

MKEC
ENGINEERING
CONSULTANTS, INC.

411 N. WEBB ROAD
WICHITA, KS. 67206
316-684-9600

**BROADWAY BRIDGE
AT 34TH STREET SOUTH**

CONCRETE APPROACH PLAN DETAILS

SHEET TITLE

472-84830
PROJECT NUMBER

DESIGN BY: JRA
DRAWN BY: DPG
CHECKED BY: JRA

ISSUED: October 9, 2012
REVISED:

SHEET NO. 44 of 212

* Transition Rail height varies from 2'-8" at E.W.S. to match Standard Curb & Gutter.
"W" For Expansion/Pressure Relief Joint width and details See Sheet No. 45.

GENERAL NOTES

- Special Concrete Bridge Approach shall be paid for as sq. yds of "Concrete Pavement 12" (Reinforced)" and includes all work and materials required to construct the approach slab as shown on this sheet.
- Transition Approach Rail shall be paid for as lineal feet of "Concrete Safety Barrier (Special)(AE)".
- Formed joints shall be edged with 1/4" radius tool for length of joint.
- Clearance from the face of concrete for all reinforcing steel, unless noted, shall be 2".
- All casting to existing concrete, if cast previously, shall be brush blasted and power washed prior to casting concrete.
- All existing concrete shall be water soaked for 2 hours prior to casting concrete.
- All reinforcing steel shall be epoxy coated.
- Standard reinforcing bar hooks in accordance with the latest ACI specifications shall be used throughout.
- The pressure relief joint shall be omitted when the concrete bridge approach pavement abuts asphalt pavement.
- All work and materials required for installation of expansion joints and pressure relief joints shall be subsidiary to this bid item.
- At the Contractor's option #4x3'-0" tie bars @ 15" centers may be substituted for the #6 e bars at 2'-6" centers.

△ See Bending Diagram

BILL OF REINFORCING STEEL

Epoxy Coated, Grade 60

Mark	Size	Number	Length
a1	#5	110	24'-8"
b1	#5	50	54'-5"
c1	#5	50	54'-5"
c2	#4	24	54'-3"
f1	#6	218	25'-4"
f2	#4	110	△
SLAB			
h1	#5	12	24'-7"
v1	#5	100	△
RAIL			
h2	#5	4	7'-5"
h3	#5	4	5'-3"
v2	#5	24	△
LONG RAIL END SHORT RAIL END			
h4	#5	4	14'-6"
h5	#5	4	14'-6"
v3	#5	24	△

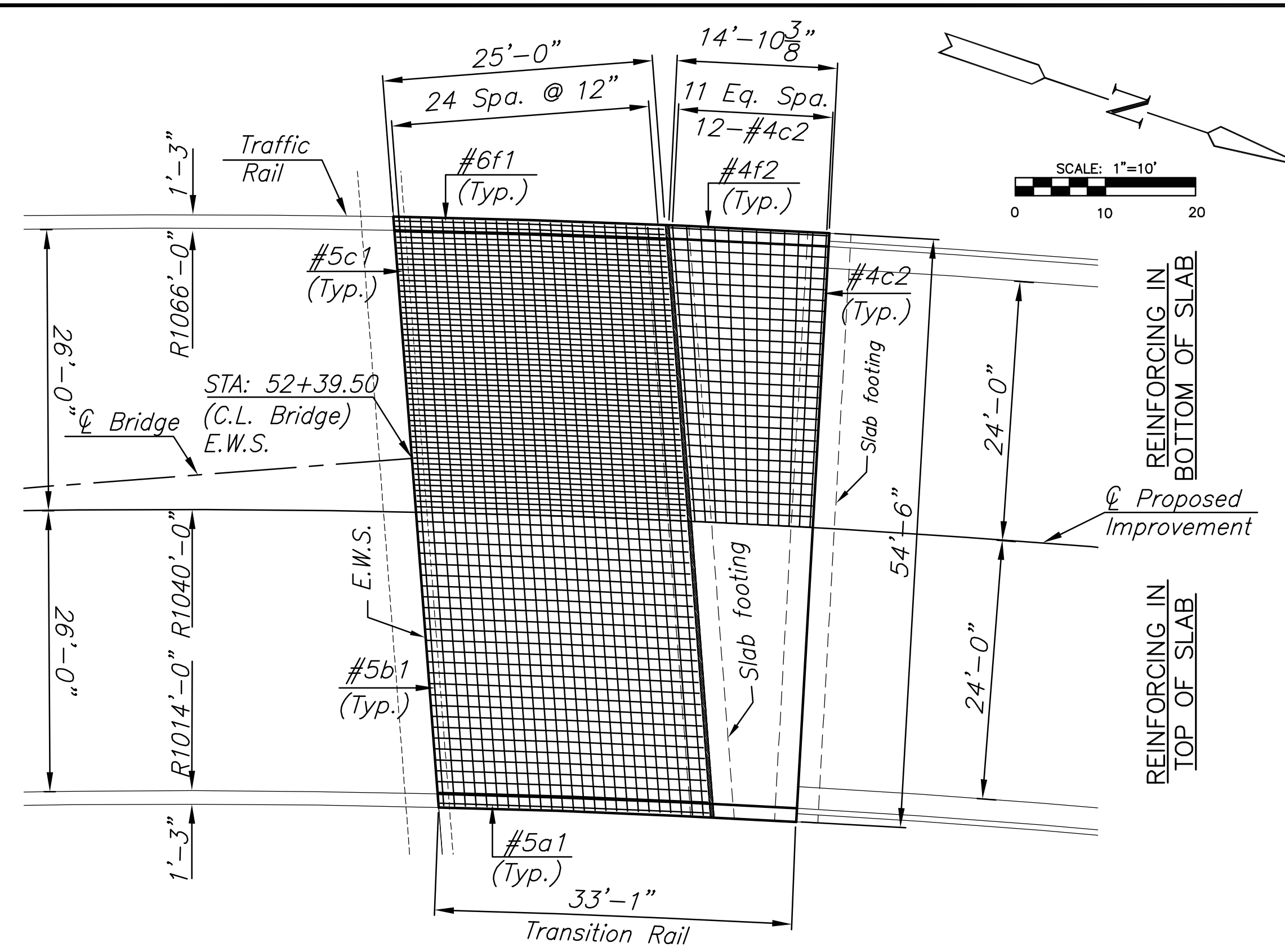

NORTH APPROACH SLAB PLAN

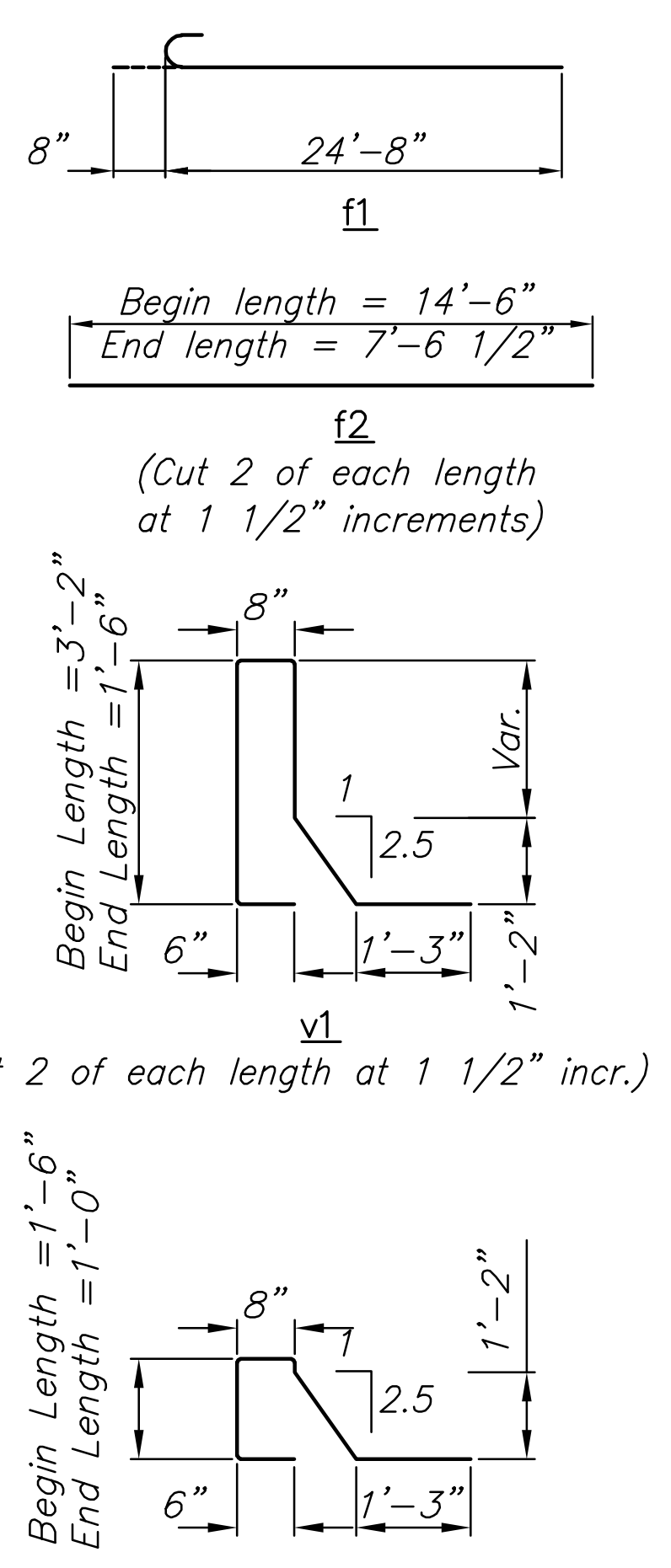

BENDING DIAGRAM

All dimensions are out to out unless otherwise noted.

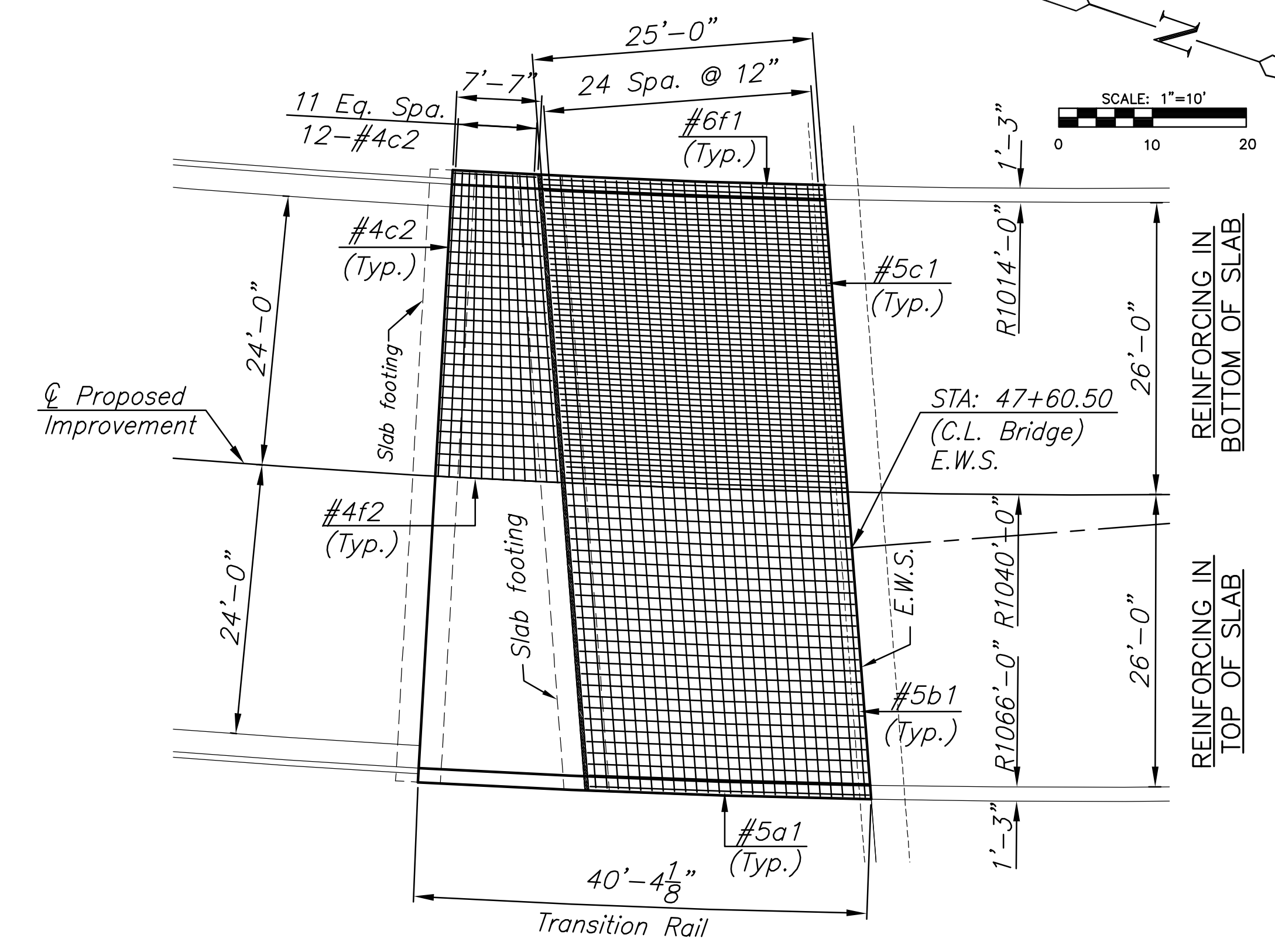

SOUTH APPROACH SLAB PLAN

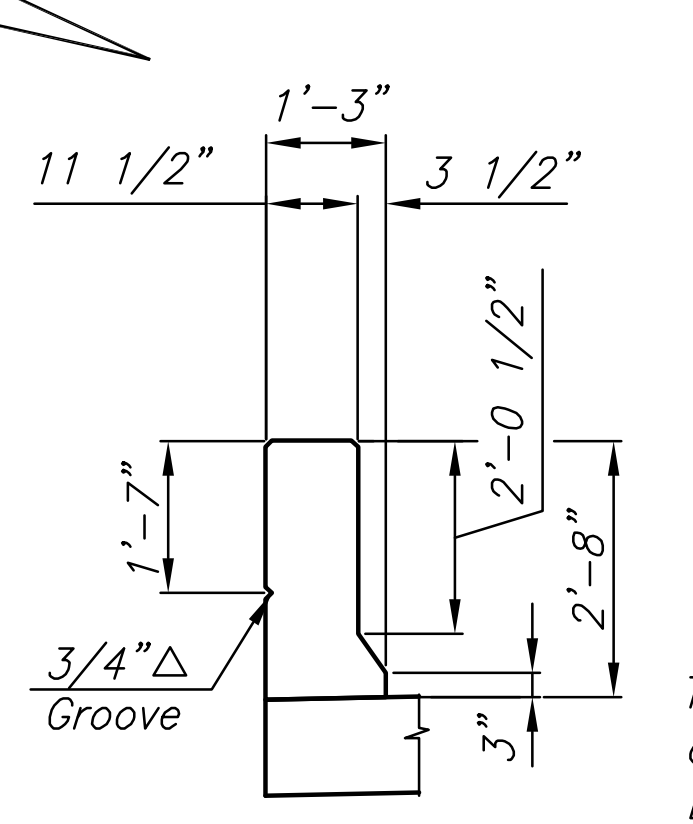

RAIL SECTION AT EWS

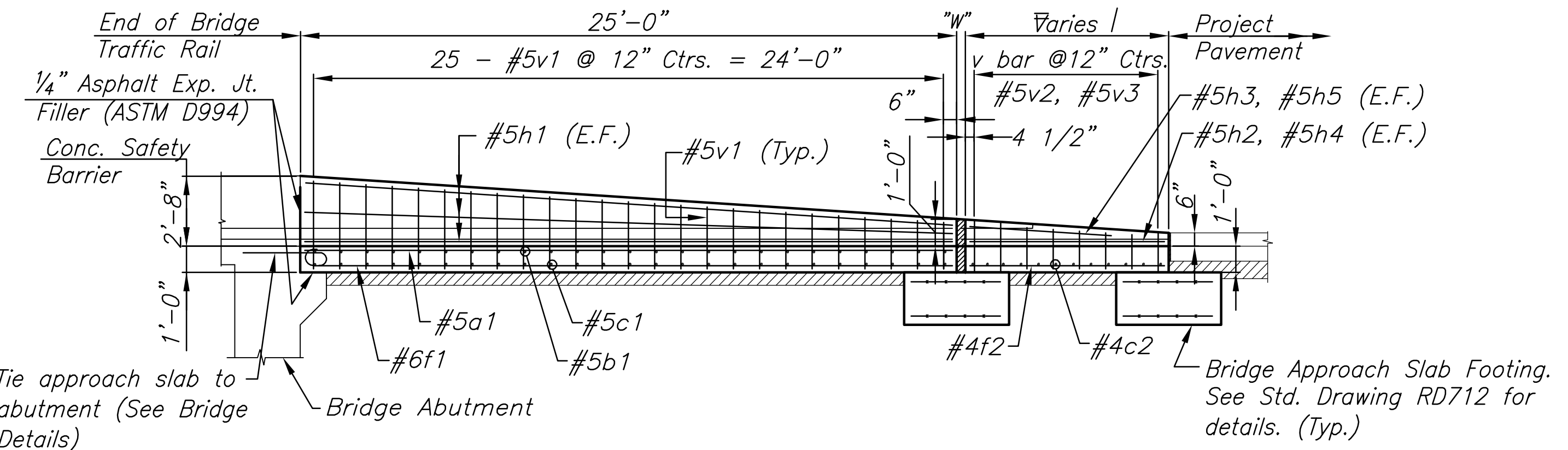

LONGITUDINAL SECTION - TRANSITION RAIL

± 7'-9" Short Rail, 15'-0" Long Rail

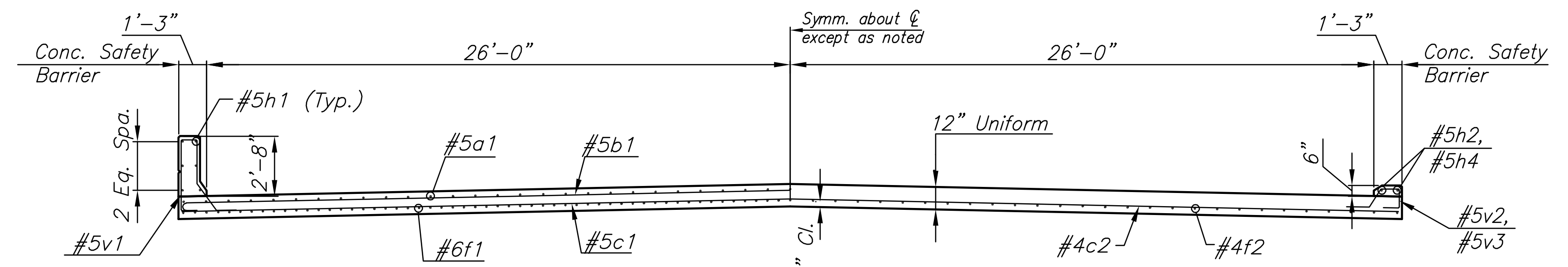

SHOWN AT EWS

SECTION

SHOWN AT END

PLOTED: Thursday, October 11, 2012 @ 10:37AM

J:\Civil\09081.dwg\Fov\09081 Appr. Details