

STATE	PROJECT NO.	YEAR	SHEET NO.	TOTAL SHEETS
KANSAS	87 N-0519-01	2012	67	212

MKEC
ENGINEERING
CONSULTANTS, INC.
411 N. WEBB ROAD
WICHITA, K.S. 67206
316-684-9600

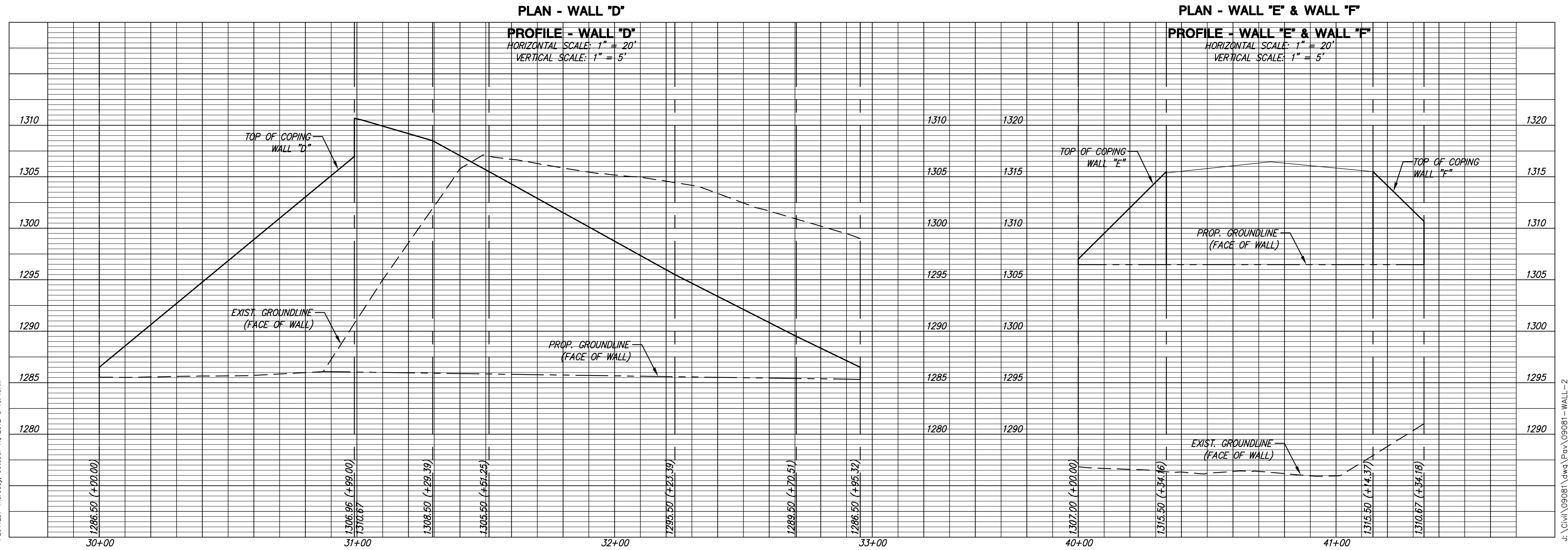

NOTES:
1. SEE SHEET 68 (MISCELLANEOUS RETAINING WALL DETAILS) FOR FINISHED GRADE AT TOP OF WALLS ADJACENT TO RETAINING WALLS.

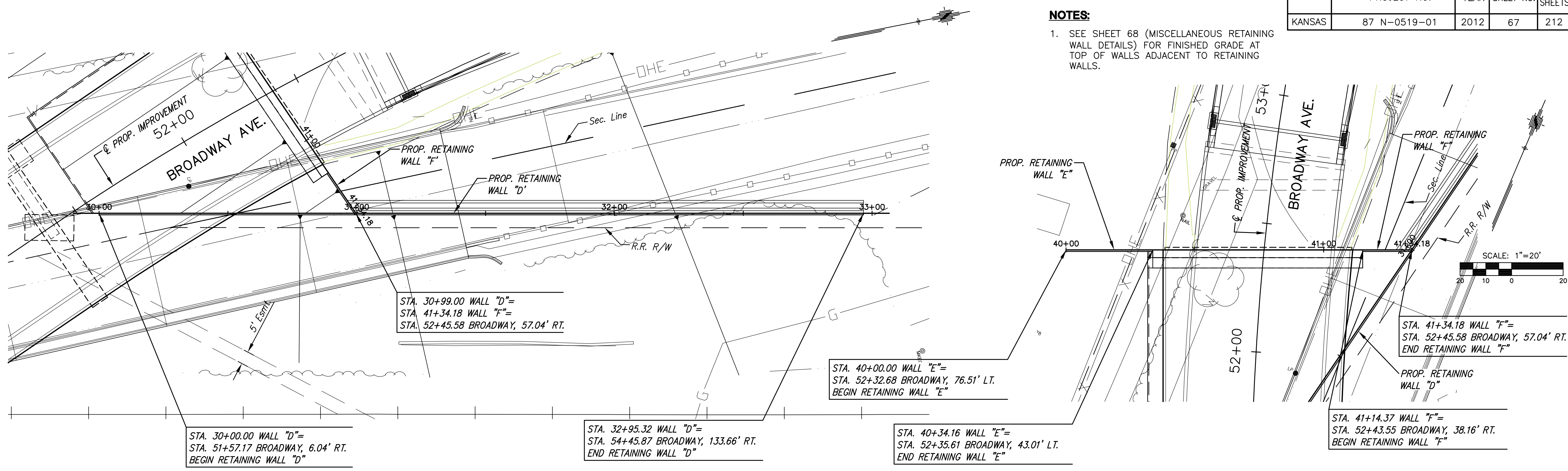

**BROADWAY BRIDGE
AT 34TH STREET SOUTH**

**WALL PLAN
AND PROFILES
WALLS "D", "E"
AND "F"**
SHEET TITLE
472-84830
PROJECT NUMBER

DESIGN BY: JRA
DRAWN BY: WNJ
CHECKED BY: JRA

ISSUED: October 9, 2012
REVISED:

SHEET NO.
67 of 212

Plot Date: Thursday, October 11, 2012 @ 10:45AM

J:\Civil\09081.dwg\Pos\09081-WALL-2