

BENCHMARKS:
 BM #1 Cross on East Edge of Sidewalk on West Side Arkansas Ave. 20' North of Centerline 36th St.
 Elev. = 1318.39 NAVD "88"

BM #2 Cross on Sidewalk on East Side Agnes St. 28' North of Centerline 36th St. 23' East of Centerline Agnes
 Elev. = 1318.70 NAVD "88"

WATER VALVE LOCATION TABLE

VALVE NUMBER	STREET	BASELINE STATION	OFFSET DISTANCE	OFFSET DIRECTION
10987	36th Street North	0+34.00	20'	Lt.
10990	36th Street North	5+73.00	28'	Lt.

P.V.I.
 Elev. = 1319.08
 No V.C.

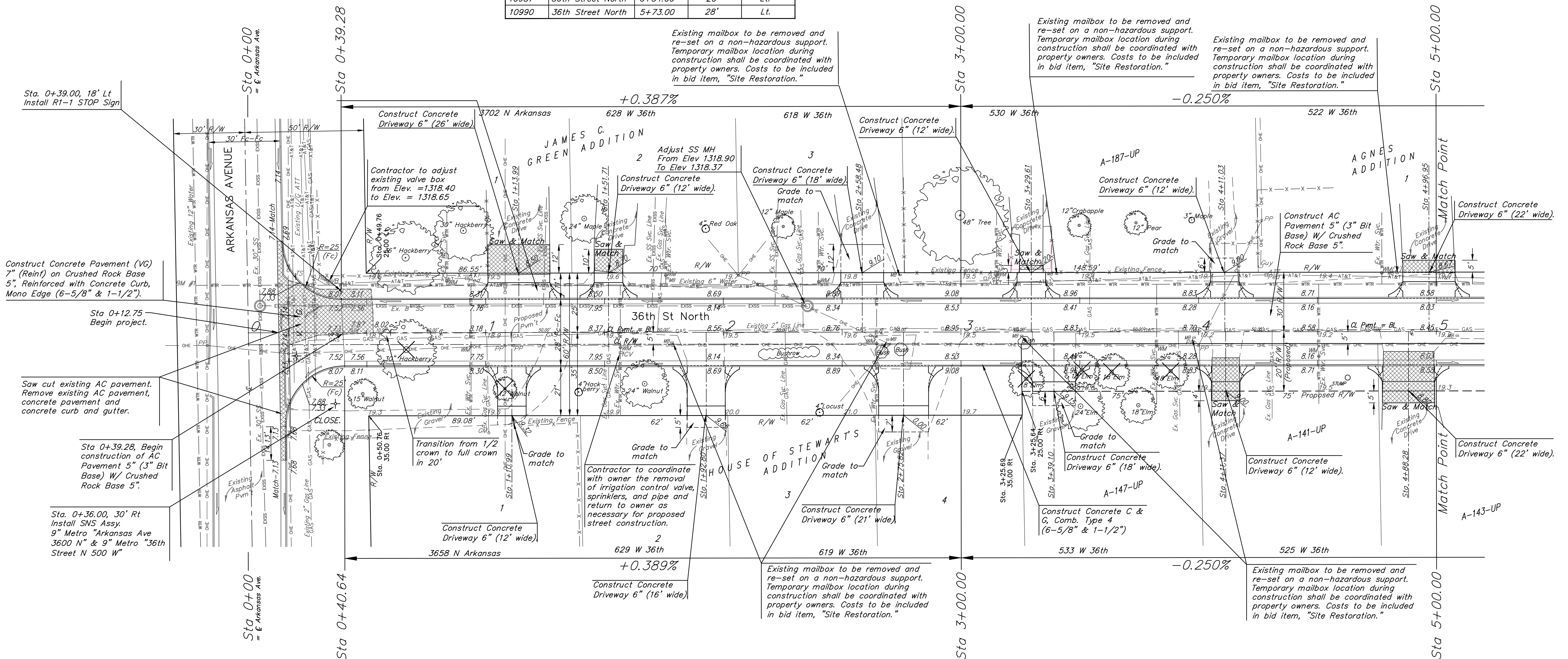
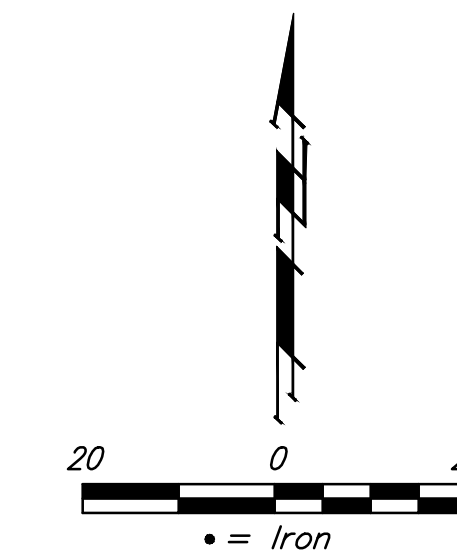

Sta. 0+39.00, 18' Lt
 Install R1-1 STOP Sign

Construct Concrete Pavement (VG)
 7" (Rein) on Crushed Rock Base
 5", Reinforced with Concrete Curb,
 Mono Edge (6-5/8" & 1-1/2").

Sta 0+12.75
 Begin project.

Saw cut existing AC pavement.
 Remove existing AC pavement,
 concrete pavement and
 concrete curb and gutter.

Sta 0+39.28, Begin
 construction of AC
 Pavement 5" (3" Bit
 Base) W/ Crushed
 Rock Base 5".

Sta. 0+36.00, 30' Rt
 Install SNS Assy.
 9" Metro "Arkansas Ave
 3600 N" & 9" Metro "36th
 Street N 500 W"

Existing mailbox to be removed and re-set on a non-hazardous support. Temporary mailbox location during construction shall be coordinated with property owners. Costs to be included in bid item, "Site Restoration."

Existing mailbox to be removed and re-set on a non-hazardous support. Temporary mailbox location during construction shall be coordinated with property owners. Costs to be included in bid item, "Site Restoration."

Existing mailbox to be removed and re-set on a non-hazardous support. Temporary mailbox location during construction shall be coordinated with property owners. Costs to be included in bid item, "Site Restoration."

Existing mailbox to be removed and re-set on a non-hazardous support. Temporary mailbox location during construction shall be coordinated with property owners. Costs to be included in bid item, "Site Restoration."

Existing mailbox to be removed and re-set on a non-hazardous support. Temporary mailbox location during construction shall be coordinated with property owners. Costs to be included in bid item, "Site Restoration."

P.V.I.
 Elev. = 1319.08
 No V.C.

Curb to be depressed through drive (1-1/2" lip curb through opening). See drive detail, sheet 9. Curb shall still be paid for as L.F. "Concrete C & G, Comb. Type 2 (6-5/8" & 1-1/2")"

Power poles, guy poles and gas mains to be relocated by respective utility companies prior to construction.

Existing driveways marked "Saw & Match" shall be saw cut at specified distance from property line, and pavement removed. Saw cut and removal to be incidental to S.F. Concrete Driveway 6", Removed

Indicates tree to be removed by contractor. To be paid for as bid items "Tree Removed, Large" (over 12") and "Tree Removed, Small" (12" and under)

All other trees shall remain and be protected from damage during construction. Overhanging limbs shall be trimmed by the Contractor only as necessary for construction and with approval of the Engineer. Cost of tree trimming to be included in bid item "Site Clearing"

		36TH STREET NORTH PAVING PLAN STA 0+00 TO 5+00	
Baughman Company, P.A. 315 Ellis St. Wichita, KS 67211 P 316-262-7271 F 316-262-0149 ENGINEERING SURVEYING PLANNING LANDSCAPE ARCHITECTURE			
PROJECT NUMBER 472-84992	DESIGN KEK	DRAWN TMS	APPROVED DATE
REVISIONS:	JFB	01/12	SCALE Noted
		SHEET 10 OF 24	