

See Sheet No. 10 for details on existing pipes.

\*Existing 2'-15"x21" CMAC's w/end sections not field located, verify size and location. Contractor shall bond 5' (Pxy Length) of 12" CMP to both ends of existing pipes and install new end sections. Total poly length=20' l.f. Fl. (N)=142.77 Fl. (S)=143.00

Construct 5" A.C. Pavement (3" Bit Base) w/ 5" Reinforced Crushed Rock Subgrade.

UTILITIES SHOWN REPRESENT THE BEST INFORMATION AVAILABLE FOR DESIGN. ADDITIONAL UTILITIES MAY BE DISCOVERED DURING CONSTRUCTION. THE CONTRACTOR SHALL BE RESPONSIBLE FOR DETERMINING THE EXACT LOCATION, DEPTH AND SIZE OF ALL UNDERGROUND UTILITIES PRIOR TO CONSTRUCTION. THE CONTRACTOR SHALL BE LIABLE FOR ANY DAMAGE CAUSED BY THE FAILURE TO DO SO.

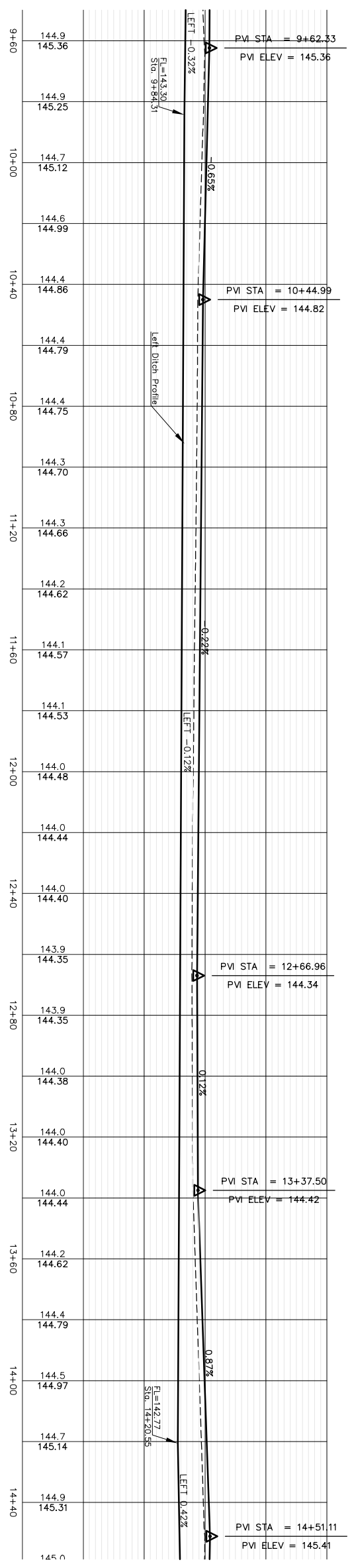
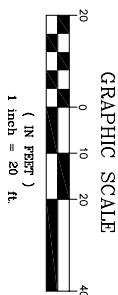

TOPOGRAPHIC SURVEY USED IN PREPARING PLANS WAS PROVIDED BY GARBER SURVEYING SERVICE, (620) 665-7032, 423 WEST FIRST AVE., HUTCHINSON, KS. ENGINEER DOES NOT GUARANTEE SURVEY ELEVATIONS FOR ACCURACY. CONTRACTOR SHALL VERIFY ELEVATIONS AND NOTIFY ENGINEER OF ANY DISCREPANCIES.

UTILITY LEGEND	
	CB = Catv Box
	FP = Flag Pole
	WW = Water Well
	SM = SS Manhole
	SH = Sprinkler Head
	WM = Water Meter
	WV = Water Valve
	GM = Gas Meter
	GV = Gas Valve
	TR = Telephone Riser
	SC = Section Corner
	SR = Set 5/8" x 24" Rebar
	MB = Mailbox
	DT = Deciduous Tree or Shrub
	CT = Coniferous Tree
	EF = Existing Fence
	PL = Property Line
	UT = Underground Telephone
	UE = Underground Electric
	OE = Overhead Electric
	WL = Water Line
	SS = Sanitary Sewer
	GL = Gas Line
	CTV = Cable TV or Fiber Optic

**STREET PAYING PLAN FOR  
54TH STREET NORTH**

CED PROJ. NO.: 20020917  
WICHITA, SEDGWICK CO., KANSAS

**CERTIFIED ENGINEERING DESIGN, P.A.**

810 WEST DOUGLAS, SUITE C  
WICHITA, KANSAS 67203  
PH. (316) 262-8608 FAX. (316) 262-1669

DESIGNED: HDF  
DRAWN: OKW  
DATE: 12/02  
SCALE: 1"=20'  
SHEET 24  
CHECKED: HDF  
CED FILE: 53-d&w&rd-Base TOTAL 74