

Plotted By: svb Date: 3/27/2015 12:44:59 PM  
 FILE: U:\Wichita\Civil\2014\14136\000\Trans\Road\DN Project\Intersection\14136-Intersection\_37th&Hillside.dgn

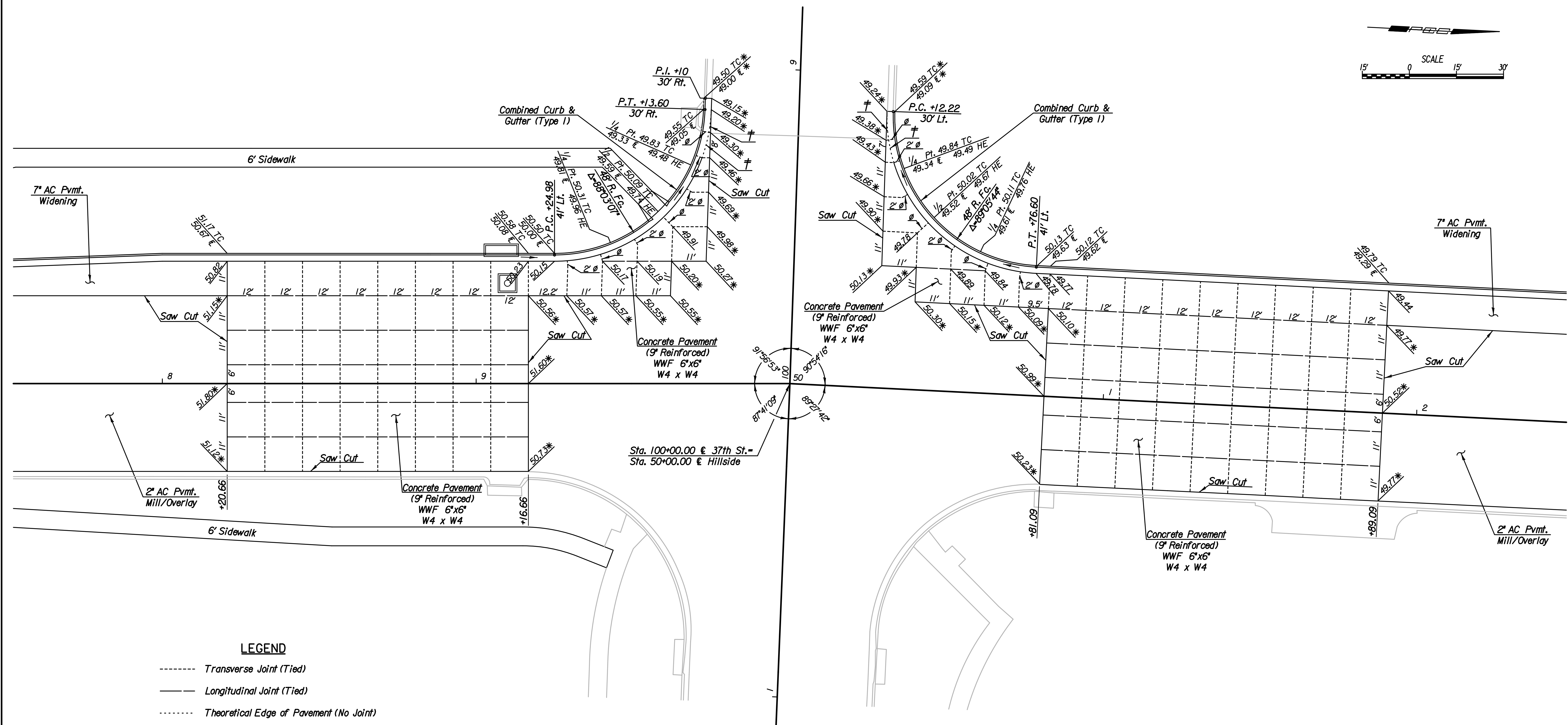
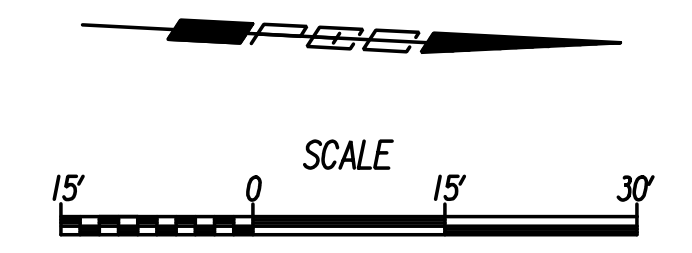

**LEGEND**

- Transverse Joint (Tied)
- Longitudinal Joint (Tied)
- ..... Theoretical Edge of Pavement (No Joint)
- \* Match Existing
- ‡ Place Pavement Integral with Curb & Gutter
- ∅ Omit Dowel or Tie Bars

See Sh. No. 11 for Joint Details.

No.	Revision	By	Date
37TH ST. AND HILLSIDE			
<b>INTERSECTION DETAILS</b>			
GARY JANZEN, P.E.—CITY ENGINEER CITY OF WICHITA PROJECT NO. 472-85161			
<b>PEC</b> PROFESSIONAL ENGINEERING CONSULTANTS, P.A. 303 SOUTH TOPEKA WICHITA, KS 67202 316-262-2691 www.pec1.com			
Designed by	JPS	Job No.	14136
Drawn by	SVB	Date	Feb., 2015
			Sht. 10 of 62