

PLOTTED: Tuesday, April 05, 2016 @ 11:46AM

PAWNEE AVENUE BRIDGE OVER ARKANSAS RIVER BRIDGE REHABILITATION IMPROVEMENTS

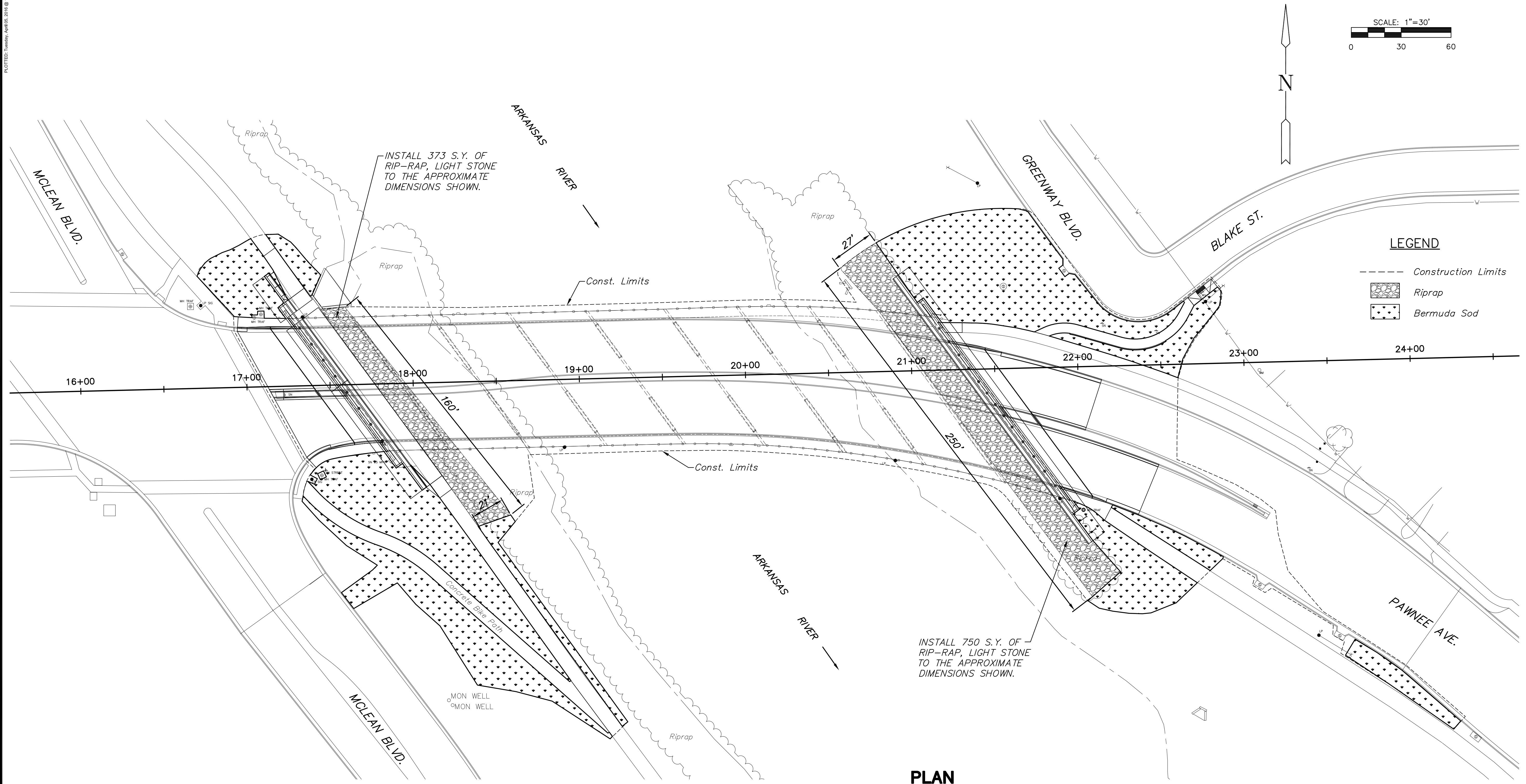

PLAN

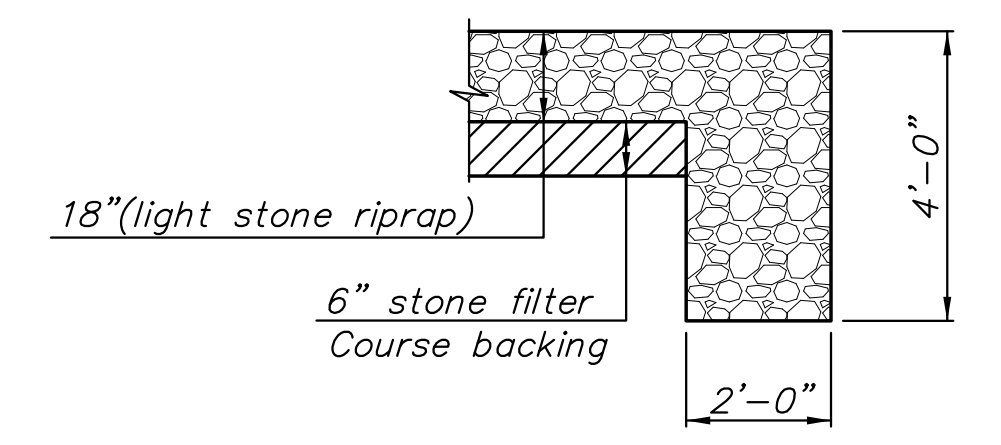

TYPICAL SECTION THRU TOEWALL
No Scale
LIGHT STONE RIPRAP DETAILS

RIPRAP NOTES:

- All riprap for this project shall be natural stone. Neither broken concrete, fabric envelope, nor Premixed dry packaged concrete bag alternates will not be allowed, unless indicated otherwise.
- Toewalls shall be installed along all unprotected Edges of stone riprap.
- Grouting of the surface of the riprap shall not be Performed, unless indicated otherwise. Grouting of the Toewalls shall be performed per city specifications.
- All materials, equipment and labor required to construct rip-rap per these plans and the standard specifications, including stone filter course, shall be Subsidiary to "Rip-rap, Light Stone".

SODDING NOTES:

- When the weather/season prevents the installation of Sod, the Contractor shall be responsible for installing Erosion Control Blanket (Curlex I, or approved equal) on all disturbed surfaces. All costs for Erosion Mat installation shall be Subsidiary to "Site Restoration".
- The sodding areas shown on the plan are approximate and based on the assumption of existing turf being damaged by construction activities. The bid price should be based on the quantity provided which conforms to this plan.

Location	Area (S.Y.)
Southwest Abutment	999
Northwest Abutment	217
Southeast Abutment	382
Northeast Abutment	918

Location	Area (S.Y.)
West	366
East	750

©2013 MKEC Engineering All Rights Reserved www.mkec.com
These drawings and their contents, including, but not limited to, all concepts, designs, & ideas are the exclusive property of MKEC Engineering (MKEC), and may not be used or reproduced in any way without the express consent of MKEC.

ROADSIDE IMPROVEMENT PLAN

PROJECT NO.	472-84922	
DATE	04/05/2016	
SCALE	1" = 30'	
DESIGNED	DRAWN	CHECKED
JRA	DPG	JRA
NO.	REVISION	DATE