

GENERAL NOTES:

- The Contractor shall comply with all applicable safety regulations. All construction shall be completed following current City Standard Specifications and Special Provisions.
- Contractor will be required to provide notice to utility companies a minimum of seventy-two (72) hours prior to any excavation, as follows:

Kansas One-Call	687-2470
-----------------	----------

The Contractor must notify the following in case of an emergency:

Cox Communications	316-260-7195
Kansas Gas Service	1-888-482-4950
Black Hills Energy	316-941-1628
Westar	316-261-6554
AT&T	1-800-286-8313
City of Wichita Water Department	262-6000
City of Wichita Sewer Maintenance	262-6000
- Utility service lines, poles, etc. are to be adjusted as necessary by others prior to construction unless the plans specifically call for their adjustment by the Contractor or unless the plans specifically identify a utility to be adjusted by its owner during construction. Existing utilities and their location, as shown on the plans, represent the best information obtainable for design. The Contractor will be required to work around existing utilities within the Right-of-Way which do not conflict with proposed construction.
- Rubble from the removal of miscellaneous structures and excess excavation which is to be wasted shall be disposed of on sites to be provided by the Contractor. These sites shall be approved by the Engineer as to suitability, appearance and site location. Locations, in the opinion of the Engineer, that will leave an unsightly appearance will not be approved. All disposal sites must be approved by the Kansas Department of Health and Environment. Material either stockpiled or disposed of in a flood plain would require a Kansas State Board of Agriculture permit. Any material dumped in waters of the United States or wetlands is subject to U.S. Corps. of Engineers permitting regulations. Any material buried or stockpiled beyond approved construction limits would require additional archaeological investigations unless buried in a previously approved borrow location.
- Trees and shrubs in public Right-of-Way which are in direct conflict with proposed new construction shall be removed by the Contractor with the Engineer's approval. Trees and shrubs which are not in direct conflict with proposed new construction shall be saved and protected from damage.
- The Contractor shall give all property owners and/or tenants of developed property abutting the construction of this project a minimum of ten (10) days notice prior to start of construction.
- The Contractor shall be responsible for preserving property irons. The Contractor will be required to re-establish any property irons which are damaged or destroyed by his construction operations. Such irons shall be re-established by a licensed land surveyor in accordance with state laws.
- The Water Distribution Division shall field locate water valves one time during construction when requested by the Contractor. It shall be the Contractor's responsibility to preserve such field locations during the construction process. Water valves, valve boxes or fire hydrants damaged during construction shall be repaired by the Contractor at his own expense. Valve boxes and water meters within the project limits shall be adjusted to match field grades.+
- If traffic is impacted by construction, a traffic control plan must be submitted and approved by the City Traffic Engineer, Brian Coon at traffic@wichita.gov before construction can begin. The Contractor shall be responsible for all traffic control measures to facilitate construction. All construction zone markings and signage shall conform to the latest version of the Manual on Uniform Traffic Control Devices (MUTCD) as published by the US Dept. of Transportation, Federal Highway Administration. All costs associated with construction markings and signage shall be the Contractors responsibility.
- All elevations shown are NAVD 88.
- All areas disturbed during construction that will not be under proposed pavement shall be restored to match existing conditions.

PAVING GATEWAY & SIERRA HILLS

to serve

Bellechase 3rd Addition

CITY OF WICHITA, KANSAS

Gary Janzen, P.E. City Engineer
 Project Number 472-85320
 O.C.A. NO. 766378

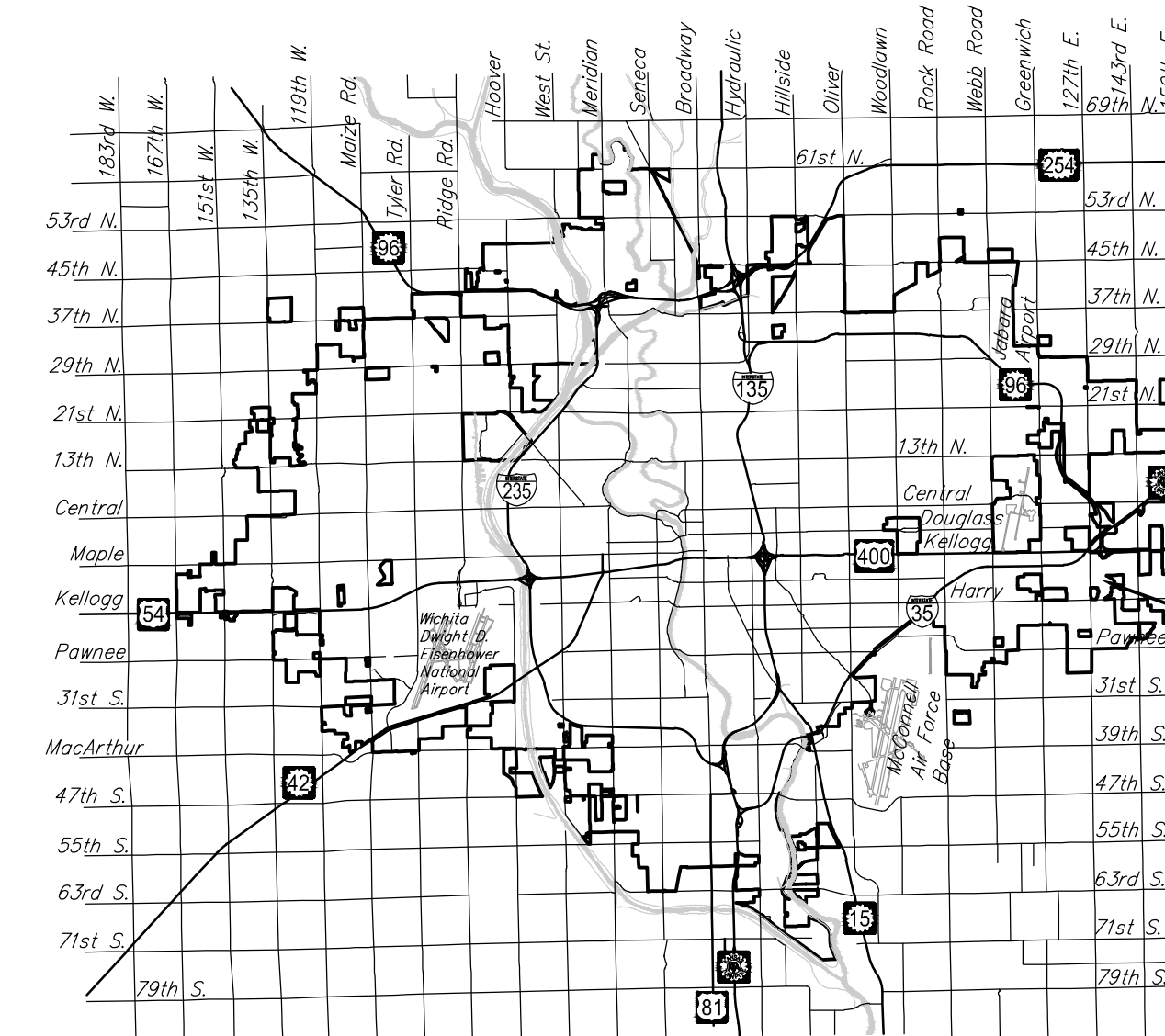

Vicinity Map

PROJECT LOCATION

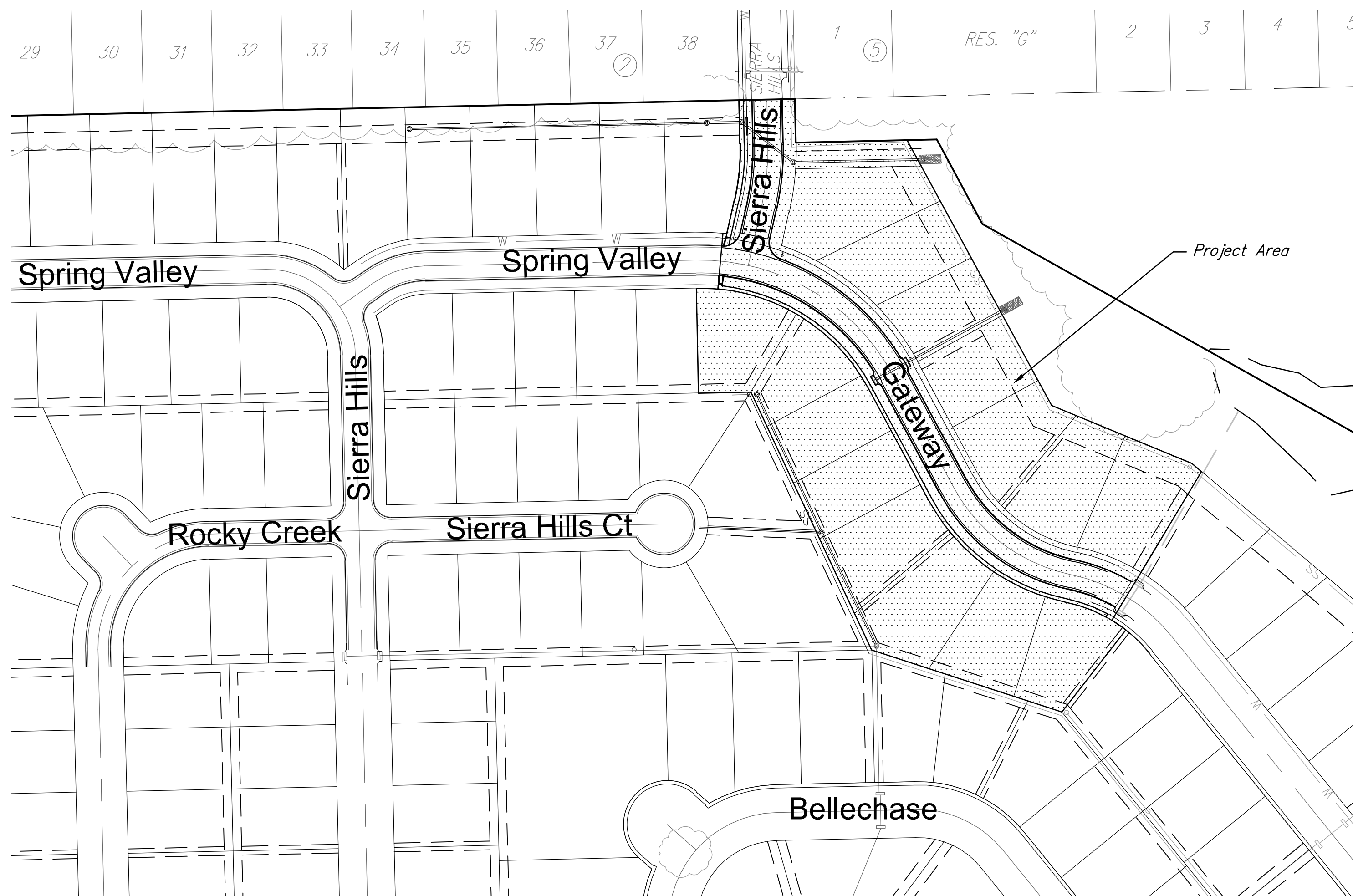

EARTHWORK QUANTITIES	
Description	Cu. Yds.
Cut	405
Fill	379
Net (Cut)	26

Sheet List Table	
Sheet	Title
1	Titlesheet
2	Curb & Gutter
3	Valley Gutter & Ramp
4	Wheelchair Ramp
5	Asphalt Paving
6	TR106 Sign Details
7	Gateway
8	Gateway
9	Sierra Hills
10	Valley Gutter Grading
11	Bubble Map
12	Bubble Map Tables
13	4 - Corner Grading Plan
14	Erosion Control Plan
15	BOC
16	Silt Fc
17	Straw Bale
18	SIP
19	SDP
20	Plat - Paving

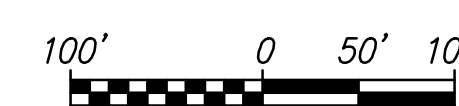

Benchmarks

BENCHMARK:
 POINT #1660
 SQUARE CUT ON THE TOP OF CURB, AT CURB
 RETURN AT THE SOUTHEAST CORNER OF ALDEN ST.
 & BELLECHASE ST.
 ELEVATION = 1,323.30 (NAVD88)

BENCHMARK:
 POINT #1659
 CHISELED SQUARE ON THE TOP OF CURB, AT CURB
 RETURN AT THE SOUTHEAST CORNER OF SPRING
 VALLEY ST. AND HORSEBACK CIR.
 ELEVATION = 1,331.27 (NAVD88)



February 2017



PLANS PREPARED BY
RUGGLES & BOHM
 ENGINEERING | SURVEYING | LANDSCAPE ARCHITECTURE | GOVERNMENT
 924 NORTH MAIN WICHITA, KANSAS 67203 P (316) 264-8008 F (316) 264-4621
 WWW.RBKANSAS.COM 4775E