

BENCHMARKS:
 "X" CUT ON TOP OF CURB INLET NORTH SIDE OF CENTRAL 96' W. OF WESTERN PROPERTY LINE OF CASTLEGATE ADDITION.
 N: 4997.42 E: 4999.10
 ELEV. = 1341.99 (NAVD88)

"X" CUT IN CURB INLET EAST SIDE OF AZURE ST. NEAR NORTH END OF CASTLEGATE ADDITION.
 N: 6320.08 E: 5589.16
 ELEV. = 1342.58 (NAVD88).

"X" CUT IN NORTH SIDE OF CURB ALONG EXISTING CINDY DRIVE, ONE JOINT BACK FROM EDGE OF PAVEMENT, NEAR EAST EDGE OF CASTLEGATE ADDITION.
 N: 5698.62 E: 6050.20
 ELEV. = 1342.38

#4 REBAR ALONG EXISTING FENCE LINE NEAR SSW CORNER OF LOT 11 BLOCK A, CASTLEGATE ADDITION.
 N: 5625.17 E: 5089.21
 ELEV. = 1343.56

*Contractor to remove all existing Tensar and replace with new Tensar throughout project.

Baseline = CL Cindy

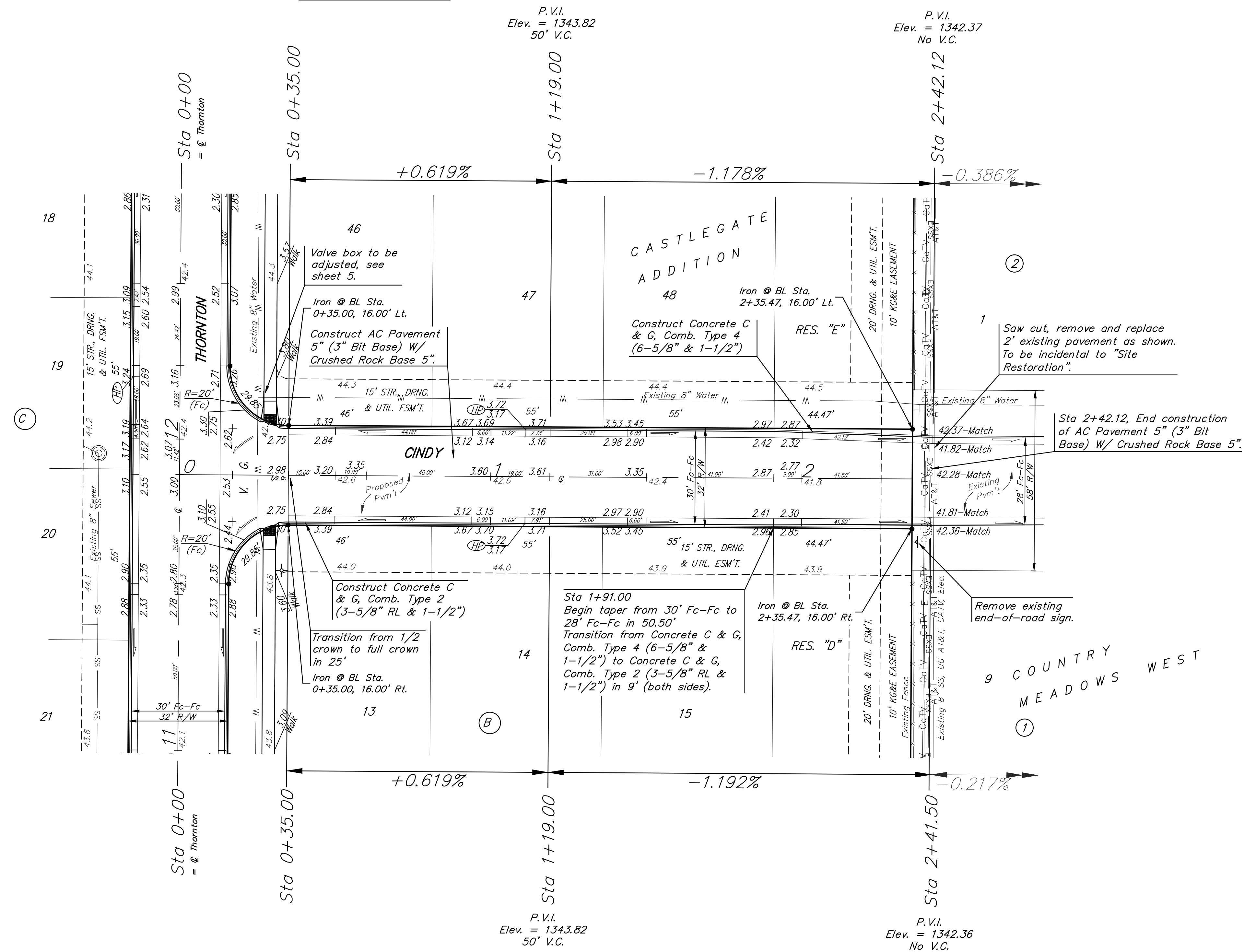
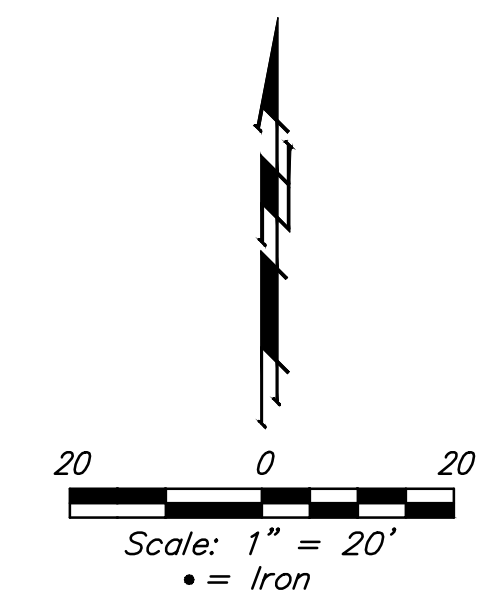

NOTE: ROLL TYPE CURB & GUTTER (TYPE 2) TO BE CONSTRUCTED ON THE PAVEMENT SHOWN ON THIS SHEET. TOP OF CURB ELEVATIONS ARE GIVEN FOR FULL HEIGHT CURB (TYPE 4).

		CASTLEGATE ADDITION	
		CINDY	
STREET IMPROVEMENTS		<small>Baughman Company, P.A. 315 Ellis St., Wichita, KS 67211 P 316-262-7271 F 316-262-0149 ENGINEERING SURVEYING PLANNING LANDSCAPE ARCHITECTURE</small>	
PROJECT NUMBER	DESIGN	DRAWN	
	NBW/JS	TMS	
REVISIONS:	APPROVED	DATE	
		06/17	
	SCALE		
	Noted		
	SHEET		
			9 OF 32