

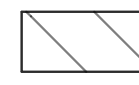





LEGEND

-  Phase 4
-  Single Post/Skid Mounted Sign
-  Channelizer
-  Tubular Marker (36")
-  Type III Barricade
-  Type III Barricade w/ Sign
-  Portable Changeable Message Board
-  Pavement Marking Removal

Note:
Contractor shall remove or cover with an approved removable tape all conflicting pavement marking that conflicts with the traffic control shown in the plans or to the discretion of the Engineer.

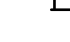

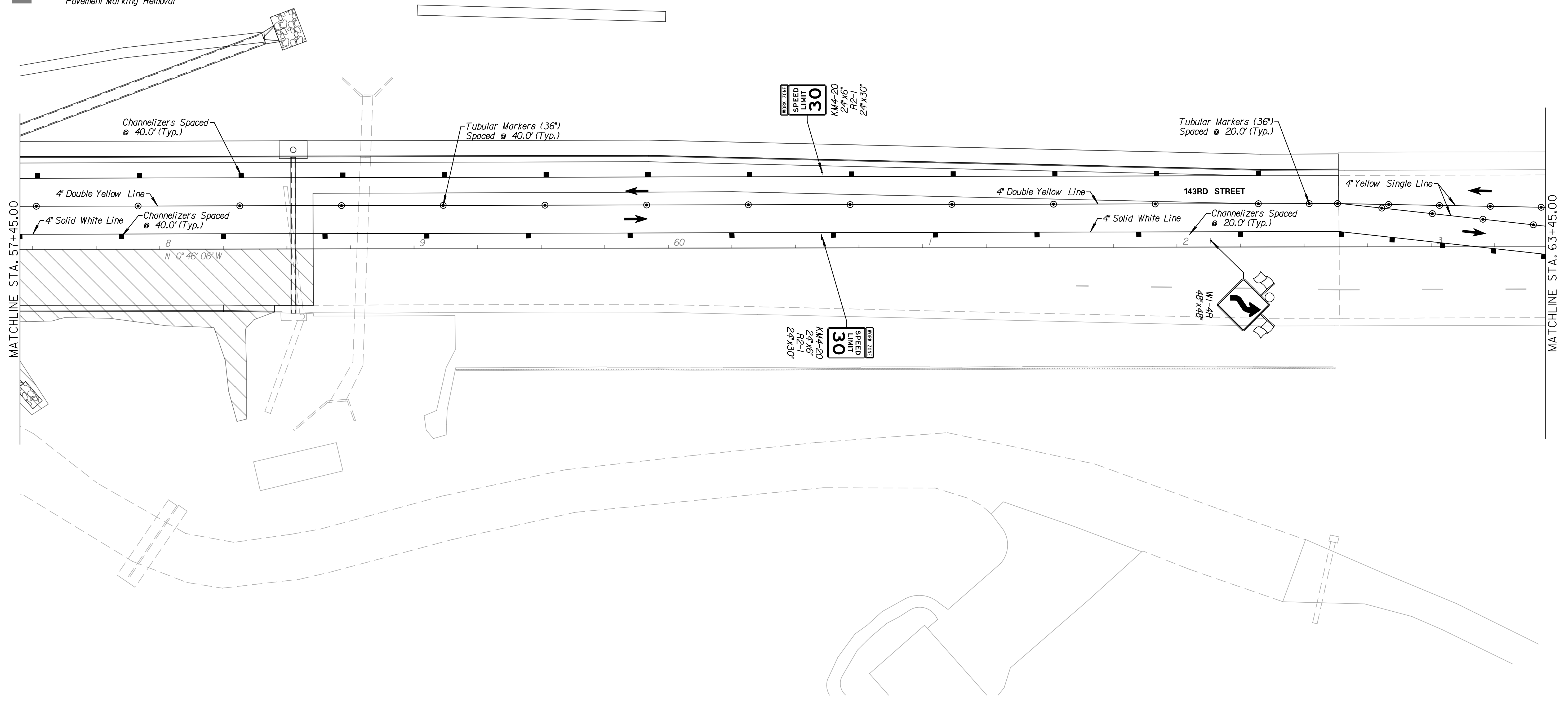
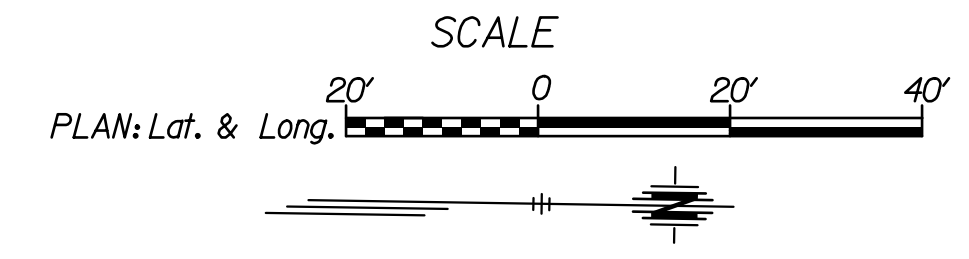
Tran Systems
 245 NORTH WACO
 SUITE 222
 WICHITA, KANSAS 67202
 PHONE: 316-303-3000
 FAX: 316-462-5629

CONSULTANTS:

143RD STREET IMPROVEMENTS
 WICHITA, KANSAS

REVISIONS:	MARK	DATE	DESCRIPTION

PROJ NO: 87 N-0614-01
 SCALE: 1"=20'
 DATE: 5/26/2017
 DESIGNED BY: TAU
 DRAWN BY: TAU
 CHECKED BY: MDB

SHEET TITLE:
143RD STREET IMPROVEMENTS TRAFFIC CONTROL PHASE 4

SHEET NO.
111

5/26/2017 11:42:20 AM c:\tran\systems\paw_ba\alltransys\paw\taum\mtd\228400\C-PP-M01-208.DGN