

SCALE: 1" = 400'

LEGEND

- EXISTING SANITARY SEWER
- EXISTING FORCE MAIN SEWER
- PROPOSED FORCE MAIN SEWER
- EXISTING SANITARY SEWER w/MANHOLE
- PROPOSED SANITARY SEWER w/MANHOLE
- PROPOSED LINE VALVE
- PROPOSED AIR RELEASE

CONDUIT/SERVICE BOX ASSEMBLY

The Contractor shall install a continuous conduit the entire length of the proposed 54" Force Main (FM 1). The conduit shall be CARLON OPTIC-GARD 1-1/4" diameter, SDR 11, PE Pipe or approved equal. The pipe shall be ribbed/smooth, orange in color, and shall contain a pre-installed poly pull rope. Where necessary, the pipe shall be jointed with metallic threaded sleeve couplings as manufactured by Carlon, or approved equal. The conduit shall be secured to the top of the 54" Force Main every 20 feet with an approved method.

The service box assembly shall be QUAZITE COMPOSITE Part No. PG3048BA18 service box (30" w x 48" L x 18" D) with a QUAZITE COMPOSITE Part No. PG3048BA00 heavy duty locking cover, or approved equal. The locking cover for the service box shall be imprinted with "CITY OF WICHITA".

The conduit entering and exiting the service box assembly shall extend to an elevation approximately 12" below grade. The pre-installed poly rope shall extend a minimum of 3' inside the service box. The service box shall be placed on a 6" crushed rock base (compacted to 95% of ASTM D698) extending a minimum of 12" around the box perimeter. A 12" wide x 12" thick concrete border (COW concrete pavement mix) shall be placed flush around the top of the service box assembly.

Service Boxes shall be installed along the route of the Force Main (FM 1) as listed in the Service Box Location table. The locations of the service boxes shown in the Service Box Location table are approximate. Maximum spacing for service boxes shall be 1,200 feet. The service boxes shall be placed along the outside limits of the Force Main excavation except where such placement would fall within a paved or unpaved vehicular travelway. Service boxes shall be situated at least 5' outside of all vehicle travelways, and in locations as approved by the Field Engineer. This work shall be considered subsidiary to the price bid for Force Main Pipe.

SERVICE BOX LOCATION TABLE	
APPROX. FM 1 STATION	OFFSET
39+60	5' Rt.
46+30	5' Rt.
54+50	5' Rt.
62+98	5' Rt.
67+89	5' Rt.
76+40	5' Rt.
81+81	5' Rt.
93+11	5' Rt.
102+73	5' Rt.
111+65	5' Rt.
115+87	5' Rt.
118+17	5' Rt.

SERVICE BOX LOCATION TABLE	
APPROX. FM 1 STATION	OFFSET
121+23	5' Rt.
132+07	5' Rt.
139+52	5' Rt.
148+30	5' Rt.
157+00	5' Rt.
166+15	5' Rt.
175+30	5' Rt.
186+48	5' Rt.
195+23	5' Rt.
199+51	5' Rt.
203+39	5' Rt.

(Approx. 17,041 L.F. conduit required.)

LEEVE CROSSING NOTES

- THE LEEVE CUT SHOULD BE NO STEEPER THAN 2 HORIZONTAL TO 1 VERTICAL AND MUST MEET OSHA SAFETY REQUIREMENTS. THE EXCAVATION SHOULD BE STEPPED TO AVOID A CONTINUOUS CONTACT AND POTENTIAL SEEPAGE PLANE AT CUT/BACKFILL INTERFACE.
- THE EXISTING LEEVE EXCAVATION SHOULD BE USED AS BACKFILL. IF DIFFERING SOIL CHARACTERISTICS ARE FOUND DURING EXCAVATION THESE SOILS SHOULD BE SEGREGATED AND REPLACED TO MATCH THE ORIGINAL LEEVE SOIL PROFILE.
- BACKFILL SHALL BE PLACED IN LIFTS OF 6 INCHES AND COMPACTED AT +/- 2% OF OPTIMAL MOISTURE CONTENT AND TO AT LEAST 95 PERCENT OF MAXIMUM STANDARD PROCTOR DENSITY.
- THE OWNER WILL PERFORM COMPACTION TESTING ON EACH LIFT.
- BEFORE THE LEEVE CUT IS MADE, THE CONTRACTOR SHALL BUILD A TEMPORARY EARTH LEEVE, MATCHING THE PROFILE OF THE EXISTING LEEVE, ON THE RIVERSIDE OF THE EXISTING LEEVE AROUND THE ANTICIPATED CONSTRUCTION AREA OF THE LEEVE CUT. THE CONTRACTOR SHALL SCHEDULE THE LEEVE CUT DURING A LOW PRECIPITATION PERIOD. AFTER THE LEEVE IS RESTORED, THE TEMPORARY LEEVE SHALL BE COMPLETELY REMOVED AND THE SITE SHALL BE RESTORED.
- CONTRACTOR SHALL MEET ALL ARMY CORP OF ENGINEERS REQUIREMENTS FOR LEEVE RESTORATION. (SEE PROJECT SPECIAL PROVISIONS).

BEDDING AND BACKFILL NOTES

- ALL BEDDING SHALL CONSIST OF TYPE 1 PIPE BEDDING MATERIAL UNDER THE BARREL OF THE PIPE EXTENDING UP TO A LEVEL EQUAL TO ONE-HALF (1/2) THE OUTSIDE PIPE DIAMETER. TYPE 3 PIPE BEDDING MATERIAL SHALL BE USED FROM THIS LEVEL TO A LEVEL TWELVE INCHES (12") ABOVE THE TOP OF THE PIPE.
- BETWEEN STA. 117+00 AND 118+38 AND BETWEEN STA. 195+40 AND 196+34, IN LIEU OF TYPE 1 BEDDING MATERIAL, FLOWABLE FILL SHALL BE PLACED UNDER THE BARREL OF THE PIPE EXTENDING UP TO A LEVEL EQUAL TO ONE-HALF (1/2) THE OUTSIDE PIPE DIAMETER. BACKFILL SHALL BE PER THE LEEVE CROSSING NOTES. CONTRACTOR SHALL PROVIDE MEANS TO PREVENT PIPE FROM FLOATING DURING INSTALLATION OF FLOWABLE FILL.
- IF SOFT SOILS ARE ENCOUNTERED IN THE BEDDING ZONE, GEOTEXTILE FABRIC SHALL BE PLACED ALONG THE TRENCH BOTTOM AND UP THE SIDES OF THE TRENCH TO A LEVEL TWELVE INCHES (12") ABOVE THE TOP OF THE PIPE. THE GEOTEXTILE FABRIC SHALL BE PAID FOR PER LINEAR FOOT OF TRENCH AS THE BID ITEM "GEOTEXTILE FABRIC"

PHASE 2 SEQUENCING

- ALL WORK IN CHAPIN PARK SHALL BE COMPLETED BY MARCH 16, 2018.
- THE REMAINING WORK ON FORCE MAIN LINE NO. 1 SHALL BE COMPLETED, EXCEPT FOR THE CONNECTION TO THE EXISTING 60" PIPE AT STA. 203+38.73. THE WORK IN MACARTHUR ROAD AND 47TH STREET MUST BE SCHEDULED SO AS BOTH STREETS ARE NOT CLOSED AT THE SAME TIME. THE PROPOSED WATERLINE VALVES LOCATED NEAR THE STREET CROSSINGS SHALL BE INSTALLED BEFORE CONSTRUCTION OF THE FORCE MAIN ACROSS THE ROAD TO ALLOW FOR WATERLINE ISOLATION.
- COMPLETE PRESSURE TESTING OF FORCE MAIN LINE NO. 1
- THE CONNECTION AT STA. 203+38.73 SHALL BE MADE. THE EXISTING 60" VALVE LOCATED TO THE NORTH OF THIS CONNECTION SHALL BE CLOSED SO THAT ALL FLOW IN THE EXISTING FORCE MAIN IS DIRECTED TO THE NORTH CLARIFIER. THE SOUTH CLARIFIER SHALL BE DRAINED AND THE CONNECTION TO THE 60" RCP SHALL BE MADE. THIS WORK SHALL BE COORDINATED WITH WICHITA WASTEWATER STAFF
- THE 60" VALVE LOCATED NORTH OF THE CONNECTION SHALL BE REOPENED AND ALL FLOW FROM PLANT 1 SHALL BE DIVERTED THROUGH THE PROPOSED FORCE MAIN. THE SOUTH VALVE OF THE PHASE 1 CROSS CONNECTION ASSEMBLY SHALL BE OPENED AND THE WEST VALVE OF THE PHASE 1 CROSS CONNECTION ASSEMBLY SHALL BE CLOSED TO PREVENT FLOW INTO THE EXISTING FORCE MAIN.
- INSTALL TEMPORARY PLUG IN THE EXISTING 60" RCP LINE TO THE SOUTH OF THE BUTTERFLY VALVE (NORTH PART OF THE WWP #2 PROPERTY). INSTALL TEMPORARY PLUG AND BYPASS ALL FLOW WEST FROM THE BUTTERFLY VALVE TO THE CLARIFIER(S). Dewater and flush the existing force main line. THIS WORK SHALL BE COORDINATED WITH WICHITA WASTEWATER STAFF REGARDING THE ALLOWABLE FLOWS TO BE BROUGHT INTO THE EXISTING CLARIFIERS FROM DEWATERING OPERATIONS.

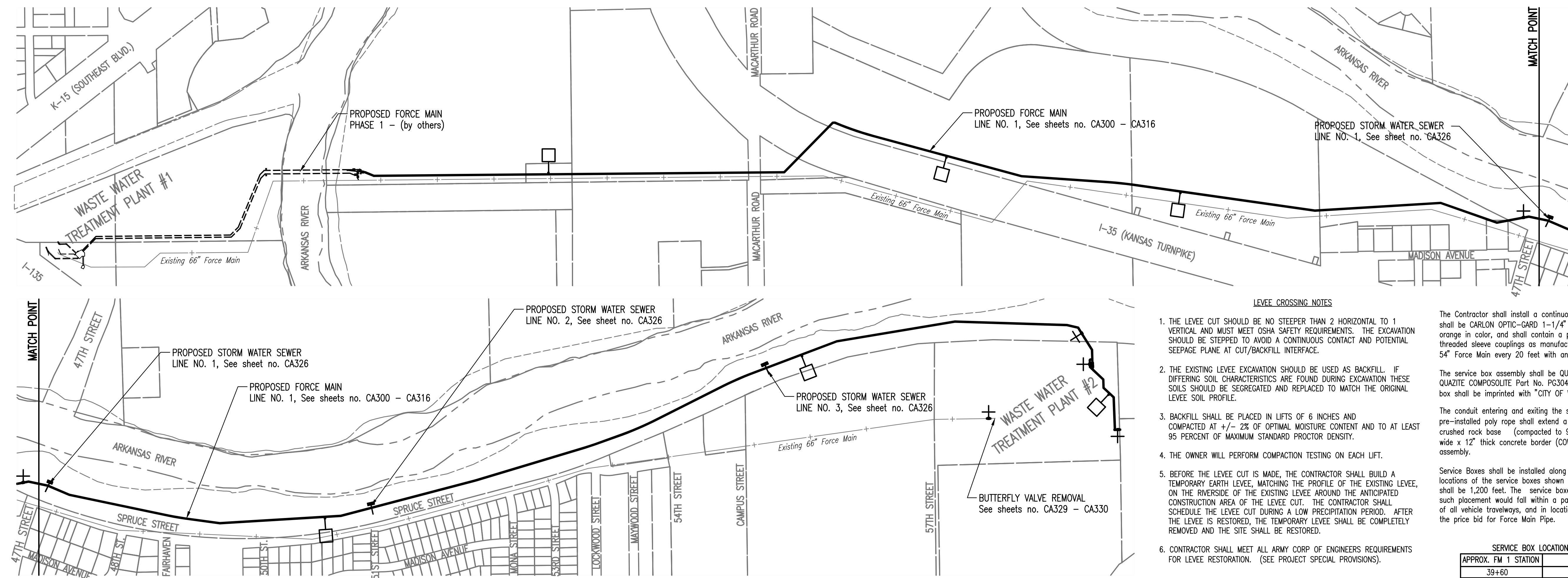

- ALL CONSTRUCTION AND MATERIALS TO COMPLY WITH CITY OF WICHITA SPECIFICATIONS AND STANDARDS, UNLESS OTHERWISE NOTED.
- EACH BIDDER SHALL VISIT THE SITE OF THE PROJECT BEFORE SUBMITTING THE PROPOSAL FOR THIS WORK SO THAT HE WILL BE FULLY INFORMED OF THE EXISTING FIELD CONDITIONS AND THE OBSTACLES WHICH MIGHT BE ENCOUNTERED. UPON AWARD OF THE CONTRACT, THE CONTRACTOR WILL NOT BE GRANTED ANY ADDITIONAL COMPENSATION WITH REGARDS TO TIME AND MONEY FOR CONDITIONS THAT MAY HAVE BEEN EVALUATED DURING ANY INSPECTION OF THE SITE.
- ALL ELEVATIONS SHOWN ARE BASED ON NAVD 88 DATUM.
- AT LEAST 72 HOURS PRIOR TO BEGINNING EXCAVATION (EXCLUDING WEEKENDS AND HOLIDAYS), THE CONTRACTOR SHALL CONTACT THE KANSAS ONE-CALL SYSTEM, A UTILITY LOCATION SERVICE, AT (316) 687-2470 OR 811 TO REQUEST THE LOCAL UTILITY COMPANIES MARK ANY EXISTING LINES WITHIN THE PROJECT AREA.
- THE CONTRACTOR MUST NOTIFY THE FOLLOWING IN CASE OF AN EMERGENCY:
 

EMERGENCY DISPATCH	911
COX COMMUNICATIONS	316-260-7745 - MARC HENDERSON
KANSAS GAS SERVICE	316-832-3128 - JIM COE
PHILLIPS 66	316-681-2081 - SCOTT SALSBUURY
SOUTHERN STAR	316-529-6620 - STACY CATLIN
WESTAR ENERGY	316-261-6264 - ZACH LAWS
BLACK HILLS ENERGY	800-324-9696 - GAS CONTROL
AT&T	316-268-2008 - JASON EDWARDS
WICHITA WATER UTILITIES (SS AND WL)	316-262-6000
WICHITA WASTE WATER TREATMENT	316-303-8702 - BECKY LEWIS
WICHITA ENVIRONMENTAL HEALTH	316-268-8318 - SHAWN MALONEY
KANSAS TURNPIKE AUTHORITY INCIDENT MANAGEMENT CENTER	316-652-2611
KANSAS TURNPIKE AUTHORITY FIBER OPTIC CONTACT	316-347-6727 - CHRIS HULETT
- THE CONTRACTOR SHALL GIVE ALL PROPERTY OWNERS AND/OR TENANTS OF DEVELOPED PROPERTY ADJUTING THE CONSTRUCTION OF THIS PROJECT A MINIMUM OF TEN (10) DAYS ADVANCE NOTICE PRIOR TO START OF CONSTRUCTION.
- THE CONTRACTOR SHALL NOT START WORK ON THE PROJECT UNTIL THE PROJECT INSPECTOR IS ASSIGNED AND IS PRESENT ON THE SITE. ANY WORK DONE WITHOUT INSPECTION WILL BE REQUIRED TO BE UNCOVERED FOR INSPECTION AT THE CONTRACTORS EXPENSE.
- EXISTING UTILITIES AND THEIR LOCATION, AS SHOWN ON THE DRAWINGS, REPRESENT THE BEST INFORMATION OBTAINABLE FOR DESIGN. LOCATION INFORMATION HAS BEEN OBTAINED FROM THE VARIOUS UTILITY COMPANIES AND IS EITHER FROM COMPANY RECORD DRAWINGS OR COMPANY PROVIDED FIELD LOCATIONS. THE CONTRACTOR SHALL PROVIDE THE MATERIAL AND MEANS TO PROTECT AND SUPPORT SAID UTILITIES DURING CONSTRUCTION TO THE SATISFACTION OF THE UTILITY OWNER. IT SHOULD BE NOTED THAT OTHER BURIED LINES AND CABLES MAY EXIST WHICH ARE NOT SHOWN ON THESE DRAWINGS. THE CONTRACTOR SHALL HAVE ALL BURIED LINES LOCATED AND FLAGGED IN THE FIELD PRIOR TO COMMENCING WORK. THE CONTRACTOR SHALL CONTACT THE ENGINEER AND REVIEW ALL BURIED LINES LOCATED TO DETERMINE IF CONFLICTS EXIST. THE CONTRACTOR SHALL EXERCISE EXTREME CAUTION DURING TRENCHING OPERATIONS TO AVOID DAMAGING THESE LINES. ANY LINES DAMAGED SHALL BE REPLACED OR REPAIRED IMMEDIATELY AS DIRECTED BY THE ENGINEER AT THE CONTRACTOR'S EXPENSE.
- THE CONTRACTOR SHALL BE RESPONSIBLE FOR PRESERVING PROPERTY IRONS. THE CONTRACTOR WILL BE REQUIRED TO RE-ESTABLISH ANY PROPERTY IRONS WHICH ARE DAMAGED OR DESTROYED BY HIS CONSTRUCTION OPERATIONS. SUCH IRONS SHALL BE RE-ESTABLISHED BY A LICENSED LAND SURVEYOR IN ACCORDANCE WITH STATE LAWS. ALL COSTS FOR THIS WORK SHALL BE SUBSIDIARY TO THE LUMP SUM PRICE BID FOR "SITE RESTORATION".

- EASEMENTS AND RIGHT-OF-WAY PROVIDED BY THE OWNER FOR THE PROJECT ARE SHOWN ON THE DRAWINGS. THE CONTRACTOR SHALL BE RESPONSIBLE FOR THE ACQUISITION OF ANY ADDITIONAL TEMPORARY EASEMENTS OR RIGHT-OF-WAY THAT HE DESIRES TO USE IN COMPLETING THE WORK.
- RUBBLE FROM THE REMOVAL OF MISCELLANEOUS STRUCTURES INCLUDING ANY TREES REMOVED, TREE TRIMMINGS, AND EXCESS EXCAVATION WHICH IS TO BE WASTED SHALL BE DISPOSED OF ON SITES PROVIDED BY THE CONTRACTOR. THESE SITES SHALL ALSO BE APPROVED BY THE ENGINEER AS TO SUITABILITY, APPEARANCE, AND SITE LOCATION. LOCATIONS THAT, IN THE OPINION OF THE ENGINEER, WILL LEAVE AN UNSIGHTLY APPEARANCE WILL NOT BE APPROVED. ALL DISPOSAL SITES MUST BE APPROVED BY THE KANSAS DEPARTMENT OF HEALTH AND ENVIRONMENT. MATERIAL EITHER STOCKPILED OR DISPOSED OF IN A FLOOD PLAIN WILL REQUIRE A KANSAS STATE BOARD OF AGRICULTURE PERMIT. ANY MATERIAL DUMPED IN WATERS OF THE UNITED STATES OR WETLANDS IS SUBJECT TO U.S. CORPS OF ENGINEERS PERMITTING REGULATIONS. ANY MATERIAL BURIED OR STOCKPILED BEYOND APPROVED CONSTRUCTION LIMITS MAY REQUIRE ARCHAEOLOGICAL INVESTIGATIONS UNLESS BURIED IN A PREVIOUSLY APPROVED DISPOSAL LOCATION.
- THE CONTRACTOR SHALL AVOID REMOVAL OR TRIMMING OF ANY TREES OR SHRUBS WHERE POSSIBLE. WHERE THE CONTRACTOR BELIEVES THE REMOVAL OR TRIMMING IS UNAVOIDABLE, HE SHALL COORDINATE SUCH WORK WITH THE ENGINEER. TREES ADJACENT TO THE TRENCH THAT ARE REMOVED SIMPLY FOR ACCESS SHOULD BE CUT AT GROUND LEVEL TO PRESERVE THE ROOT SYSTEM TO MAINTAIN SOIL STABILITY. COSTS FOR TREE/SHRUB REMOVAL AND TRIMMING REGARDLESS OF SIZE SHALL BE CONSIDERED SUBSIDIARY TO THE LUMP SUM PRICE BID FOR "SITE CLEARING".
- THE CONTRACTOR SHALL RESTORE ALL DITCHES, SWALES, ROAD SHOULDERS, AND BANKS TO THEIR ORIGINAL SLOPES AND GRADES. WHERE EXISTING ENTRANCE PIPE, DRAINAGE PIPE, SIGNS, FENCES, IRRIGATION, LANDSCAPING, ETC., CONFLICT WITH THE PROPOSED WORK HEREIN, THEY SHALL BE REMOVED AND REPLACED OR RESET, UNLESS OTHERWISE NOTED ON THE DRAWINGS. THE REPLACEMENT OF ALL THE AFOREMENTIONED ITEMS, INCLUDING SEEDING, FERTILIZER, AND MULCHING SHALL BE CONSIDERED SUBSIDIARY TO "SITE RESTORATION".
- THE CONTRACTOR SHALL INSTALL AND/OR MAINTAIN EROSION CONTROL METHODS AS SPECIFIED ON SHEET CA400-CA402. THE CONTRACTOR SHALL BE RESPONSIBLE FOR MAINTAINING THE EROSION CONTROL SHOWN THROUGH THE COMPLETION OF THIS PROJECT. INSTALLATION OF THESE BMP'S DOES NOT RELIEVE THE CONTRACTOR OF THE RESPONSIBILITY OF ABATING SOIL EROSION.
- THE CONTRACTOR SHALL TAKE CARE TO PREVENT SILT AND DEBRIS FROM ENTERING ANY STORM DRAINAGE SYSTEM DURING CONSTRUCTION. PIPES OR STRUCTURES WHICH CONTAIN MATERIALS FROM THE CONTRACTORS ACTIVITIES SHALL BE THOROUGHLY CLEANED BY THE CONTRACTOR, AT HIS OWN EXPENSE, PRIOR TO THE FINAL INSPECTION.
- ALL LAWN/TURF AREAS DISTURBED BY CONSTRUCTION OF THE PROPOSED IMPROVEMENTS SHALL BE RESTORED WITH A MIXTURE OF RYEGRASS (50 LBS PER ACRE) AND BUFFALO GRASS (200 LBS PER ACRE). RESTORATION OF DISTURBED AREAS SHALL INCLUDE, BUT NOT BE LIMITED TO, TOP SOIL PREPARATION, SEEDING, MULCH, AND/OR RESEEDING. ALL SEEDING/SODDING WORK SHALL BE IN ACCORDANCE WITH THE CITY OF WICHITA STANDARD SPECIFICATIONS AND THE CITY OF WICHITA ADMINISTRATIVE REGULATION NO. AR6.5 WHICH GOVERNS CLEANUP AND RESTORATION OR REPLACEMENT FOLLOWING CONSTRUCTION. ALL COSTS FOR THIS WORK SHALL BE SUBSIDIARY TO THE LUMP SUM PRICE BID FOR "SITE RESTORATION".
- THE CONTRACTOR SHALL SEED ALL AREAS DISTURBED BY CONSTRUCTION ACTIVITIES WITH TEMPORARY RYE GRASS. RYE GRASS SEED SHALL BE PLANTED AT A MINIMUM RATE OF SIX (6) POUNDS PER ONE THOUSAND (1,000) SQUARE FEET. THIS TEMPORARY SEEDING MAY BE OMITTED ONLY IF OTHER SEEDING IS REQUIRED IN ACCORDANCE WITH GENERAL NOTE NO. 16 ABOVE. TEMPORARY SEEDING OR PERMANENT SEEDING/SODDING SHALL BE APPLIED WITHIN 14 DAYS AFTER THE AREA HAS BEEN DISTURBED.

- THE CONTRACTOR SHALL PREVENT ANY CONSTRUCTION DEBRIS FROM ENTERING THE EXISTING SANITARY SEWER DURING CONSTRUCTION.
- THE CONTRACTOR IS REQUIRED TO MAINTAIN CONTINUOUS FLOW OF SEWAGE IN EXISTING SANITARY SEWERS AT ALL TIMES.
- THE CONTRACTOR SHALL LIMIT THE EXTENT OF TRENCH TO REMAIN OPEN OVERNIGHT AND WEEKENDS TO LESS THAN 50 FEET. ANY EXCAVATED AREAS SHALL BE FENCED.
- THE TEST PRESSURE FOR THE NEWLY CONSTRUCTED FORCE MAIN SHALL BE 100 PSI. ALL FITTINGS, PIPE, AND APPURTENANCES INSTALLED SHALL HAVE A PRESSURE RATING OF 100 PSI (MIN.).
- PIPE DEFLECTIONS AT A JOINT SHALL NOT EXCEED THE MANUFACTURERS RECOMMENDATIONS. IF PIPE DEFLECTIONS SHOWN IN THE PLANS EXCEED THE MAXIMUM PIPE DEFLECTIONS ALLOWABLE PER THE PIPE MANUFACTURER'S RECOMMENDATIONS, THESE PIPE DEFLECTIONS MAY BE ACCOMPLISHED THROUGH MORE THAN ONE JOINT.
- ALLOWABLE PIPE OPTIONS FOR THE PROPOSED 54" PIPING SHALL BE FIBERGLASS.
- THE CONTRACTOR SHALL RESTRAIN ALL BENDS, TEES, VALVES AND PIPE THROUGH THE USE OF FIBERGLASS COUPLINGS WITH LOCKING RODS OR AS SPECIFIED, AT THE MINIMUM LENGTHS AS SHOWN IN THE PLANS. RESTRAINED JOINT PIPE WILL NOT BE BID SEPARATELY AND SHALL BE INCLUDED IN THE PRICE BID FOR PIPE IN PLACE.
- CONTRACTOR TO OBTAIN APPROVAL FROM SOUTHERN STAR TO WORK WITHIN 33 FEET OF ITS PIPELINES. CONTACT KEVIN SCHEER, OPERATIONS TEAM LEAD, AT 316-303-7800 (ALTERNATE CONTACT 800-324-9696)
- NO CONSTRUCTION EQUIPMENT SHALL BE ALLOWED ON SURFACE ABOVE OR WITHIN 10 FEET OF THE EXISTING 66" RCP FORCE MAIN. FROM FM 1 STA. 33+21 TO STA. 63+50 AND STA. 81+80 TO STA. 116+40, TEMPORARY FENCING SHALL BE INSTALLED 10 FEET OFF OF THE EXISTING FORCE MAIN TO PREVENT CONSTRUCTION EQUIPMENT FROM ENTERING THE AREA. THIS WORK SHALL BE CONSIDERED SUBSIDIARY TO THE PROJECT.
- THE CONTRACTOR SHALL BE RESPONSIBLE FOR THE REPLACEMENT/RESTORATION OF ANY DAMAGED PAVEMENTS OR ROADWAYS. THIS WORK SHALL BE CONSIDERED SUBSIDIARY TO "SITE RESTORATION".
- DUE TO POTENTIAL SOIL CONTAMINATION AND METHANE GAS, ALL CONTRACTOR PERSONNEL WORKING IN THE PIPE TRENCH OR STRUCTURE EXCAVATION WITHIN CHAPIN PARK AND BOEING PROPERTY SHALL CARRY AIR MONITORING DEVICES IN ACCORDANCE WITH THE OCCUPATIONAL SAFETY AND HEALTH ADMINISTRATION REGULATIONS.
- CONTRACTOR SHALL INSTALL FORCE MAIN WARNING SIGNS AT LOCATIONS AS SHOWN ON THE PLANS AS APPROVED BY THE FILED ENGINEER.
- THE CONTRACTOR SHALL MEET ALL THE REQUIREMENTS IN THE SANITARY SEWER AND TEMPORARY CONSTRUCTION EASEMENT AGREEMENTS.
- THE EASEMENT AGREEMENTS FOR THE BOEING IRB ASSET TRUST PROPERTY ARE EXPECTED TO BE FINALIZED BY SEPTEMBER 1, 2018. THE CONTRACTOR SHALL NOT ENTER THE PROPERTY UNTIL NOTIFIED THAT THE EASEMENTS ARE HAVE BEEN RECORDED.

Served 07-17-2017 11:28:36 AM by KURTIS DEKAT  
 Plot Scale 1:1 07-17-2017 11:30:48 AM by KURTIS DEKAT  
 U:\Wichita-Civil\2015\15554\001\Main\Drawings\Phase 2\15554-001-KEY MAP AND GENERAL NOTES

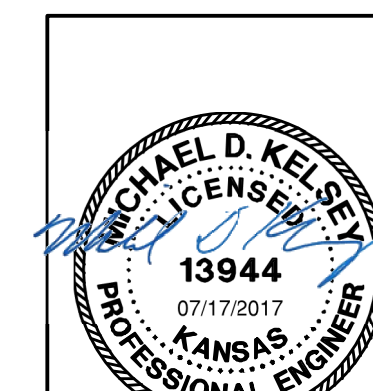

No.	Revision	By	Date
<b>WASTEWATER PLANT 2</b> <b>INFLEUNT FORCE MAIN - PHASE 2</b> <b>KEY MAP AND GENERAL NOTES</b> GARY JANZEN, P.E. - CITY ENGINEER CITY OF WICHITA PROJECT NO. 468-85202 PROFESSIONAL ENGINEERING CONSULTANTS, P.A. 303 SOUTH TOPEKA WICHITA, KS 67202 316-262-2691 www.pec1.com			
Designed by	MDK, TBK	Job No.	35-15554-1-0042
Drawn by	CSL, KTD	Date	NOVEMBER 2016