

PIPE NO.	PIPE SIZE	ABANDON PIPE (L.F.)
1	11"x19" CMP	31.6
2	11"x19" CMP	18.4
3	15" RCP	30.2
4	11"x19" CMP	31.1
5	18" RCP	88.7
6	11"x19" CMP	18.4
7	15" RCP	30.9
8	24" RCP	25.1

CENTERLINE VERTICAL CONTROL			
Station	P.V.I.	P.V.I. Elevation	Vertical Curve
43+30		110.80	No
45+35	L.P.	110.04	No
45+93.66	H.P.	110.22	No
46+40	L.P.	109.92	No

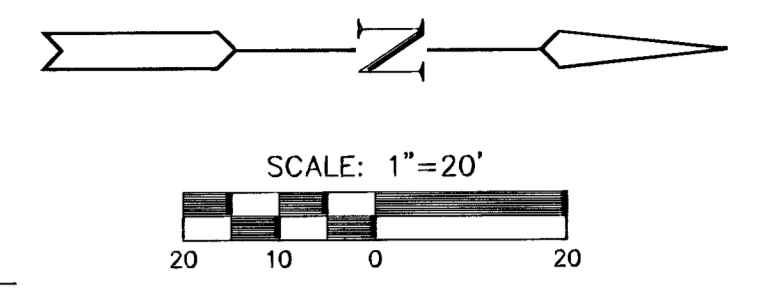

See Note 1

Sta. 42+43.55 Seneca, Const. Std. Manhole (Type P), 25.00' Lt. Dia.=5'-0" Manhole Top=110.99 Install 24" x 278.79' Storm Swr. (RCP)(N)

Sta. 42+44.93 Seneca, Const. Curb Inlet (Type II), 32.18' Lt. L=6'-2-1/2", W=3'-4-3/8" Inlet Top=111.22 Install 15" x 7.18' Storm Swr. (RCP)(E)

Sta. 45+32.34 Seneca, Const. Std. Manhole (Type P), 25.00' Lt. Dia.=6'-0" Manhole Top=109.53 Install 36" x 110.13' Storm Swr. (RCP)(N)

Sta. 45+27.52 Seneca, Const. Curb Inlet (Type II), 32.18' Lt. L=6'-2-1/2", W=3'-4-3/8" Inlet Top=109.79 Install 15" x 6.21' Storm Swr. (RCP)(N)

Sta. 45+90.88 Seneca, Install Survey Monument E 1/4 Cor. Sec. 19, T27S, R1E. See Detail Sht. No. 2.

Sta. 46+42.46 Seneca, Const. Std. Manhole (Type P), 25.00' Lt. Dia.=6'-0" Manhole Top=109.41 Install 36" x 278.17' Storm Swr. (RCP)(N)

Sta. 46+43.84 Seneca, Const. Curb Inlet (Type II), 32.18' Lt. L=6'-2-1/2", W=3'-4-3/8" Inlet Top=109.66 Install 18" x 7.18' Storm Swr. (RCP)(E)

Sta. 46+50.05 Seneca, Const. Curb Inlet (Type II), 32.18' Lt. L=6'-2-1/2", W=3'-4-3/8" Inlet Top=109.68 Install 18" x 6.21' Storm Swr. (RCP)(S)

Const. 8" Reinf. Conc. Drive Entrance (Full Ramp)

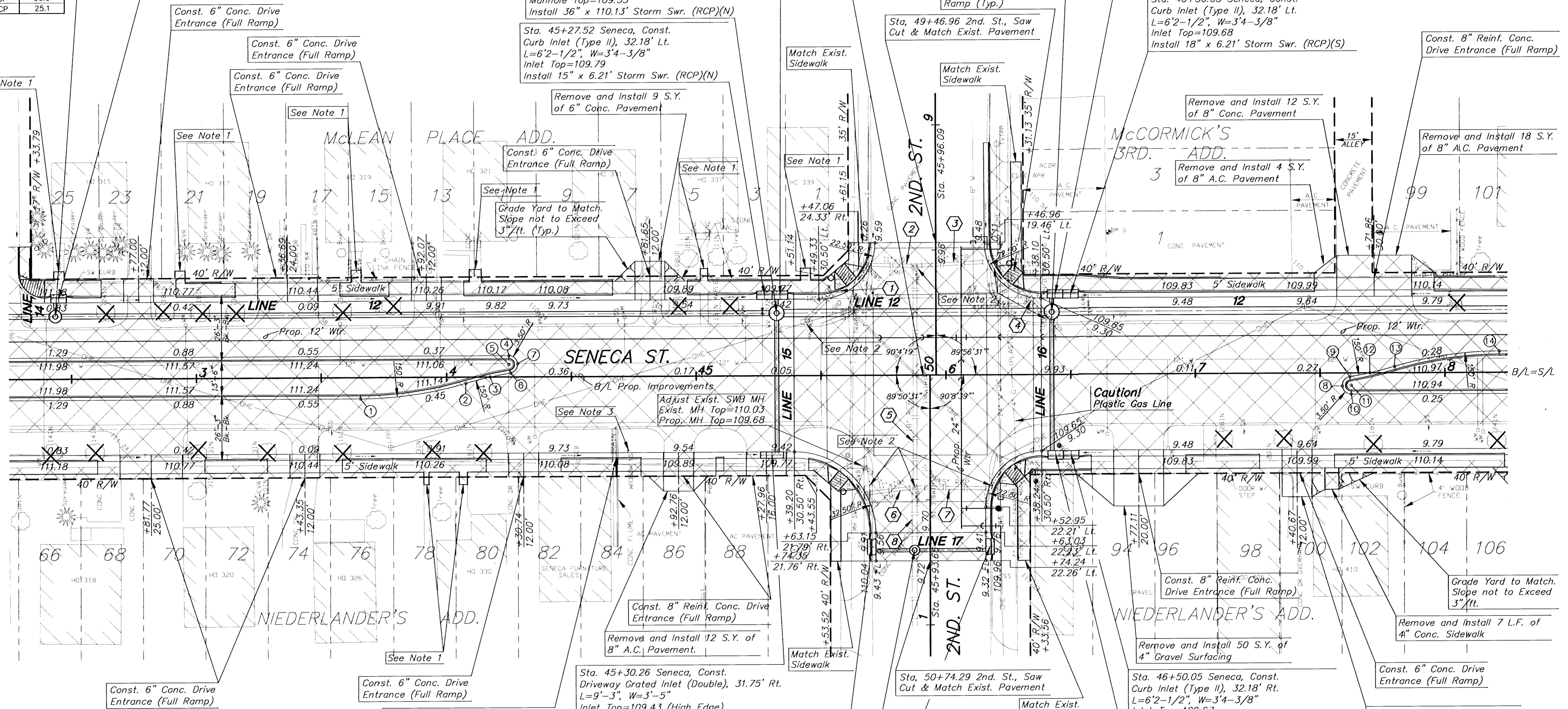

MEDIAN LOCATION				
Pt. No.	Station	Offset	Elevation High Edge	Elevation Top Curb
1	43+65.67	8.50' Rt.	110.50	111.19
2	44+07.67	2.50' Rt.	110.46	111.15
3	44+17.46	0.00' Rt.	110.48	111.17
4	44+24.98	8.50' Lt.	110.28	110.97
5	44+24.98	5.00' Lt.	Radius Point	
6	44+25.54	1.55' Lt.	110.42	111.07
7	44+28.46	5.28' Lt.	110.33	111.02
8	47+58.95	5.28' Rt.	110.18	110.85
9	47+61.87	1.55' Rt.	110.27	110.92
10	47+62.44	8.50' Rt.	110.14	110.83
11	47+62.44	5.00' Rt.	Radius Point	
12	47+69.95	0.00' Rt.	110.33	111.00
13	47+79.74	2.50' Lt.	110.31	111.00
14	48+21.74	8.50' Lt.	110.32	111.01

Notes:  
 1. Remove and Install Sidewalk 3' Min. beyond Right-of-way to match existing.  
 3. Remove or abandon storm water sewer structures as required (Typ.). Payment Subsidiary to other bid items.  
 4. See Pavement Marking and Signing Plan.

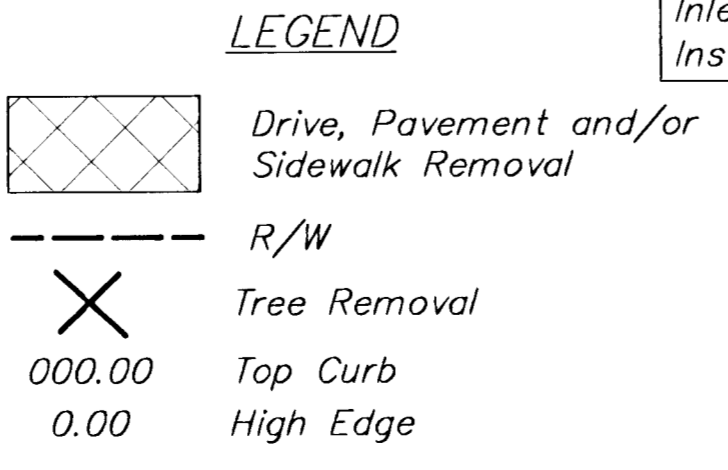

Sta. 50+70.09 Seneca, Const. Std. Manhole (Type P), 6.25' Rt. Dia.=4'-0" Manhole Top=109.63 Connect to Existing 24" RCP

Sta. 50+68.63 2nd. St., Const. Curb Inlet (Type II), 23.93' Lt. L=6'-2-1/2", W=3'-4-3/8" Inlet Top=109.74 Install 15" x 30.18' Storm Swr. (RCP)(S)

Sta. 46+43.84 Seneca, Const. Curb Inlet (Type II), 32.18' Rt. L=6'-2-1/2", W=3'-4-3/8" Inlet Top=109.66 Install 18" x 57.18' Storm Swr. (RCP)(W)



**SENECA STREET**  
PROJECT NAME

**PAVING PLANS**  
SHEET TITLE

**MKEC**  
ENGINEERING CONSULTANTS  
411 N. WEBB ROAD  
WICHITA, KS. 67208  
316-684-9600

WJN  
DRAWN BY:

GJA  
CHECKED BY:

OCT. 2001  
DATE

98092\_E5  
DRAWING NAME

12 / 87  
SHEET OF