

BENCHMARKS

BM #9 - City Disc Located @ 12.89m South and 10.91m West of the Centerline of both Meridian and Central.
Elev. = 397.376 SI Units (1303.71 MSL Datum)

FHWA REGION NO.	STATE	PROJECT NO.	FISCAL YEAR	SHEET NO.	TOTAL SHEETS
7	KANSAS	87N-0094-01	1998	26	202

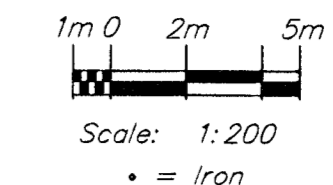

NOTE:
Trees / Shrubs to be removed are marked thus:

NOTE:
Pavement, Driveways, Sidewalks, Etc. To Be Removed Are Indicated By:

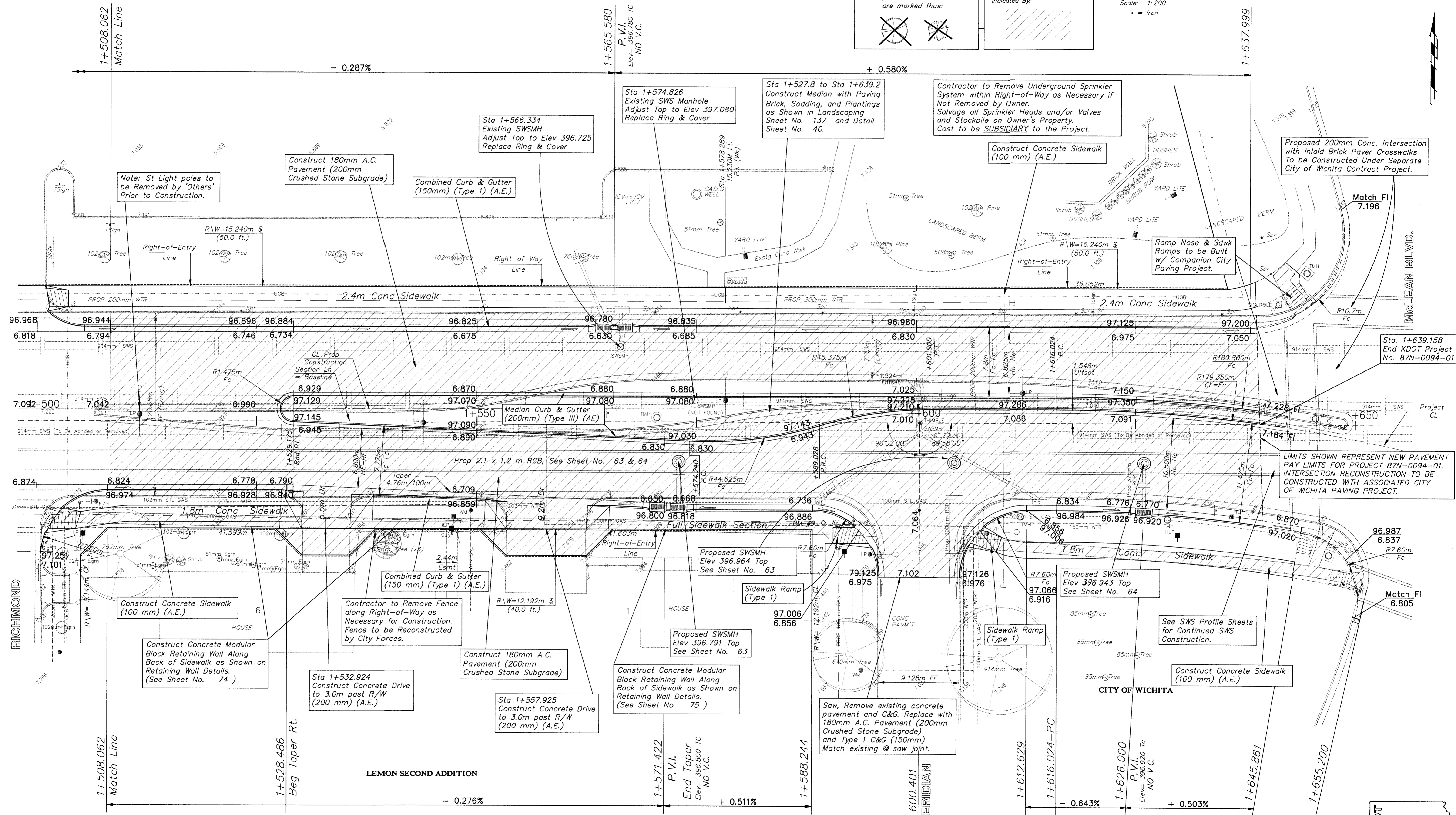

Proposed 200mm Conc. Intersection with Inlaid Brick Paver Crosswalks To be Constructed Under Separate City of Wichita Contract Project.

Contractor to Remove Underground Sprinkler System within Right-of-Way as Necessary if Not Removed by Owner. Salvage all Sprinkler Heads and/or Valves and Stockpile on Owner's Property. Cost to be SUBSIDIARY to the Project.

Sta 1+527.8 to Sta 1+639.2 Construct Median with Paving Brick, Sodding, and Plantings as Shown in Landscaping Sheet No. 137 and Detail Sheet No. 40.

Sta 1+574.826 Existing SWS Manhole Adjust Top to Elev 397.080 Replace Ring & Cover

Sta 1+566.334 Existing SWSMH Adjust Top to Elev 396.725 Replace Ring & Cover

Construct 180mm A.C. Pavement (200mm Crushed Stone Subgrade)

Note: St Light poles to be Removed by 'Others' Prior to Construction.

Sta. 1+639.158 End KDOT Project No. 87N-0094-01

LIMITS SHOWN REPRESENT NEW PAVEMENT PAY LIMITS FOR PROJECT 87N-0094-01. INTERSECTION RECONSTRUCTION TO BE CONSTRUCTED WITH ASSOCIATED CITY OF WICHITA PAVING PROJECT.

Construct Concrete Modular Block Retaining Wall Along Back of Sidewalk as Shown on Retaining Wall Details. (See Sheet No. 74)

Sta 1+532.924 Construct Concrete Drive to 3.0m past R/W (200 mm) (A.E.)

Construct 180mm A.C. Pavement (200mm Crushed Stone Subgrade)

Construct Concrete Modular Block Retaining Wall Along Back of Sidewalk as Shown on Retaining Wall Details. (See Sheet No. 75)

Saw, Remove existing concrete pavement and C&G. Replace with 180mm A.C. Pavement (200mm Crushed Stone Subgrade) and Type 1 C&G (150mm) Match existing @ saw joint.

NOTE:
Water meters, Gas meters, Utility poles, and Electrical junction pedestals, boxes, etc. are to be REMOVED and RELOCATED as necessary by the respective utility company, owner PRIOR TO CONSTRUCTION of this project.

PROJECT NUMBER 472 - 82908		PROJ NUMBER 85 05 E026	CAPITAL IMPROVEMENT PROJECT CENTRAL AVENUE Sta 1+508.082 to Sta 1+639.158			SHEET 26 OF 202
DESIGN STAFF	DRAWN SONNY	APPROVED JFB	DATE NOV 98	SCALE NOTED		