

BENCHMARKS:
 BM #1: "X" Chiseled on Top of Curb, approximately 50' east of the NE corner of Lot 1, Block 4, Parkstone Addition.
 Elev. = 1332.03 (NAVD88)

BM #2: "X" Chiseled on Top of Curb, approximately 169' west and 57.5' north of the NE corner of Lot 1, Block 4, Parkstone Addition.
 Elev. = 1327.76 (NAVD88)

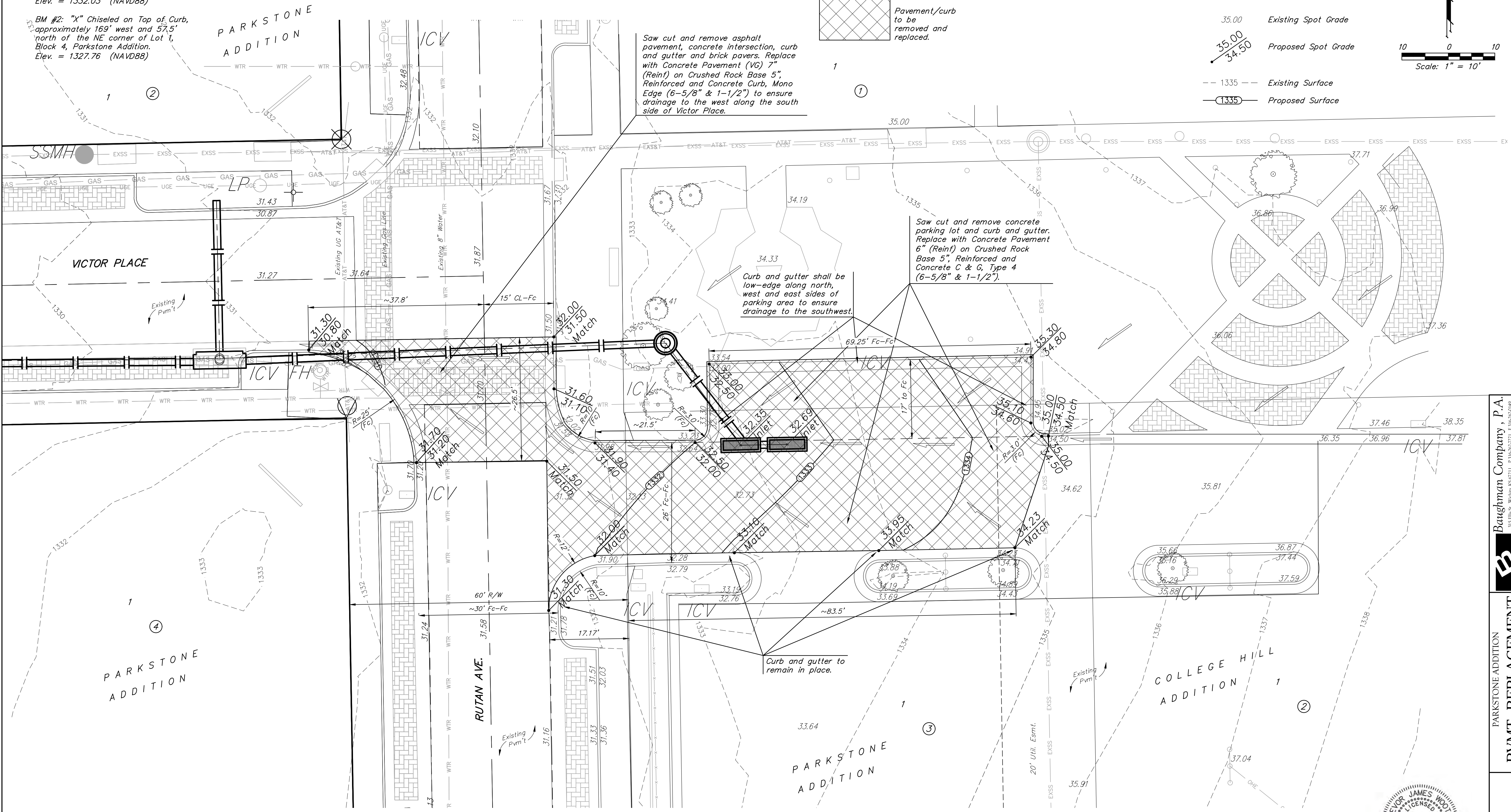

Baughman Company, P.A.
 P.E. WAHAB, S.S. CHAI, P. HANSEN, J. T. MCGONAGLE
 ENGINEERING, SURVEYING, PLANNING, LANDSCAPE ARCHITECTURE
 1000 W. 19th St., Suite 100, Lawrence, KS 66044
 Phone: 781-842-1100 Fax: 781-842-1101
 www.baughman.com

PARKSTONE ADDITION
PVMT. REPLACEMENT
 STORM WATER SEWER IMPROVEMENTS

JAMES WOOTEN
 LICENSED
 PROFESSIONAL ENGINEER
 21190
 5-1-18
 KANSAS