

REED'S COVE ADDITION

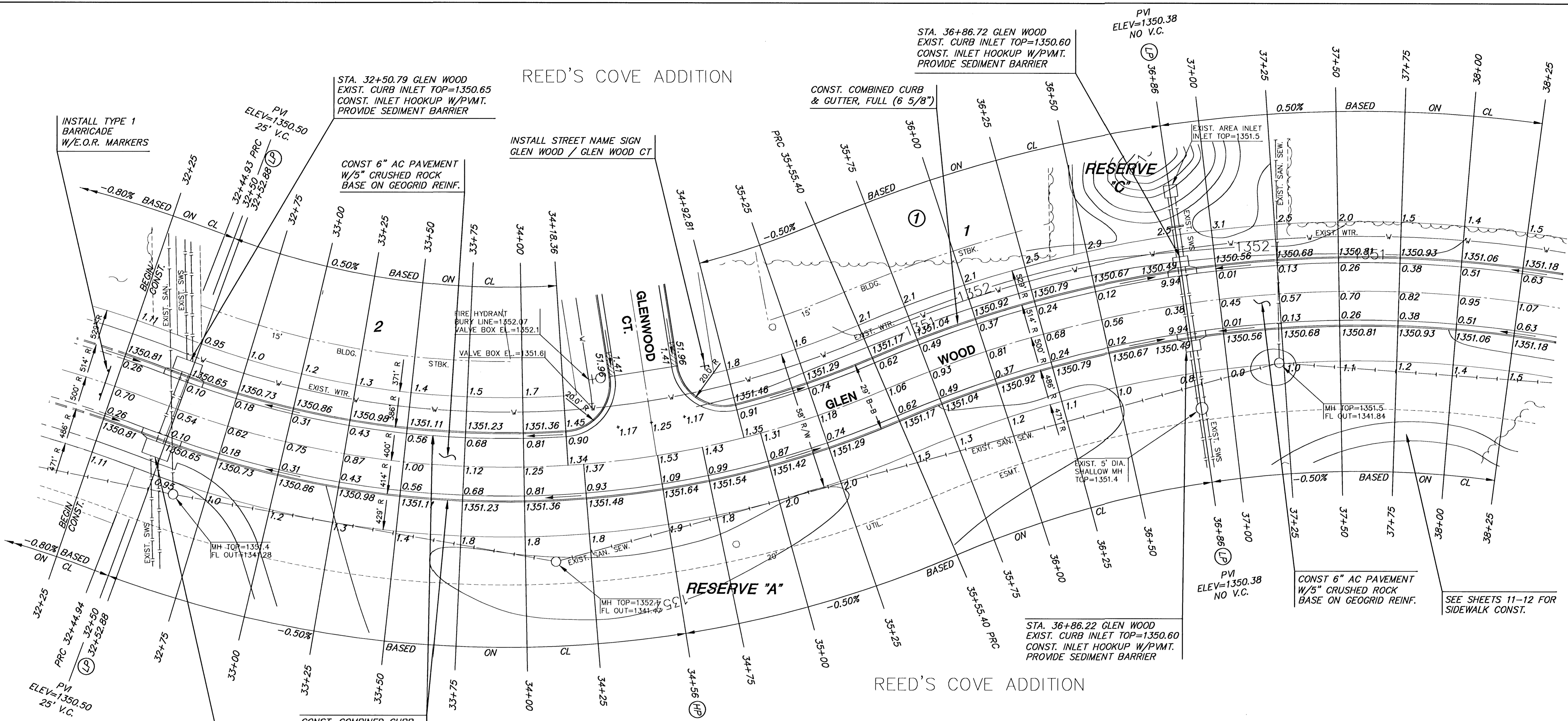

CURVE TABLE

$\Delta = 21^{\circ}42'28''$ R = 500.00' T = 95.87' L = 189.43' LC = 188.30'

CURVE DATA BASED ON CENTERLINE $\Delta/2 = 10^{\circ}51'14''$

CHORD LENGTH					
STATION	ARC	8' Off LtCb	8' Off RtCb	DEFLECTION	TOTAL DEFLECTION
32+25.00	25.00'	26.10'	23.90'	01°25'57"	09°42'43"
32+44.93	19.93'	20.81'	19.05'	01°08'31"	10°51'14"

Def/Ft = 3.43782 Min.

CURVE TABLE

$\Delta = 44^{\circ}28'15''$ R = 400.00' T = 163.53' L = 310.46' LC = 302.73'

CURVE DATA BASED ON CENTERLINE $\Delta/2 = 22^{\circ}14'08''$

CHORD LENGTH					
STATION	ARC	8' Off LtCb	8' Off RtCb	DEFLECTION	TOTAL DEFLECTION
32+44.93	-	-	-	00°00'00"	00°00'00"
32+50.00	5.07'	4.79'	5.35'	00°21'47"	00°21'47"
32+75.00	25.00'	23.62'	26.37'	01°47'26"	02°09'13"
33+00.00	25.00'	23.62'	26.37'	01°47'26"	03°56'39"
33+25.00	25.00'	23.62'	26.37'	01°47'26"	05°44'05"
33+50.00	25.00'	23.62'	26.37'	01°47'26"	07°31'30"
33+75.00	25.00'	23.62'	26.37'	01°47'26"	09°18'56"
34+00.00	25.00'	23.62'	26.37'	01°47'26"	11°06'22"
34+25.00	25.00'	23.62'	26.37'	01°47'26"	12°53'48"
34+50.00	25.00'	23.62'	26.37'	01°47'26"	14°41'13"
34+75.00	25.00'	23.62'	26.37'	01°47'26"	16°28'39"
35+00.00	25.00'	23.62'	26.37'	01°47'26"	18°16'05"
35+25.00	25.00'	23.62'	26.37'	01°47'26"	20°03'31"
35+50.00	25.00'	23.62'	26.37'	01°47'26"	21°50'57"
35+55.40	5.40'	5.10'	5.69'	00°23'11"	22°14'08"

Def/Ft = 4.29718 Min.

CURVE TABLE

$\Delta = 48^{\circ}45'58''$ R = 500.00' T = 226.63' L = 425.56' LC = 412.84'

CURVE DATA BASED ON CENTERLINE $\Delta/2 = 24^{\circ}22'59''$

CHORD LENGTH					
STATION	ARC	8' Off LtCb	8' Off RtCb	DEFLECTION	TOTAL DEFLECTION
35+55.40	-	-	-	00°00'00"	00°00'00"
35+75.00	19.60'	20.46'	18.74'	01°07'23"	01°07'23"
36+00.00	25.00'	26.10'	23.90'	01°25'57"	02°33'19"
36+25.00	25.00'	26.10'	23.90'	01°25'57"	03°59'16"
36+50.00	25.00'	26.10'	23.90'	01°25'57"	05°25'13"
36+75.00	25.00'	26.10'	23.90'	01°25'57"	06°51'09"
37+00.00	25.00'	26.10'	23.90'	01°25'57"	08°17'06"
37+25.00	25.00'	26.10'	23.90'	01°25'57"	09°43'03"
37+50.00	25.00'	26.10'	23.90'	01°25'57"	11°08'59"
37+75.00	25.00'	26.10'	23.90'	01°25'57"	12°34'56"
38+00.00	25.00'	26.10'	23.90'	01°25'57"	14°00'52"
38+25.00	25.00'	26.10'	23.90'	01°25'57"	15°26'49"
38+50.00	25.00'	26.10'	23.90'	01°25'57"	16°52'46"
38+75.00	25.00'	26.10'	23.90'	01°25'57"	18°18'43"
39+00.00	25.00'	26.10'	23.90'	01°25'57"	19°44'39"
39+25.00	25.00'	26.10'	23.90'	01°25'57"	21°10'36"
39+50.00	25.00'	26.10'	23.90'	01°25'57"	22°36'32"
39+75.00	25.00'	26.10'	23.90'	01°25'57"	24°02'29"
39+80.96	5.96'	6.23'	5.70'	00°20'30"	24°22'59"

Def/Ft = 3.43775 Min.

LEGEND

STREET SIGN & SIGN LOCATION (SEE SIGN ASSEMBLY TABLE FOR TYPE & STATION OF SIGN)

SCALE: 1"=20'

MKEC ENGINEERING CONSULTANTS
411 N. WEBB ROAD
WICHITA, KS. 67206
316-694-9600

REED'S COVE ADDITION
PROJECT NAME

GLEN WOOD
SHEET TITLE

DFL DESIGN BY: DMU DRAWN BY: GJA CHECKED BY:
JUNE 2003 DATE: 02121E4 JOB NO. 7 / 34 SHEET/OF