

SCALE: 1" = 40'

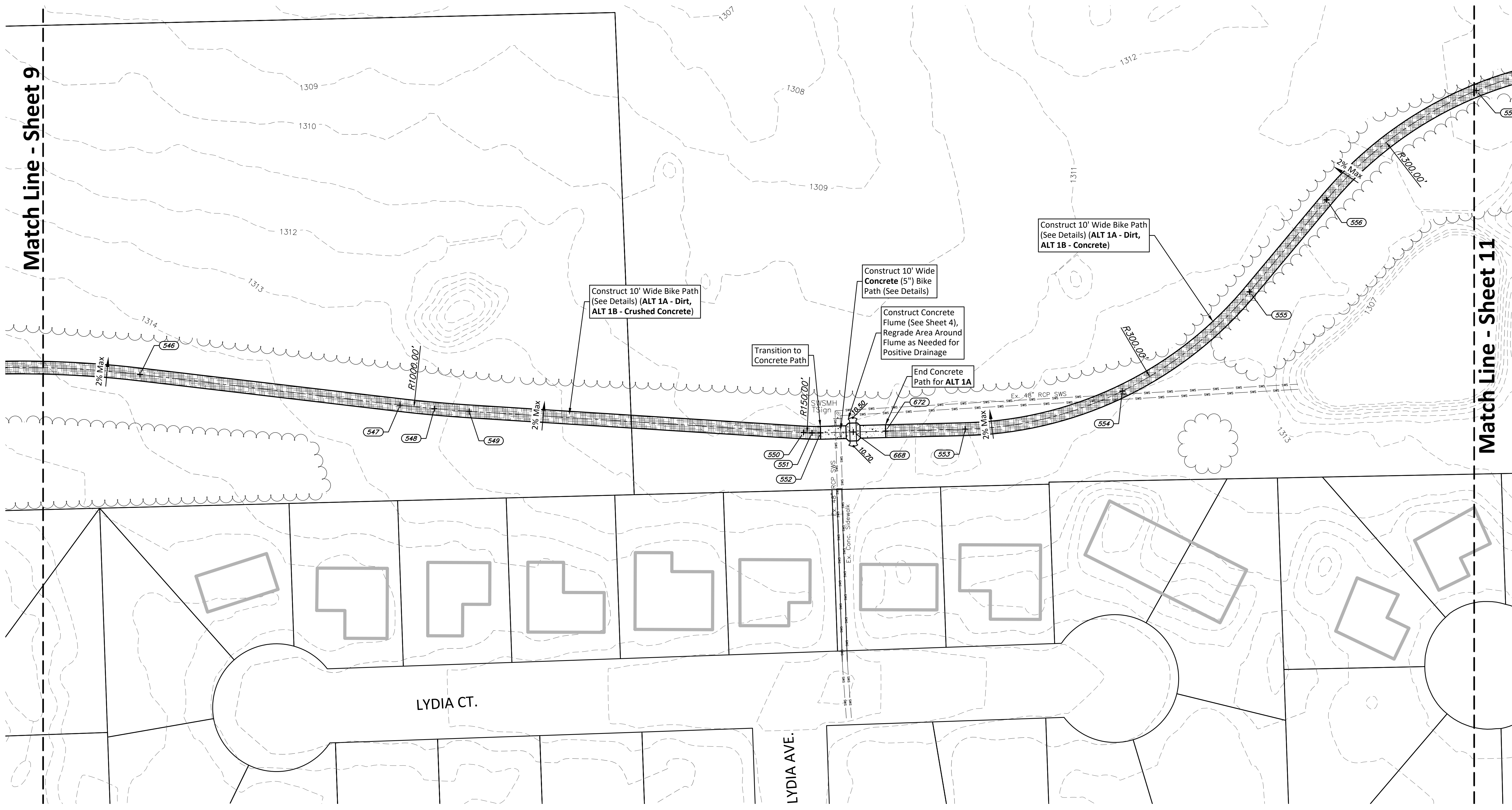
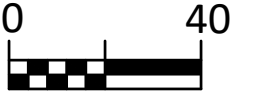

POINT TABLE				
POINT #	RAW DESCRIPTION	NORTHING	EASTING	ELEVATION
546	path	1674414.9794	1614223.0157	1314.49
547	path	1674211.3898	1614199.8023	1312.94
548	path	1674184.5094	1614197.1047	1312.73
549	path	1674157.2687	1614195.1165	1312.46
550	path	1673895.5287	1614179.5251	1310.91
551	path	1673888.8959	1614179.2771	1310.90
552	start conc	1673882.2586	1614179.3228	1310.81
553	path	1673769.0160	1614182.6088	1311.92

POINT #	RAW DESCRIPTION	NORTHING	EASTING	ELEVATION
554	path	1673646.2600	1614212.8181	1312.42
555	path	1673546.8474	1614290.9129	1311.89
556	path	1673486.8972	1614363.1618	1311.20
668	flume	1673856.5828	1614180.0679	1311.30
672	end conc	1673831.2801	1614180.8021	1311.55

NOTE: Proposed Path to be Constructed Flush w/ Existing Surface Unless Otherwise Noted on Plans (Flume Grades). Path Cross Slope to Match Existing Runoff Direction as Shown on Plans and at 2% Max.

NOTE: Crushed Concrete (4") & Concrete Sidewalk Transitions shall have Thickened Edge as Shown in Details (See Sheet 4)

PAVING QUANTITIES PER SHEET		
BID	PAVEMENT TYPE	QUANTITIES
ALT 1A	Dirt Path (95% Compaction)	11,666.41 sf
	Concrete Sidewalk (5") (Reinforced)	546.05 sf
ALT 1B	Crushed Concrete Path (4")	6,108.05 sf
	Concrete Sidewalk (5") (Reinforced)	6,102.44 sf

BAUGHMAN COMPANY
 315 Ellis St. Wichita, KS 67211 316-262-7271
 baughmanCo.com



CAPITAL IMPROVEMENT PROJECT
BIKE PATH LAYOUT PLAN
 PAWNEE PRAIRIE PARK IMPROVEMENTS

PROJECT NUMBER: 436632
 INTERNAL NUMBER: 17-11-E865
 DESIGN: LP
 DRAWN: LP
 DATE: Jul, 2018
 SHEET
10
 OF
23