

TYLER ROAD TRAILHEADS

SCALE: 1" = 10'

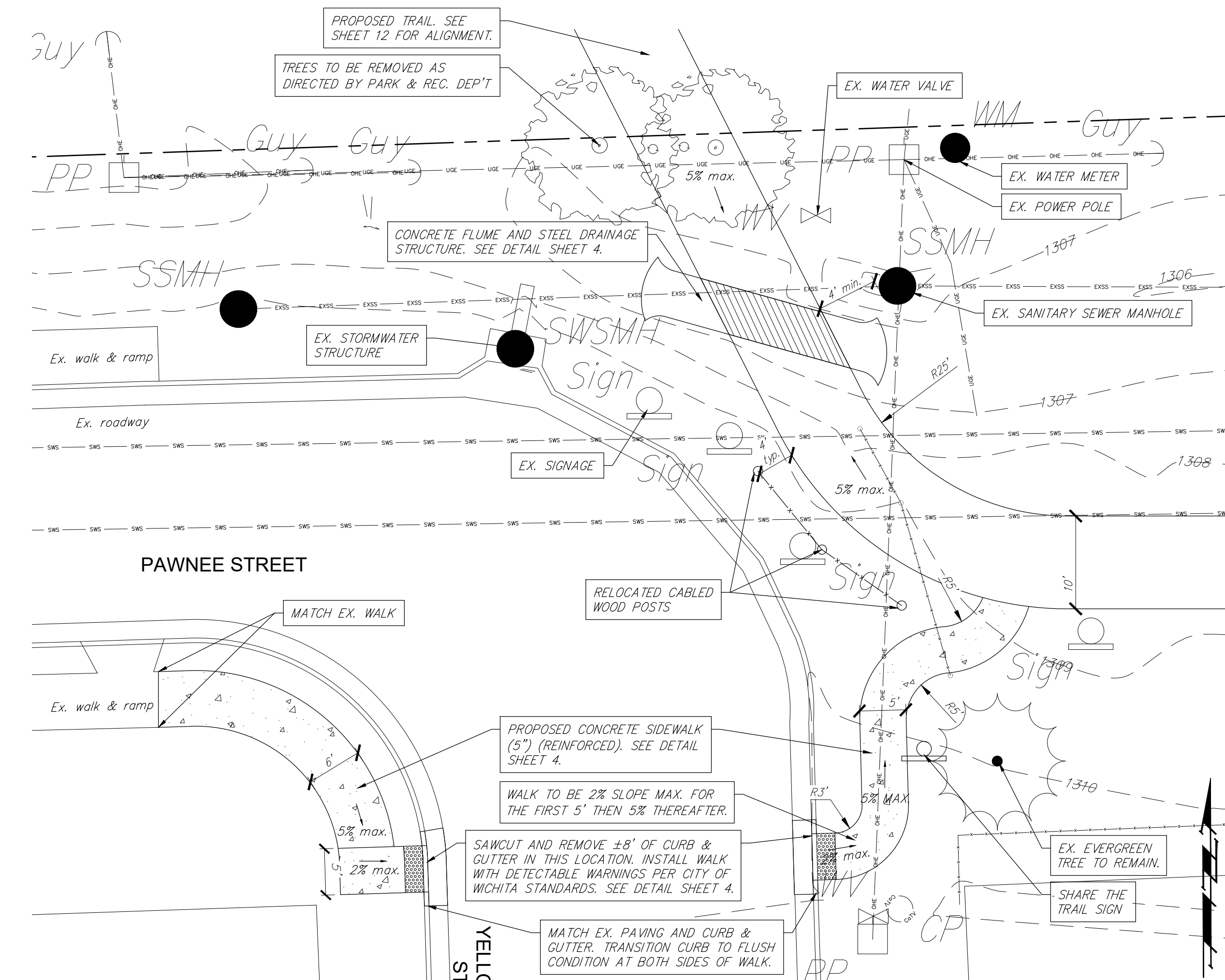

SHARE THE TRAIL SIGN

- NOTE**
- PEDESTRIAN IMPROVEMENTS AT THIS INTERSECTION ARE BID ALTERNATE ONLY. BID ALTERNATE INCLUDES:
 - CURB DEMOLITION & INSTALLATION OF DETECTABLE PAVERS
 - INSTALLATION OF 5' & 6' SIDEWALKS TO CONNECT TO PROPOSED BICYCLE TRAIL.
 - INSTALLATION OF SHARE THE TRAIL SIGN
 - BID ALTERNATE DOES NOT INCLUDE BASE BID ITEMS SUCH AS:
 - BICYCLE PATH CONSTRUCTION
 - RELOCATION OF EX. WOOD POSTS
 - CONSTRUCTION OF CONCRETE FLUME & METAL COVER
 - DEMOLITION OF VEGETATION

BID ALTERNATE ENLARGEMENT - PEDESTRIAN CONNECTION

SCALE: 1" = 10'

BAUGHMAN COMPANY
315 Ellis St. Wichita, KS 67211 316-262-7271
BaughmanCo.com

BAUGHMAN

CAPITAL IMPROVEMENT PROJECT
BIKE PATH LAYOUT ENLARGEMENTS
PAWNEE PRAIRIE PARK IMPROVEMENTS

PROJECT NUMBER: 436632
INTERNAL NUMBER: 17-11-E865
DESIGN: AH
DRAWN: AH
DATE: Jul, 2018
SHEET OF 22 23

THE ENGINEER HAS PREPARED THESE PLANS IN ACCORDANCE WITH THE PROFESSIONAL ENGINEERING ACT OF 1932, AS AMENDED.