

REVISIONS:	DESCRIPTION	DATE	MARK

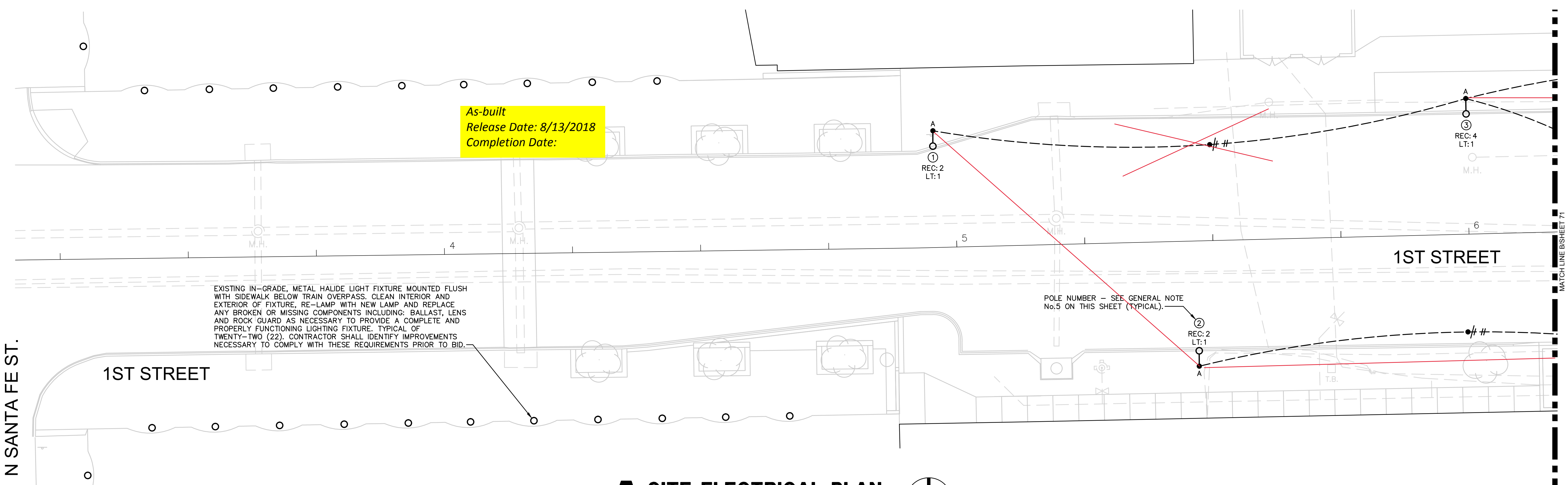

**A SITE ELECTRICAL PLAN**  
 1" = 10'-0"  

LETTER DESIG.	MANUFACTURER	CATALOG NUMBER	VOLTAGE	LAMPS		MOUNTING	FINISH TRIM	TOTAL VA	REMARKS
				NO.	TYPE				
A	PEMCO	CORO 2-DG-94W12C4K-240V-GLDIII-CC	240	-	L.E.D.'S W/UNIT	20" POLE	RAL9005-TEXTURED	110	SEE DETAIL 'F' ON SHEET 71.
B	HADCO	TB361-LED-BOLLARD-A-LO-10-E-N	120	-	L.E.D.'S W/UNIT	SIDEWALK	BLACK	30	SEE DETAIL '12' ON SHEET 13.

- GENERAL NOTES:**
- ALL RACEWAYS TO BE 1" TRADE SIZE MINIMUM.
  - ALL RACEWAYS TO BE SCHEDULE 40 PVC.
  - ALL CONDUCTORS TO BE COPPER, No.10 AWG MINIMUM WITH TYPE THWN INSULATION.
  - REPAIR OF ANY UTILITIES DAMAGED DURING CONSTRUCTION SHALL BE THE RESPONSIBILITY OF THIS CONTRACTOR INCLUDING ALL MATERIALS, LABOR AND UTILITY COMPANY FEES. REPAIRS SHALL HAVE WRITTEN APPROVAL OF RESPECTIVE UTILITY COMPANY PRIOR TO BEING BACK-FILLED.
  - POLE NUMBER INDICATED ON ELECTRICAL PLANS SHALL BE PAINTED ON HAND-HOLE COVER OF EACH POLE. LETTERS AND NUMERALS SHALL BE WHITE IN COLOR, 1" TALL AND PAINTED USING STENCILS. DECALS ARE NOT PERMITTED.
  - CONTRACTOR SHALL PROVIDE ALL TRENCHING AND BORING REQUIRED FOR INSTALLATION OF UNDERGROUND ELECTRICAL RACEWAYS.
  - REFERENCE CIVIL DRAWINGS AND SPECIFICATIONS FOR TRENCHING AND BACKFILL REQUIREMENTS.
  - CONDUITS INSTALLED BELOW EXISTING PAVED AND HARDSCAPED AREAS THAT ARE NOT BEING DISTURBED AS PART OF THIS PROJECT SHALL BE BORED.

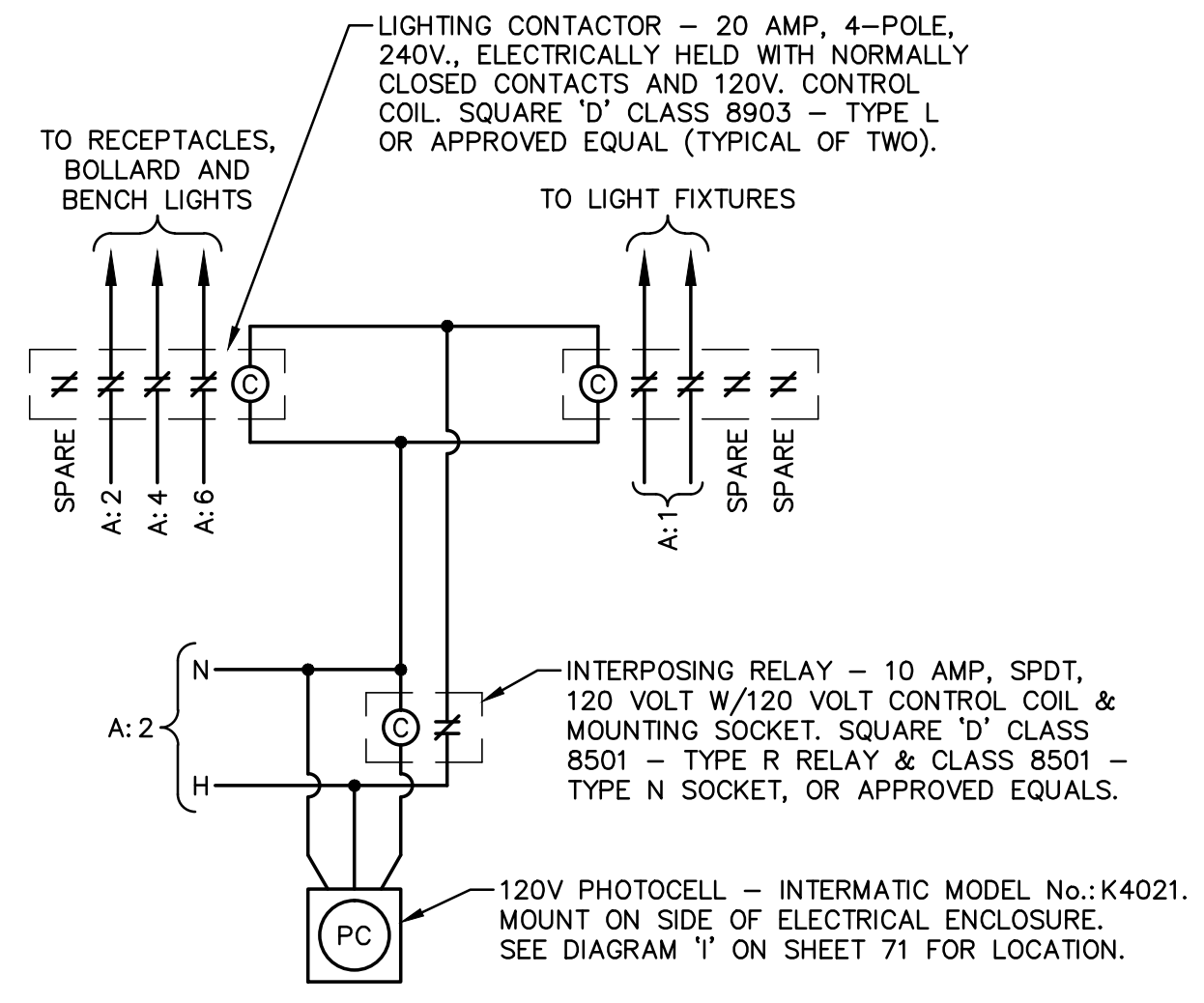

**E LIGHTING CONTROL DIAGRAM**  
 N.T.S.

CKT No.	DESCRIPTION	KVA	AMP	Ø A	Ø B	AMP	KVA	DESCRIPTION	CKT No.
1	1ST ST. LIGHTS POLE 1-15	1.7	20	Ø A	Ø B	20	1.1	1ST STREET RECS. POLE 1, 2, 5, 7, 9 & 11 / LTG. CTRL. CKT.	2
3	↑	↑	↑	↑	↑	↑	↑	↑	4
5	CONVENIENCE RECEPTACLE	.2	20	Ø A	Ø B	20	.9	1ST STREET RECEPTACLES POLE 3, 4, 6, 8, 10 & 12	6
7	SPARE	-	20	Ø A	Ø B	20	-	SPARE	8
9	SPARE	-	20	Ø A	Ø B	20	-	SPARE	10
11	SPACE ONLY	-	-	Ø A	Ø B	-	-	SPACE ONLY	12
13	SPACE ONLY	-	-	Ø A	Ø B	-	-	SPACE ONLY	14
15	BACK-FED MAIN BREAKER	5.0	100	Ø A	Ø B	30	-	SURGE PROTECTIVE DEVICE	16
17	↑	↑	↑	↑	↑	↑	↑	↑	18

① CIRCUIT TO BE CONNECTED TO LIGHTING CONTACTOR. SEE DIAGRAM 'E' THIS SHEET.

SYMB.	DESCRIPTION	MOUNTING OR AS INDICATED
A-O	POLE WITH (1) LIGHTING FIXTURE, (1) GFCI RECEPT. AND LETTER DESIGNATION.	SEE DETAIL 'F' ON SHEET 71.
⊙	BOLLARD LIGHT W/LETTER DESIGNATION	SURFACE
—/—/—	CONDUIT RUN WITH (3) HOTS, (1) NEUTRAL AND (1) GROUND	EARTH
—/—/—	'HOME RUN' WITH (3) HOTS, (1) NEUTRAL AND (1) GROUND	EARTH
①	POLE NUMBER - SEE GEN. NOTE #5 THIS SHEET	
AFG	ABOVE FINISHED GRADE	
C.	CONDUIT	
GRD.	GROUND	

① GFCI RECEPTACLE TO BE BLACK, WEATHER RESISTANT, 20AMP, 125V. DUPLEX RECEPTACLE - HUBBELL CATALOG NUMBER: GFWRST20BK OR APPROVED EQUAL.





