

BENCHMARKS:
 BM #1: Railroad spike in HLP
 2' West of center Sec. 11,
 T-27-S, R-2-W
 (S. Face of HLP)
 Elev. = 1367.70 NGVD29

BM #2: "□" Cut in top of
 curb adjacent to the Southwest
 Corner, Lot 11, Block B,
 Blackstone Addition
 Elev. = 1369.85 NGVD29

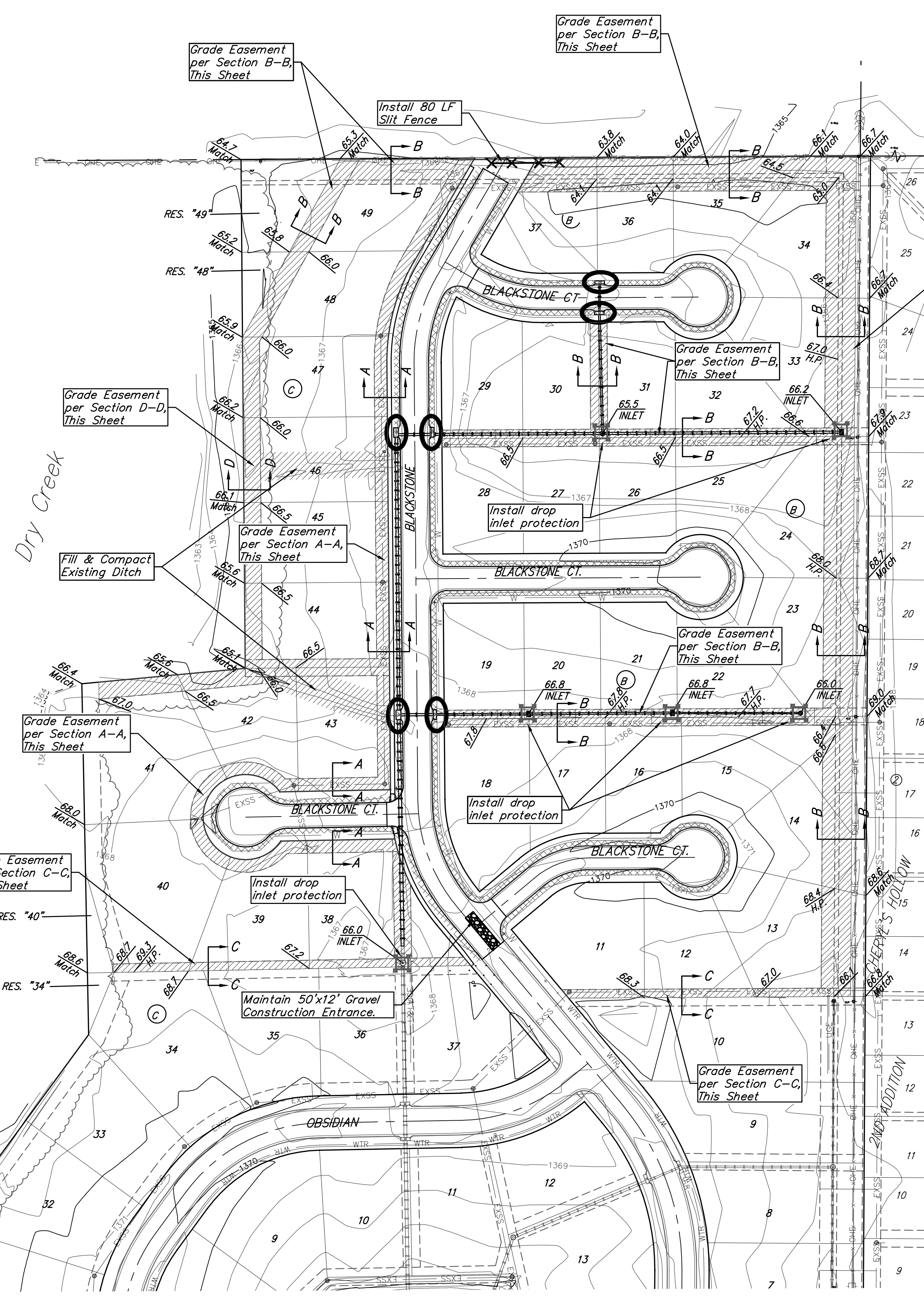

= Easements To Be Graded
 See Typical Section Details, this sheet.

Approximate Easement Grading Quantities:
 (For Information Only)
 Excavation: 646 C.Y.
 Fill: 1,215 C.Y.

The Contractor shall grade the easements as shown to the elevations given on the easement grading plan.

The Contractor shall 'straight' grade the easements between the elevations given. Where a callout designates 'Match', the Contractor will grade to the existing ground elevation.

Excess excavation from easement grading and from sanitary sewer construction shall be placed on the lots as indicated to the elevations shown.

All cost to be included in the Lump Sum bid item "Easement Grading"

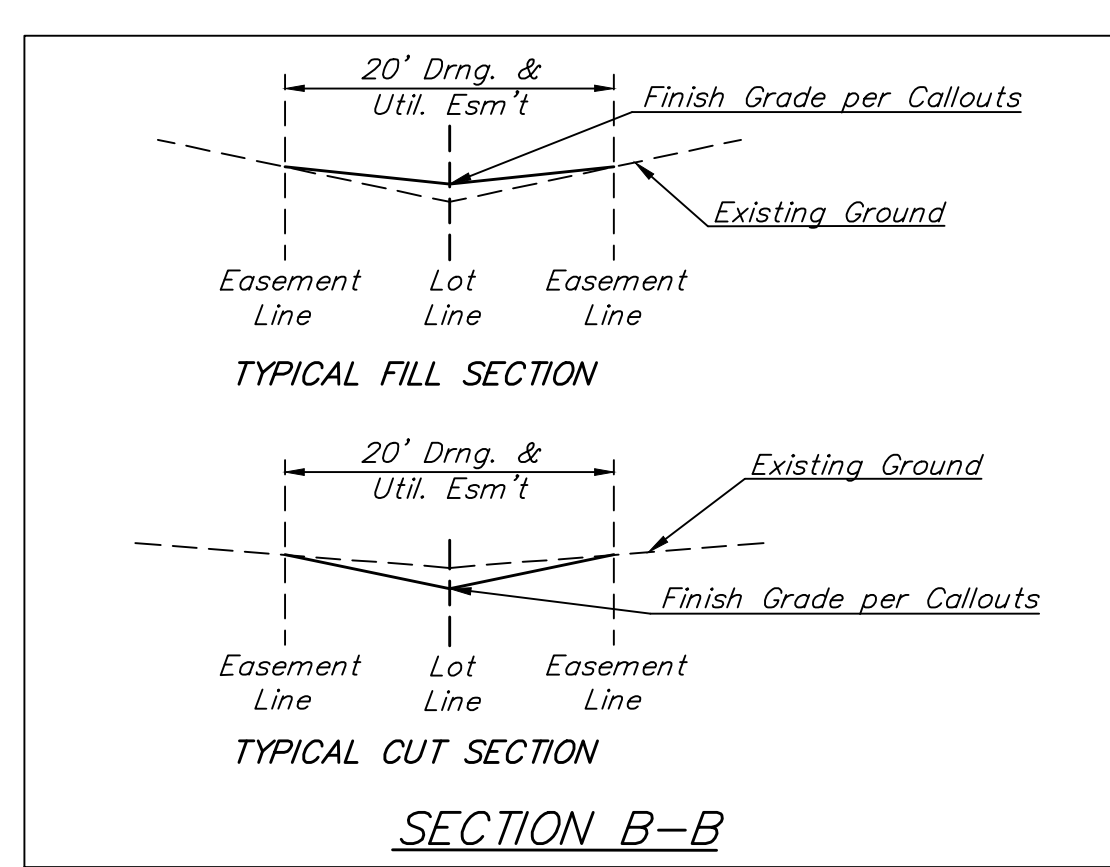
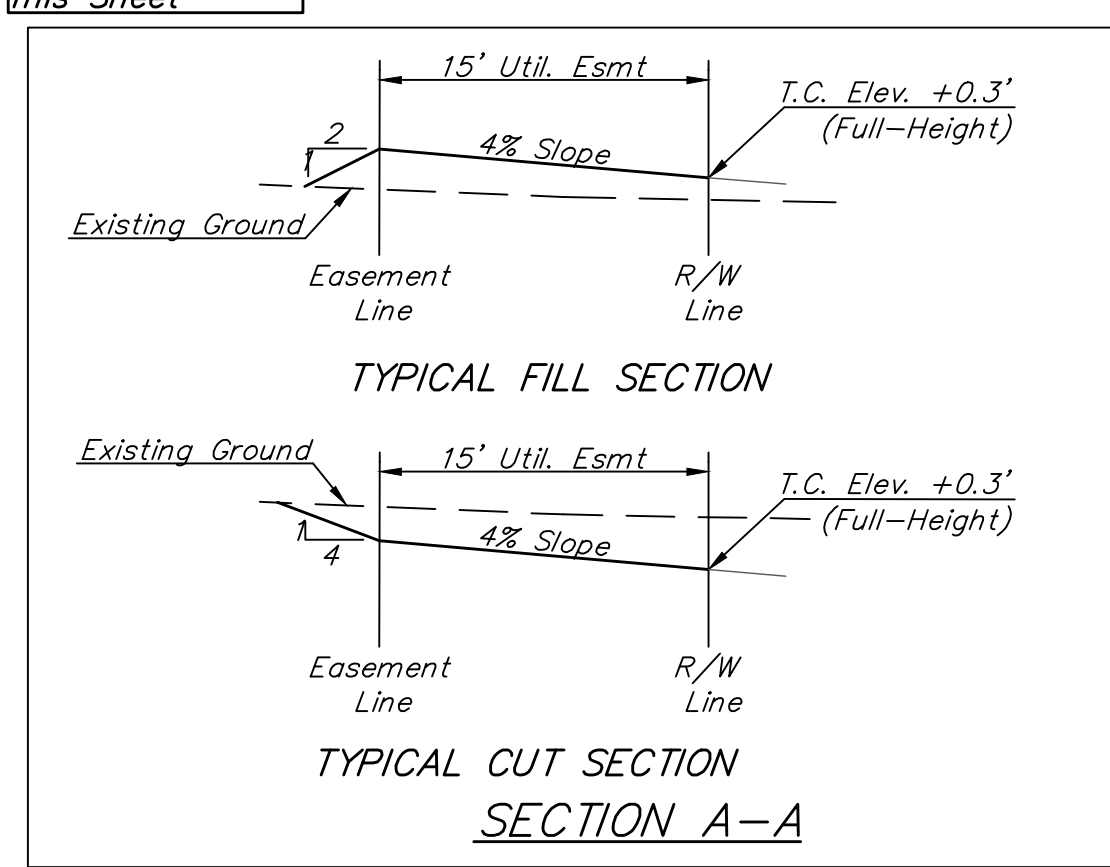
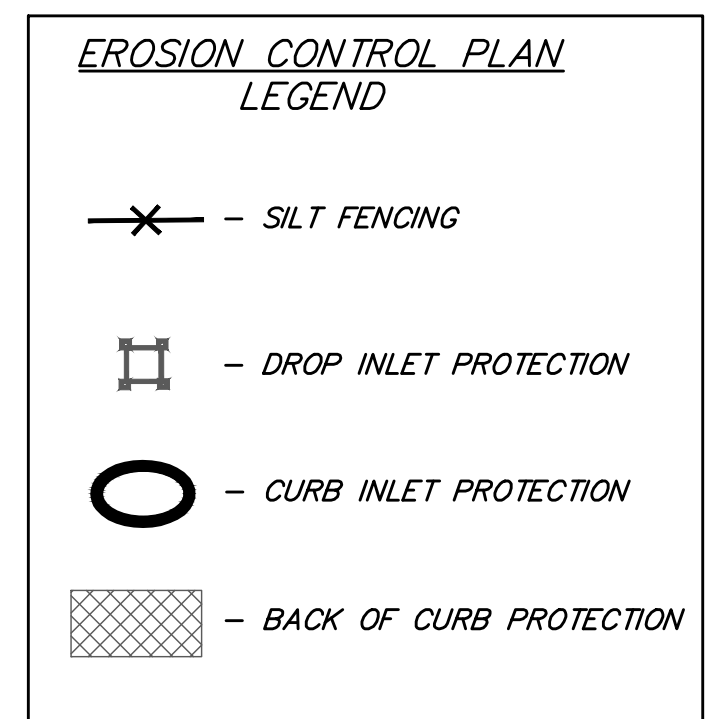
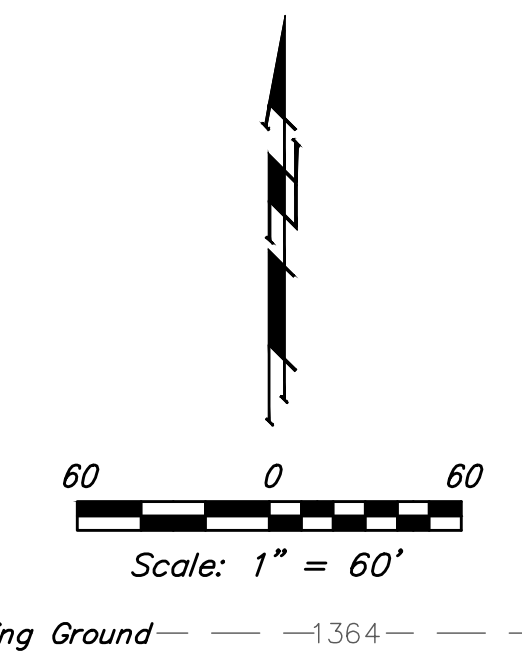

- NOTES:**
- Contractor shall make sure all erosion control is in place before project is accepted. This plan represents the minimum standard. Any additional erosion control measures shall be installed by the Contractor as needed.
 - Removal of Gravel Construction Entrance for pavement construction shall be included in bid item "Site Clearing & Restoration"
 - This Plan is Not To Be Used As A Comprehensive Grading Plan. All Spot Elevations Are Proposed & Subject To Change.
- All areas disturbed during construction shall be seeded, mulched, and fertilized as per Cover Sheet General Notes.

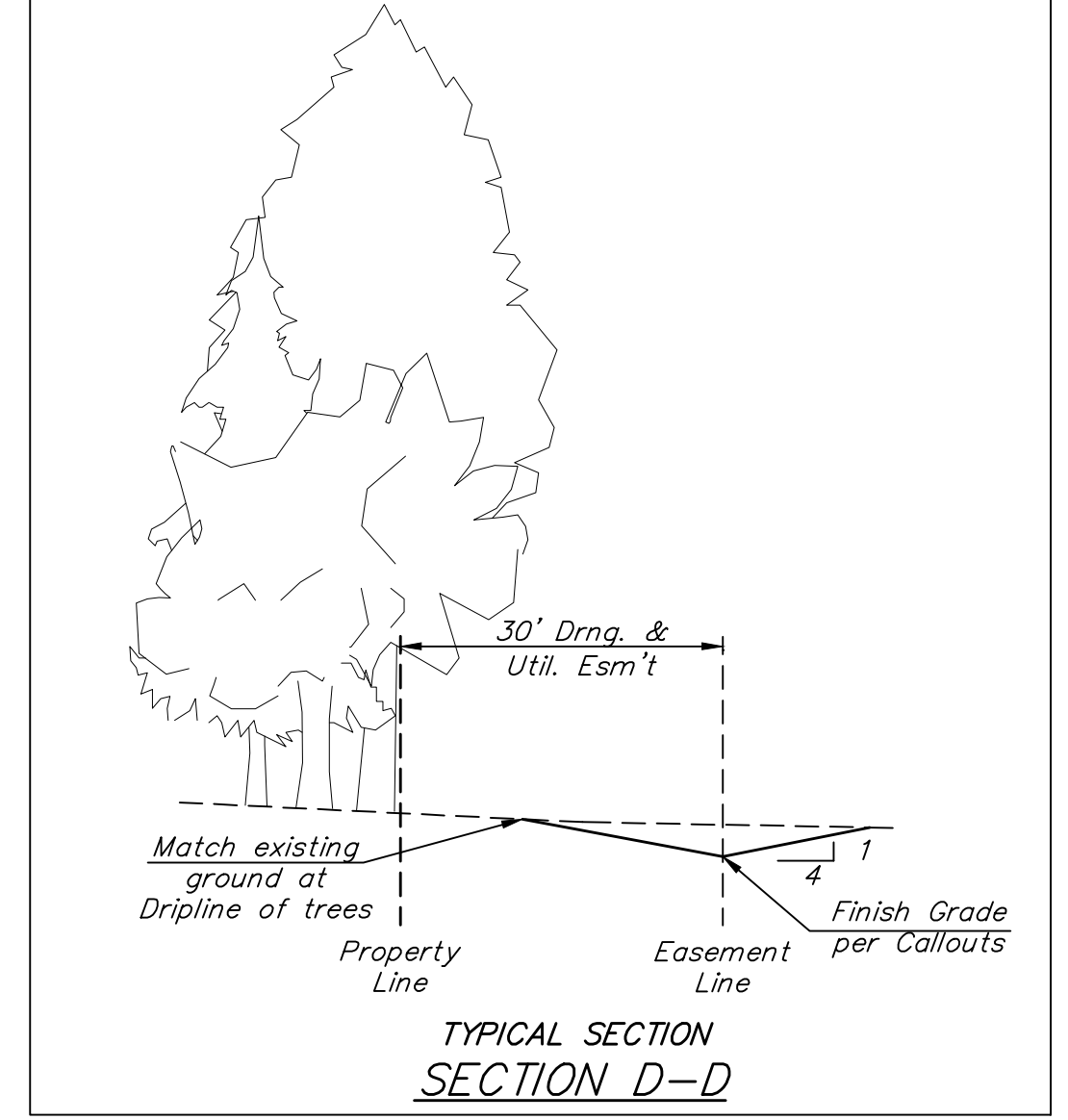
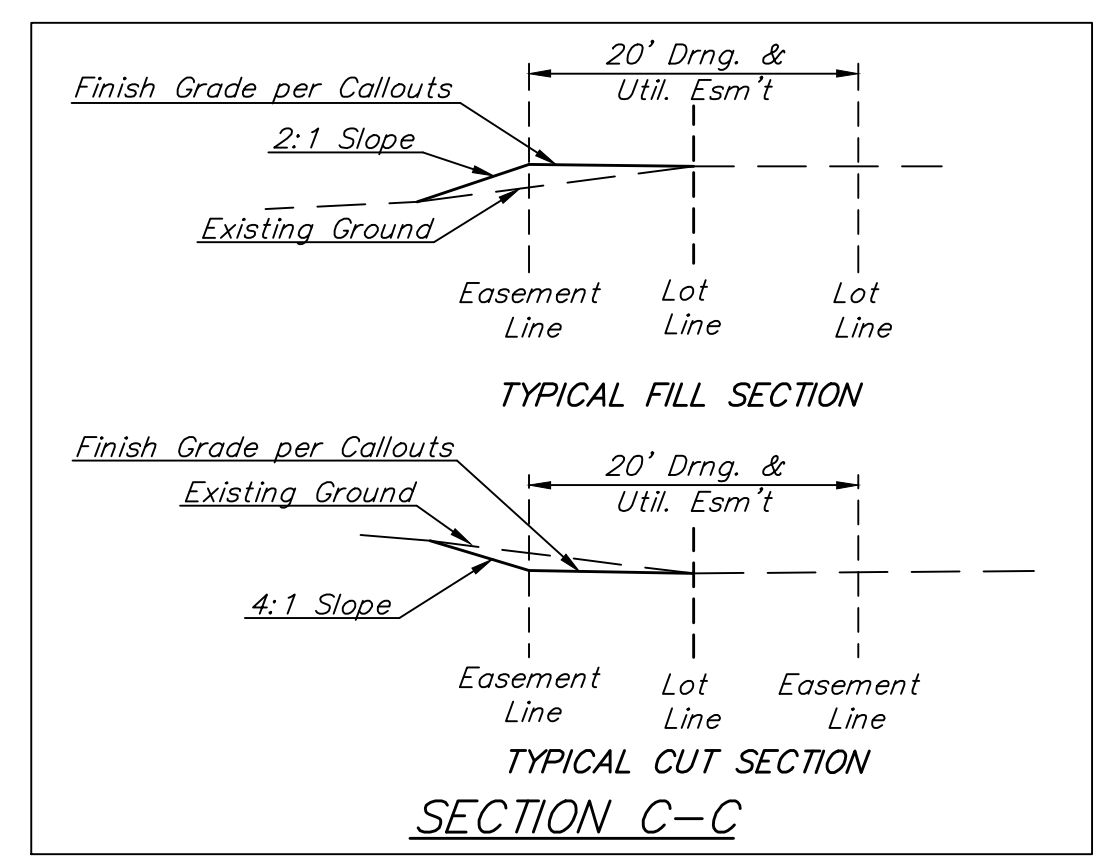

EROSION CONTROL MEASURE	INSTALL	MAINTAIN
BACK OF CURB PROTECTION (LF)	4,364	0
CONSTRUCTION ENTRANCE (EA)	0	1
CURB INLET BARRIER (EA)	6	0
DROP INLET BARRIER (EA)	6	0
MAINTAIN EROSION CONTROL BMP'S (LS)	0	1

* ALL EXISTING BMP'S INCLUDING CONSTRUCTION ENTRANCE, SEDIMENT BARRIERS, SILT FENCE, CUT-OFF TRENCH, AND EROSION CONTROL MAT SHALL BE MAINTAINED AND REPAIRED IF NECESSARY.

Baughman Blackstone Addition - Phase III
EROSION CONTROL
 Street/SWS Improvements

Baughman Company, P.A. 315 Ellis St. Wichita, KS 67211 P 316-262-7271 F 316-262-0149
 ENGINEERING | SURVEYING | PLANNING | LANDSCAPE ARCHITECTURE

PROJECT NUMBER 472-84399	DESIGN NBW	DRAWN JAK
REVISIONS:	APPROVED	DATE 8/27/18
	SCALE Noted	SHEET 19 OF 41

C:\Projects\Blackstone\Engineering\Phase 3\STR 1803E954\STR PLANS.dwg