

Note:
The Contractor shall coordinate with the utility companies to locate any existing utilities that have not been previously located.

Any storm sewer adjacent to the curb & gutter or under any proposed pavement on mainline, side roads or entrances shall be backfilled in accordance with the City of Wichita Specifications unless otherwise noted on the plans or by the Engineer.

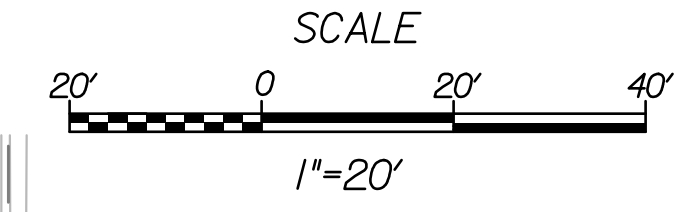
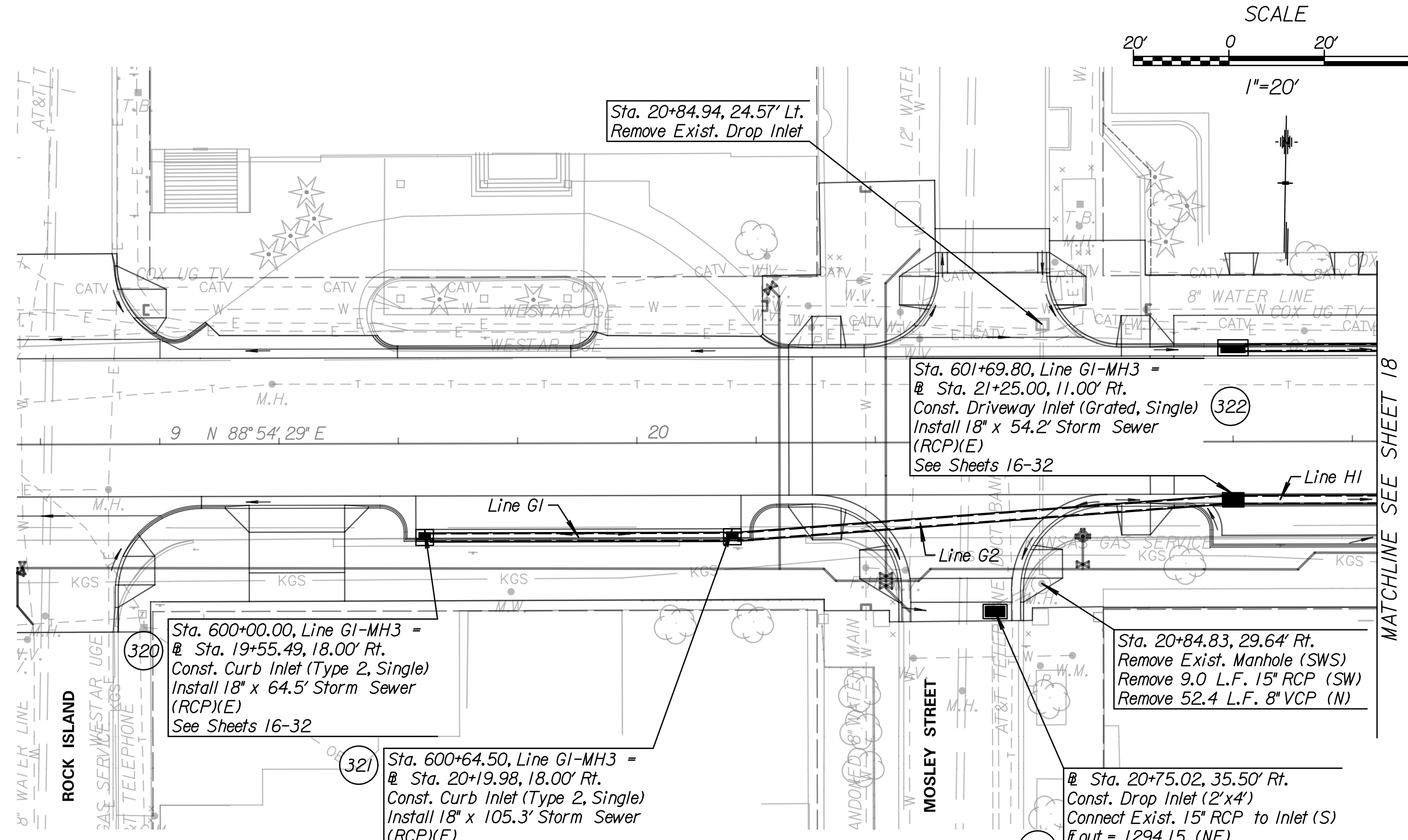

Tran Systems
245 NORTH WACO
SUITE 222
WICHITA, KANSAS 67202
PHONE: 316-303-3000
FAX: 316-303-0166

CONSULTANTS:
LK ARCHITECTURE, INC.
345 RIVERVIEW
SUITE 200
WICHITA, KANSAS 67208
PHONE: 316-268-0230

2ND STREET IMPROVEMENTS
SANTA FE TO WASHINGTON IN OLD TOWN
WICHITA, KANSAS
CITY OF WICHITA

All utilities shown in the profile are shown at approximate depths. The Contractor is responsible for field verifying the locations of utilities prior to construction in that area.

*Flowline Elevation shall be field verified prior to installing the manhole.

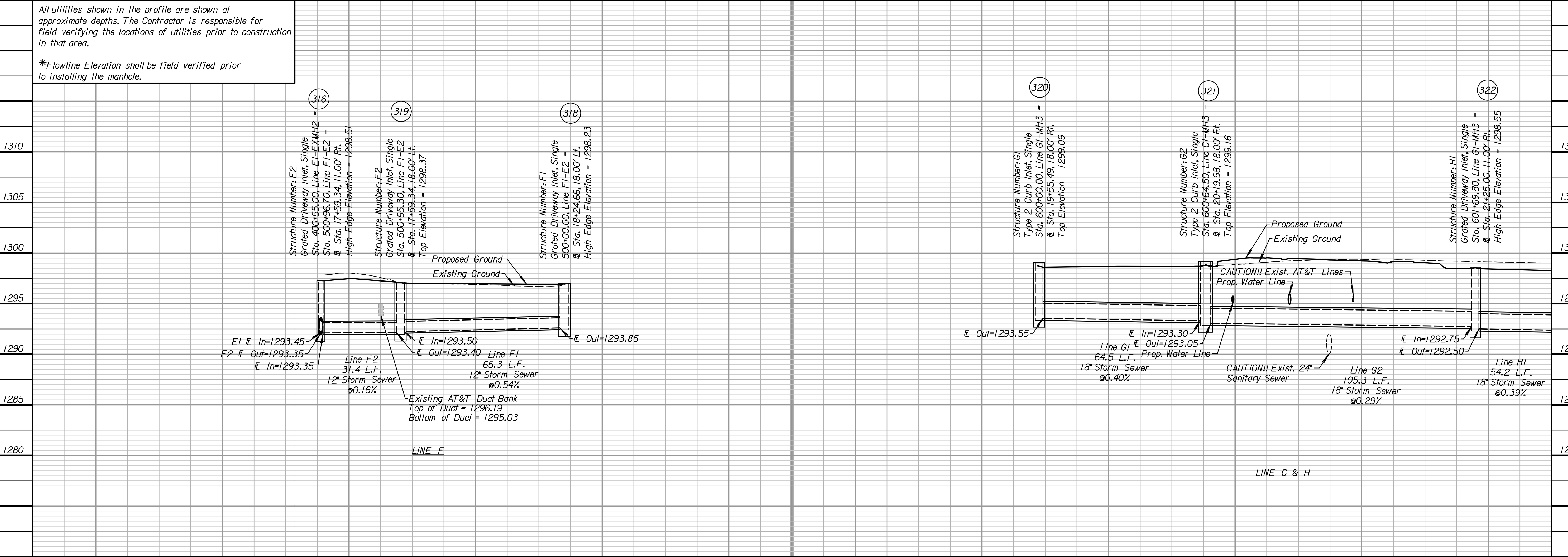

REVISIONS:	MARK	DATE	DESCRIPTION

PROJ NO: 472-85284
SCALE: 1"=20'
DATE: 7/11/2018
DESIGNED BY: TAU
DRAWN BY: TAU
CHECKED BY: MDB

SHEET TITLE:
2ND STREET STORM SEWER IMPROVEMENTS

SHEET NO.
17
SHEET 17 OF 103