

Note:  
The Contractor shall coordinate with the utility companies to locate any existing utilities that have not been previously located.

Any storm sewer adjacent to the curb & gutter or under any proposed pavement on mainline, side roads or entrances shall be backfilled in accordance with the City of Wichita Specifications unless otherwise noted on the plans or by the Engineer.

All work, material, and labor needed to install the downspout boot, 8" PVC pipe, and connect to the inlet shall be considered SUBSIDIARY to the bid item.  
\*Pipe, SWS 8"

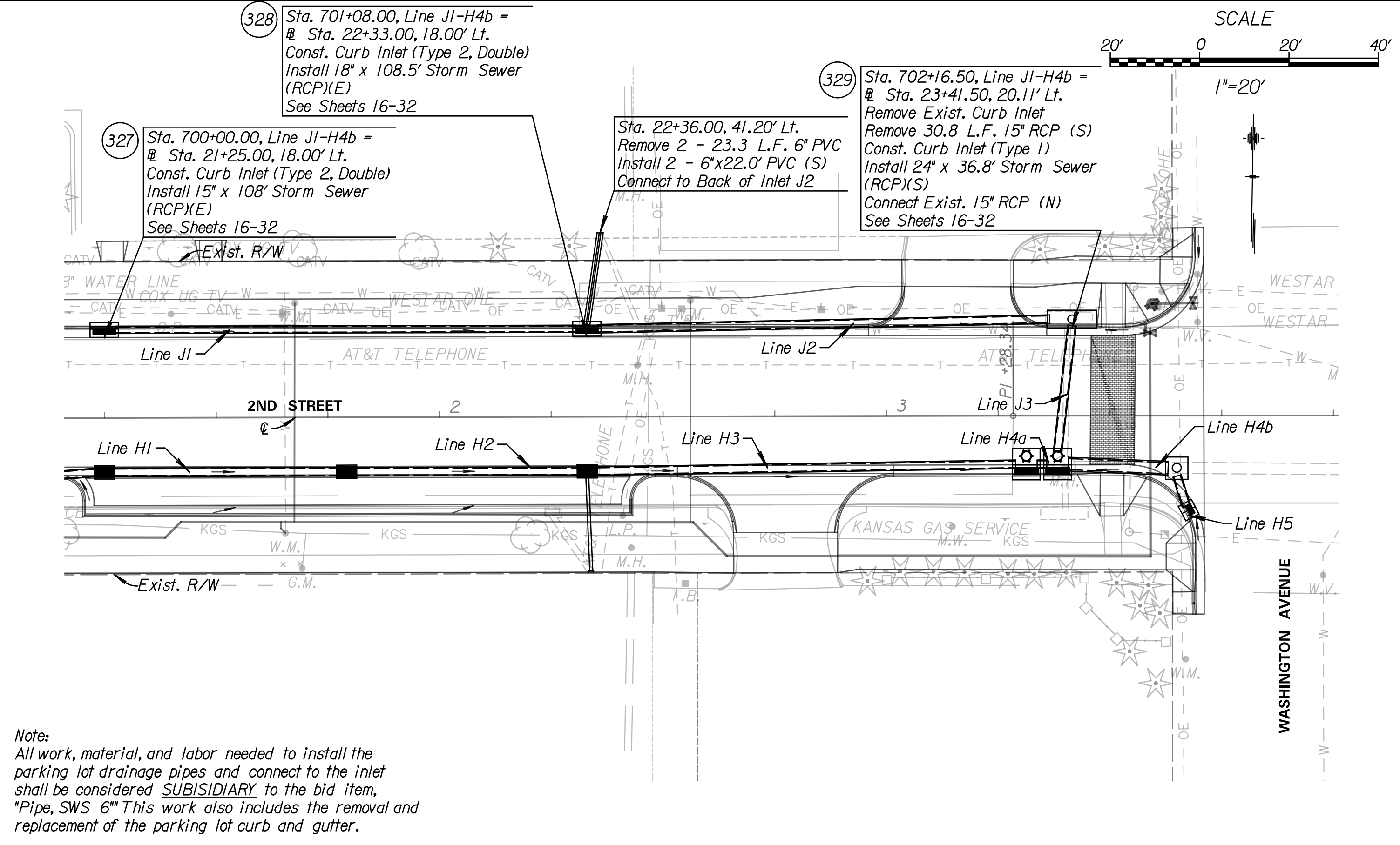
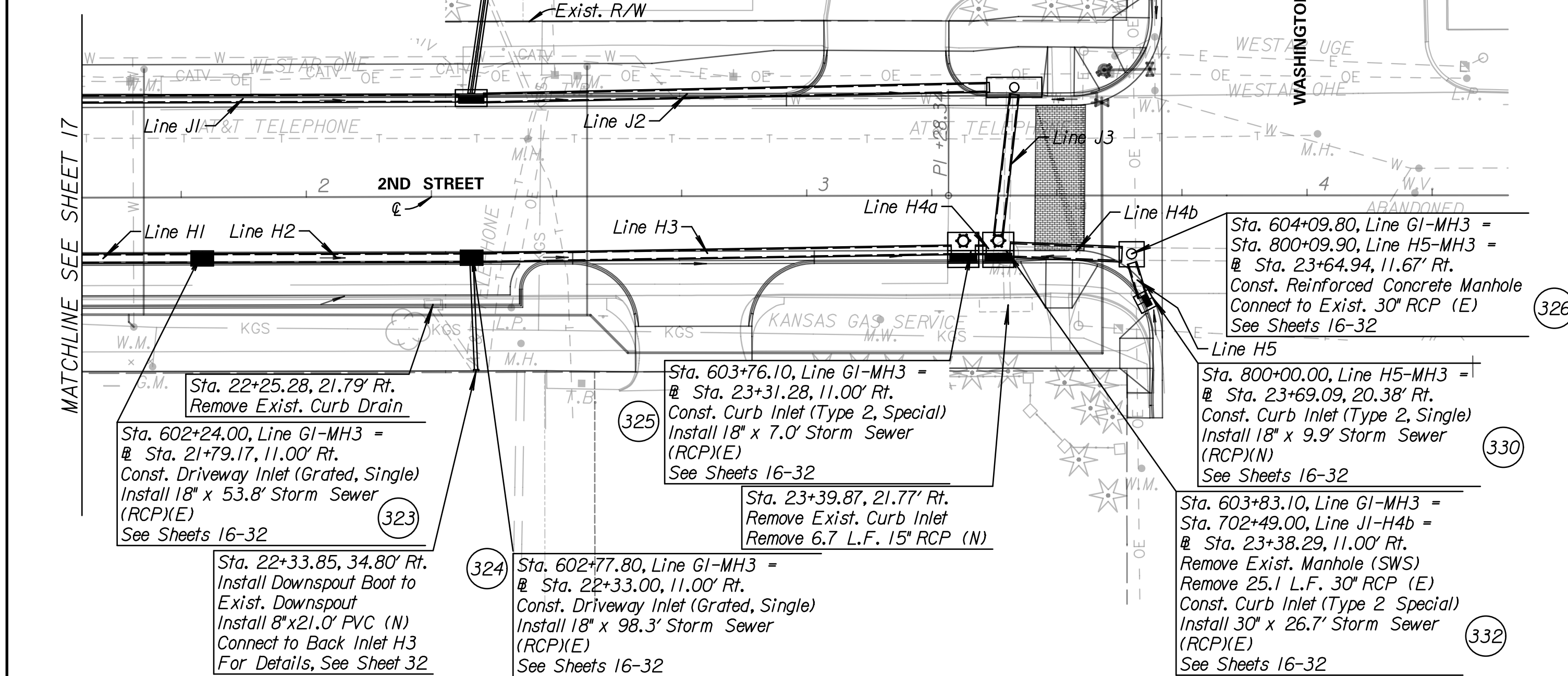

Note:  
All work, material, and labor needed to install the parking lot drainage pipes and connect to the inlet shall be considered SUBSIDIARY to the bid item.  
\*Pipe, SWS 6" This work also includes the removal and replacement of the parking lot curb and gutter.

All utilities shown in the profile are shown at approximate depths. The Contractor is responsible for field verifying the locations of utilities prior to construction in that area.  
\*Flowline Elevation shall be field verified prior to installing the manhole.

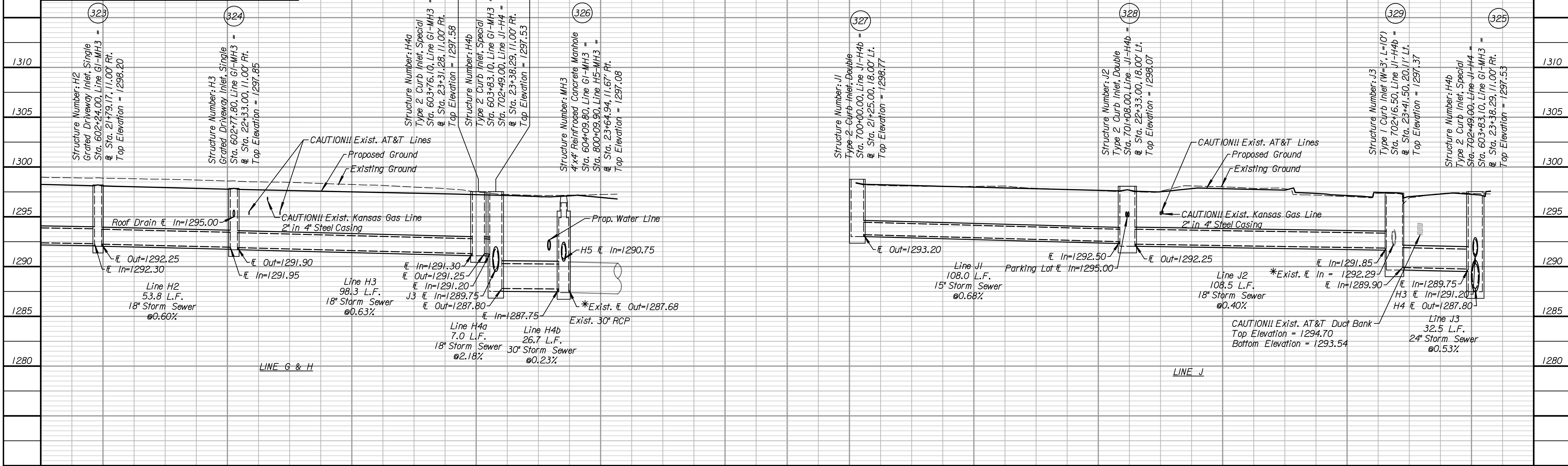

**Tran Systems**  
245 NORTH WACO  
SUITE 222  
WICHITA, KANSAS 67202  
PHONE: 316-303-3000  
FAX: 316-303-0166

CONSULTANTS:  
**LK ARCHITECTURE, INC.**  
345 RIVERVIEW  
SUITE 200  
WICHITA, KANSAS 67208  
PHONE: 316-268-0230

2ND STREET IMPROVEMENTS  
SANTA FE TO WASHINGTON IN OLD TOWN  
WICHITA, KANSAS  
**CITY OF WICHITA**

REVISIONS:	MARK	DATE	DESCRIPTION

PROJ NO: 472-85284  
SCALE: 1"=20'  
DATE: 7/11/2018  
DESIGNED BY: TAU  
DRAWN BY: TAU  
CHECKED BY: MDB  
SHEET TITLE:  
**2ND STREET STORM SEWER IMPROVEMENTS**  
SHEET NO.  
**18**  
SHEET 18 OF 103