

**BENCHMARKS:**

BM #1: "□" Top of Curb NE of the most easterly corner of Lot 28, Block E, Falcon Falls 2nd Addition  
Elev. = 1361.23 (NGVD29)

BM #2: "□" Top of Curb North of the NE corner of Lot 2, Block D, Falcon Falls 3rd Addition  
Elev. = 1351.76 (NGVD29)

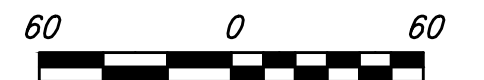
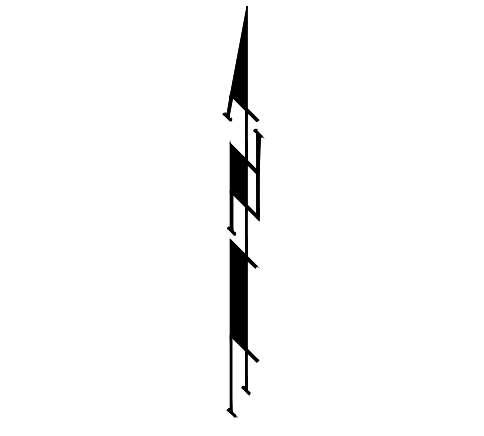
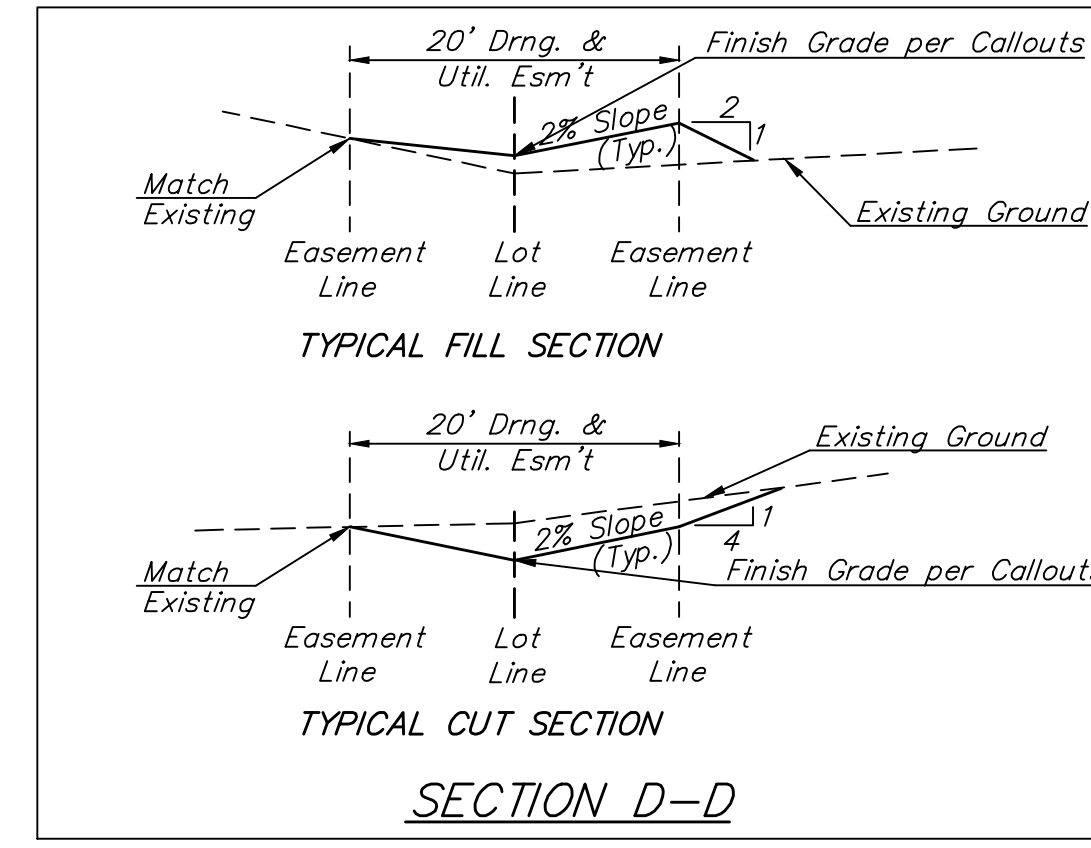
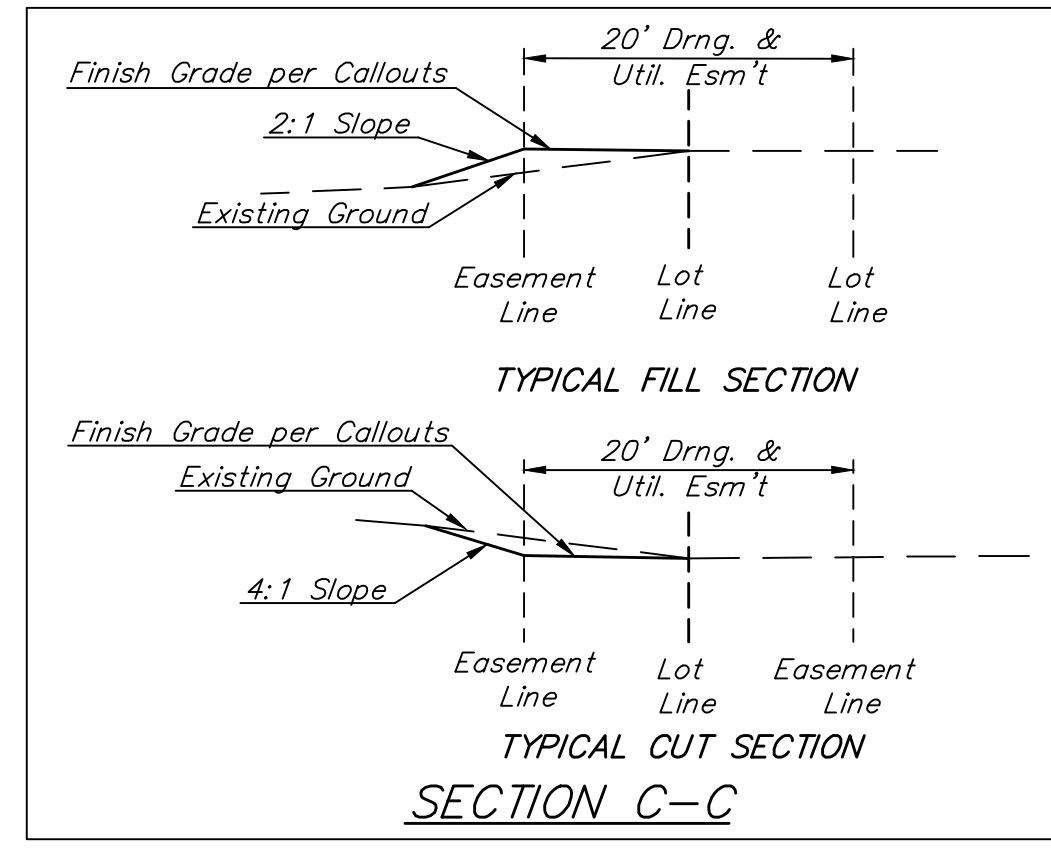
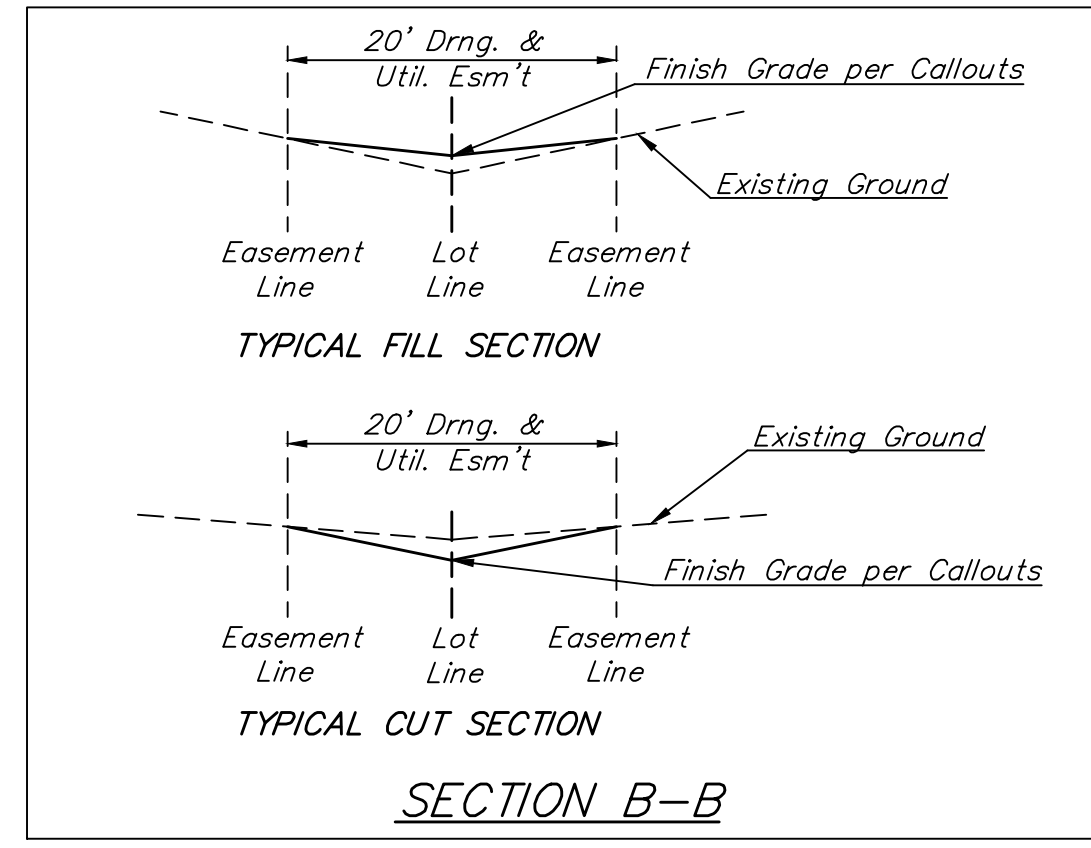
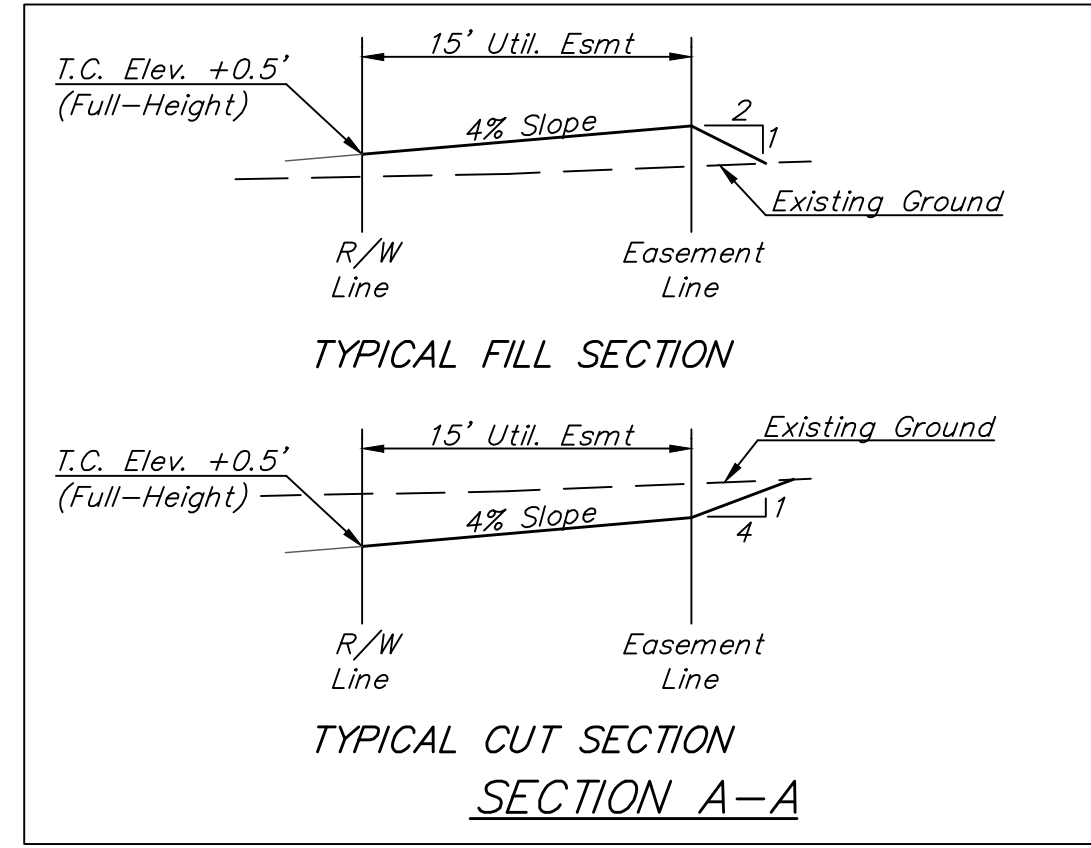

Scale: 1" = 60'

Existing Ground ——— 1364 ———

= Easements To Be Graded

Approximate Easement Grading Quantities:  
(For Information Only)  
Excavation: 614 C.Y.  
Fill: 981 C.Y.

The Contractor shall grade the easements as shown to the elevations given on the easement grading plan.

The Contractor shall 'straight' grade the easements between the elevations given. Where a callout designates 'Match', the Contractor will grade to the existing ground elevation.

All cost to be included in the Lump Sum bid item "Easement Grading"

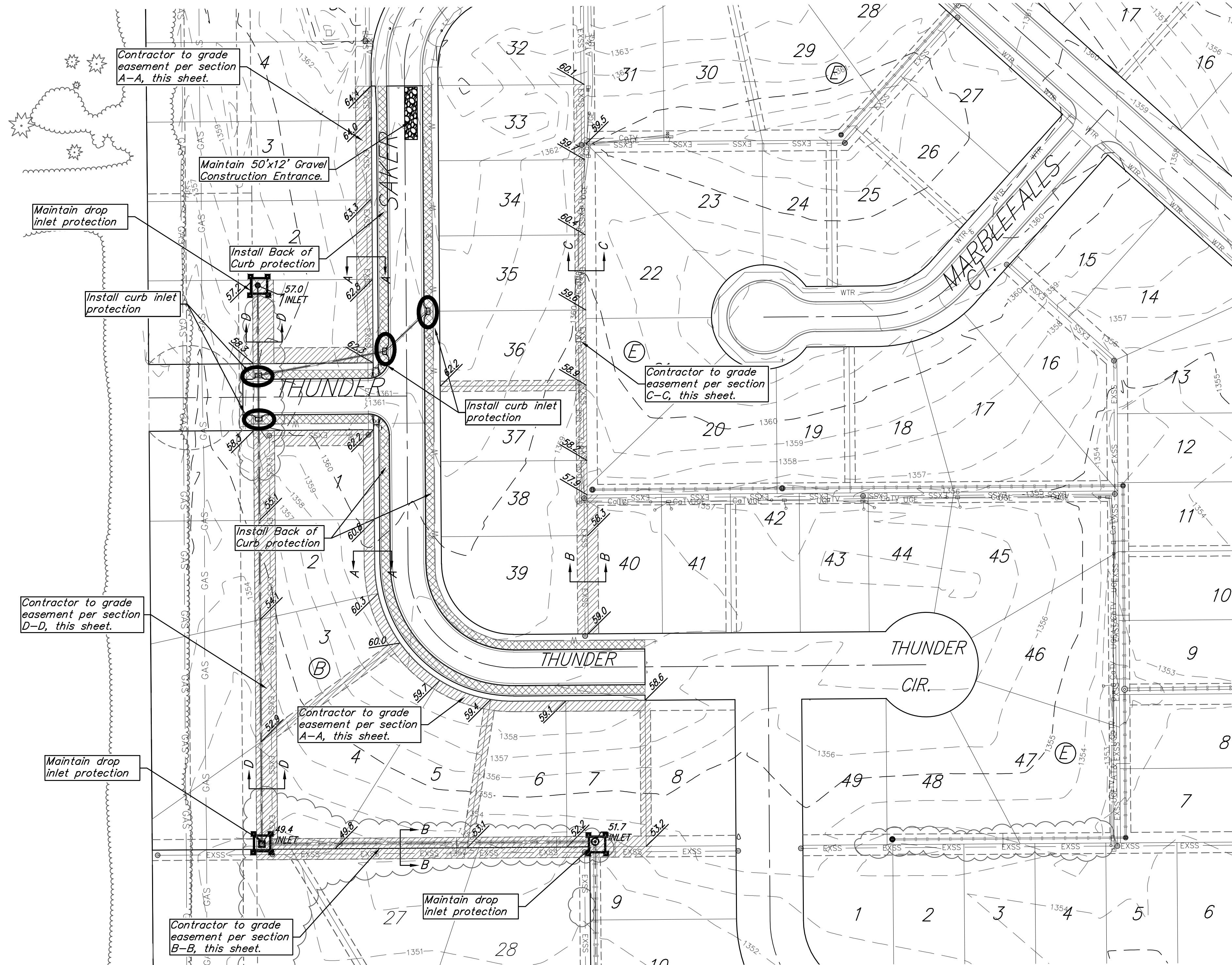

**EROSION CONTROL PLAN LEGEND**

- DROP INLET PROTECTION
- CURB INLET PROTECTION
- BACK OF CURB PROTECTION

- NOTES:**
- Contractor shall make sure all erosion control is in place before project is accepted. This plan represents the minimum standard. Any additional erosion control measures shall be installed by the Contractor as needed.
  - Removal of Gravel Construction Entrance for pavement construction shall be included in bid item "Site Clearing"
  - This Plan is Not To Be Used As A Comprehensive Grading Plan. All Spot Elevations Are Proposed & Subject To Change.
- All areas disturbed during construction shall be seeded, mulched, and fertilized as per Cover Sheet General Notes.

EROSION CONTROL MEASURE	INSTALL	MAINTAIN
BACK OF CURB PROTECTION (LF)	1,711	0
CONSTRUCTION ENTRANCE (EA)	0	1
CURB INLET BARRIER (EA)	4	0
DROP INLET BARRIER (EA)	0	3
MAINTAIN EROSION CONTROL BMP's (LS)	0	1

\* ALL EXISTING BMPs INCLUDING CONSTRUCTION ENTRANCE, SEDIMENT BARRIERS, SILT FENCE, CUT-OFF TRENCH, AND EROSION CONTROL MAT SHALL BE MAINTAINED AND REPAIRED IF NECESSARY.

**Baughman** Falcon Falls 2nd Addition - Phase 4A  
**EROSION CONTROL**  
Water Distribution System

Baughman Company, P.A. 315 Ellis St. Wichita, KS 67211 P 316-262-7271 F 316-262-0149  
ENGINEERING | SURVEYING | PLANNING | LANDSCAPE ARCHITECTURE

PROJECT NUMBER 472-84267	DESIGN DMV	DRAWN JAK
REVISIONS:	APPROVED	DATE 7/18/18
	SCALE Noted	SHEET <b>10 OF 21</b>

E:\Projects\Falcon Falls 2nd\Phase 4A\STR 1805-E012\STR PLANS.dwg