

**BENCHMARKS:**  
 BM #1: "□" Top of Curb NE of the most easterly corner of Lot 28, Block E, Falcon Falls 2nd Addition  
 Elev. = 1361.23 (NGVD29)

BM #2: "□" Top of Curb North of the NE corner of Lot 2, Block D, Falcon Falls 3rd Addition  
 Elev. = 1351.76 (NGVD29)

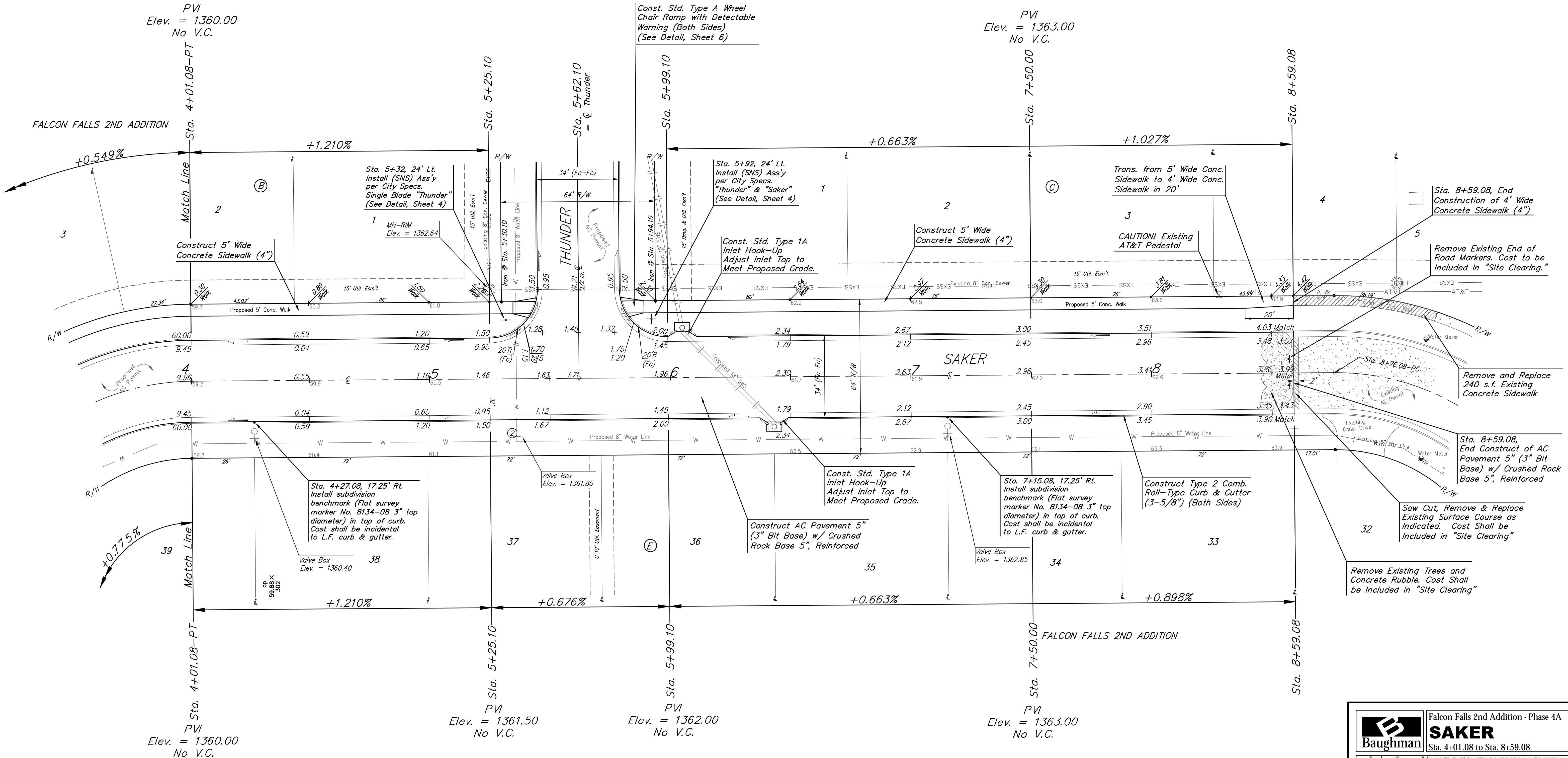
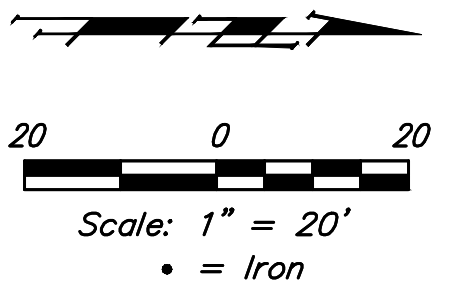

Subdivision Bench Marks		
Street & Station	Location Description	Elevation
Saker 4+27.08, 17.25' Rt.	Adjacent to Fire Hydrant at SW Corner of Lot 38, Block E	
Saker 7+15.08, 17.25' Rt.	Adjacent to Fire Hydrant at SW Corner of Lot 34, Block E	

Roll type curb & gutter to be constructed on the pavement on this sheet.  
 Top of curb elevation are given for full height curb.

	Falcon Falls 2nd Addition - Phase 4A	
	<b>SAKER</b> Sta. 4+01.08 to Sta. 8+59.08	
<small>Baughman Company, P.A. 315 Ellis St. Wichita, KS 67211 P 316-262-7271 F 316-262-0149          ENGINEERING   SURVEYING   PLANNING   LANDSCAPE ARCHITECTURE</small>		
PROJECT NUMBER <b>472-84267</b>	DESIGN AEG	DRAWN JAK
REVISIONS:	APPROVED DATE 7/18/18	SCALE Noted SHEET
		<b>8 OF 21</b>