

BENCHMARKS:
 BM #1: "□" Top of Curb NE of the most easterly corner of Lot 28, Block E, Falcon Falls 2nd Addition
 Elev. = 1361.23 (NGVD29)

BM #2: "□" Top of Curb North of the NE corner of Lot 2, Block D, Falcon Falls 3rd Addition
 Elev. = 1351.76 (NGVD29)

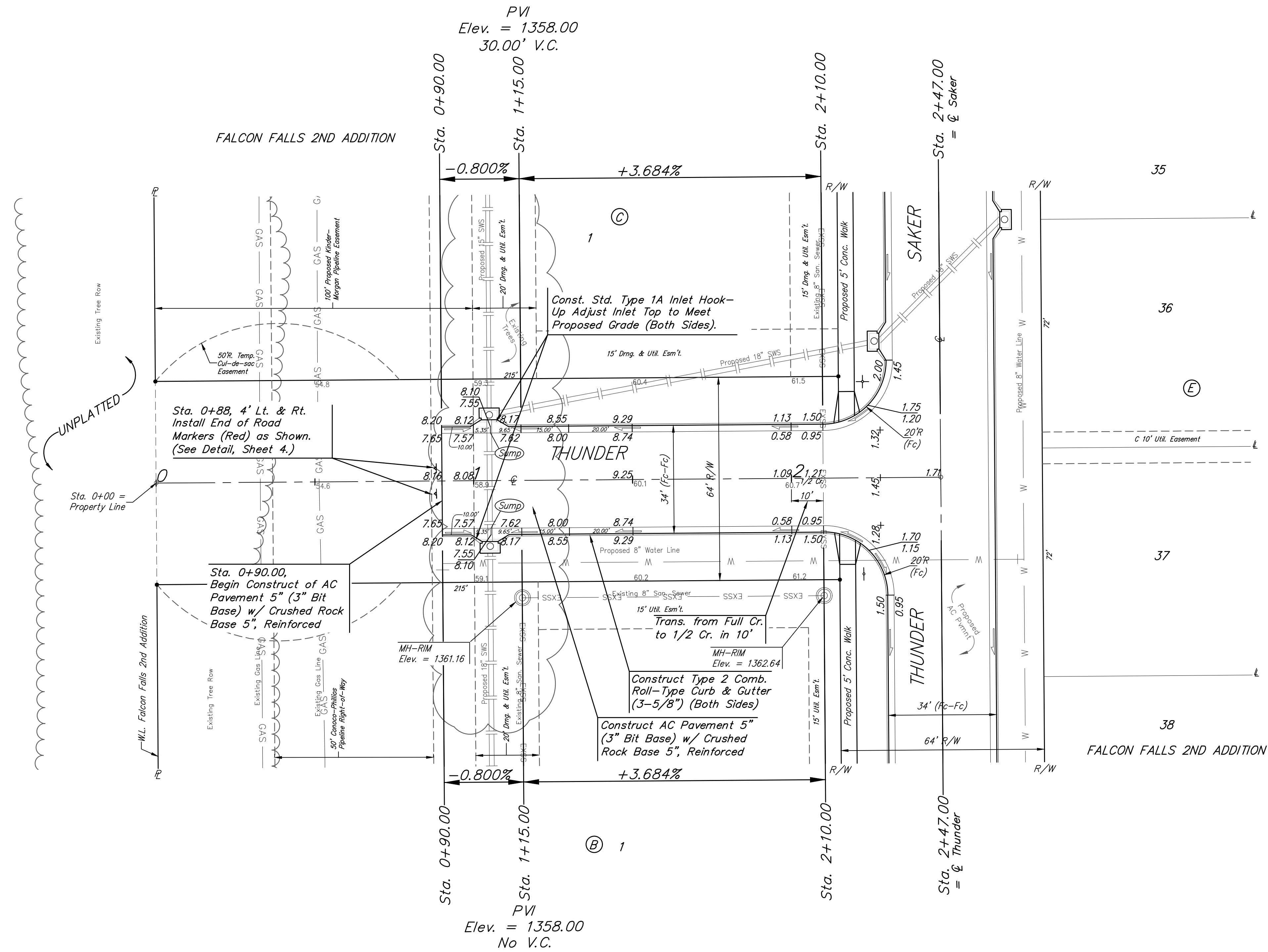
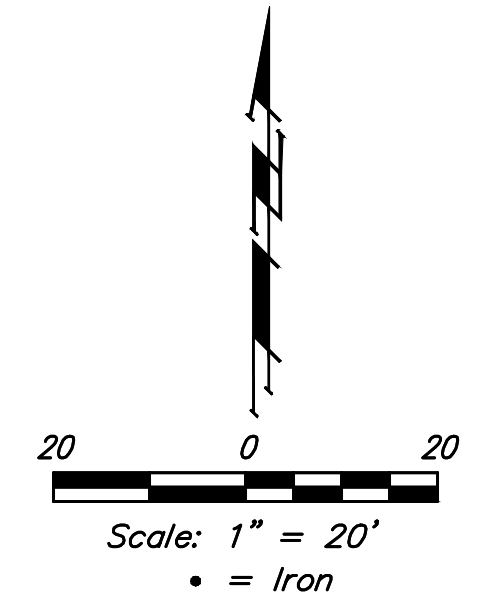

Remove existing trees only as **ABSOLUTELY** necessary for construction. Trees not in direct conflict with proposed new construction shall remain and be protected from damage. Cost to be included in bid item "Site Clearing"

Roll type curb & gutter to be constructed on the pavement on this sheet. Top of curb elevation are given for full height curb.

		Falcon Falls 2nd Addition - Phase 4A	
		THUNDER	
Sta. 0+90.00 to Sta. 2+10.00			
Baughman Company, P.A. 315 Ellis St. Wichita, KS 67211 P 316-262-7271 F 316-262-0149 ENGINEERING SURVEYING PLANNING LANDSCAPE ARCHITECTURE			
PROJECT NUMBER 472-84267	DESIGN AEG	DRAWN JAK	
REVISIONS:	APPROVED	DATE 7/18/18	
	SCALE Noted	SHEET	
			9 OF 21