

BENCHMARKS:
 BM #1: V-notch cut into sidewalk along east property line at common corner of Lots 1 & 2, Block D, Clifton Cove Addition.
 Elev. = 1259.70 NGVD29

BM #2: Chiseled cross on walk, southwest of intersection of Jade Avenue and Sunflower Drive, Clifton Cove Addition.
 Elev. = 1257.78 NGVD29

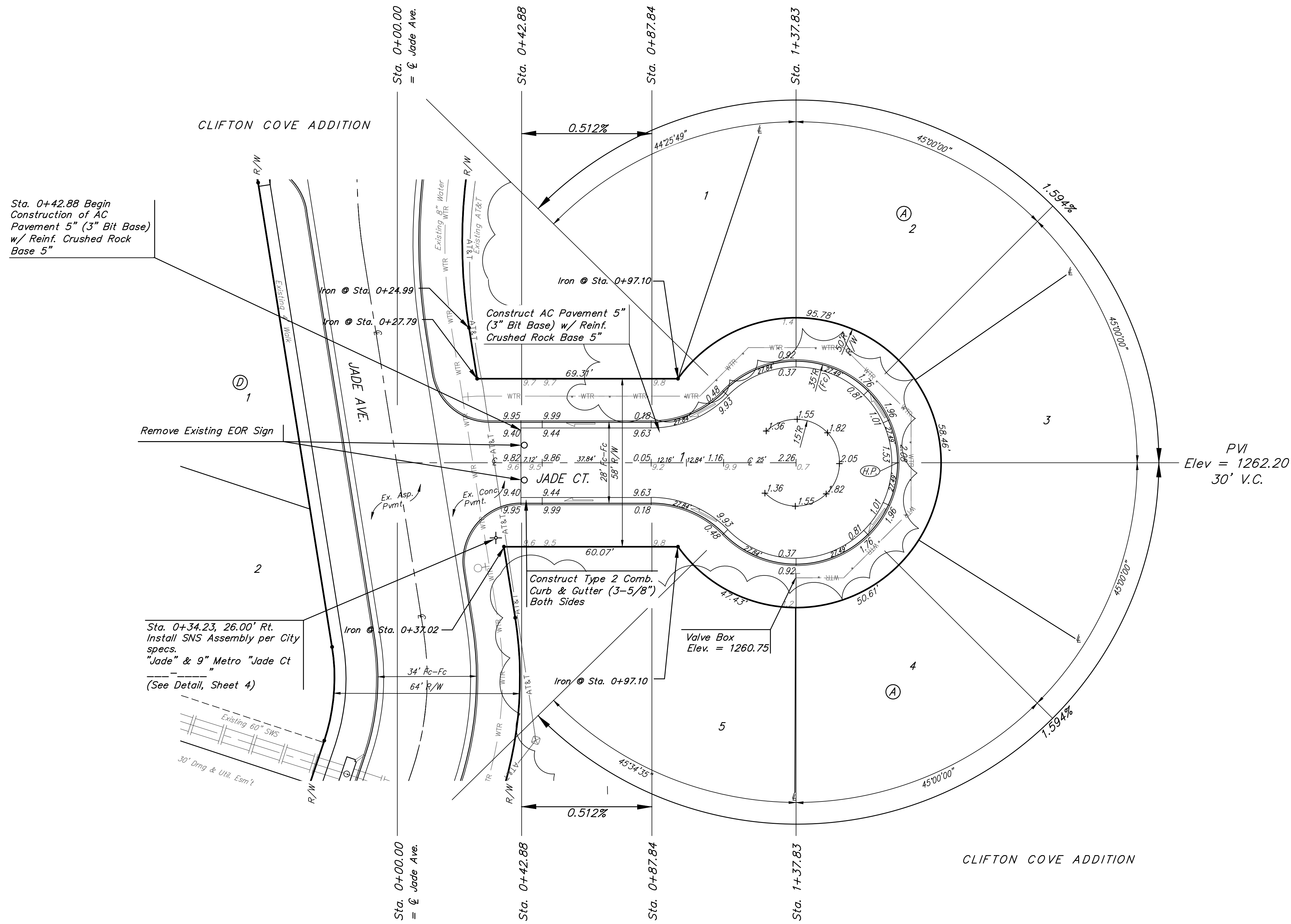
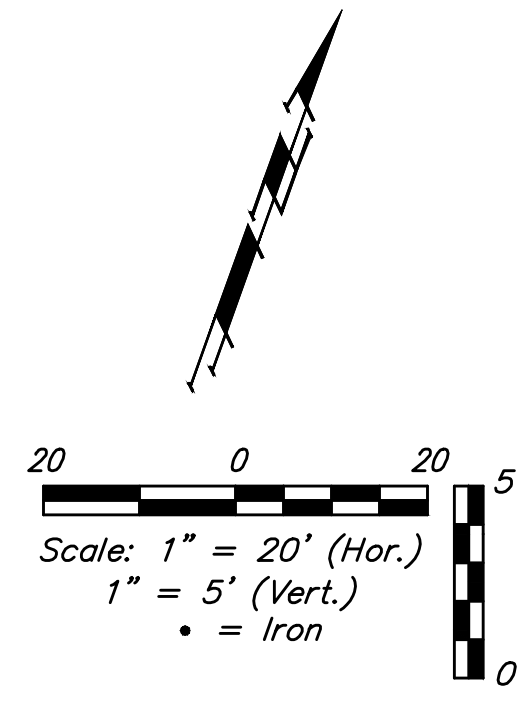

Sta. 0+42.88 Begin Construction of AC Pavement 5" (3" Bit Base) w/ Reinf. Crushed Rock Base 5"

Remove Existing EOR Sign

Sta. 0+34.23, 26.00' Rt. Install SNS Assembly per City specs. "Jade" & 9" Metro "Jade Ct" (See Detail, Sheet 4)

Construct AC Pavement 5" (3" Bit Base) w/ Reinf. Crushed Rock Base 5"

Construct Type 2 Comb. Curb & Gutter (3-5/8") Both Sides

Valve Box Elev. = 1260.75

Trees in conflict with street construction to be removed by contractor. To be paid for as lump sum bid item "Site Clearing"

All other trees shall remain and be protected from damage during construction. Overhanging limbs shall be trimmed by the Contractor using a chain saw only as necessary for construction and with approval of the Engineer. Cost of tree trimming to be included in bid item "Site Clearing"

PVI Elev = 1262.20
30' V.C.

Roll type curb & gutter to be constructed on the pavement on this sheet.
 Top of curb elevation are given for full height curb.

	Clifton Cove Addition Phase II	
	JADE CT. Sta. 0+00.00 to Sta. 1+37.83	
<small>Baughman Company, P.A. 315 Ellis St. Wichita, KS 67211 P 316-262-7271 F 316-262-0149 ENGINEERING SURVEYING PLANNING LANDSCAPE ARCHITECTURE</small>		
PROJECT NUMBER 472-85477	DESIGN AEG	DRAWN HW
REVISIONS:	APPROVED	DATE 9/11/18
	SCALE Noted	SHEET 5 OF 14