

# DOUGLAS & SHERIDAN SANITARY SEWER RELOCATION

## Index

- 1 Title Sheet
- 2 Notepage
- 3-5 Sanitary Sewer Line 1
- 6-7 Standard Sanitary Sewer Details
- 8 Traffic Control Plan
- 9-11 Traffic Control Details
- 12-16 Erosion Control Details

## BENCHMARKS:

- BM #1 - Chiseled "X" on the South End of the East Return of the Middle Drive to the National Guard Armory Property  
Elev. = 1305.24 (NAVD 88)
- BM #2 - Chiseled "X" on the South Side of the Sidewalk on the South Side of Douglas, 17' Southeast of the Lighted School Crossing Sign  
Elev. = 1303.89 (NAVD 88)
- BM #3 - Chiseled "X" on the North Side of the Sidewalk on the South Side of Douglas, 84.5' East Wheelchair Ramp on the East Side of Gow Avenue  
Elev. = 1303.60 (NAVD 88)
- BM #4 - Chiseled "X" on the Top of the Curb on the South Side of the Wheelchair Ramp on the East Side of Sheridan Avenue.  
Elev. = 1303.60 (NAVD 88)

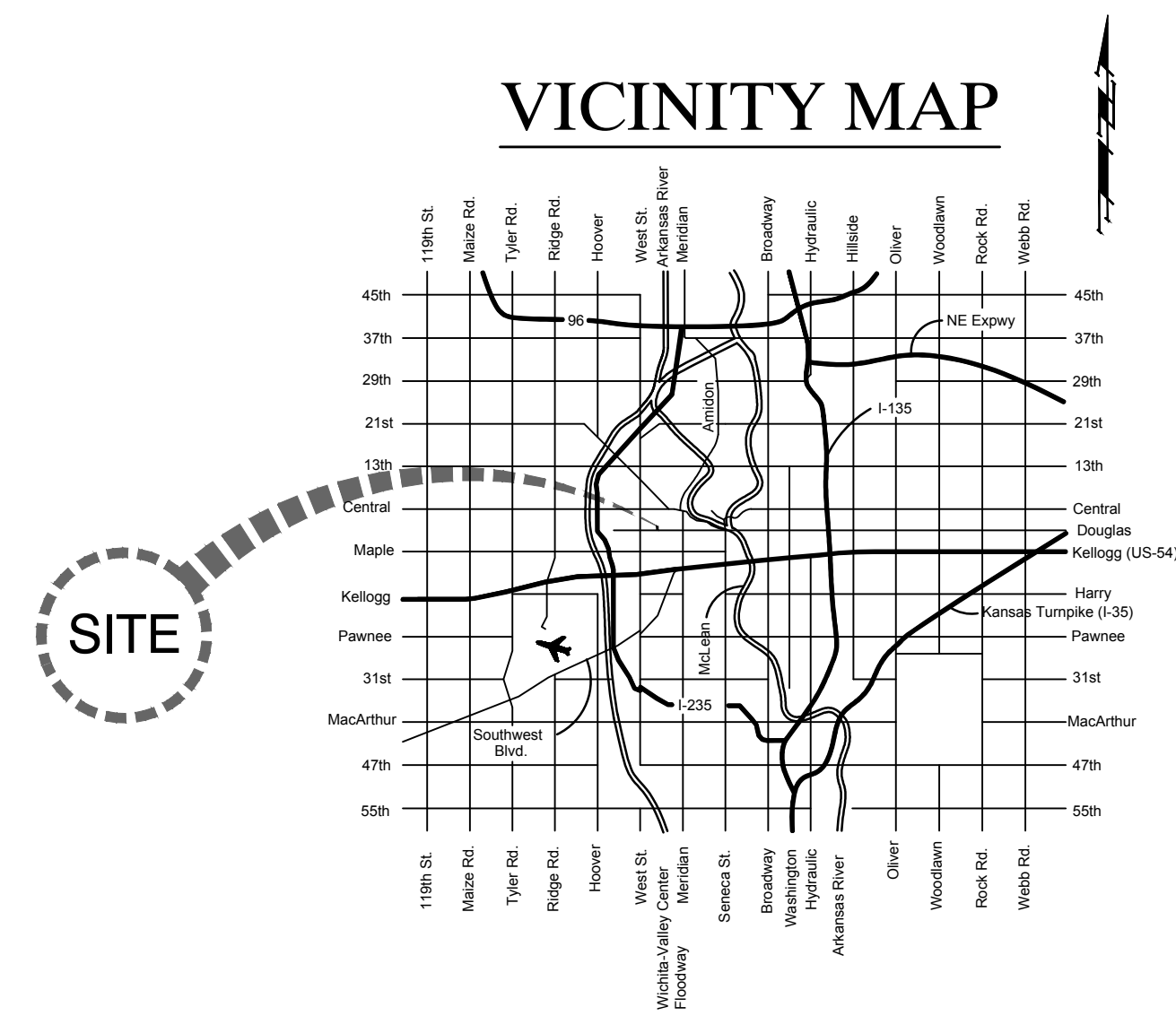

**Dondlinger - Contractor**  
**J. Brand - City of Wichita, Field Project Engineer**  
**T. Dvorak - City of Wichita, Inspector**  
**Asbuilt**  
**Completion Date: 8/12/2018**  
**pdf: 10/9/2018 apr**

FOR  
**THE CITY OF WICHITA,  
 SEDGWICK COUNTY, KANSAS**

**Gary Janzen, P.E., City Engineer**

City Project No. - 468-85244  
 O.C.A. No. - 622516

## CONTROL POINTS:

- |  |  |
|--|--|
| CP #100 - Chiseled "X"<br>N-1684650.08<br>E-1635330.93 | CP #101 - Chiseled "X"<br>N-1684656.99<br>E-1635772.38 |
| CP #102 - Chiseled "X"<br>N-1684655.62<br>E-1636097.31 | CP #103 - Chiseled "X"<br>N-1684594.25<br>E-1636346.40 |

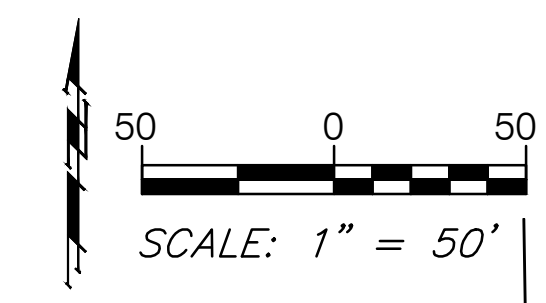
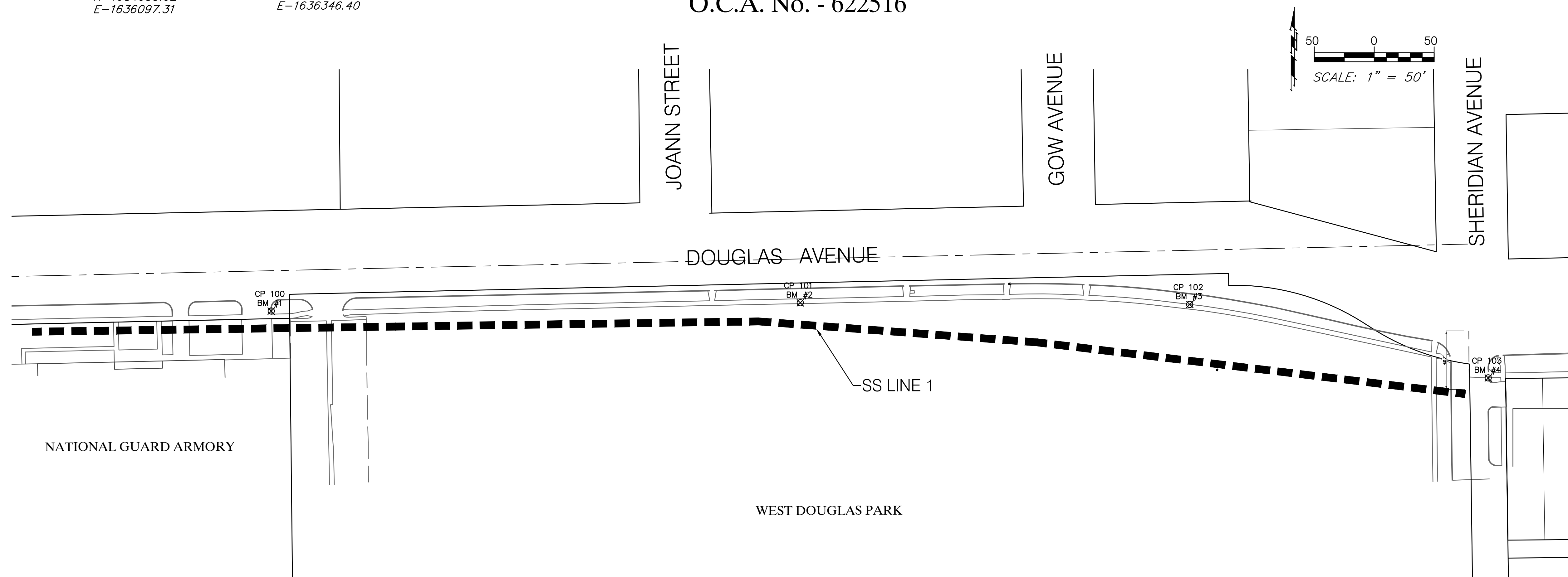

December 2017

# GENERAL NOTES

- The Contractor shall give all property owners and/or tenants of developed property abutting the project limits a minimum of ten (10) days advance notice prior to start of construction. See Project Special Provisions for additional notification requirements.
- Contractor will be required to provide a minimum advance notice of seventy-two (72) hours to utility companies prior to excavation or working adjacent to utilities. Kansas One-Call 687-2470
- Existing utilities and their locations, as shown on the plan, represent the best information obtainable at the time of design. The Contractor shall be aware that construction will occur in close proximity to existing utilities, and any conflicts with such utilities shall be reported to the Engineer. The Contractor should also be aware that some utility lines within the Project corridor may have been abandoned in place as new lines are installed. Contractor shall be responsible for notifying the affected utility to determine the status of said lines.
- The Water Department shall field locate water valves one time during construction when requested by the Contractor. It shall be the Contractor's responsibility to preserve such field locations during the construction process. Water valves, water valve boxes or fire hydrant damaged during construction shall be repaired by the Contractor at his own expense.
- All project waste including any trees, milled asphalt, rubble from miscellaneous structures, abandoned pipes, excess excavation & etc. shall be disposed of on sites to be provided by the Contractor. These sites shall be approved by the Engineer as to suitability, appearance and site location. Locations that, in the opinion of the Engineer, will leave an unsightly appearance will not be approved. All disposal sites must be approved by the Kansas Department of Health and Environment. Material either stockpiled or disposed of in a flood plain would require a Kansas State Board of Agriculture permit. Any material dumped in waters of the United States or wetlands is subject to U.S. Corps. of Engineers permitting regulations. Any material buried or stockpiled beyond approved construction limits would require additional archaeological investigations unless buried in a previously approved borrow location.
- The Contractor shall be made aware that he will be working in close proximity of existing utilities. Any conflicts with such utilities shall be reported to the Engineer. The Contractor shall coordinate the construction of this project with relocation of any existing utilities by the utility companies.
- Irons and monuments found are shown on the Plans. The Contractor shall be responsible for notifying the Engineer prior to excavation or clearing operations that will endanger said irons so that accurate ties can be determined for resetting. The Contractor shall be responsible for replacing shown property irons that are damaged or removed during construction. The Contractor shall procure a licensed Land Surveyor to locate and re-install the property iron.
- The Contractor shall be responsible for implementing erosion control methods during construction to prevent unnecessary silt/sediment discharge through downstream properties and/or storm sewer systems. The Contractor install and maintain erosion controls as directed by the Engineer. These controls may include, but not limited to: hay bales; silt fences, temporary seeding, Excelsior I Erosion Control Blanket (Curlax), or approved equal, or other controls necessary to inhibit sediment runoff during construction.
- Sewer Service shall not be interrupted throughout the length of the Project. The Contractor shall be responsible for maintaining continuous sewage flows. Cost for by-pass pumping at all sewer crossings shall be SUBSIDIARY to other items in the Project.
- The Contractor shall not start work on the Project until the Project Inspector is assigned and is present on site. Any work done without inspection will be required to be uncovered for inspection. Staking and inspection for this Project will be the responsibility of the City of Wichita.
- The Contractor shall comply with all applicable safety regulations, Special Provisions and City of Wichita Specifications and Standards.
- The Contractor shall be responsible for all traffic control measures to facilitate construction. All Construction Zone markings and signage shall conform to the latest version of the Manual on Uniform Traffic Control Devices (MUTCD) as published by the US Dept. of Transportation, Federal Highway Administration. All costs associated with construction markings and signage shall be SUBSIDIARY to the lump sum Bid Item "Traffic Control".
- The Contractor shall protect utility lines that cross or abut the Project corridor. For larger lines, the Contractor's method of supporting the utility structure shall be provided to the Engineer, as well as the affected Utility Company's representative for review and approval. Any shutdown of a utility line that may be required by construction of this Project shall be coordinated with the said affected utility.

- Adjacent Buildings, Structures, Parking Lots, Driveways, etc. other than those shown for replacement shall be protected from damage during construction of this Project.
- A full depth saw cut of the existing surface courses or the existing total pavement thickness shall be provided at the locations where proposed construction abuts an existing surface course or pavement for which partial removal of that surface or pavement is required. Sawed joint to facilitate removal within three (3) feet of existing joints will not be permitted and for such instances the limits of removal shall extend to the existing joint. Such saw cuts will not be paid for directly and this cost shall be considered SUBSIDIARY to the pavement removal.
- All traffic signs that are located in direct conflict with the proposed construction shall be removed and protected from damage by the Contractor. All signs that are removed during construction shall be replaced or reset by the Contractor as soon as construction permits. Any sign damaged by the Contractor shall be replaced at no additional cost to the project. All Traffic Control Signs shall remain operational during all phases of the project by either resetting existing or erecting temporary signs. This shall include all school crossing, warning signs, and applicable regulatory signs. The cost for any removal, replacement and/or resetting of traffic signs shall be SUBSIDIARY to "Site Restoration".
- All Elevations shown are based on NAVD 88 Datum.
- When under the pavement, the proposed SS Lines shall be backfilled with sand, flushed and vibrated, from the top of the improved bedding to within 2' below the bottom of the rock base or the bottom of drives/sidewalks. All others areas shall backfilled with the existing soils. Cost to be SUBSIDIARY to the Bid Item "Fill, Sand (Flushed & Vibrated)".
- Existing Power & Light poles may require bracing or removal/replacement during certain phases of the Project. The Contractor shall be responsible for coordinating the pole bracing with Randy Truitt with Westar at 261-6521 at least 3 weeks prior to beginning construction.
- All existing sanitary service connections that are active shall be reconnected to the new sewer line. To be paid as measured quantity bid item "Service Line Reconnections." Contractor is to confirm that all buildings that are being served will be served during and after construction and that any service found that is thought to be dead is confirmed to be dead before abandoning the connection.
- The Contractor shall coordinate with the Park Department regarding any laydown areas for pipe within West Douglas Park and meet with the City Arborist, Gary Farris 316-268-4003 to identify trees that may need defined clearance and/or protection during construction activities.
- Any trees that may need to be trimmed should be brought to the attention of the City Arborist during the field location and verification of all locations that will require tree protection fencing, who will assist with all trimming exercises. All tree protection and trimming shall be in place prior to construction activities. All Tree Trimming Operations shall be considered as SUBSIDIARY to "Site Clearing" bid item.
- The Contractor shall coordinate with Larry Hoetmer, City of Wichita Park Department at 268-4179 throughout the construction in West Douglas Park.
- TRAFFIC CONTROL:**  
One lane of traffic in each direction must be maintained on Douglas Avenue during construction of the sanitary sewer line. Sheridan Ave. can be closed during construction of the sewer. The Contractor shall provide, erect, and maintain traffic control devices in accordance with the Manual on Uniform Traffic Control Devices (M.U.T.C.D) as shown on the Traffic Control plans and subject to the Engineer's approval. Access to Businesses shall be maintained at all times.

## LIST OF UTILITY COMPANIES

TYPE	OWNER	CONTACT	TELEPHONE	(ALT.)
Locator Service	Kansas One-Call		687-2470	800-344-7233
TV	Cox Communications (Cable)	James Walburn	260-7491	262-0661
Electric	Westar Energy - Distribution	Shane Price	261-6315	383-8600
Gas	Kansas Gas Service	Joe Bridgewater	832-3158	888-482-4950
Gas	Black Hills Energy	Kelly Kraus	941-1628	832-3121
Telephone	AT&T	Jason Edwards	268-2008	800-344-7233
Water	Wichita Water Department	Greg Lolley	268-4555	219-8921
Storm Water Sewer	Wichita SWS Maintenance	Darrin Deutscher	268-4037	
Sanitary Sewer	Wichita Sewer Maintenance	Joe Loggins	268-4073	219-8921

RECAPITULATION OF QUANTITIES		
ITEM	QUANTITY TOTAL	UNIT
<b>LUMP SUM BID ITEMS - SANITARY SEWER</b>		
SITE CLEARING	1	Lump Sum
SITE RESTORATION	1	Lump Sum
SODDING	1	Lump Sum
REMOVAL OF EXISTING STRUCTURES (Includes Pipe, Manholes, etc.)	1	Lump Sum
TEMPORARY FENCE	1	Lump Sum
<b>MEASURED QUANTITY BID ITEMS - SANITARY SEWER</b>		
PIPE, SS 8"	1,199	Ft.
MH, SHALLOW SS (4')	2	Each
MH, STANDARD SS (4')	2	Each
MH, STANDARD SS (6') (Lined) (Dog House Style)	1	Each
<b>FILL, SAND (Flushed &amp; Vibrated)</b>		
	130	Ft.
<b>SERVICE RECONNECTION, SEWER (4')</b>		
	1	Each
<b>TREE REMOVED, LARGE</b>		
	2	Each
<b>TREE REMOVED, SMALL</b>		
	2	Each
<b>LUMP SUM BID ITEMS - TRAFFIC</b>		
TRAFFIC CONTROL	1	Lump Sum
<b>MEASURED QUANTITY BID ITEMS - PAVING</b>		
CONCRETE PAVEMENT REMOVED AND REPLACED	28	S.Y.
CONCRETE DRIVE REMOVED AND REPLACED	20	S.Y.
ASPHALT PARKING LOT PAVEMENT REMOVED AND REPLACED	27	S.Y.
CONCRETE CURB, MONO EDGE, REMOVED AND REPLACED	15	Ft.
SIDEWALK REMOVED & REPLACED	7	S.Y.
AC PAVEMENT, 6" (Temporary)	50	S.Y.
<b>MEASURED QUANTITY BID ITEMS - EROSION CONTROL</b>		
BMP, CURB INLET PROTECTION	2	Each
BMP, BACK OF CURB PROTECTION	100	Ft.

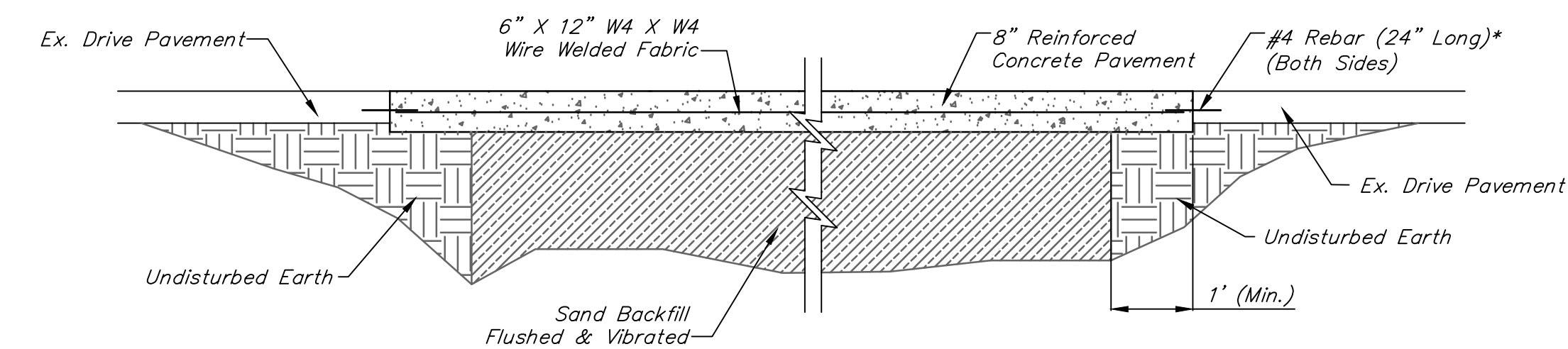

## REINF. CONCRETE DRIVE TYPICAL SECTION

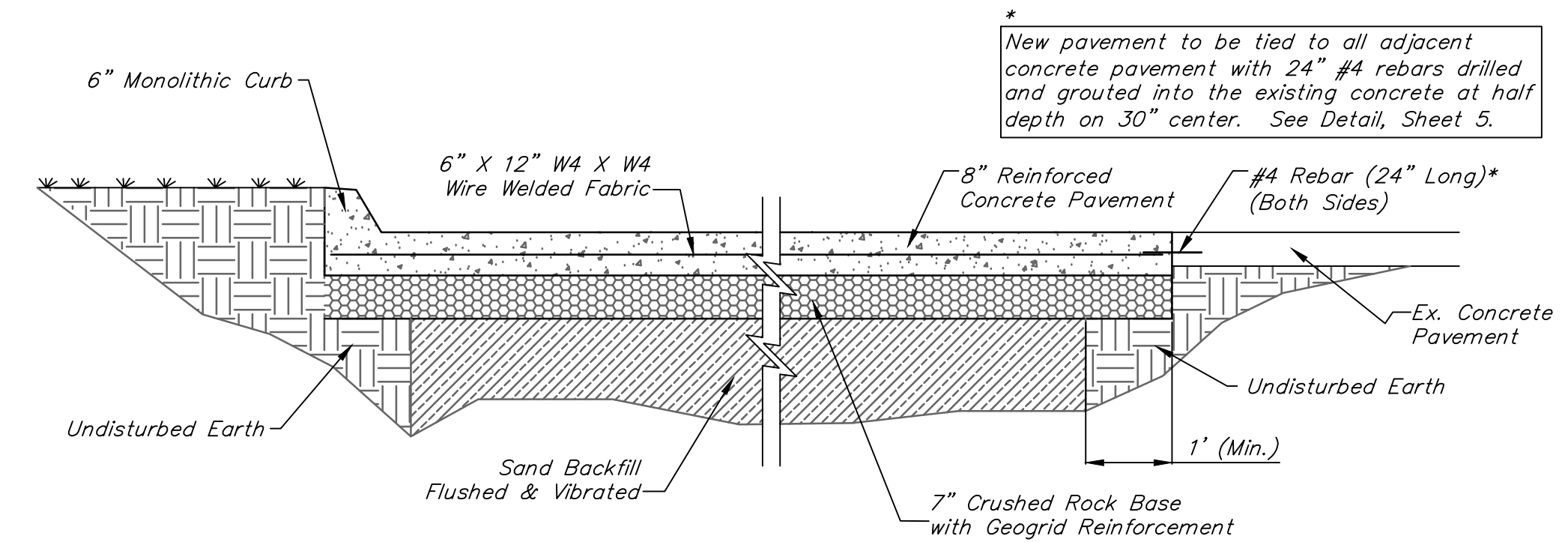

## REINF. CONCRETE PAVEMENT TYPICAL SECTION

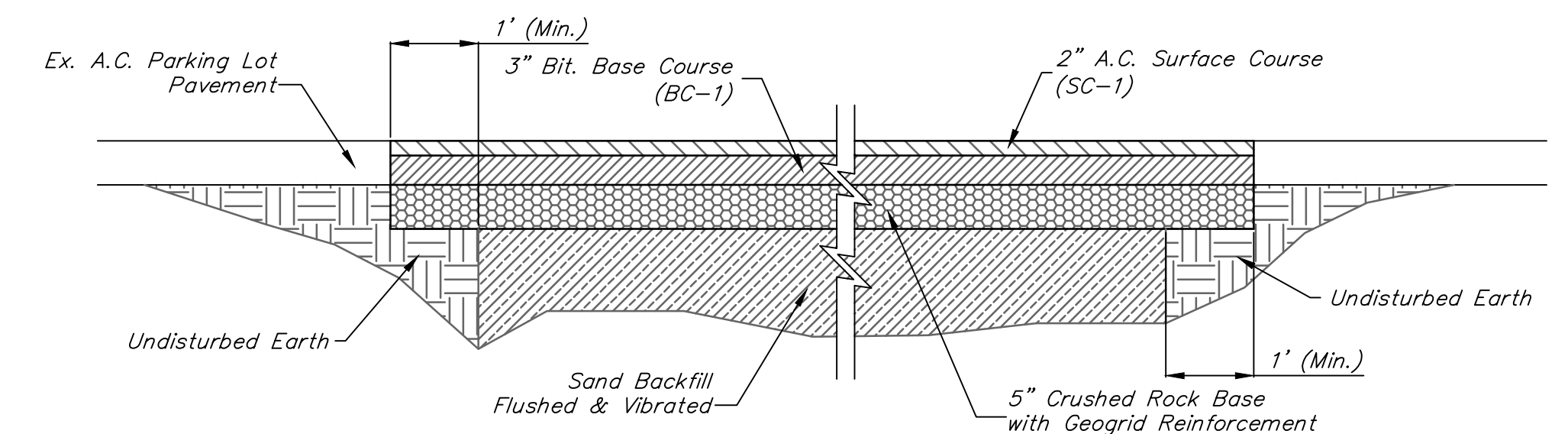

## A.C. PARKING LOT TYPICAL SECTION

**BENCHMARKS:**

BM #1 - Chiseled "X" on the South End of the East Return of the Middle Drive to the National Guard Armory Property  
Elev. = 1305.24 (NAVD 88)

The Contractor Shall Remove and Dispose of the Stone Columns, Flag Pole, Concrete Barrier and Sign in Front of the Armory Building. Cost to be SUBSIDIARY to the Lump Sum Bid Item "Removal of Existing Structures".

The Ex. Manholes Shall be Removed as Necessary for Construction or Abandoned in Place per City of Wichita Specifications. The Ex. SS Pipe Shall be Removed as Necessary for the Construction and the Existing Pipe that is to Remain Shall be Capped. Cost to be SUBSIDIARY to the Lump Sum Bid Item "Removal of Existing Structures".

**SS TAP RECONNECTIONS**

ADDRESS	SS Line #	Approx. Station
Concession Stand	Line 1	2+96

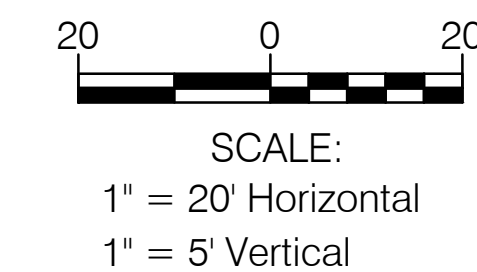

**BUILT PER PLAN**

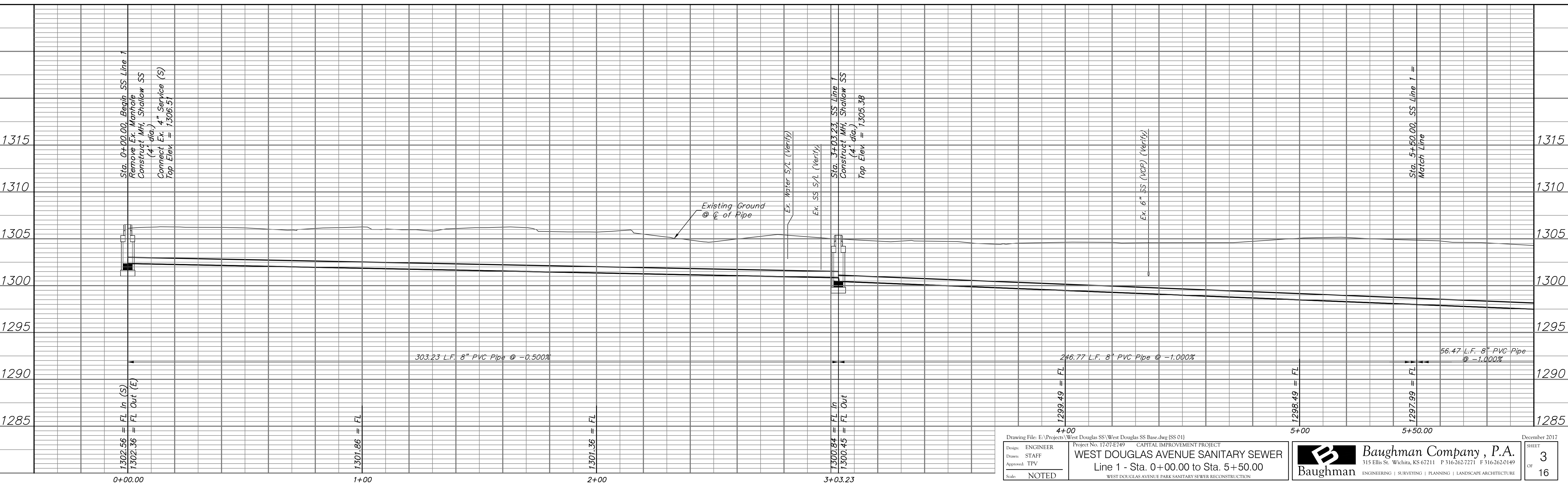
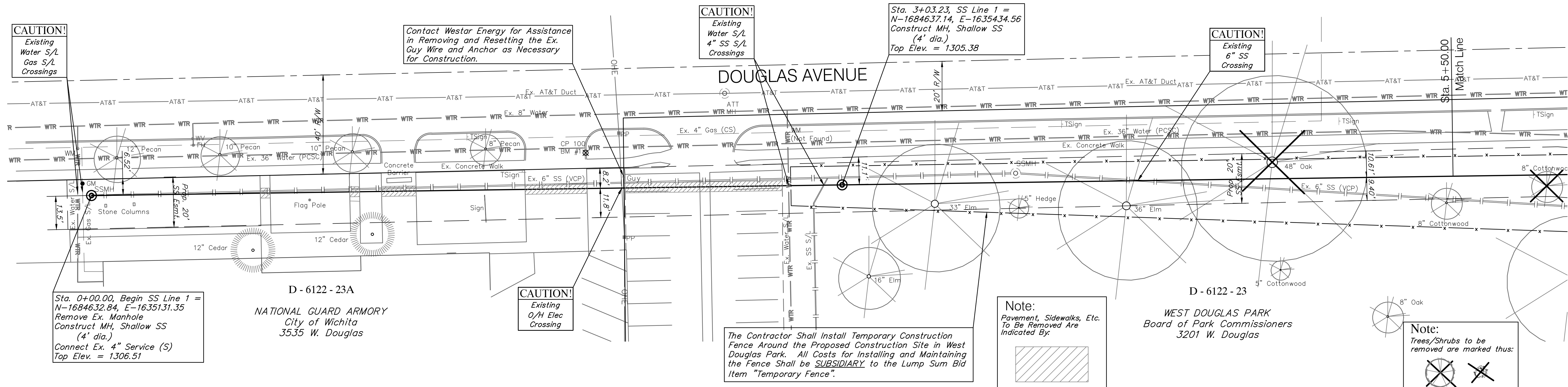



**BENCHMARKS:**

BM #4 - Chiseled "X" on the Top of the Curb on the South Side of the Wheelchair Ramp on the East Side of Sheridan Avenue. Elev. = 1303.60 (NAVD 88)

The Contractor Shall Seal the 6" SS Opening (E) in the Manhole Approx. 175' East of the Centerline of Sheridan Avenue. All Cost Associated with this Work Shall be Considered **SUBSIDIARY** to the Lump Sum Bid Item "Removal of Existing Structures".

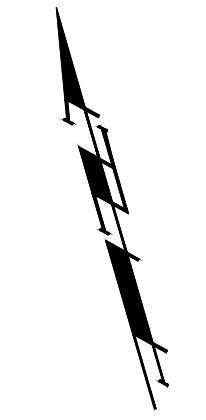
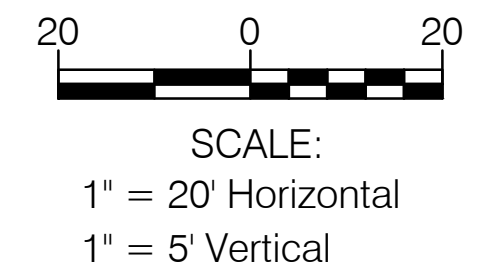

Sta. 11+98.61, End SS Line 1 = N-1684584.82, E-1536327.10  
Construct MH, Standard SS (Lined) (6' Dia.) (Dog House Style)  
Over Existing 36" VCP Sewer  
Grout & Seal Ex. 36" Pipe (N & S)  
Top Elev. = 1302.82

**BUILT PER PLAN**

**CAUTION!**  
Existing 8" Water AT&T Duct in Vicinity

**CAUTION!**  
Existing 36" Water 4" Gas O/H Elec Crossings

The Contractor Shall Install Temporary Construction Fence Around the Proposed Construction Site in West Douglas Park. All Costs for Installing and Maintaining the Fence Shall be **SUBSIDIARY** to the Lump Sum Bid Item "Temporary Fence".

**Note:**  
Pavement, Sidewalks, Etc. To Be Removed Are Indicated By:

