

Existing Pavement, Curb and Gutter to be Removed and Replaced as necessary for construction. No additional pay shall be made for this work, *Subsidiary* to other pay items.

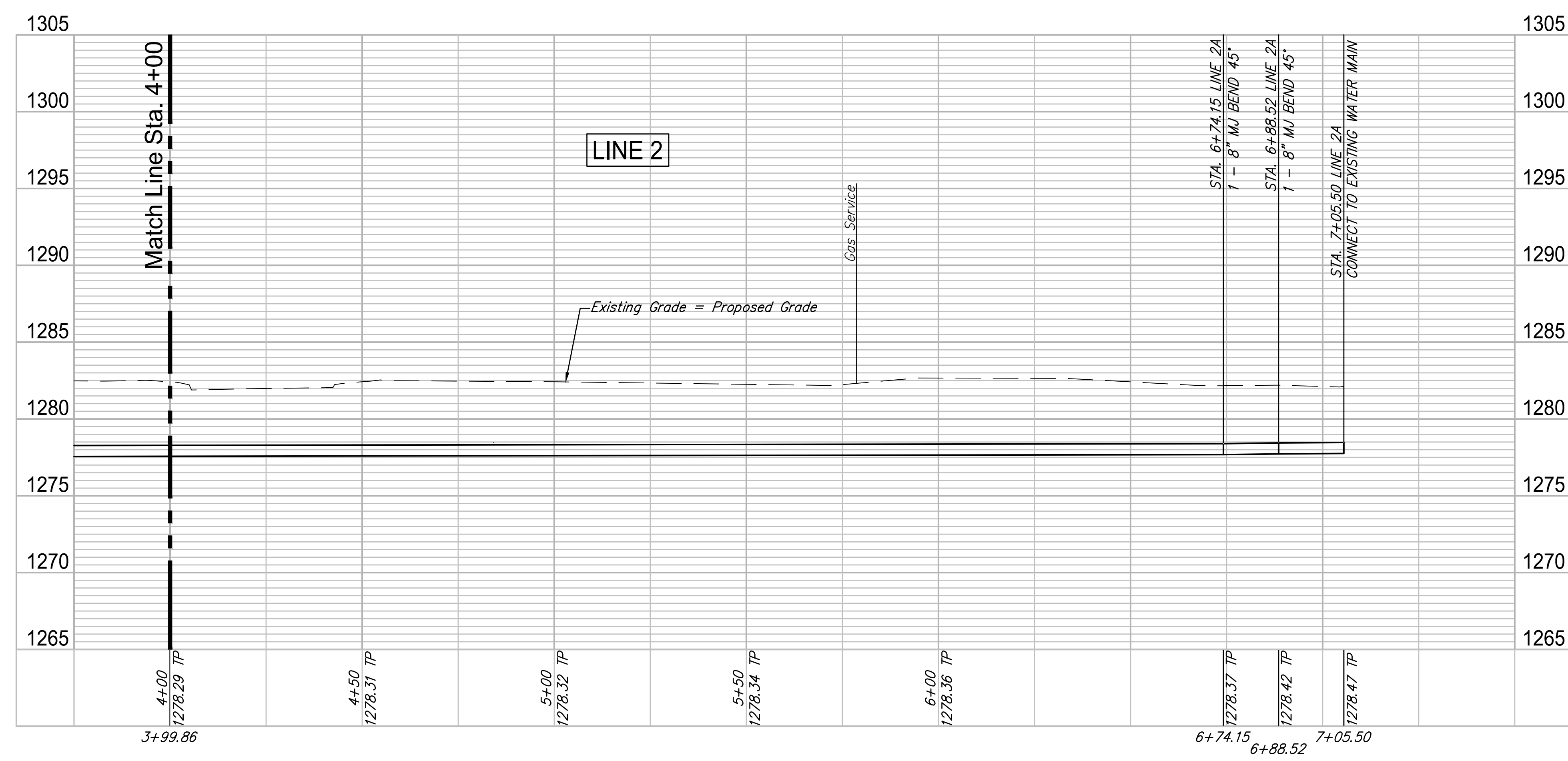

Replat of Lot 23, Block 2, Schrader Bros. 4th Addition



ROSE MARIE WATER - Part A
WASSALL - LINE 2A (2 of 2)
 Wichita, Kansas

PROJECT NUMBER: 448-30721
 DRAWING FILE: LINE 2A - Wassall

DESIGN: CMB / RA
 DRAWN: DRS / RA

REVIEW: 12-7-16
 DATE: 4/20/18

GARVER JOB 4701W
 SHEET 11 OF 57

© Copyright 2018, Garver

F:\Projects\Projects 4700-4799\4701W (Rose Marie waterline replacement)\LINE 2A - Wassall.dwg