

# La Mascotte Addition

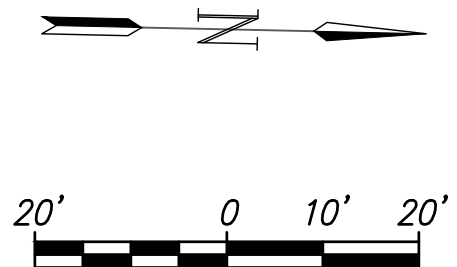
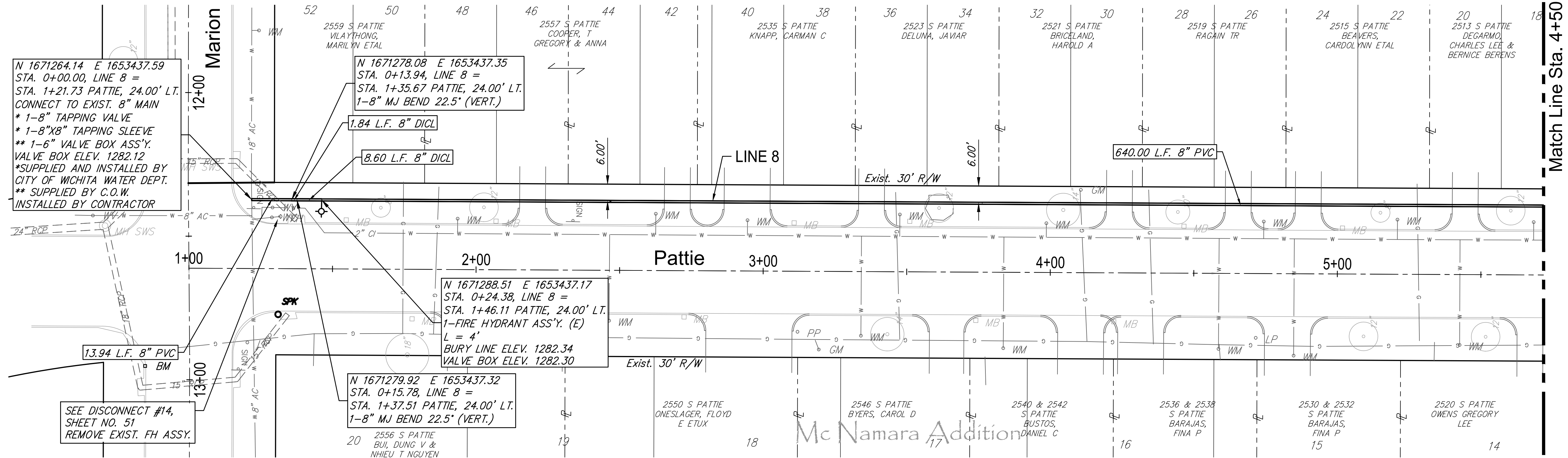

Existing Pavement, Curb and Gutter to be Removed and Replaced as necessary for construction. No additional pay shall be made for this work, Subsidiary to other pay items.

WATER METER SUMMARY				
BL Station	Lt./Rt.	Service (Long or Short)	Address	As Built
1+93	Lt.	Short	2557 S. PATTIE	
2+46	Rt.	Long	2550 S. PATTIE	
2+94	Lt.	Short	2535 S. PATTIE	
3+34	Rt.	Long	2546 S. PATTIE	
3+47	Lt.	Short	2523 S. PATTIE	

WATER METER SUMMARY				
BL Station	Lt./Rt.	Service (Long or Short)	Address	As Built
3+83	Rt.	Long	2540 S. PATTIE	
3+98	Lt.	Short	2521 S. PATTIE	
4+48	Rt.	Long	2536 S. PATTIE	
4+74	Lt.	Short	2519 S. PATTIE	
4+85 *1	Rt.	Long	2532 S. PATTIE	

WATER METER SUMMARY				
BL Station	Lt./Rt.	Service (Long or Short)	Address	As Built
4+85 *1	Rt.	Long	2530 S. PATTIE	
5+21	Lt.	Short	2515 S. PATTIE	
5+42	Rt.	Long	2520 S. PATTIE	

\* These duplexes share the same tap and the same meter box. 1 - 2530 & 2532 s. Pattie

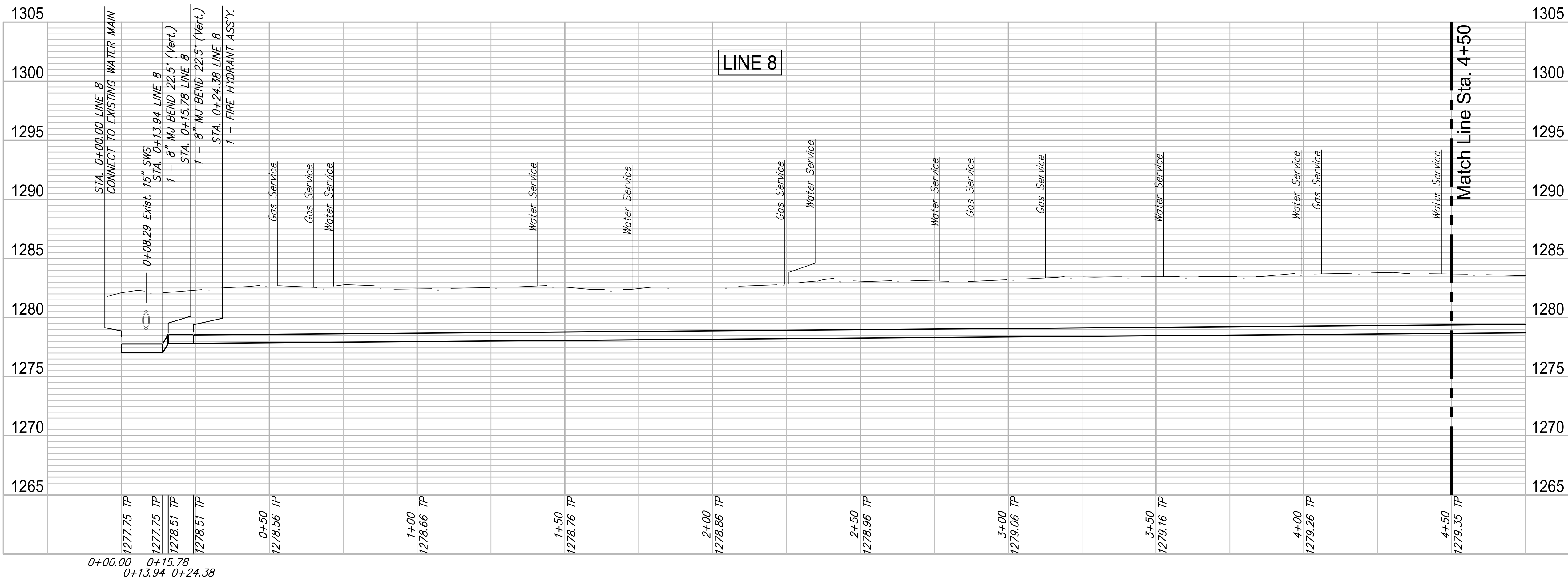

F:\Projects\Projects 4700-4799\4701W (Rose Marie waterline replacement)\LINE 8 - Pattie 1-2.dwg

**ROSE MARIE WATER - Part A**  
**PATTIE - LINE 8 (1 of 3)**  
 Wichita, Kansas

PROJECT NUMBER: 448-90721  
 DRAWING FILE: LINE 8 - Pattie 1-2

DESIGN: CMB / RA  
 DRAWN: DRS / RA

REVIEW: 12-7-16  
 DATE: 4/20/18

GARVER JOB: 4701W  
 SHEET: 28 OF 57  
 © Copyright 2018, Garver