

Existing Pavement, Curb and Gutter to be Removed and Replaced as necessary for construction. No additional pay shall be made for this work, Subsidiary to other pay items.

WATER METER SUMMARY				
Bl. Station	Lt./Rt.	Service (Long or Short)	Address	As Built
1+37	Lt.	Short	1110 E. JUMP	
1+67	Rt.	Long	2870 S. LARKIN	
2+40	Rt.	Long	2864 S. LARKIN	
2+51	Lt.	Short	2863 S. LARKIN	
3+12	Lt.	Short	2857 S. LARKIN	
3+13	Rt.	Long	2858 S. LARKIN	

WATER METER SUMMARY				
Bl. Station	Lt./Rt.	Service (Long or Short)	Address	As Built
3+56	Lt.	Short	2851 S. LARKIN	
3+68	Rt.	Long	2852 S. LARKIN	
4+29	Rt.	Long	2846 S. LARKIN	
4+32	Lt.	Short	2845 S. LARKIN	
4+91	Rt.	Long	2840 S. LARKIN	
4+92	Lt.	Short	2839 S. LARKIN	

WATER METER SUMMARY				
Bl. Station	Lt./Rt.	Service (Long or Short)	Address	As Built
5+47	Rt.	Long	2834 S. LARKIN	
5+54	Lt.	Short	2833 S. LARKIN	
6+10	Rt.	Long	2828 S. LARKIN	
6+12	Lt.	Short	2827 S. LARKIN	



REVIEW: 12-7-16
DATE: 4/20/18
DESIGN: CMB / RA
DRAWN: DRS / RA

ROSE MARIE WATER - Part A
LARKIN - LINE 13 (1 of 3)
Wichita, Kansas

GARVER JOB NO. 4701W
SHEET NO. 46 OF 57
© Copyright 2018, Garver

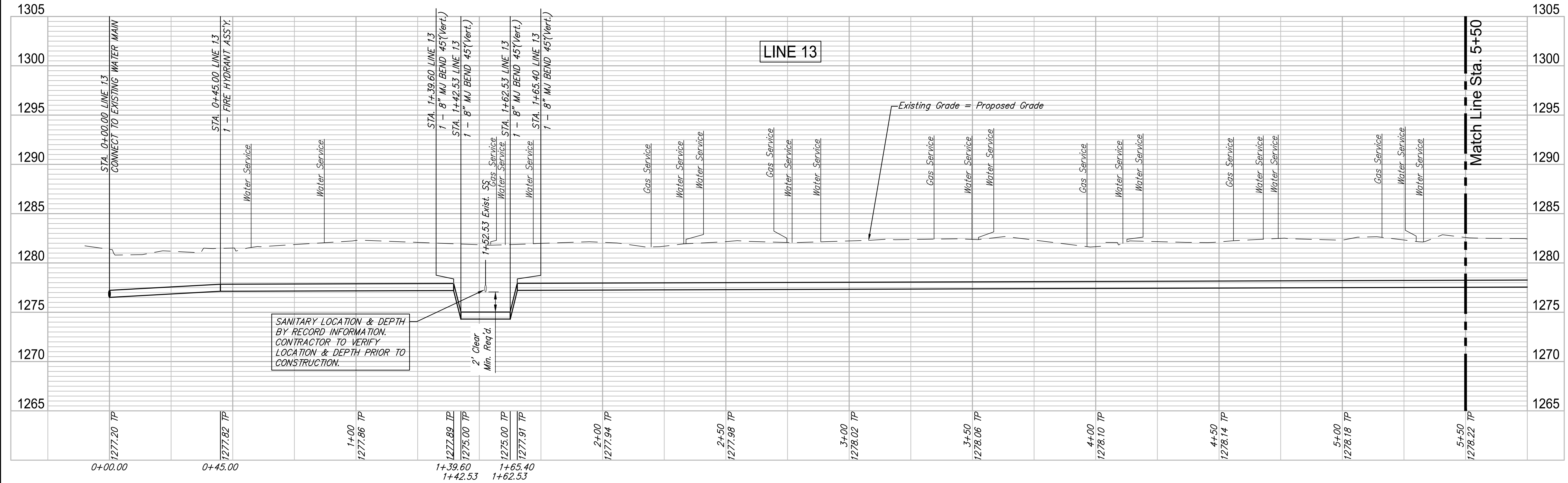

F:\Projects\Projects 4700-4799\4701W (Rose Marie waterline replacement)\LINE 13 - Larkin 1-2.dwg